

(SUBMIT IN TRIPLICATE)

Indian Agency Bureau of Indian Affairs

Contr. 14-50-003-3022

UNITED STATES

DEPARTMENT OF THE INTERIOR  
GEOLOGICAL SURVEY

Allottee Trust #140

Lease No. Bureau "A"

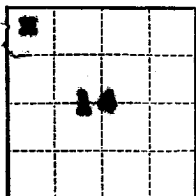

## SUNDRY NOTICES AND REPORTS ON WELLS

NOTICE OF INTENTION TO DRILL	<input checked="" type="checkbox"/>	SUBSEQUENT REPORT OF WATER SHUT-OFF	
NOTICE OF INTENTION TO CHANGE PLANS		SUBSEQUENT REPORT OF SHOOTING OR ACIDIZING	
NOTICE OF INTENTION TO TEST WATER SHUT-OFF		SUBSEQUENT REPORT OF ALTERING CASING	
NOTICE OF INTENTION TO REDRILL OR REPAIR WELL		SUBSEQUENT REPORT OF REDRILLING OR REPAIR	
NOTICE OF INTENTION TO SHOOT OR ACIDIZE		SUBSEQUENT REPORT OF ABANDONMENT	
NOTICE OF INTENTION TO PULL OR ALTER CASING		SUPPLEMENTARY WELL HISTORY	
NOTICE OF INTENTION TO ABANDON WELL			

(INDICATE ABOVE BY CHECK MARK NATURE OF REPORT, NOTICE, OR OTHER DATA)

RECEIVED  
AUG 10 1960  
U. S. GEOLOGICAL SURVEY  
FARMINGTON, NEW MEXICO

August 8, 1960

Well No. 23 is located 600 ft. from N line and 800 ft. from W line of sec. 14

Sec. 14 (34 Sec. and Sec. No.) 31N (Twp.) 17W (Range) N10E (Meridian)  
Huerfano-Gallup (Field) San Juan (County or Subdivision) New Mexico (State or Territory)

The elevation of the ~~surface~~ level above sea level is 5872 ft. (Est.)

### DETAILS OF WORK

(State names of and expected depths to objective sands; show sizes, weights, and lengths of proposed casings; indicate mudding jobs, cementing points, and all other important proposed work)

Propose to drill the above well to a total depth of approximately 1000'. We expect to test the Gallup formation at 925', and any other zones that appear productive of oil or gas.

Casing program: 120' of 8-5/8" casing,  
1000' of 3-1/2" casing.

We propose to sand-oil free with 20,000 gals. and 40,000 gals.



I understand that this plan of work must receive approval in writing by the Geological Survey before operations may be commenced.

Company Security Mobil Oil Company, Inc.

Address P. O. Box 3371

Bureau, Colorado

By

P. M. Barry

Title Dist. Prod. Supt.

# NEW MEXICO OIL CONSERVATION COMMISSION

## WELL LOCATION AND ACREAGE DEDICATION PLAT

FORM C-128  
Revised 5/1/57

**SEE INSTRUCTIONS FOR COMPLETING THIS FORM ON THE REVERSE SIDE**

### SECTION A

Operator <b>SOCONY MOBIL OIL COMPANY, INC.</b>			Lease <b>Navajo (A)</b>		Well No. <b>23</b>
Unit Letter <b>D</b>	Section <b>14</b>	Township <b>31N</b>	Range <b>17W</b>	County <b>San Juan</b>	
Actual Well Location of Well: <div style="display: flex; justify-content: space-between;"> <span>660 feet from the North line and</span> <span>800 feet from the West line</span> </div>					
Ground Level Elev. <b>5272</b>	Producing Formation <b>Lower Gallup</b>		Pool <b>Horseshoe Gallup</b>		Dedicated Acreage: <b>40</b> Acres

1. Is the Operator the only owner in the dedicated acreage outlined on the plat below? YES X NO \_\_\_\_ . ("Owner" means the person who has the right to drill into and to produce from any pool and to appropriate the production either for himself or for himself and another. (65-3-29 (e) NMSA 1935 Comp.)
2. If the answer to question one is "no," have the interests of all the owners been consolidated by communitization agreement or otherwise? YES \_\_\_\_ NO \_\_\_\_ . If answer is "yes," Type of Consolidation \_\_\_\_
3. If the answer to question two is "no," list all the owners and their respective interests below:

Owner	Land Description

### SECTION B

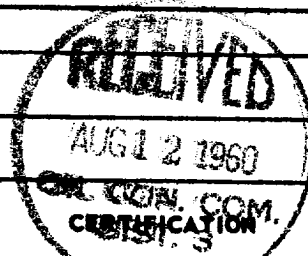
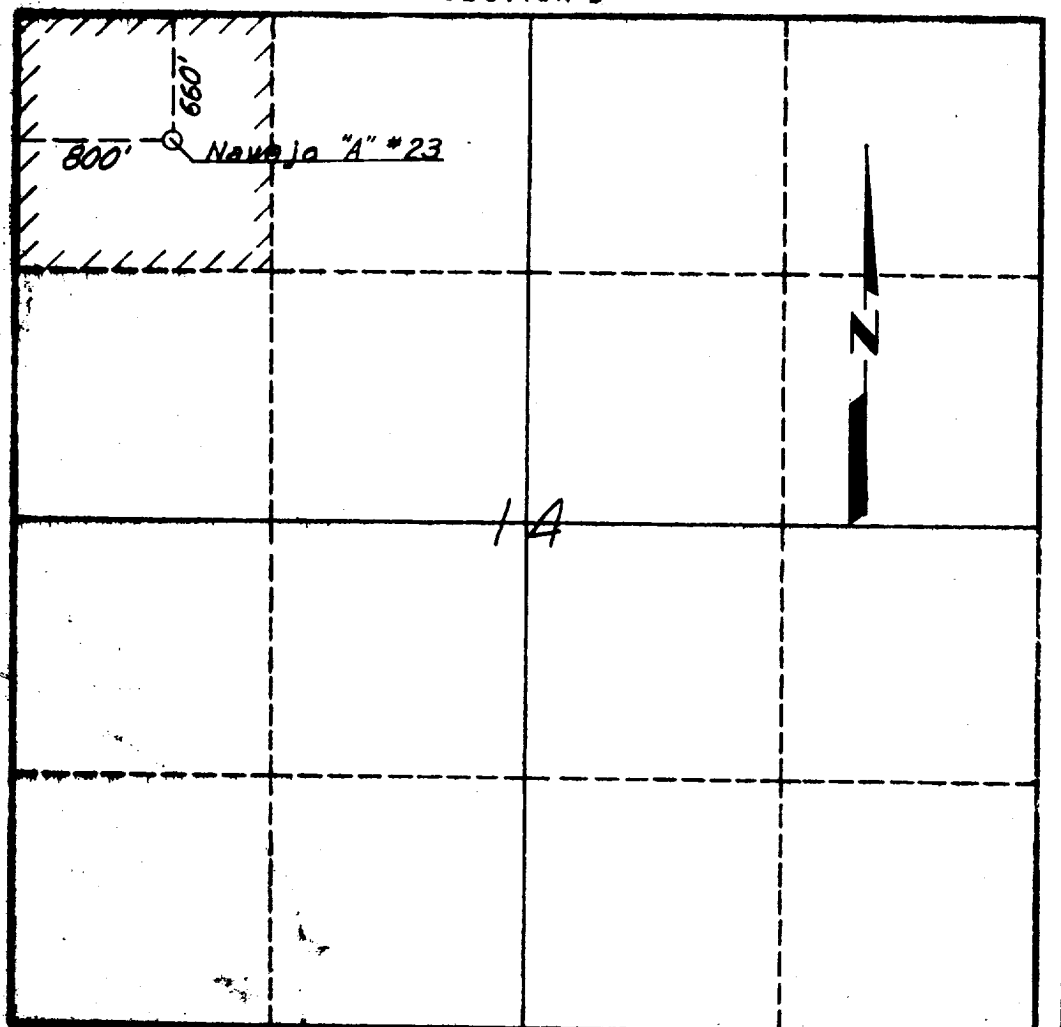

I hereby certify that the information in SECTION A above is true and complete to the best of my knowledge and belief.

Name <i>P. M. Barry</i>
Position <b>P. M. Barry</b>
Dist. Prod. Supt.
Company <b>Socony Mobil Oil Co., Inc.</b>
Date <b>LS 3330</b>

I hereby certify that the well location shown on the plat in SECTION B was plotted from field notes of actual surveys made by me or under my supervision, and that the same is true and correct to the best of my knowledge and belief.

Date Surveyed <b>7/21/60</b>
Registered Professional Engineer and/or Land Surveyor <i>Raymond L. Palmer</i>
Certificate No. <b>LS 3330</b>

0 500 1000 1500 2000 2500 3000 3500 4000 4500 5000