

(SUBMIT IN TRIPLICATE)

UNITED STATES
DEPARTMENT OF THE INTERIOR
GEOLOGICAL SURVEY

Land Office Santa Fe
Lease No. 078389-A
Unit San Juan 32-9 Unit
14-08-001-569

SUNDRY NOTICES AND REPORTS ON WELLS

| | | |
|--|-------------------------------------|--|
| NOTICE OF INTENTION TO DRILL | <input checked="" type="checkbox"/> | SUBSEQUENT REPORT OF WATER SHUT-OFF |
| NOTICE OF INTENTION TO CHANGE PLANS | | SUBSEQUENT REPORT OF SHOOTING OR ACIDIZING |
| NOTICE OF INTENTION TO TEST WATER SHUT-OFF | | SUBSEQUENT REPORT OF ALTERING CASING |
| NOTICE OF INTENTION TO RE-DRILL OR REPAIR WELL | | SUBSEQUENT REPORT OF RE-DRILLING OR REPAIR |
| NOTICE OF INTENTION TO SHOOT OR ACIDIZE | | SUBSEQUENT REPORT OF ABANDONMENT |
| NOTICE OF INTENTION TO PULL OR ALTER CASING | | SUPPLEMENTARY WELL HISTORY |
| NOTICE OF INTENTION TO ABANDON WELL | | |

(INDICATE ABOVE BY CHECK MARK NATURE OF REPORT, NOTICE, OR OTHER DATA)

May 16, 1956

Well No. 45 is located 1068 ft. from 11N line and 968 ft. from 12W line of sec. 12

SW Section 12
(1/4 Sec. and Sec. No.)

31N
(Twp.)

10W
(Range)

NMPM
(Meridian)

Blanco
(Field)

San Juan
(County or Subdivision)

New Mexico
(State or Territory)

The elevation of the derrick floor above sea level is 6308 ft.

DETAILS OF WORK

(State names of and expected depths to objective sands; show sizes, weights, and lengths of proposed casings; indicate mudding jobs, cementing points, and all other important proposed work)

It is intended to drill a well with rotary tools thru the Mesa Verde formation. Mud circulation will be used thru the Pictured Cliffs and set intermediate casing. Gas circulation will be used thru the Mesa Verde and production casing will be set. Possible productive intervals will be perforated and fractured. Est. T.D. 5541'.

Casing Program:

10 3/4" at 170' with 125 sacks cement circulated to the surface.
7 5/8" at 3420' with 250 sacks cement.
5 1/2" at 5541' with 150 sacks cement.

The W/2 of Section 12 is dedicated to this well.
(W/2) SW 078389-A.

I understand that this plan of work must receive approval in writing by the Geological Survey before operations may be commenced.

Company El Paso Natural Gas Company

Address Box 997

Farmington, New Mexico

By W. F. Cowell

Title Petroleum Engineer

NEW MEXICO
OIL CONSERVATION COMMISSION

Form 17-128

WELL LOCATION AND/OR GAS PRORATION PLAT

DATE MAY 15, 1956

OPERATOR EL PASO NATURAL GAS COMPANY SAN JUAN 32-9 UNIT SF 078389-A

WELL NO. 45 SECTION 12 TOWNSHIP 31-N RANGE 10-W NE 1/4

DEPT. 1068 FEET FROM SOUTH LINE 968 FEET FROM WEST LINE

SAN JUAN COUNTY, NEW MEXICO 6298

WELL NO. MESA VERDE BLANCO 320

(1880 PLAT)

Note: All distances must be from outer boundaries of section.

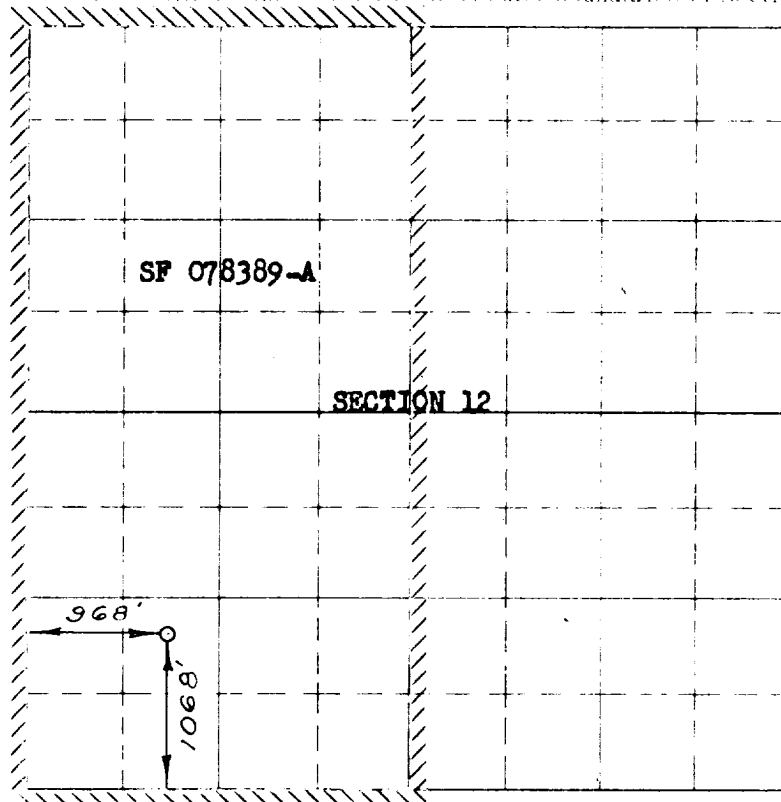

Scale 1 inches equal 1 mile

RECEIVED
MAY 15 1956
SURVEY
NEW MEXICO

NOTE

This section of
form is to be used
for gas wells only

This is to certify that the above plat was prepared from
field notes of actual surveys made by me or under my
supervision and that the same are true and correct to the
best of my knowledge and belief.

Date Surveyed FEBRUARY 6, 1956

W. F. Covert
Registered Professional Engineer and ~~Oil~~ Land Surveyor

1. Is this well a Dual ☒ Comp.

Yes _____ No _____

2. If the answer to Question 1
is yes, are there any other dually
completed wells within the
dedicated acreage.

Yes _____ No _____

Name W. F. Covert

Petroleum Engineer

Position _____

El Paso Natural Gas Co.

Representing _____

Box 997, Farmington, N.M.

Address _____

Seal

Farmington, New Mexico