

NEW MEXICO OIL CONSERVATION COMMISSION
Santa Fe, New Mexico

Form C-101
Revised (12/1/55)

NOTICE OF INTENTION TO DRILL

Notice must be given to the District Office of the Oil Conservation Commission and approval obtained before drilling or recompletion begins. If changes in the proposed plan are considered advisable, a copy of this notice showing such changes will be returned to the sender. Submit this notice in QUINTUPLICATE. One copy will be returned following approval. See additional instructions in Rules and Regulations of the Commission. If State Land submit 6 Copies Attach Form C-128 in triplicate to first 3 copies of form C-101

Midland, Texas

March 28, 1961

(Place)

(Date)

OIL CONSERVATION COMMISSION
SANTA FE, NEW MEXICO

Gentlemen:

You are hereby notified that it is our intention to commence the Drilling of a well to be known as
Adobe Oil Company

Nickels

(Company or Operator)

1

K

(Lease)

1730

West

(Unit)

1450

located.....feet from the.....line and.....feet from the

South

Line of Section 11, T. 31N, R. 13W, NMPM.

(GIVE LOCATION FROM SECTION LINE)

Basin Dakota

Pool, San Juan

County

If State Land the Oil and Gas Lease is No.....

If patented land the owner is **Ralph Nickels**

Address **Farmington, New Mexico**

We propose to drill well with drilling equipment as follows: **Rotary**

The status of plugging bond is **\$10,000.00 Blanket**

Drilling Contractor **Great Western Drilling Company**
Farmington, New Mexico

We intend to complete this well in the **Dakota**
formation at an approximate depth of **6800** feet.

CASING PROGRAM

We propose to use the following strings of Casing and to cement them as indicated:

Size of Hole	Size of Casing	Weight per Foot	New or Second Hand	Depth	Sacks Cement
11-1/4	8-5/8	24#	New	300	200
7-7/8	5-1/2	15.5 & 17	New	6800	200 / 200*

If changes in the above plans become advisable we will notify you immediately.

ADDITIONAL INFORMATION (If recompletion give full details of proposed plan of work.)

* D. V. Tool at base of Mesa Verde with 200 sacks through it.

Approved.....
Except as follows:

OIL CONSERVATION COMMISSION

By

Sincerely yours,

ADOBE OIL COMPANY

(Company or Operator)

By **A. T. Sinder**

Position **Vice President**

Send Communications regarding well to

Name **ADOBE OIL COMPANY**

Address **1223 Petroleum Life Building -
Midland, Texas**

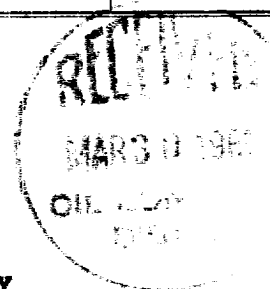

NUMBER OF COPIES RECEIVED	
DISTRIBUTION	
SANTA FE	
FILE	
U.S.G.S.	
LAND OFFICE	
TRANSPORTER	OIL GAS
PRODUCTION OFFICE	
OPERATOR	

NEW MEXICO OIL CONSERVATION COMMISSION
WELL LOCATION AND ACREAGE DEDICATION PLAT
 SEE INSTRUCTIONS FOR COMPLETING THIS FORM ON THE REVERSE SIDE

FORM C-128
 Revised 5/1/57

SECTION A

Operator ADOBE OIL COMPANY		Lease NICKELS		Well No. 1
Unit Letter K	Section 11	Township 31 NORTH	Range 13 WEST	County SAN JUAN
Actual Footage Location of Well: 1450 feet from the SOUTH line and 1730 feet from the WEST line				
Ground Level Elev. 5703.0	Producing Formation Dakota	Dedicated Acreage: 320 Acres		

Ref: GLO plat dated 9 July 1954

1. Is the Operator the only owner in the dedicated acreage outlined on the plat below? YES _____ NO **X**. ("Owner" means the person who has the right to drill into and to produce from any pool and to appropriate the production either for himself or for himself and another. (65-3-29 (e) NMSA 1935 Comp.)
2. If the answer to question one is "no," have the interests of all the owners been consolidated by communitization agreement or otherwise? YES _____ NO _____. If answer is "yes," Type of Consolidation _____
3. If the answer to question two is "no," list all the owners and their respective interests below:

Owner Consolidated Oil & Gas Company	Land Description W/2 SW/4
--	-------------------------------------

SECTION B

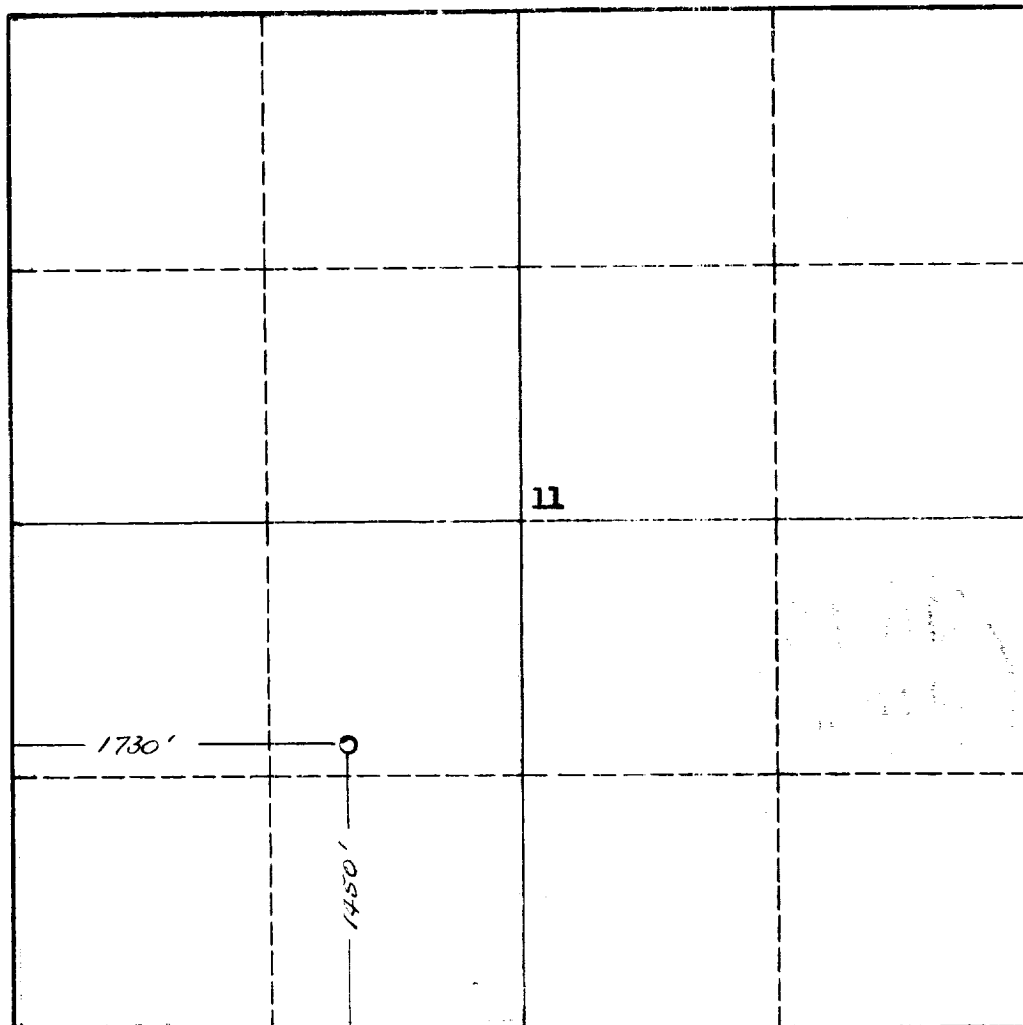

CERTIFICATION

I hereby certify that the information in SECTION A above is true and complete to the best of my knowledge and belief.

Name	A. T. Sindel
Position	Vice President
Company	Adobe Oil Company
Date	March 28, 1961

I hereby certify that the well location shown on the plat in SECTION B was plotted from field notes of actual surveys made by me or under my supervision, and that the same is true and correct to the best of my knowledge and belief.

Date Surveyed	17 March 1961
Registered Professional Engineer and/or Land Surveyor	James P. Leese
Certificate No.	1463

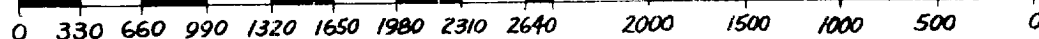

INSTRUCTIONS FOR COMPLETION OF FORM C-128

1. Operator shall furnish and certify to the information called for in Section A.
2. Operator shall outline the dedicated acreage for *both* oil and gas wells on the plat in Section B.
3. A registered professional engineer or land surveyor registered in the State of New Mexico or approved by the Commission shall show on the plat the location of the well and certify this information in the space provided.
4. All distances shown on the plat must be from the outer boundaries of the Section.
5. If additional space is needed for listing owners and their respective interests as required in question 3 of Section A, please use space below.