

(SUBMIT IN TRIPLICATE)

Indian Agency Navajo

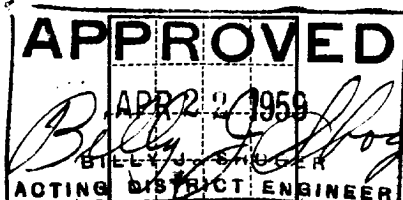

UNITED STATES  
DEPARTMENT OF THE INTERIOR  
GEOLOGICAL SURVEY

Allottee \_\_\_\_\_  
Lease No. 14-80-003-0053  
Co. Loc. No. 234970

See Attached Plate

SUNDRY NOTICES AND REPORTS ON WELLS

NOTICE OF INTENTION TO DRILL	<input checked="" type="checkbox"/>	SUBSEQUENT REPORT OF WATER SHUT-OFF	
NOTICE OF INTENTION TO CHANGE PLANS		SUBSEQUENT REPORT OF SHOOTING OR ACIDIZING	
NOTICE OF INTENTION TO TEST WATER SHUT-OFF		SUBSEQUENT REPORT OF ALTERING CASING	
NOTICE OF INTENTION TO REDRILL OR REPAIR WELL		SUBSEQUENT REPORT OF REDRILLING OR REPAIR	
NOTICE OF INTENTION TO SHOOT OR ACIDIZE		SUBSEQUENT REPORT OF ABANDONMENT	
NOTICE OF INTENTION TO PULL OR ALTER CASING		SUPPLEMENTARY WELL HISTORY	
NOTICE OF INTENTION TO ABANDON WELL			

RECEIVED

APR 22 1959

GEOLOGICAL SURVEY  
FORT WORTH, TEXAS

(INDICATE ABOVE BY CHECK MARK NATURE OF REPORT, NOTICE, OR OTHER DATA)

Navajo Tribe of Indians "O"

April 18, 1959

Well No. 1 is located 300 ft. from S line and 1900 ft. from E line of sec. 11  
SW/4 SW/4 11 31-N 17-W RPM  
(1/4 Sec. and Sec. No.) (Twp.) (Range) (Meridian)  
Garfield San Juan New Mexico  
(Field) (County or Subdivision) (State or Territory)

The elevation of the derrick floor above sea level is later ft.

DETAILS OF WORK

(State names of and expected depths to objective sands; show sizes, weights, and lengths of proposed casings; indicate mudding jobs, cementing points, and all other important proposed work)

CASING PROGRAM			CEMENT PROGRAM	COSING PROGRAM
Size	Wt.	Depth		
7"	22#	35'	Circulate to surface.	Bone
6"	14#	1300'	Sufficient volume to cement at least 500' above pay zone.	

Completion Method: Sand oil fracture with 20,000 gal oil and 30,000 gal water.  
Halliburton method of cementing to be used.  
Proposed total depth 1300' to test Gallup.



I understand that this plan of work must receive approval in writing by the Geological Survey before operations may be commenced.

Company Humble Oil & Refining Co.

Address Box 1800

Midland, Texas

Ok as

By B. P. Guntan  
Asst. Div. Chief Clerk  
Title \_\_\_\_\_

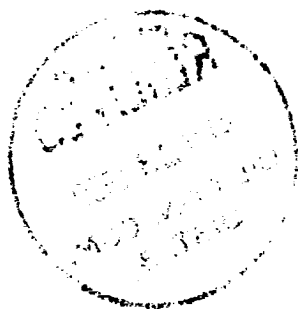

NEW MEXICO OIL CONSERVATION COMMISSION  
Well Location and Acreage Dedication Plat

Section A.

Date 4-15-59

Operator HUMBLE OIL & REFG. CO Lease Navajo Tribe of Indians "G"  
Well No. 1 Unit Letter "N" Section 11 Township 31-N Range 17-W NMPM  
located 500 Feet From South Line, 1980 Feet From West Line  
County San Juan G. L. Elevation \_\_\_\_\_ Dedicated Acreage 40 Acres  
Name of Producing Formation Gallup Sand Pool Chimney Rock

1. Is the Operator the only owner\* in the dedicated acreage outlined on the plat below?  
Yes ✓ No \_\_\_\_\_.
2. If the answer to question one is "no," have the interests of all the owners been consolidated by communitization agreement or otherwise? Yes \_\_\_\_\_ No \_\_\_\_\_. If answer is "yes," Type of Consolidation \_\_\_\_\_
3. If the answer to question two is "no," list all the owners and their respective interests below:

Owner

Land Description

Section B

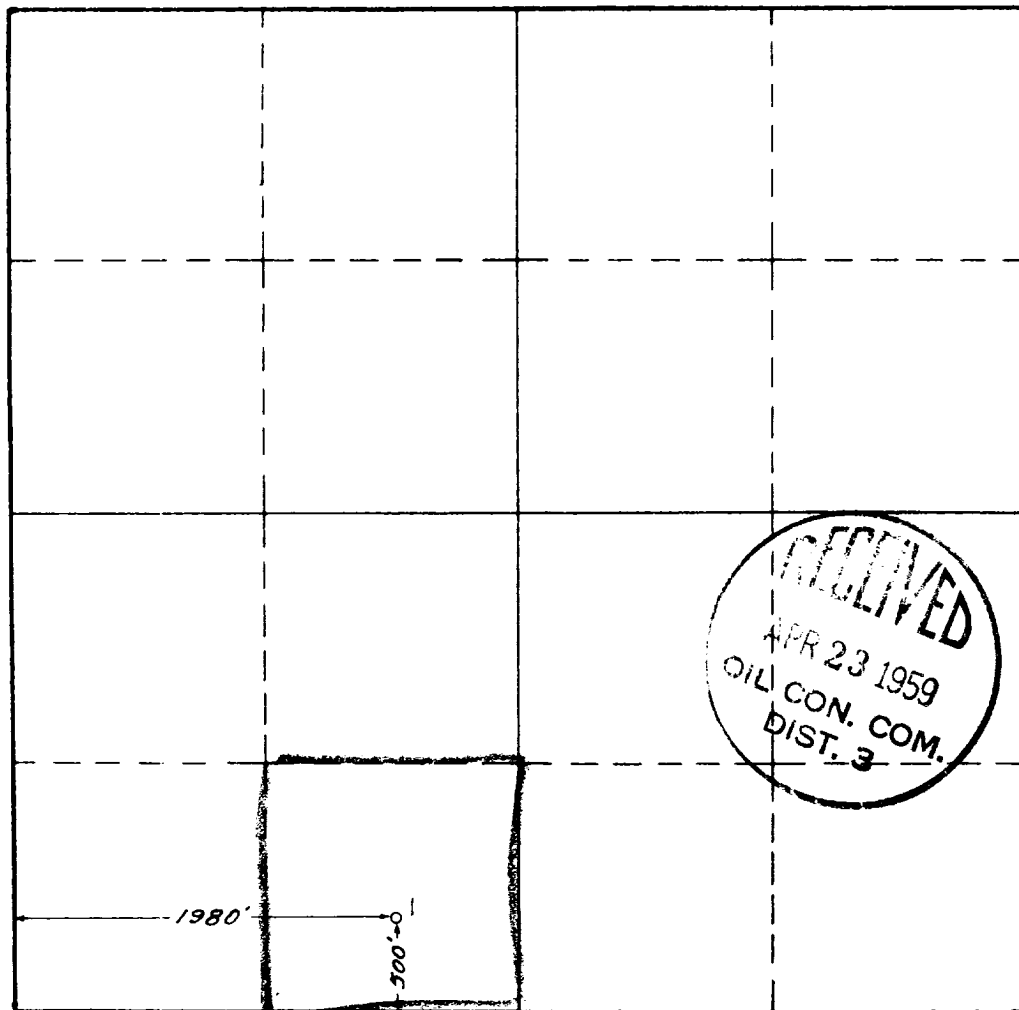

This is to certify that the information in Section A above is true and complete to the best of my knowledge and belief.

HUMBLE OIL & REFG. CO  
(Operator)

H. L. Henoley  
(Representative)  
Assistant Division Supt.  
Box 1600 Midland, Texas  
Address

This is to certify that the well location shown on the plat in Section B was plotted from field notes of actual surveys made by me or under my supervision and that the same is true and correct to the best of my knowledge and belief.

Date Surveyed 4-9-59

H. S. Hunterfield  
Registered Professional  
Engineer and/or Land Surveyor.

Certificate No. 1382

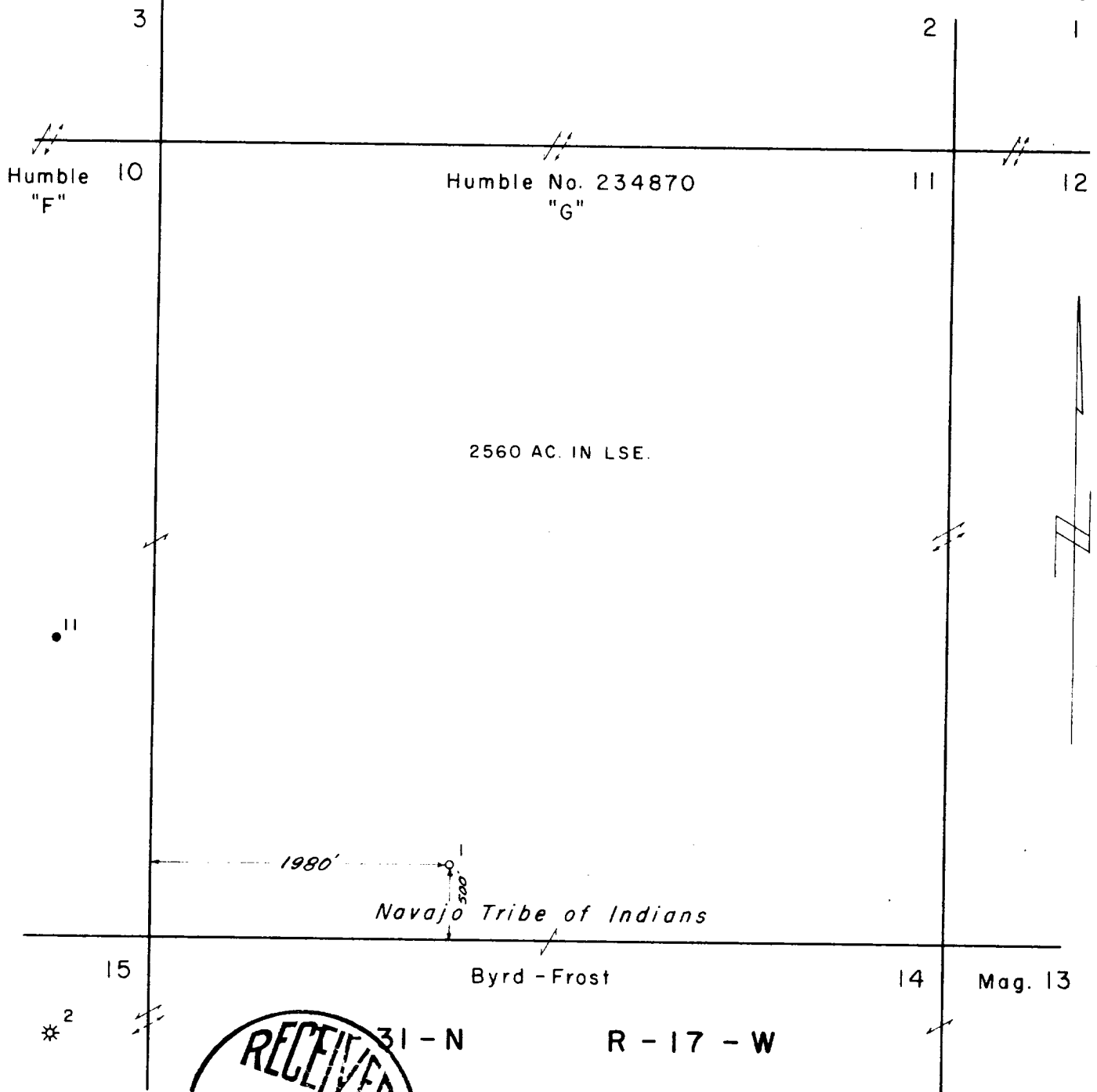

NAVAJO TRIBE OF INDIANS "G" LSE. NO. 234870  
SEC. 1, 2, 11, & 12, T-31-N, R-17-W, N.M.P.M.  
SAN JUAN CO., NEW MEXICO

HUMBLE OIL & REFINING COMPANY  
PRODUCTION DEPARTMENT  
MIDLAND, TEXAS

CIVIL ENG. DIV.

SCALE 1" = 1000'

PRIMARY DESIGN BY

D. V. SWENSON

DATE 4-15-59

DRAWN BY

CHECKED BY

APPROVED BY

REVISED

CIVIL ENG. DIV.  
FILE NO.

W-A 2662

14 Apr. 59  
H. S. Wisterfeld