

(SUBMIT IN TRIPLICATE)

UNITED STATES
DEPARTMENT OF THE INTERIOR
GEOLOGICAL SURVEY

Land Office Santa Fe
Lease No. 078095
Unit Case

SUNDRY NOTICES AND REPORTS ON WELLS

RECEIVED

NOTICE OF INTENTION TO DRILL.....	<input checked="" type="checkbox"/>	SUBSEQUENT REPORT OF WATER SHUT-OFF.....	
NOTICE OF INTENTION TO CHANGE PLANS.....		SUBSEQUENT REPORT OF SHOOTING OR ACIDIZING.....	
NOTICE OF INTENTION TO TEST WATER SHUT-OFF.....		SUBSEQUENT REPORT OF ALTERING CASING.....	
NOTICE OF INTENTION TO RE-DRILL OR REPAIR WELL.....		SUBSEQUENT REPORT OF RE-DRILLING OR REPAIR.....	
NOTICE OF INTENTION TO SHOOT OR ACIDIZE.....		SUBSEQUENT REPORT OF ABANDONMENT.....	
NOTICE OF INTENTION TO PULL OR ALTER CASING.....		SUPPLEMENTARY WELL HISTORY.....	
NOTICE OF INTENTION TO ABANDON WELL.....			

(INDICATE ABOVE BY CHECK MARK NATURE OF REPORT, NOTICE, OR OTHER DATA)

July 28, 1961

Well No. 9 is located 1680 ft. from XXX line and 1520 ft. from W line of sec. 8

S.W. Section 8

(1/4 Sec. and Sec. No.)

31-N

(Twp.)

11-W

(Range)

N.M.P.M.

(Meridian)

Basin Dakota

(Field)

San Juan

(County or Subdivision)

New Mexico

(State or Territory)

The elevation of the derrick floor above sea level is 6147 ft.

DETAILS OF WORK

(State names of and expected depths to objective sands; show sizes, weights, and lengths of proposed casings; indicate mudding, cementing points, and all other important proposed work)

It is intended to drill a well with rotary tools thru the Dakota formation. Mud circulation will be used thru the Pictured Cliffs & 7 5/8" intermediate casing will be set. Gas circulation will be used thru the middle of the Greenhorn & 5 1/2" intermediate production casing will be set. Gas circulation will be used to drill thru the Dakota and 4" production liner will be set. Est. T.D. 7466'.

Casing Program:

- 10 3/4" set at 280' with 220 sks cement circulated to surface.
- 7 5/8" set at 2900' with 290 sacks cement - 100% to circulate
- 5 1/2" set at 7090' with 470 sks cement - 200% to fill to 7 5/8" casing shoe.
- 4" set at 7466' with 50 sks cement - 360% to cover liner top.

The W/2 of Section 8 is dedicated to this well.

I understand that this plan of work must receive approval in writing by the Geological Survey before operations may be commenced.

Company El Paso Natural Gas Company

Address Box 990

Farmington, New Mexico

By Original Signed D. W. Meehan

Title Petroleum Engineer

NEW MEXICO OIL CONSERVATION COMMISSION

Well Location and Acreage Dedication Plat

Section A.

Date **JULY 27, 1961**

Operator **EL PASO NATURAL GAS COMPANY** Lease **CASE** **SF 078095**
 Well No. **9** Unit Letter **K** Section **8** Township **31-N** Range **11-W** NMPM
 Located **1680** Feet From **SOUTH** Line **1520** Feet From **WEST** Line
 County **SAN JUAN** G. L. Elevation **6137** Dedicated Acreage **320** Acres
 Name of Producing Formation **DAKOTA** Pool **BASIN DAKOTA**

1. Is the Operator the only owner in the dedicated acreage outlined on the plat below?
 Yes ☒ No ☐
2. If the answer to question one is "no", have the interests of all the owners been consolidated by communitization agreement or otherwise? Yes ☐ No ☐ If answer is "yes", Type of Consolidation.

3. If the answer to question two is "no", list all the owners and their respective interests below:

Owner

Land Description



Section B.

This is to certify that the information in Section A above is true and complete to the best of my knowledge and belief.

El Paso Natural Gas Company
 (Operator)

Original Signed **D. W. Meehan**
 (Representative)

Box 977
 (Address)

Farmington, New Mexico

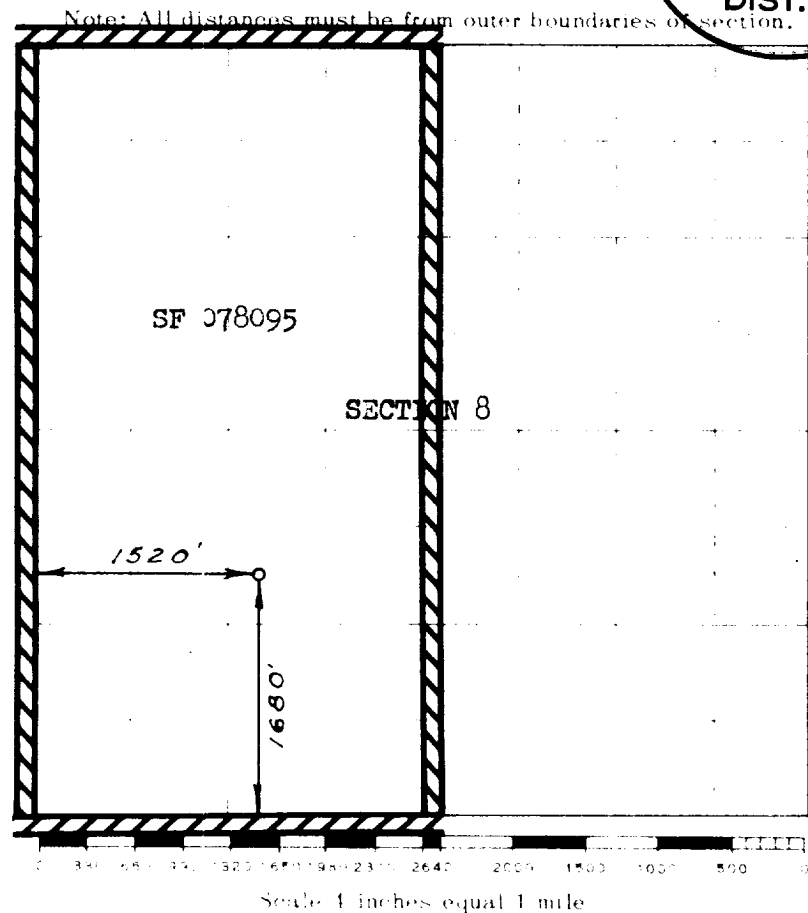

This is to certify that the above plat was prepared from field notes of actual surveys made by me or under my supervision and that the same are true and correct to the best of my knowledge and belief.

(Seal)

Date Surveyed **JULY 20, 1961**

W. A. C. C. C.
 Registered Professional Engineer and/or Land Surveyor

Farmington, New Mexico