

Form 9-331b  
(April 1952)

(SUBMIT IN TRIPLICATE)

Indian Agency Navajo

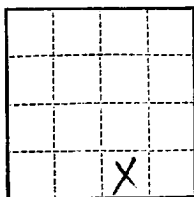

UNITED STATES  
DEPARTMENT OF THE INTERIOR  
GEOLOGICAL SURVEY

Allottee \_\_\_\_\_

Lease No. 14-20-003-2033  
Co. Loc. 234970

See Attached Plat

SUNDRY NOTICES AND REPORTS ON WELLS

NOTICE OF INTENTION TO DRILL	<input checked="" type="checkbox"/>	SUBSEQUENT REPORT OF WATER SHUT-OFF	
NOTICE OF INTENTION TO CHANGE PLANS		SUBSEQUENT REPORT OF SHOOTING OR ACIDIZING	
NOTICE OF INTENTION TO TEST WATER SHUT-OFF		SUBSEQUENT REPORT OF ALTERING CASING	
NOTICE OF INTENTION TO REDRILL OR REPAIR WELL		SUBSEQUENT REPORT OF REDRILLING OR REPAIR	
NOTICE OF INTENTION TO SHOOT OR ACIDIZE		SUBSEQUENT REPORT OF ABANDONMENT	
NOTICE OF INTENTION TO PULL OR ALTER CASING		SUPPLEMENTARY WELL HISTORY	
NOTICE OF INTENTION TO ABANDON WELL			

(INDICATE ABOVE BY CHECK MARK NATURE OF REPORT, NOTICE, OR OTHER DATA)

Navajo Tribe of Indians

July 17, 1959

Well No. 5 is located 736 ft. from S line and 2045 ft. from E line of sec. 11

SW/4 of SE/4 11 31-N 17-W RECEIVED  
(1/4 Sec. and Sec. No.) (Twp.) (Range) (Meridian)  
Chimney Rock Gallup San Juan New Mexico 1959  
(Field) (County or Subdivision) (State or Territory)

The elevation of the derrick floor above sea level is later ft.

DETAILS OF WORK

(State names of and expected depths to objective sands; show sizes, weights, and lengths of proposed casings; indicate mudding jobs, cementing points, and all other important proposed work)

CASING PROGRAM			CEMENT PROGRAM	CORING PROGRAM
Size	Wt.	Depth		
7-5/8"	28.4#	25'	Circulate to surface.	None
5"	18#	1100'	Sufficient volume to cement at least 500' above pay zone.	

Completion Method: Sand oil fracture with 20,000 gal oil & 20,000 gal water.  
Halliburton method of cementing to be used.  
Proposed total depth 1100' to test Gallup.

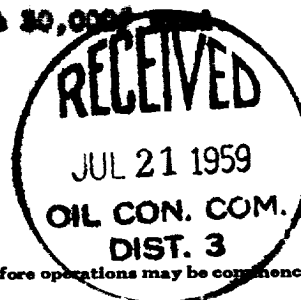

I understand that this plan of work must receive approval in writing by the Geological Survey before operations may be commenced.

Company Rumble Oil & Refining Co.  
Box 1600  
Address Midland, Texas

By [Signature]  
Title Division Administrator

NEW MEXICO OIL CONSERVATION COMMISSION

Well Location and Acreage Dedication Plat

Section A.

Date July 17, 1959

Operator HUMBLE OIL & REFG. CO Lease Navajo Tribe of Indians "G"  
Well No. 5 Unit Letter "O" Section 11 Township 31 North Range 17 West NMPM  
located 736 Feet From South Line, 2045 Feet From East Line  
County San Juan G. L. Elevation \_\_\_\_\_ Dedicated Acreage 90 Acres  
Name of Producing Formation Gallup Sand Pool Chimney Rock

1. Is the Operator the only owner\* in the dedicated acreage outlined on the plat below?  
Yes ☒ No ☐.
2. If the answer to question one is "no," have the interests of all the owners been consolidated by communitization agreement or otherwise? Yes ☐ No ☐. If answer is "yes," Type of Consolidation \_\_\_\_\_
3. If the answer to question two is "no," list all the owners and their respective interests below:

Owner

Land Description

Section B

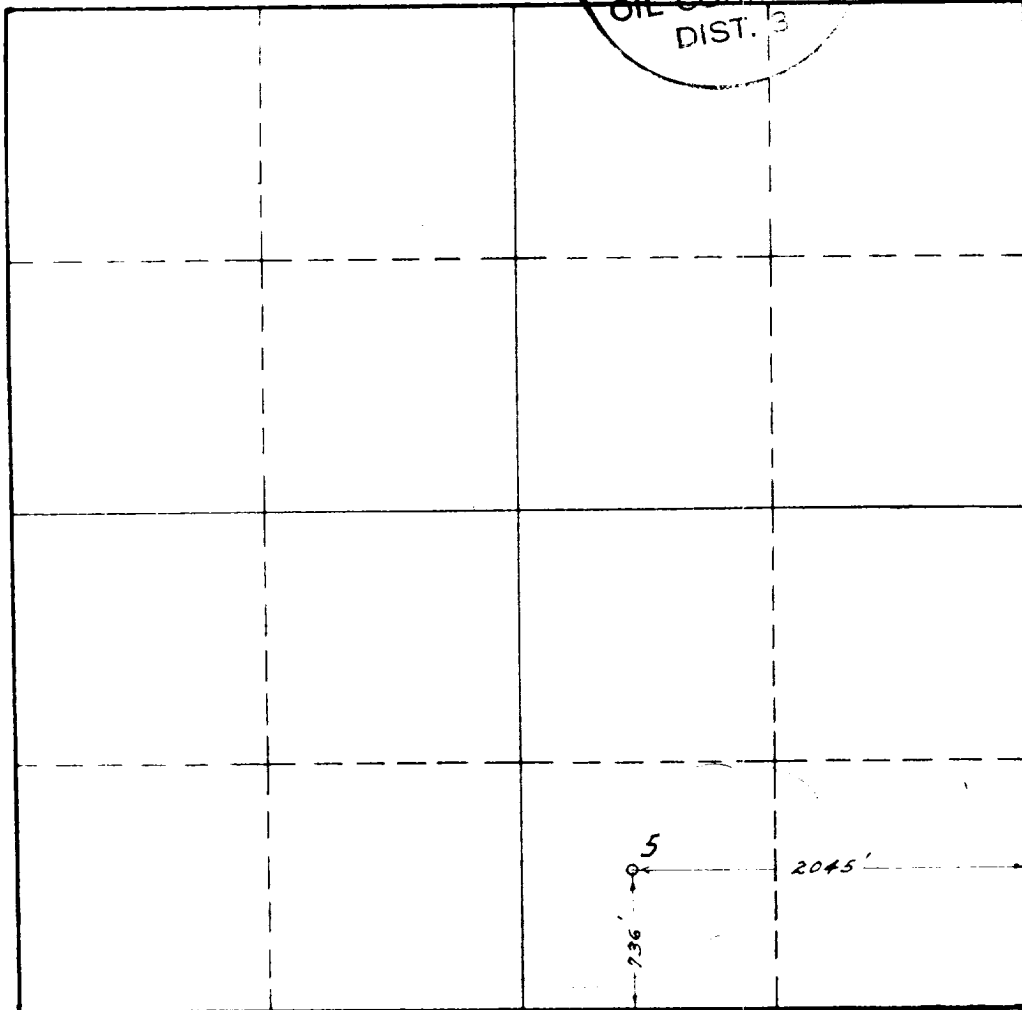

0 330 660 990 1320 1650 1980 2310 2640 2000 1500 1000 500 0

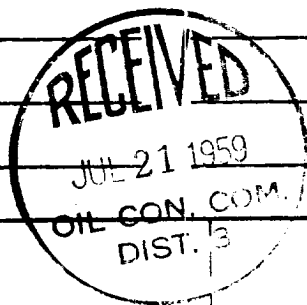

RECEIVED

JUL 23 1959

U. S. GEOLOGICAL SURVEY  
FARMINGTON, N. M.

This is to certify that the information in Section A above is true and complete to the best of my knowledge and belief.

HUMBLE OIL & REFG. CO  
(Operator)

H. L. Henoley  
(Representative)

Assistant Division Supt.  
Box 1600 Midland, Texas  
Address

This is to certify that the well location shown on the plat in Section B was plotted from field notes of actual surveys made by me or under my supervision and that the same is true and correct to the best of my knowledge and belief.

Date Surveyed 4-8-59

W. S. Westfield  
Registered Professional  
Engineer and/or Land Surveyor.

Certificate No. 1382