

(SUBMIT IN TRIPLICATE)

Indian Agency Navajo

UNITED STATES
DEPARTMENT OF THE INTERIOR
GEOLOGICAL SURVEY

Allottee _____

Lease No. 14-30-603-2034
Co. Lee 234371

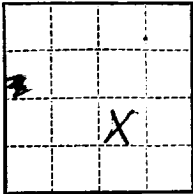

See Attached Plat

SUNDRY NOTICES AND REPORTS ON WELLS

NOTICE OF INTENTION TO DRILL _____	<input checked="" type="checkbox"/> SUBSEQUENT REPORT OF WATER SHUT-OFF _____
NOTICE OF INTENTION TO CHANGE PLANS _____	SUBSEQUENT REPORT OF SHOOTING OR ACIDIZING _____
NOTICE OF INTENTION TO TEST WATER SHUT-OFF _____	SUBSEQUENT REPORT OF ALTERING CASING _____
NOTICE OF INTENTION TO REDRILL OR REPAIR WELL _____	SUBSEQUENT REPORT OF REDRILLING OR REPAIR _____
NOTICE OF INTENTION TO SHOOT OR ACIDIZE _____	SUBSEQUENT REPORT OF ABANDONMENT _____
NOTICE OF INTENTION TO PULL OR ALTER CASING _____	SUPPLEMENTARY WELL HISTORY _____
NOTICE OF INTENTION TO ABANDON WELL _____	

(INDICATE ABOVE BY CHECK MARK NATURE OF REPORT, NOTICE, OR OTHER DATA)

Navajo Tribe of Indians P

July 17, 19 59

Well No. 41 is located 1500 ft. from TXK line and 2000 ft. from RECEIVED line of sec. 10

10
(1/4 Sec. and Sec. No.)

31-N
(Twp.)

17-W
(Range)

NEW MEXICO
(Meridian)

Chimney Rock Gallup
(Field)

San Juan

(County or Subdivision)

New Mexico

U.S. GEOLOGICAL SURVEY
(State or Territory) NEW MEXICO
FARMING

The elevation of the derrick floor above sea level is 1200 ft.

DETAILS OF WORK

(State names of and expected depths to objective sands; show sizes, weights, and lengths of proposed casings; indicate mudding jobs, cementing points, and all other important proposed work)

CASING PROGRAM

Size	Wt.	Depth
7-5/8"	26.4#	35'
5"	10#	1100'

CEMENT PROGRAM

Circulate to surface.
Sufficient volume to cement at least
500' above pay zone.

COMING PROGRAM

None

Completion Method: Sand oil fracture with 20,000 gal oil & 30,000 gal cement.
Halliburton method of cementing to be used.
Proposed total depth 1100' to test Gallup.



I understand that this plan of work must receive approval in writing by the Geological Survey before operations may be commenced.

Humble Oil & Refining Co.

Company _____

Box 1800

Address _____

Midland, Texas

By _____

Title Division Administrator

NEW MEXICO OIL CONSERVATION COMMISSION

Well Location and Acreage Dedication Plat

Section A.

Date July 17, 1959

Operator HUMBLE OIL & REFG. CO Lease Navajo Tribe of Indians "F"
Well No. 41 Unit Letter "J" Section 10 Township 31 North Range 17 West NMPM
located 2080 Feet From East Line, 1980 Feet From South Line
County San Juan G. L. Elevation _____ Dedicated Acreage 40 Acres
Name of Producing Formation Gallup Sand Pool Chimney Rock

1. Is the Operator the only owner* in the dedicated acreage outlined on the plat below?
Yes ☒ No ☐.
2. If the answer to question one is "no," have the interests of all the owners been consolidated by communitization agreement or otherwise? Yes ☐ No ☐. If answer is "yes," Type of Consolidation _____
3. If the answer to question two is "no," list all the owners and their respective interests below:

Owner

Land Description

RECEIVED

JUL 21 1959

OIL CON
DIST

RECEIVED

U. S. GEOLOGICAL SURVEY
FARMINGTON, NEW MEXICO

Section B

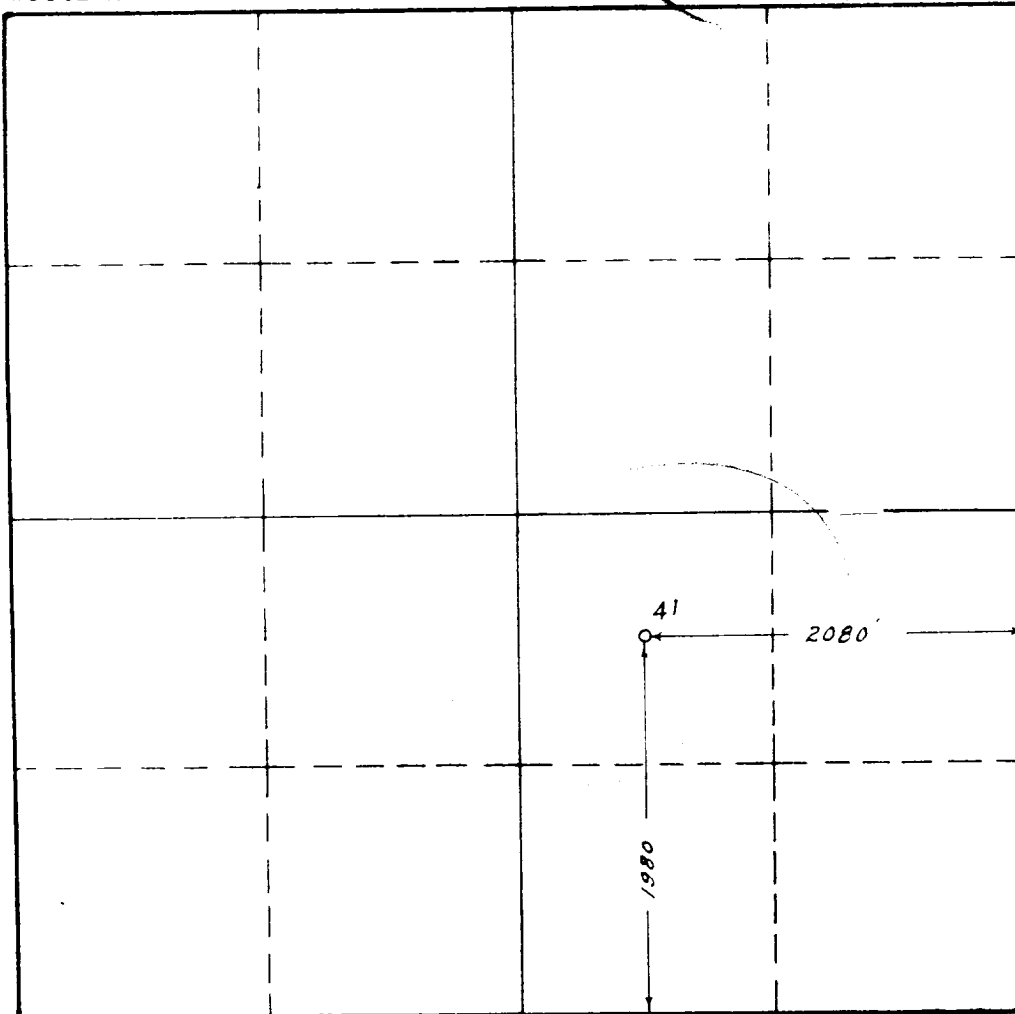

This is to certify that the information in Section A above is true and complete to the best of my knowledge and belief.

HUMBLE OIL & REFG. CO
(Operator)

H. E. Hensley
(Representative)

Assistant Division Supt.
Box 1600 Midland, Texas
Address

This is to certify that the well location shown on the plat in Section B was plotted from field notes of actual surveys made by me or under my supervision and that the same is true and correct to the best of my knowledge and belief.

Date Surveyed 2-18-59

W. S. Hunterfeld
Registered Professional
Engineer and/or Land Surveyor.

0 330 660 990 1320 1650 1980 2310 2640 2000 1500 1000 500 0

Certificate No. 1382