

NEW MEXICO OIL CONSERVATION COMMISSION
Santa Fe, New Mexico

NOTICE OF INTENTION TO DRILL OR RECOMPLETE

Notice must be given to the District Office of the Oil Conservation Commission and approval obtained before drilling or recompletion begins. If changes in the proposed plan are considered advisable, a copy of this notice showing such changes will be returned to the sender. Submit this notice in **QUINTUPLICATE**. One copy will be returned following approval. See additional instructions in Rules and Regulations of the Commission.

Farmington, New Mexico
(Place)

August 19, 1953
(Date)

OIL CONSERVATION COMMISSION
SANTA FE, NEW MEXICO

Gentlemen:

You are hereby notified that it is our intention to commence the (Drilling) (Recompletion) of a well to be known as

El Paso Natural Gas Company
(Company or Operator)

Marcote Pool Unit
(Lease)

Well No. 1, in E₂ (Unit)

located 1650 feet from the North line and 1650 feet from the

East line of Section 8, T. 31N, R. 10W, NMPM.

(GIVE LOCATION FROM SECTION LINE) Blanco Pool, San Juan County

D	C	B	A
E	F	E	H
L	K	J	I
M	N	O	P

If State Land the Oil and Gas Lease is No.

If patented land the owner is Beaver Lodge Oil Corporation

Address Mercantile Commerce Building, Dallas, Texas

We propose to drill well with drilling equipment as follows: cable tools to 172',
rotary tools to total depth.

The status of plugging bond is Statewide.

Drilling Contractor Carroll Drilling Company

We intend to complete this well in the Mesaverde
formation at an approximate depth of 5052'

CASING PROGRAM

We propose to use the following strings of Casing and to cement them as indicated:

Size of Hole	Size of Casing	Weight per Foot	New or Second Hand	Depth	Sacks Cement
<u>13-3/4</u>	<u>9-5/8</u>	<u>25.4</u>	<u>New</u>	<u>172'</u>	<u>125</u>
<u>8-3/4</u>	<u>7"</u>	<u>23# & 20#</u>	<u>New</u>	<u>4308'</u>	<u>500</u>

If changes in the above plans become advisable we will notify you immediately.

ADDITIONAL INFORMATION (If recompletion give full details of proposed plan of work.)

The Mesaverde will be drilled with gas circulation and shot with two quarts of S.N.G. per ft.

The E₂ of Section 8 is dedicated to this well.

(OVER)

Approved 8-25, 1953
Except as follows:

Sincerely yours,

EL PASO NATURAL GAS COMPANY
(Company or Operator)

By Carroll Drilling Company

Position Petroleum Engineer

Said Company's relations regarding well to

Name Box 997 Farmington, New Mexico

Address

OIL CONSERVATION COMMISSION

By Original Signed Emery C. Arnold

Title Oil and Gas Inspector Dist. #3.

Communitization will be filed with the following lease holders as soon as possible:

SW $\frac{1}{4}$, SE $\frac{1}{4}$, NE $\frac{1}{4}$, SE $\frac{1}{4}$, Section 8 - T-31N R-10W Brookhaven Oil Company
First National Bank Bldg.
Albuquerque, New Mexico

NW $\frac{1}{4}$, NE $\frac{1}{4}$ Section 8 T-31N R-10W Beaver Lodge Oil Corporation
Mercantile Commerce Bldg. Dallas, Texas

E $\frac{1}{2}$, NE $\frac{1}{4}$, E $\frac{1}{2}$, SW $\frac{1}{4}$, NE $\frac{1}{4}$ Section 8 T-31N R-10W Beaver Lodge Oil Corporation.

1 ac in E $\frac{1}{2}$, SW $\frac{1}{4}$, NE $\frac{1}{4}$ Section 8 T-31N R-10W Beaver Lodge Oil Corporation.

Portion of right-of-way of Denver & Rio Grande Western Railroad Co. in extreme
North westerly corner of NW $\frac{1}{4}$, NW $\frac{1}{4}$, NE $\frac{1}{4}$ Section 8 T-31N R-10W Beaver Lodge Oil Corporation.

W $\frac{1}{2}$, SW $\frac{1}{4}$, NE $\frac{1}{4}$ Section 8 T-31N R-10W Delhi Oil Corporation, Corrigan Tower, Dallas, Texas.

SE $\frac{1}{4}$, SE $\frac{1}{4}$ Section 8 T-31N R-10W Saul A. Yager, 613 Oil Capitol Building, Tulsa, Oklahoma.
Mariel Yager c/o C.H. Rosenstein, McBirney Building, Tulsa, Oklahoma.
M.E. Gimp c/o Zales Jewelry Co., 1606 Main St. Dallas, Texas.
Sam Mizel, 101 W. Cammeron St. Tulsa, Oklahoma.

OIL CONSERVATION COMMISSION		
AZTEC DISTRICT OFFICE		
No. Copies Received		
DISTRIBUTION		
	NO. FURNISHED TO	
Operator		
Santa Fe		
Production Office		
Engineering Office		
J. E. C. S.		
Transporter		
File		

COMPANY EL PASO NATURAL GAS COMPANY

Well Name & No. Marcote Pool Unit NO. 1 Lease No. TEE

Location 1650 ft. from the North Line 1650 ft. from the East Line

Being in SW/4 of the NE/4

Sec. 8, T31N., R10W., N.M.P.M., San Juan County, New Mexico

Ground Elevation 5847.62

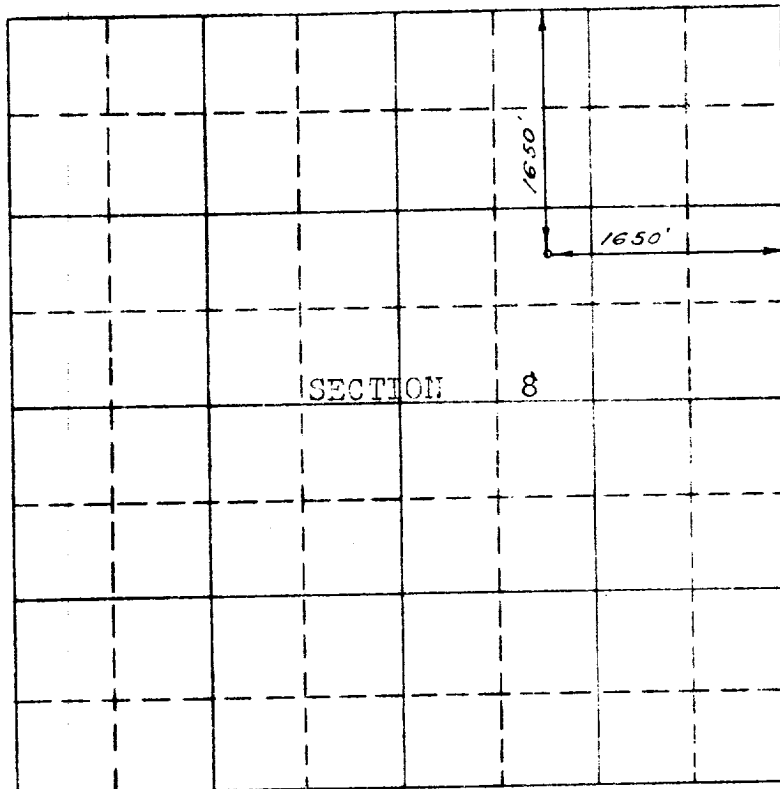

Scale -- 4 inches equals 1 mile

Surveyed January 21, 19 53

This is to certify that the above plat was prepared from field notes of actual surveys made by me or under my supervision and that the same are true and correct to the best of my knowledge and belief.

C. O. Walker

Registered Professional
Engineer and Land Surveyor.

Seal:

Farmington, New Mexico

OIL CONSERVATION COMMISSION
 AZTEC DISTRICT OFFICE

No. Copies Received 7

DISTRIBUTION

	NO. FURNISHED	
Operator		
Santa Fe	1	
Protraction Office	1	
State Land Office		
U. S. G. S.	1	
Transporter	2	
File	1	
		1