

(SUBMIT IN TRIPLICATE)

UNITED STATES
DEPARTMENT OF THE INTERIOR
GEOLOGICAL SURVEY

Indian Agency _____

Navajo Tribal

Allottee _____

Lease No. _____

Contr#14-20-600-3230

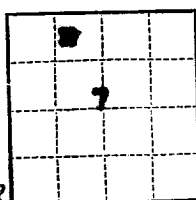

SUNDRY NOTICES AND REPORTS ON WELLS

NOTICE OF INTENTION TO DRILL	<input checked="" type="checkbox"/>	SUBSEQUENT REPORT OF WATER SHUT-OFF
NOTICE OF INTENTION TO CHANGE PLANS	<input type="checkbox"/>	SUBSEQUENT REPORT OF SHOOTING OR ACIDIZING
NOTICE OF INTENTION TO TEST WATER SHUT-OFF	<input type="checkbox"/>	SUBSEQUENT REPORT OF ALTERING CASING
NOTICE OF INTENTION TO REDRILL OR REPAIR WELL	<input type="checkbox"/>	SUBSEQUENT REPORT OF REDRILLING OR REPAIR
NOTICE OF INTENTION TO SHOOT OR ACIDIZE	<input type="checkbox"/>	SUBSEQUENT REPORT OF ABANDONMENT
NOTICE OF INTENTION TO PULL OR ALTER CASING	<input type="checkbox"/>	SUPPLEMENTARY WELL HISTORY
NOTICE OF INTENTION TO ABANDON WELL	<input type="checkbox"/>	

RECEIVED
AUG 28 1963
U. S. GEOLOGICAL SURVEY
FARMINGTON, NEW MEXICO

(INDICATE ABOVE BY CHECK MARK NATURE OF REPORT, NOTICE, OR OTHER DATA)

August 27, 1963

Chimney Rock
Well No. **21-7** is located **980** ft. from **[N]** line and **1654** ft. from **[W]** line of sec. **7**

SW 1/4 Sec. 7 **31N** **16W** **NMPM**
(1/4 Sec. and Sec. No.) (Twp.) (Range) (Meridian)

Many Archaes **San Juan** **New Mexico**
(Field) (County or Subdivision) (State or Territory)

The elevation of the **land surface** above sea level is **5427** ft.

DETAILS OF WORK

(State names of and expected depths to objective sands; show sizes, weights, and lengths of proposed casings; indicate mudlogging jobs, cementing points, and all other important proposed work)

RECEIVED
AUG 29 1963
OIL CON. COM.
DIST. 3

It is intended to drill a **Junna Lopez** well as follows:

1. Drill 13 3/4" hole to 100' and set 9 5/8" csg. Test to 600 PSI.
2. Drill 7 7/8" hole to 1340' with air. Note all oil and gas shows. Cement 5 1/2" csg. Bring Cement above 1030' and press. test to 1000 PSI.
3. Perf. and free. as necessary.
4. Run rods, tubing and pump and put on production.

I understand that this plan of work must receive approval in writing by the Geological Survey before operations may be commenced.

Company **Security Mobil Oil Company, Inc.**

Address **P. O. Box 3371**

Durango, Colorado

By **M. J. Meyer**

Title **Sr. Prod. Foreman**

NEW MEXICO OIL CONSERVATION COMMISSION

FORM C-128
Revised 5/1/57

WELL LOCATION AND ACREAGE DEDICATION PLAT

SEE INSTRUCTIONS FOR COMPLETING THIS FORM ON THE REVERSE SIDE

SECTION A

Operator Socony Mobil Oil Company, Inc.		Lease Chimney Rock		Well No. 21-7
Unit Letter C	Section 7	Township 31N	Range 16W	County San Juan
Actual Footage Location of Well: 980 feet from the North line and 1654 feet from the West line				
Ground Level Elev. 5427'	Producing Formation Gallup		Pool Many Rocks	Dedicated Acreage: 40 Acres

1. Is the Operator the only owner in the dedicated acreage outlined on the plat below? YES X NO ____ . ("Owner" means the person who has the right to drill into and to produce from any pool and to appropriate the production either for himself or for himself and another. (65-3-29 (e) NMSA 1935 Comp.)
2. If the answer to question one is "no," have the interests of all the owners been consolidated by communitization agreement or otherwise? YES ____ NO ____ . If answer is "yes," Type of Consolidation ____
3. If the answer to question two is "no," list all the owners and their respective interests below:

Owner	Land Description

RECEIVED

AUG 28 1963

SECTION B

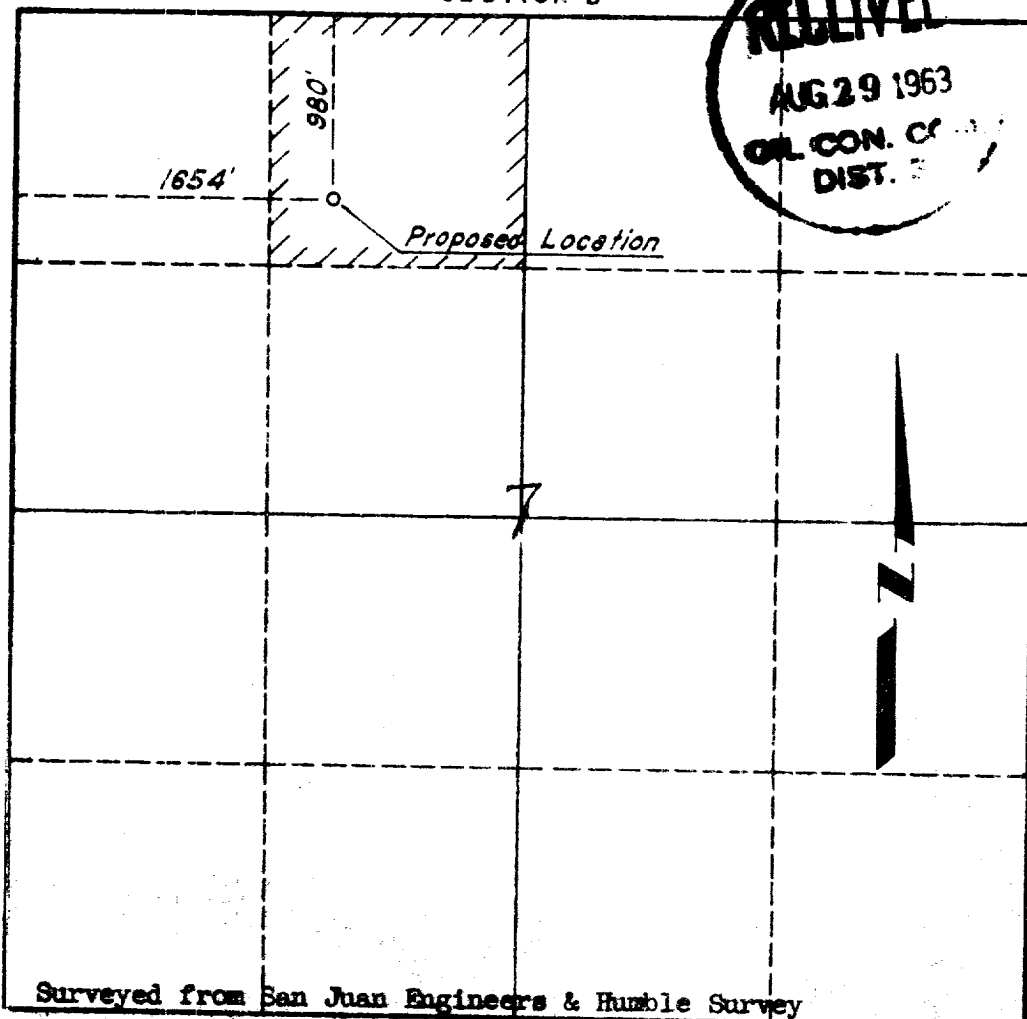
RECEIVED
AUG 29 1963
OIL CON. COM.
DIST. 3CERTIFICATION SURVEY
U. S. GEOLOGICAL SURVEY
FARMINGTON, NEW MEXICO

I hereby certify that the information in SECTION A above is true and complete to the best of my knowledge and belief.

Name M. J. Meyer
M. J. Meyer
Position
Sr. Prod. Foreman
Company
Socony Mobil Oil Co., Inc.
Date
August 8, 1963

I hereby certify that the well location shown on the plat in SECTION B was plotted from field notes of actual surveys made by me or under my supervision, and that the same is true and correct to the best of my knowledge and belief.

Date Surveyed
July 15, 1963
Registered Professional Engineer
and Land Surveyor
Reynold L. Pedersen
Reynold L. Pedersen

Certificate No.
LS 3330

0 330 660 990 1320 1650 1980 2310 2640 2000 1500 1000 500 0