

NUMBER OF COPIES RECEIVED	
DISTRIBUTION	
SANTA FE	
FILE	
U.S.S.	
LAND OFFICE	
TRANSPORTER	
PRODUCTION OFFICE	
OPERATOR	

NEW MEXICO OIL CONSERVATION COMMISSION
WELL LOCATION AND ACREAGE DEDICATION PLAT
SEE INSTRUCTIONS FOR COMPLETING THIS FORM ON THE REVERSE SIDE

FORM C-128
Revised 5/1/57

SECTION A

Operator Nelson Standefer			Lease Kevajo		Well No. 1
Unit Letter 0	Section 2	Township 31N	Range 19W	County San Juan	
Actual Footage Location of Well: 1980 feet from the East line and 660 feet from the South line					
Ground Level Elev. 5054.2	Producing Formation Dakota		Pool Wildcat	Dedicated Acreage: 80 Acres	

1. Is the Operator the only owner in the dedicated acreage outlined on the plat below? YES _____ NO 1 . ("Owner" means the person who has the right to drill into and to produce from any pool and to appropriate the production either for himself or for himself and another. (65-3-29 (e) NMSA 1935 Comp.)
2. If the answer to question one is "no," have the interests of all the owners been consolidated by communitization agreement or otherwise? YES 1 NO ____ . If answer is "yes," Type of Consolidation Leasehold Agreement
3. If the answer to question two is "no," list all the owners and their respective interests below.

Owner	Land Description

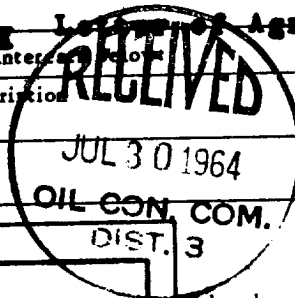

SECTION B

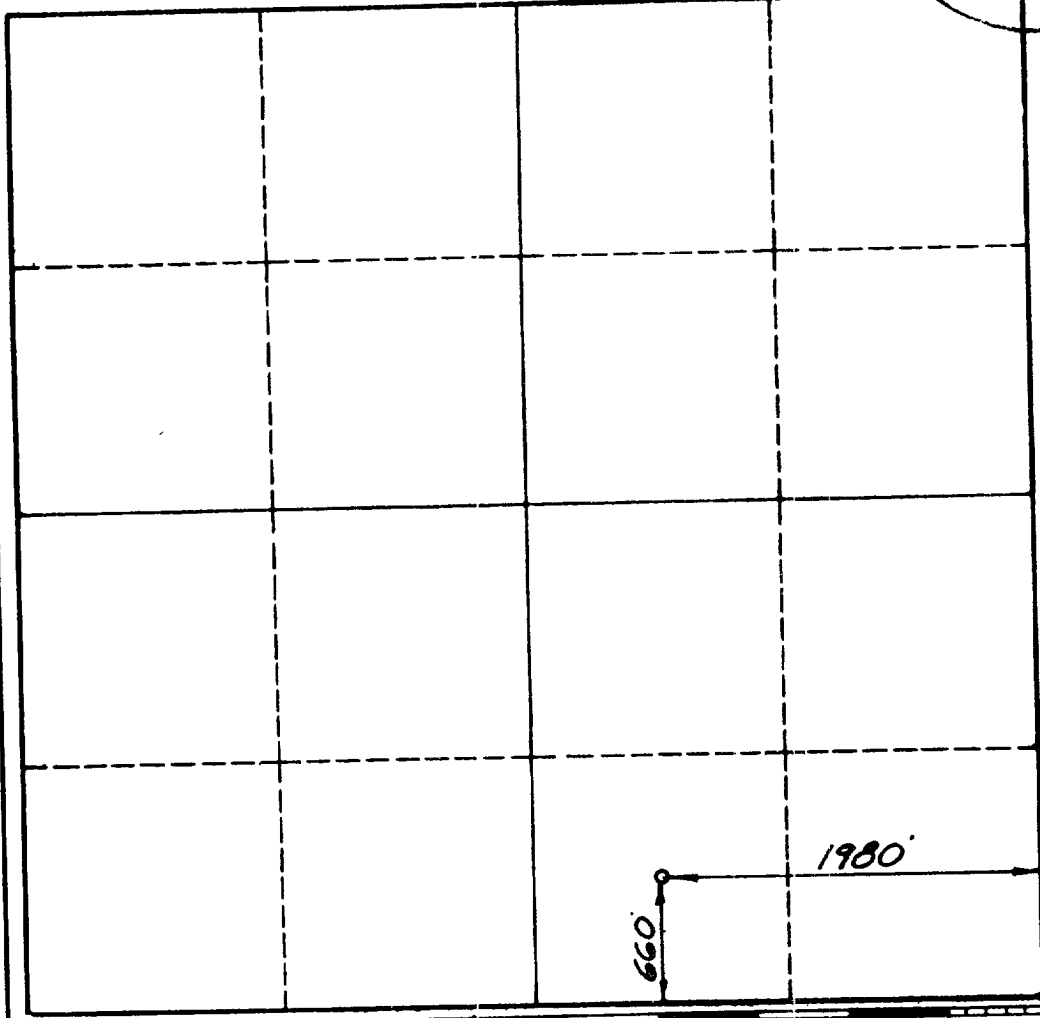

CERTIFICATION

I hereby certify that the information in SECTION A above is true and complete to the best of my knowledge and belief.

Nelson Standefer
Name
Operator
Position
Nelson Standefer
Company

Date Sept 21 - 1961

I hereby certify that the well location shown on the plat in SECTION B was plotted from field notes of actual surveys made by me or under my supervision, and that the same is true and correct to the best of my knowledge and belief.

Date Surveyed August 22, 1961
Registered Professional Engineer and/or Land Surveyer <i>R. J. Leason</i>
Certificate No. 1457

