

(SUBMIT IN TRIPLICATE)

UNITED STATES  
DEPARTMENT OF THE INTERIOR  
GEOLOGICAL SURVEY

Budget Bureau No. 42-R359.4.  
Approval expires 12-31-60.

Indian Agency Navajo

Allottee \_\_\_\_\_

Lease No. 14-20-603-63

SUNDRY NOTICES AND REPORTS ON WELLS

NOTICE OF INTENTION TO DRILL	<input checked="" type="checkbox"/>	SUBSEQUENT REPORT OF WATER SHUT-OFF	
NOTICE OF INTENTION TO CHANGE PLANS		SUBSEQUENT REPORT OF SHOOTING OR ACIDIZING	
NOTICE OF INTENTION TO TEST WATER SHUT-OFF		SUBSEQUENT REPORT OF ALTERING CASING	
NOTICE OF INTENTION TO REDRILL OR REPAIR WELL		SUBSEQUENT REPORT OF REDRILLING OR REPAIR	
NOTICE OF INTENTION TO SHOOT OR ACIDIZE		SUBSEQUENT REPORT OF ABANDONMENT	
NOTICE OF INTENTION TO PULL OR ALTER CASING		SUPPLEMENTARY WELL HISTORY	
NOTICE OF INTENTION TO ABANDON WELL			

(INDICATE ABOVE BY CHECK MARK NATURE OF REPORT, NOTICE, OR OTHER DATA)

April 10, 1958, 19\_\_

Well No. 3 is located 660 ft. from [N] line and 660 ft. from [E] line of sec. 6

SW 1/4 Sect 6

31 N 17 W

RMPM

(1/4 Sec. and Sec. No.)

(Twp.)

(Range)

(Meridian)

San Juan

New Mexico

(Field)

(County or Subdivision)

(State or Territory)

The elevation of the derrick floor above sea level is 5304 ft.

DETAILS OF WORK

(State names of and expected depths to objective sands; show sizes, weights, and lengths of proposed casings; indicate mudding jobs, cementing points, and all other important proposed work)

7" Surface pipe 100' cemented to surface 50 Sax  
drill hole to 1700' maximum to test Dakota  
4-1/2" production string to TD if needed



I understand that this plan of work must receive approval in writing by the Geological Survey before operations may be commenced.

Company R. L. Bayless  
Box 1868  
Address Ponca City, Oklahoma

By R. L. Bayless

Title \_\_\_\_\_

NEW MEXICO OIL CONSERVATION COMMISSION  
Well Location and Acreage Dedication Plat

Section A.

Date 7-17-58

Operator BAYLESS Lease NAVAJO  
Well No. 3 Unit Letter      Section 6 Township 31 N Range 17 W NMPM  
Located 660 Feet From south Line, 660 Feet From west Line  
County San Juan G. L. Elevation 504 Dedicated Acreage 160 Acres  
Name of Producing Formation      Pool     

1. Is the Operator the only owner\* in the dedicated acreage outlined on the plat below?  
Yes X No     .
2. If the answer to question one is "no," have the interests of all the owners been consolidated by communitization agreement or otherwise? Yes      No     . If answer is "yes," Type of Consolidation
3. If the answer to question two is "no," list all the owners and their respective interests below:

Owner

Land Description

**RECEIVED**

APR 21 1958

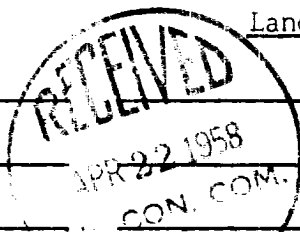

Section B

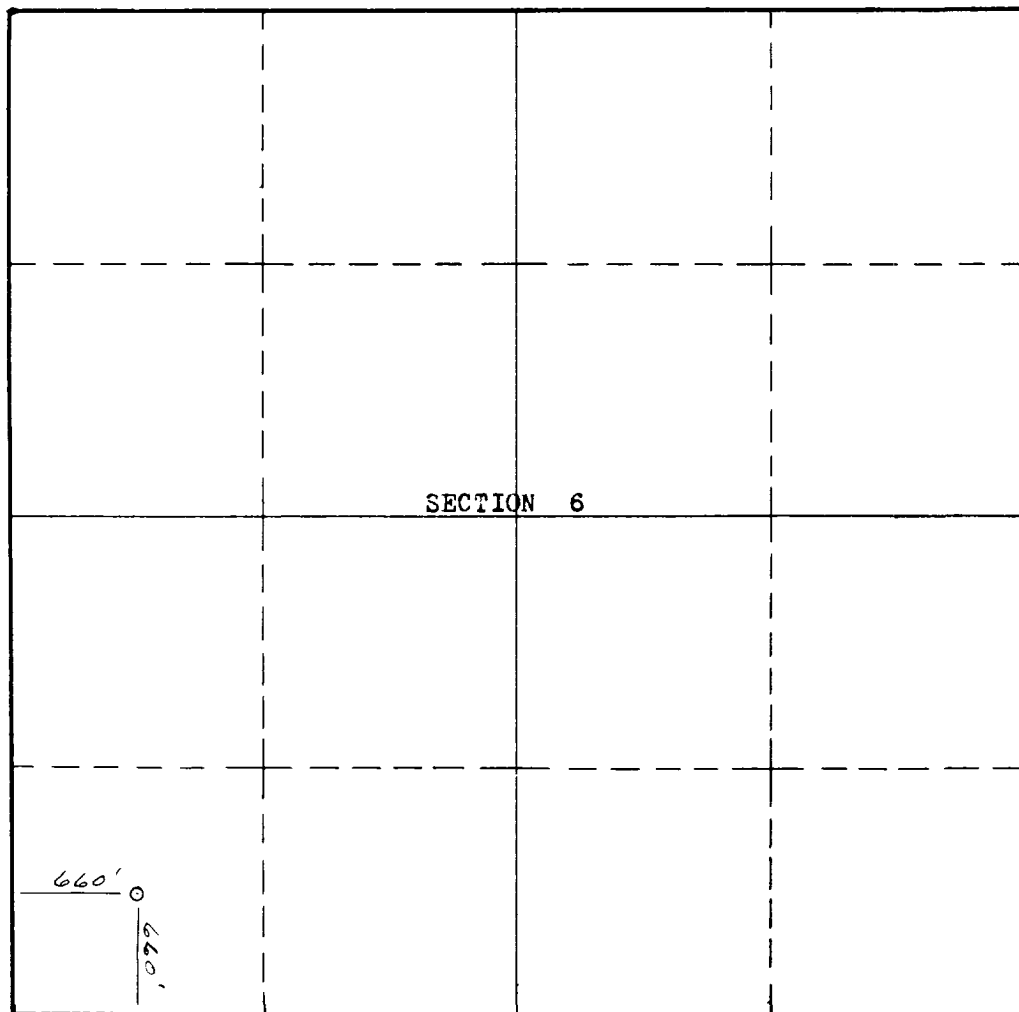

This is to certify that the information in Section A above is true and complete to the best of my knowledge and belief.

R L Bayless  
(Operator)

(Representative)

Poncha City, Okla  
Address

This is to certify that the well location shown on the plat in Section B was plotted from field notes of actual surveys made by me or under my supervision and that the same is true and correct to the best of my knowledge and belief.

Date Surveyed April 12, 1958

Stephen H. Kinney  
Registered Professional  
Engineer and/or Land Surveyor.

Certificate No. 803

