

(SUBMIT IN TRIPLICATE)

Land Office New Mexico-Santa Fe

Lease No. 0271

Unit _____

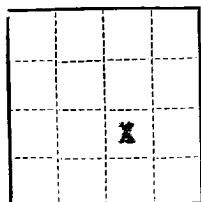

UNITED STATES
DEPARTMENT OF THE INTERIOR
GEOLOGICAL SURVEY

SUNDRY NOTICES AND REPORTS ON WELLS

NOTICE OF INTENTION TO DRILL	<input checked="" type="checkbox"/>	SUBSEQUENT REPORT OF WATER SHUT-OFF	
NOTICE OF INTENTION TO CHANGE PLANS		SUBSEQUENT REPORT OF SHOOTING OR ACIDIZING	
NOTICE OF INTENTION TO TEST WATER SHUT-OFF		SUBSEQUENT REPORT OF ALTERING CASING	
NOTICE OF INTENTION TO RE-DRILL OR REPAIR WELL		SUBSEQUENT REPORT OF RE-DRILLING OR REPAIR	
NOTICE OF INTENTION TO SHOOT OR ACIDIZE		SUBSEQUENT REPORT OF ABANDONMENT	
NOTICE OF INTENTION TO PULL OR ALTER CASING		SUPPLEMENTARY WELL HISTORY	
NOTICE OF INTENTION TO ABANDON WELL			

(INDICATE ABOVE BY CHECK MARK NATURE OF REPORT, NOTICE, OR OTHER DATA)

June 6, 1960

Westheimer-Neustadt
Well No. 1-5 is located 1650 ft. from S line and 1675 ft. from E line of sec. 5
SE/4 Sec. 5 (1/4 Sec. and Sec. No.) 11N 13W 101 P (Twp.) (Range) (Meridian)
Undesignated Gallup San Juan New Mexico (Field) (County or Subdivision) (State or Territory)

The elevation of the Ungrd Ground surface above sea level is 5861 ft.

DETAILS OF WORK

(State names of and expected depths to objective sands; show sizes, weights, and lengths of proposed casings; indicate mudding jobs, cementing points, and all other important proposed work)

Propose to set 10 3/4" surface casing at approximately 120'. Cement to surface. Drill with mud, 8 3/4" hole to approx. 7000' to test Gallup and Dakota. Set 5 1/2" casing or 7" casing to finally complete if both Gallup and Dakota are found productive. Use ample cement to cover Dakota and Gallup and IW tool to cement Mesa Verde approx. 4000' to 5500'. The NW/4 of SE/4, Section 5, containing 40 acres is dedicated to this well.

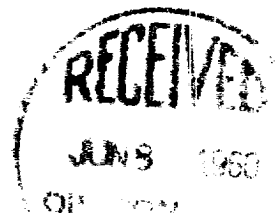

I understand that this plan of work must receive approval in writing by the Geological Survey before operations may be commenced.

Company Johnston-Shear

Address 3010 Monte Vista Blvd., N.E.

Albuquerque, New Mexico

By W. R. Johnston

Title Operator

NEW MEXICO OIL CONSERVATION COMMISSION

Well Location and Acreage Dedication Plat

Section A.

Date June 6, 1960

Operator Johnston & Shear Lease Westheimer-Mustadt
Well No. 1 - 5 Unit Letter J Section 5 Township 31 North Range 13 West NMPM
Located 1650 Feet From South Line, 1675 Feet From East Line
County San Juan G. L. Elevation 5881 Dedicated Acreage _____ Acres
Name of Producing Formation Gallup-Dakota Pool Undesignated Gallup Oil

1. Is the Operator the only owner* in the dedicated acreage outlined on the plat below?
Yes X No _____.
2. If the answer to question one is "no," have the interests of all the owners been consolidated by communitization agreement or otherwise? Yes _____ No _____. If answer is "yes,"
Type of Consolidation _____
3. If the answer to question two is "no," list all the owners and their respective interests below:

Owner

Land Description

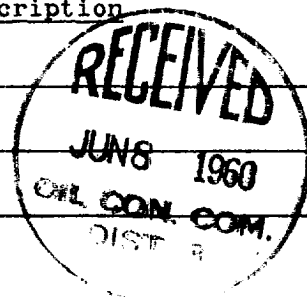

Section. B

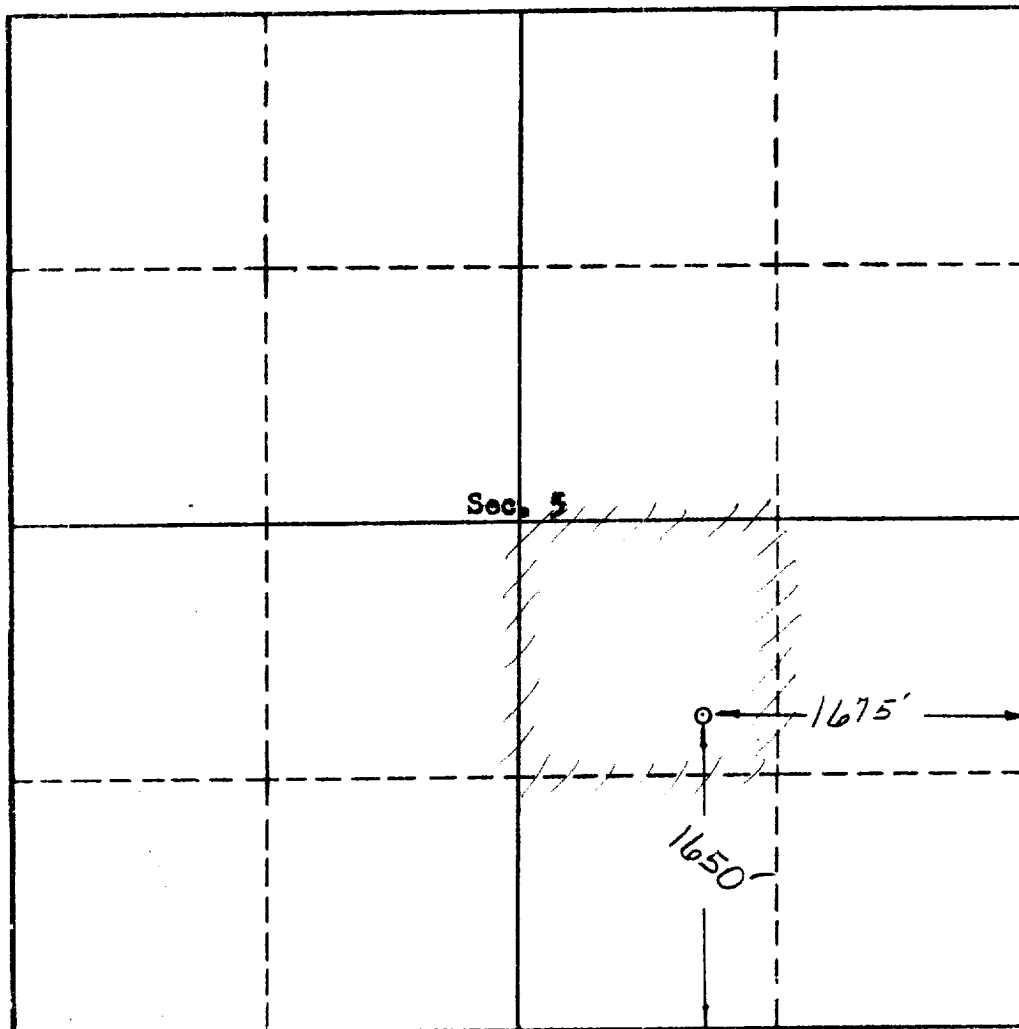

This is to certify that the information in Section A above is true and complete to the best of my knowledge and belief.

Johnston-Shear
(Operator)

W. R. Johnston
(Representative)

3010 Monte Vista Blvd., N.

Albuquerque, New Mexico

This is to certify that the well location shown on the plat in Section B was plotted from field notes of actual surveys made by me or under my supervision and that the same is true and correct to the best of my knowledge and belief.

Date Surveyed May 28, 1960

Ernest V. Echshaw
Ernest V. Echshaw
Registered Land Surveyor.

Certificate No. 1545

