

(SUBMIT IN TRIPLICATE)

Indian Agency Navajo

UNITED STATES
DEPARTMENT OF THE INTERIOR
GEOLOGICAL SURVEY

Allettee _____

Lease No. 11-80-603-2033

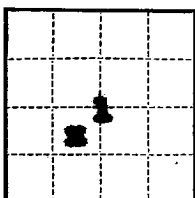

SUNDRY NOTICES AND REPORTS ON WELLS

NOTICE OF INTENTION TO DRILL	<input checked="" type="checkbox"/>	SUBSEQUENT REPORT OF WATER SHUT-OFF	
NOTICE OF INTENTION TO CHANGE PLANS		SUBSEQUENT REPORT OF SHOOTING OR ACIDIZING	
NOTICE OF INTENTION TO TEST WATER SHUT-OFF		SUBSEQUENT REPORT OF ALTERING CASING	
NOTICE OF INTENTION TO REDRILL OR REPAIR WELL		SUBSEQUENT REPORT OF REDRILLING OR REPAIR	
NOTICE OF INTENTION TO SHOOT OR ACIDIZE		SUBSEQUENT REPORT OF ABANDONMENT	
NOTICE OF INTENTION TO PULL OR ALTER CASING		SUPPLEMENTARY WELL HISTORY	
NOTICE OF INTENTION TO ABANDON WELL			

(INDICATE ABOVE BY CHECK MARK NATURE OF REPORT, NOTICE, OR OTHER DATA)

May 1, 1962

Navajo Tribe of Indians
Well No. 9 is located 1300 ft. from S line and 1000 ft. from W line of sec. 1

NE SE Section 1 11N 17W 107N
(1/4 Sec. and Sec. No.) (Twp.) (Range) (Meridian)

Unmanned San Juan New Mexico
(Field) (County or Subdivision) (State or Territory)

The elevation of the derrick floor above sea level is 5205 ft. G. L.

DETAILS OF WORK

(State names of and expected depths to objective sands; show sizes, weights, and lengths of proposed casings; indicate bounding points, and all other important proposed work)

Note: This may be the next well drilled on this lease, well No. 8 currently being drilled. Permits to drill wells number 9, 10 & 11 have been received, but our plans are not definite as to which location will be drilled next. A well number will be assigned at a later date.

Rotary drilling equipment will be used to drill to approx. 1300', a Semur test. Approx. 200' of 7" surface casing will be run and cemented to surface. If production is encountered the required amount of 4 1/2" casing will be run and cemented with sufficient cement to cover the highest potentially productive zone. Air, oil or mud may be used for circulation. All shows will be tested and logs will be run prior to setting casing or abandonment. Stimulation treatments may be used in completion.

I understand that this plan of work must receive approval in writing by the Geological Survey before operations may be commenced.

Company Shutle Oil & Refining Company

Address P. O. Box 2002

Burraga, Colorado

By COPY (ORIGINAL SIGNED) P. L. FARRIS

Title Dist. Supt.

NEW MEXICO OIL CONSERVATION COMMISSION

Well Location and Acreage Dedication Plat

Section A.

Date May 3, 1963Operator HUMBLE OIL AND REFINING COMPANYLease Navajo Tribe of Indians "G"Well No. 9 Unit Letter K Section 1Located 1980 Feet From the SOUTH Line, 1980County SAN JUAN G. L. Elevation 5285.0'Name of Producing Formation GallupTownship 31 NORTH Range 17 WEST NMPM
Feet From the WEST Line
Dedicated Acreage 40 Acres
Pool Unnamed

1. Is the Operator the only owner in the dedicated acreage outlined on the plat below?

Yes ☒ No ☐2. If the answer to question one is "no", have the interests of all the owners been consolidated by communitization agreement or otherwise? Yes ☐ No ☐ If answer is "yes", Type of Consolidation.

3. If the answer to question two is "no", list all the owners and their respective interests below:

Owner

Land Description

Section B.

This is to certify that the information in Section A above is true and complete to the best of my knowledge and belief.

Humble Oil & Refining Company

COPY (ORIGINAL SIGNED) (Operator) H. L. FARRIS

(Representative)

P. O. Box 3082

(Address)

Durango, Colorado

Note: All distances must be from outer boundaries of section.

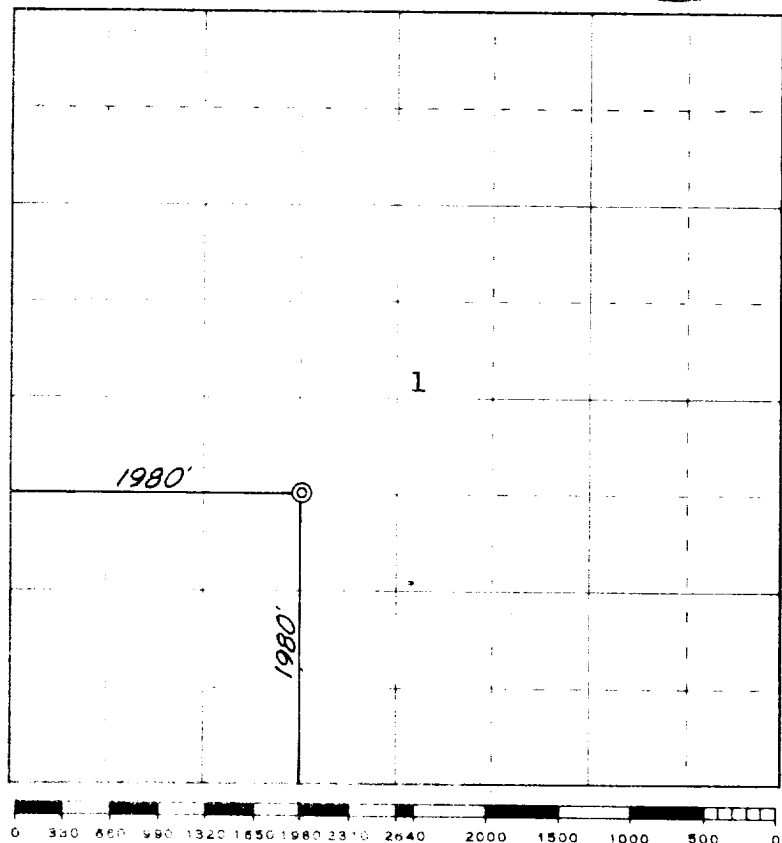

Scale 4 inches equal 1 mile

This is to certify that the above plat was prepared from field notes of actual surveys made by me or under my supervision and that the same are true and correct to the best of my knowledge and belief.

(Seal)

Date Surveyed 2 May 1963

Farmington, New Mexico

James P. Leese
Registered Professional Engineer and/or Land Surveyor
James P. Leese, N. Mex. Reg. No. 1432