

Kenny S. Foust
District I
P.O. Box 1980, Hobbs, NM
DEPUTY OIL & GAS INSPECTOR
District II
P.O. Drawer DD, Artesia, NM 88221
DEC 17 1998
District III
1000 Rio Brazos Rd, Aztec, NM 87410

State of New Mexico
Energy, Minerals and Natural Resources Department

OK
SUBMIT 1 COPY TO
APPROPRIATE
DISTRICT OFFICE
AND 1 COPY TO
SANTA FE OFFICE

OIL CONSERVATION DIVISION

2040 South Pacheco Street
Santa Fe, New Mexico 87505

Approved
PIT REMEDIATION AND CLOSURE REPORT

RECEIVED
JUL 31 1998

OIL CON. DIV.
DIST. 3

Operator: PNM Gas Services (Burlington) **Telephone:** 324-3764

Address: 603 W. Elm Street Farmington, NM 87401

Facility or Well Name: Davis #3

Location: Unit E Sec 1 T 31 N R 12 W County San Juan

Pit Type: Separator ☐ Dehydrator ☐ Other None

Land Type: BLM ☐ State ☐ Fee ☒ Other No

Pit Location: Pit dimensions: length 20 width 20 depth 3

(Attach diagram) **Reference:** wellhead ☒ other

Footage from reference: 135'

Direction from reference: 60 Degrees ☐ East ☐ North
of ☒ West ☒ South

Depth to Ground Water:

(Vertical distance from contaminants to
seasonal high water elevation of ground
water)

Less than 50 feet	(20 points)	
50 feet to 99 feet	(10 points)	
Greater than 100 feet	(0 points)	<u>10</u>

Wellhead Protection Area:

(Less than 200 feet from a private
domestic water source, or, less than 1,000
feet from all other water sources)

Yes	(20 points)	
No	(0 points)	<u>0</u>

Distance to Surface Water:

(Horizontal distance to perennial lakes,
ponds, rivers, streams, creeks, irrigation
canals and ditches)

Less than 200 feet	(20 points)	
200 feet to 1,000 feet	(10 points)	
Greater than 1,000 feet	(0 points)	<u>0</u>

RANKING SCORE (TOTAL POINTS): 10

Davis #3

Date Remediation Started: 5/18/98Date Completed: 5/18/98Remediation Method: Excavation XApprox. Cubic Yard 72

(Check all appropriate sections)

Landfarmed XAmount Landfarmed (cubic yds) 72

Other _____

Remediation Location:

Onsite X

Offsite _____

(i.e., landfarmed onsite, name and location of offsite facility)

Backfill Material Location: _____

General Description of Remedial Action:

Excavated contaminated soil to a pit size of 13' X 15' X 10' and landfarmed soil onsite within a bermed area at a depth of 6" to 12". Soil was aerated by disking/plowing until soil met regulatory levels.Ground Water Encountered: No ☒ Yes ☐ Depth _____

Final Pit Closure Sampling:

Sample Location Bottom of excavation.

(if multiple samples, attach sample result and diagram of sample locations and depths.)

Sample depth 10'Sample date 5/18/98 Sample time 10:15:00 AM

Sample Results

Benzene (ppm) 0.0018Total BTEX (ppm) 0.0041

Field headspace (ppm) _____

TPH (ppm) < 25.00 Method 8015Vertical Extent (ft) _____ Risk Analysis form attached Yes _____ No ☒

Ground Water Sample:

Yes ☐No ☒

(If yes, see attached Groundwater Site Summary Report)

I HEREBY CERTIFY THAT THE INFORMATION ABOVE IS TRUE AND COMPLETE TO THE BEST OF MY KNOWLEDGE AND MY BELIEF

DATE July 27, 1998

SIGNATURE

Mary CookPRINTED NAME Gary CookAND TITLE Environmental Technician III

Davis #3
Burlington Resources
Sec. 1, 31N, 12W, E

5/18/98

start:

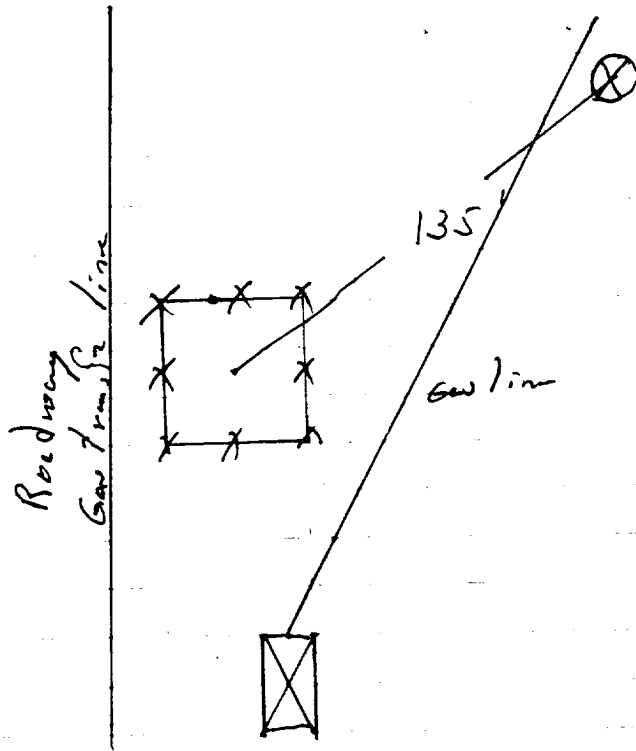

End of excavation

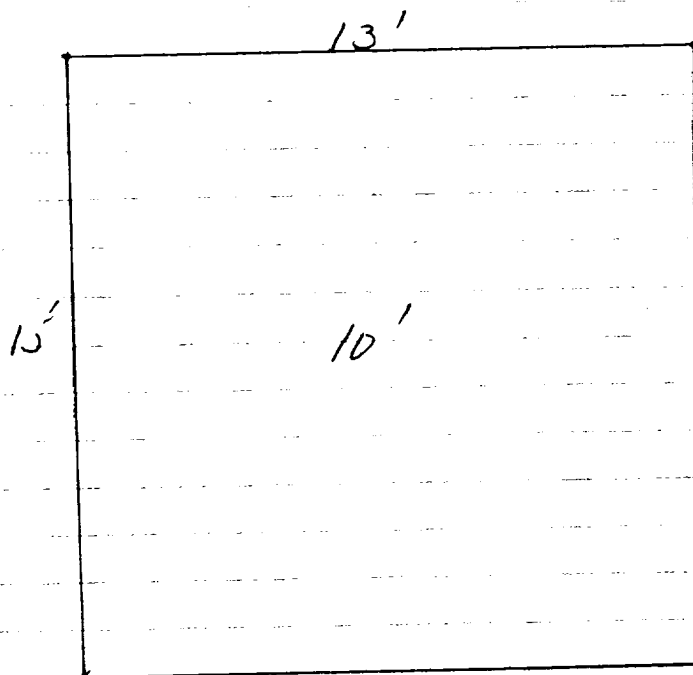

OFF: (505) 325-5667



LAB: (505) 325-1556

On Site Technologies, LTD.

Date: 26-May-98

CLIENT: PNM - Public Service Company of NM

Project: Davis #3

Lab Order: 9805053

CASE NARRATIVE

Samples were analyzed using the methods outlined in the following references:

Test Methods for Evaluating Solid Waste, Physical/Chemical Methods, SW846, 3rd Edition

All method blanks, laboratory spikes, and/or matrix spikes met quality assurance objectives.

OFF: (505) 325-5667



LAB: (505) 325-1556

ANALYTICAL REPORT

Date: 26-May-98

Client: PNM - Public Service Company of NM
Work Order: 9805053
Lab ID: 9805053-01A **Matrix:** SOIL
Project: Davis #3

Client Sample Info: Davis #3
Client Sample ID: 9805181015; Bottom @ 10ft.
Collection Date: 5/18/98 10:15:00 AM
COC Record: 7220

Parameter	Result	PQL	Qual	Units	DF	Date Analyzed
DIESEL RANGE ORGANICS		SW8015				Analyst: DC
T/R Hydrocarbons: C10-C28	ND	25		mg/Kg	1	5/22/98
BTEX		SW8020A				Analyst: HR
Benzene	1.8	1		µg/Kg	1	5/18/98
Toluene	2.3	2		µg/Kg	1	5/18/98
Ethylbenzene	ND	1		µg/Kg	1	5/18/98
m,p-Xylene	ND	2		µg/Kg	1	5/18/98
o-Xylene	ND	1		µg/Kg	1	5/18/98

4.1
 .0041 ppm

Qualifiers:
 PQL - Practical Quantitation Limit
 ND - Not Detected at Practical Quantitation Limit
 J - Analyte detected below Practical Quantitation Limit
 B - Analyte detected in the associated Method Blank

S - Spike Recovery outside accepted recovery limits
 R - RPD outside accepted recovery limits
 E - Value above quantitation range
 Surr: - Surrogate

1 of 1

P.O. BOX 2606 • FARMINGTON, NM 87499

- TECHNOLOGY BLENDING INDUSTRY WITH THE ENVIRONMENT -

OFF: (505) 325-5667



LAB: (505) 325-1556

ANALYTICAL REPORT

Date: 26-May-98

Client:	PNM - Public Service Company of NM	Client Sample Info:	Davis #3
Work Order:	9805053	Client Sample ID:	9805181020; Walls @ 6ft.
Lab ID:	9805053-02A	Matrix:	SOIL
Project:	Davis #3	Collection Date:	5/18/98 10:20:00 AM
		COC Record:	7220

Parameter	Result	PQL	Qual	Units	DF	Date Analyzed
DIESEL RANGE ORGANICS		SW8015				Analyst: DC
T/R Hydrocarbons: C10-C28	ND	25		mg/Kg	1	5/22/98
BTEX		SW8020A				Analyst: HR
Benzene	ND	1		µg/Kg	1	5/18/98
Toluene	ND	2		µg/Kg	1	5/18/98
Ethylbenzene	ND	1		µg/Kg	1	5/18/98
m,p-Xylene	ND	2		µg/Kg	1	5/18/98
o-Xylene	ND	1		µg/Kg	1	5/18/98

Qualifiers: PQL - Practical Quantitation Limit
ND - Not Detected at Practical Quantitation Limit
J - Analyte detected below Practical Quantitation Limit
B - Analyte detected in the associated Method Blank

S - Spike Recovery outside accepted recovery limits
R - RPD outside accepted recovery limits
E - Value above quantitation range
Surr: - Surrogate

1 of 1

P.O. BOX 2606 • FARMINGTON, NM 87499

- TEL: (505) 325-5667 FAX: (505) 325-1556

David #3

6/30/98

BR

Sec 1, 31N, 12W, E

Land farm:

72 yards

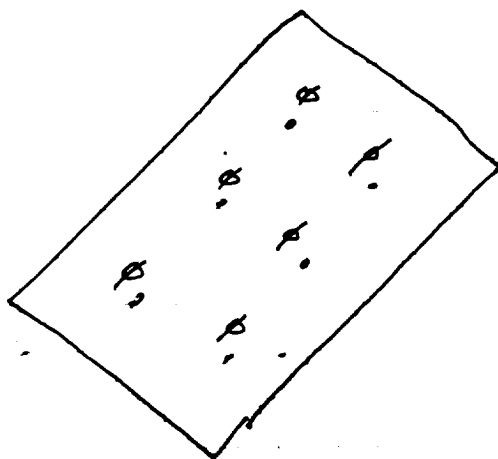

9806300830
2"-12" depth

soil vapor headspace = 2.1 ppm

OFF: (505) 325-5667

ON SITE
TECHNOLOGIES, LTD.

LAB: (505) 325-1556

Date: 07-Jul-98

On Site Technologies, LTD.

CLIENT: PNM - Public Service Company of NM
Project: Landfarms
Lab Order: 9806116

CASE NARRATIVE

Samples were analyzed using the methods outlined in the following references:

Test Methods for Evaluating Solid Waste, Physical/Chemical Methods, SW846, 3rd Edition

All method blanks, laboratory spikes, and/or matrix spikes met quality assurance objectives.

OFF: (505) 325-5667

ON SITE
TECHNOLOGIES, LTD.

LAB: (505) 325-1556

ANALYTICAL REPORT

Date: 07-Jul-98

Client:	PNM - Public Service Company of NM	Client Sample Info: Davis #3 LF
Work Order:	9806116	Client Sample ID: 9806300830; 6pt. Comp. 2-12in.
Lab ID:	9806116-02A	Collection Date: 6/30/98 8:30:00 AM
Project:	Landfarms	COC Record: 7307
	Matrix: SOIL	

Parameter	Result	PQL	Qual	Units	DF	Date Analyzed
DIESEL RANGE ORGANICS		SW8015				Analyst: DC
T/R Hydrocarbons: C10-C28	33	25		mg/Kg	1	6/30/98

Qualifiers:

PQL - Practical Quantitation Limit

ND - Not Detected at Practical Quantitation Limit

J - Analyte detected below Practical Quantitation Limit

B - Analyte detected in the associated Method Blank

S - Spike Recovery outside accepted recovery limits

R - RPD outside accepted recovery limits

E - Value above quantitation range

Surr: - Surrogate

P.O. BOX 2606 • FARMINGTON, NM 87499

1 of 1