

APPROVED
Form 9-331a
(Feb. 1951)

FEB 3 1958

JERRY W. LONG
ACTING DISTRICT ENGINEER

Budget Bureau No. 42-R358.4.
Approval expires 12-31-60.

(SUBMIT IN TRIPLICATE)

UNITED STATES
DEPARTMENT OF THE INTERIOR
GEOLOGICAL SURVEY

Land Office Santa Fe
Lease No. 170007
Unit

SUNDRY NOTICES AND REPORTS ON WELLS

NOTICE OF INTENTION TO DRILL	<input checked="" type="checkbox"/>	SUBSEQUENT REPORT OF WATER SHUT-OFF	
NOTICE OF INTENTION TO CHANGE PLANS		SUBSEQUENT REPORT OF SHOOTING OR ACIDIZING	
NOTICE OF INTENTION TO TEST WATER SHUT-OFF		SUBSEQUENT REPORT OF ALTERING CASING	
NOTICE OF INTENTION TO RE-DRILL OR REPAIR WELL		SUBSEQUENT REPORT OF RE-DRILLING OR REPAIR	
NOTICE OF INTENTION TO SHOOT OR ACIDIZE		SUBSEQUENT REPORT OF ABANDONMENT	
NOTICE OF INTENTION TO PULL OR ALTER CASING		SUPPLEMENTARY WELL HISTORY	
NOTICE OF INTENTION TO ABANDON WELL			

RECEIVED
FEB 3 1958
U.S. GEOLOGICAL SURVEY
FARMINGTON, NEW MEXICO

(INDICATE ABOVE BY CHECK MARK NATURE OF REPORT, NOTICE, OR OTHER DATA)

Well No. 1-1 is located 000 ft. from [N] line and 000 ft. from [E] line of sec. 1

1-1 (1/4 Sec. and Sec. No.) 301 (Twp.) 10 (Range) 10 (Meridian)

1-1 (Field) 10 (County or Subdivision) 10 (State or Territory)

The elevation of the derrick floor above sea level is 271 ft. around underground.

DETAILS OF WORK

(State names of and expected depths to objective sands; show sizes, weights, and lengths of proposed casings; indicate mudding jobs, cementing points, and all other important proposed work)

To prepare to drill to sufficient depth to test the point below out water of the sand. Duration. 30. 10 0000.

Casing and tool joint as follows:
10 1/2" to 100' diameter with cement
3 1/2" to 100' diameter with 10. 0000.

Well to be completed by perforation and sand-wash.



I understand that this plan of work must receive approval in writing by the Geological Survey before operations may be commenced.

Company Colorado East on Exploration, Inc.

Address 1111 National Ave. Denver, Colorado

By J. W. Carrington
Title Area Supervisor

NEW MEXICO OIL CONSERVATION COMMISSION
Well Location and Acreage Dedication Plat

Section A.

Date 24 JANUARY 1958

Operator COLORADO WESTERN EXPLORATION CO. Lease
Well No. 1-1 Unit Letter A Section 1 Township 31 NORTH Range 13 WEST NMPM
Located 990 Feet From THE NORTH Line, 990 Feet From THE EAST Line
County SAN JUAN G. L. Elevation 5870.8 Dedicated Acreage 317.78 Acres
Name of Producing Formation Alamosa Pool Alamosa N. 319.20

1. Is the Operator the only owner* in the dedicated acreage outlined on the plat below?
Yes XXXXXXXX No .
2. If the answer to question one is "no," have the interests of all the owners been consolidated by communitization agreement or otherwise? Yes No . If answer is "yes," Type of Consolidation
3. If the answer to question two is "no," list all the owners and their respective interests below:

REF. GLO. PLAT dated: 9 July 1954

Owner

Land Description

RECEIVED
FEB 28 1958

OIL CON. COM.
DIST. 3

RECEIVED

FEB 3 1958

U.S. GEOLOGICAL SURVEY
DENVER, COLORADO

Section B

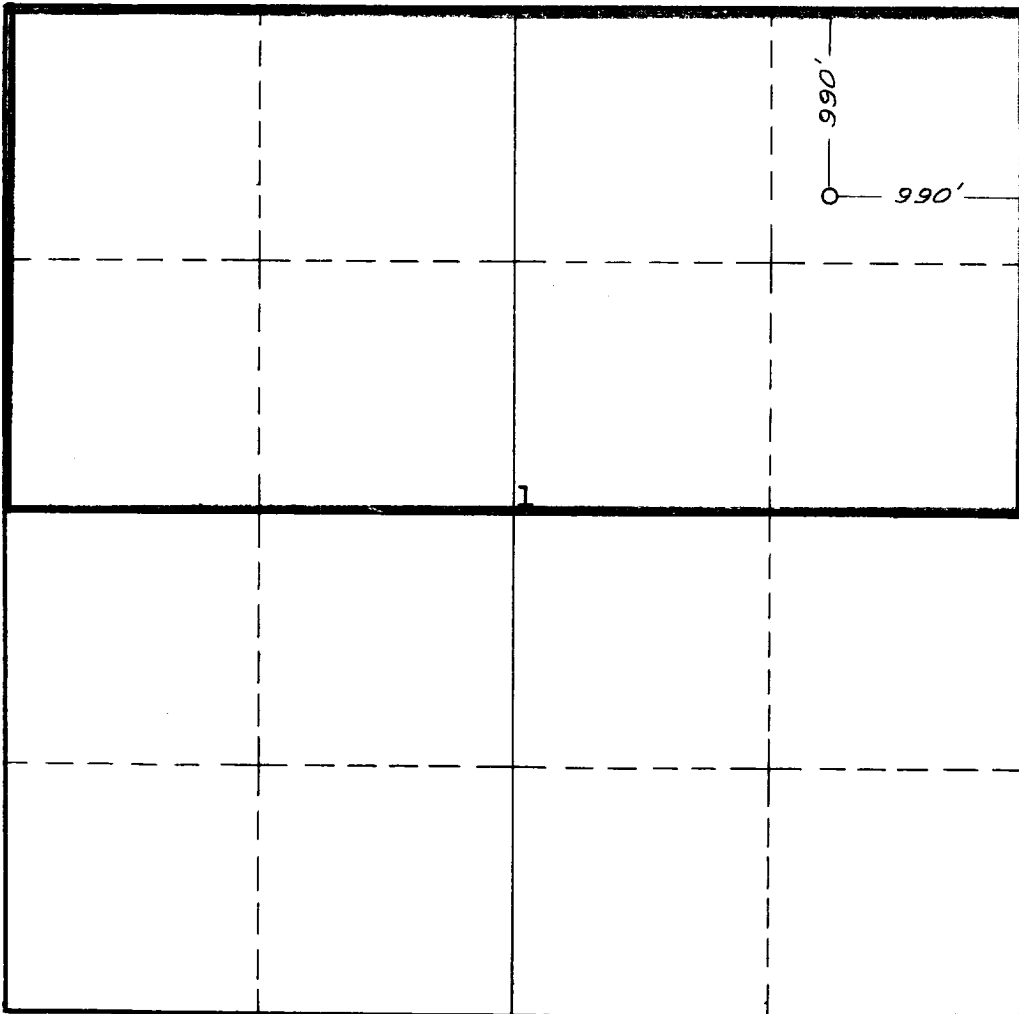

This is to certify that the information in Section A above is true and complete to the best of my knowledge and belief.

Colorado Western Exploration, Inc.
(Operator)
C. R. Carney
(Representative)

312 E. 1st St. Box 115.
Denver, Colorado.

This is to certify that the well location shown on the plat in Section B was plotted from field notes of actual surveys made by me or under my supervision and that the same is true and correct to the best of my knowledge and belief.

Date Surveyed 23 JANUARY 1958

James P. Leese
Registered Professional
Engineer and/or Land Surveyor.
JAMES P. LEESE

Certificate No. 1463

(See instructions for completing this form on the reverse side)

CONSOLIDATED OIL & GAS, INC.

3-25-68

WELLS REQUIRING FILE CORRECTION ONLY

LEASE NAME & WELL NUMBER	LOCATION	POOL	PRESENT ACREAGE	CORRECT ACREAGE
Ladd #1	C-19-25N-9W	Basin Dak.	N 320	N 321.80 ✓
Mills #1	K-19-25N-9W	Basin Dak.	S 320	S 321.40 ✓
Huerfano #1	A-30-25N-9W	Basin Dak.	N 320	N 321.14 ✓
Navajo #1	A-2-25N-10W	Basin Dak.	E 320	E 319.79 ✓
Huron #3	A-2-26N-4W	Tapacito PC	160	160.58 ✓
Huron #3	A-2-26N-4W	Blanco MV	E 320	E 320.58 ✓
Huron #2	D-2-26N-4W	Tapacito PC	160	160.80 ✓
Huron #2	D-2-26N-4W	Basin Dak.	W 320	W 320.80 ✓
Huron #1	M-2-26N-4W	Blanco MV	W 320	W 320.80 ✓
Huron #4	P-2-26N-4W	Basin Dak.	E 320	E 320.58 ✓
Linda #1	M-31-27N-8W	Blanco MV.	W 320	W 322.40 ✓
Rourke #1	M-4-30N-13W	Basin Dak.	W 320	W 320.20 ✓
Mitchell #1	N-5-31N-12W	Basin Dak.	W 320	W 318.36 ✓
Southern Union #2	A-19-31N-12W	Basin Dak.	N 320	N 318.24 ✓
XXXXXX	XXXXXXXXXXXXXXXXXXXXXXXXXXXX		XXXXXX	XXXXXX
Hancock #1	A-1-31N-13W	Blanco MV	N 317.78	N 319.20 ✓
Chavez Com #1	A-2-31N-13W	Blanco MV	E 320	E 319.40 ✓
Alberding #1	A-3-31N-13W	Blanco MV	E 319.03	E 320.10 ✓
Landauer #1	H-3-31N-13W	Basin Dak.	E 319.03	E 320.10 ✓
O'Shea #1	K-3-31N-13W	Blanco MV	W 319.92	W 320.30 ✓
O'Shea #1	K-3-31N-13W	Basin Dak.	W 319.92	W 320.30 ✓
Baird #1	H-4-31N-13W	Blanco MV	E 320	E 320.90 ✓
Baird #1	H-4-31N-13W	Basin Dak.	E 320	E 320.90 ✓