

(SUBMIT IN TRIPLICATE)

1-W. L. Johnston  
1-File

UNITED STATES  
DEPARTMENT OF THE INTERIOR  
GEOLOGICAL SURVEY

Land Office .....

Lease No. ....

Unit 32-7

711-22-001-441

## SUNDRY NOTICES AND REPORTS ON WELLS

NOTICE OF INTENTION TO DRILL.....	<input checked="" type="checkbox"/>	SUBSEQUENT REPORT OF WATER SHUT-OFF.....	
NOTICE OF INTENTION TO CHANGE PLANS.....		SUBSEQUENT REPORT OF SHOOTING OR ACIDIZING.....	
NOTICE OF INTENTION TO TEST WATER SHUT-OFF.....		SUBSEQUENT REPORT OF ALTERING CASING.....	
NOTICE OF INTENTION TO RE-DRILL OR REPAIR WELL.....		SUBSEQUENT REPORT OF RE-DRILLING OR REPAIR.....	
NOTICE OF INTENTION TO SHOOT OR ACIDIZE.....		SUBSEQUENT REPORT OF ABANDONMENT.....	
NOTICE OF INTENTION TO PULL OR ALTER CASING.....		SUPPLEMENTARY WELL HISTORY.....	
NOTICE OF INTENTION TO ABANDON WELL.....			

(INDICATE ABOVE BY CHECK MARK NATURE OF REPORT, NOTICE, OR OTHER DATA)

May 23, 19 56

Well No. 14-28 is located 1650 ft. from N line and 790 ft. from E line of sec. 28

33/4 33/4 28 33 7 R.R.P.M.  
(1/4 Sec. and Sec. No.) (Twp.) (Range) (Meridian)  
Blanco Mesa Verde San Juan New Mexico  
(Field) (County or Subdivision) (State or Territory)

The elevation of the ~~derrick floor~~ upgraded ground above sea level is 6669 ft.

### DETAILS OF WORK

(State names of and expected depths to objective sands; show sizes, weights, and lengths of proposed casings; indicate mudding jobs, cementing points, and all other important proposed work)

Propose to drill to 175'. Set 10-3/4" csg cemented w/150 sz 4 1/2 gal. Drill w/water and minimum mud to 3902'. Set 7-5/8" csg cemented w/150 sz 8 1/2 gal and 50 sz cement on bottom. Drill w/gas to 6070'. Set 5-1/2" csg cemented w/200 sz reg ant. Perforate and water from the Cliff House, Benches and St. Lookout, separately, each w/40,000 gal water, clean out, run tubing and so plate well. 32 1/2 acres, E/2 Sec 28 dedicated to this well.

I understand that this plan of work must receive approval in writing by the Geological Survey before operations may be commenced.

Company Pacific Northwest Pipeline Corp.

Address 4131 N. Main,

Farmington, New Mexico

By Original signed by T. A. Dugan

Title District Engineer

NEW MEXICO  
OIL CONSERVATION COMMISSION

Form C-128

Well Location and/or Gas Proration Plat

Date May 28, 1956  
San Juan 32-7

Operator PACIFIC NORTHWEST PIPELINE CORPORATION Lease San Juan 32-7

Well No. 34-28 Section 28 Township 32 NORTH Range 7 WEST, NMPM

Located 1650 Feet From the NORTH Line, 990 Feet From the EAST Line,

SAN JUAN County, New Mexico. G. L. Elevation 6669/0 UNGRADED.

Name of Producing Formation San Juan Pool San Juan Dedicated Acreage 320

(Note: All distances must be from outer boundaries of Section)

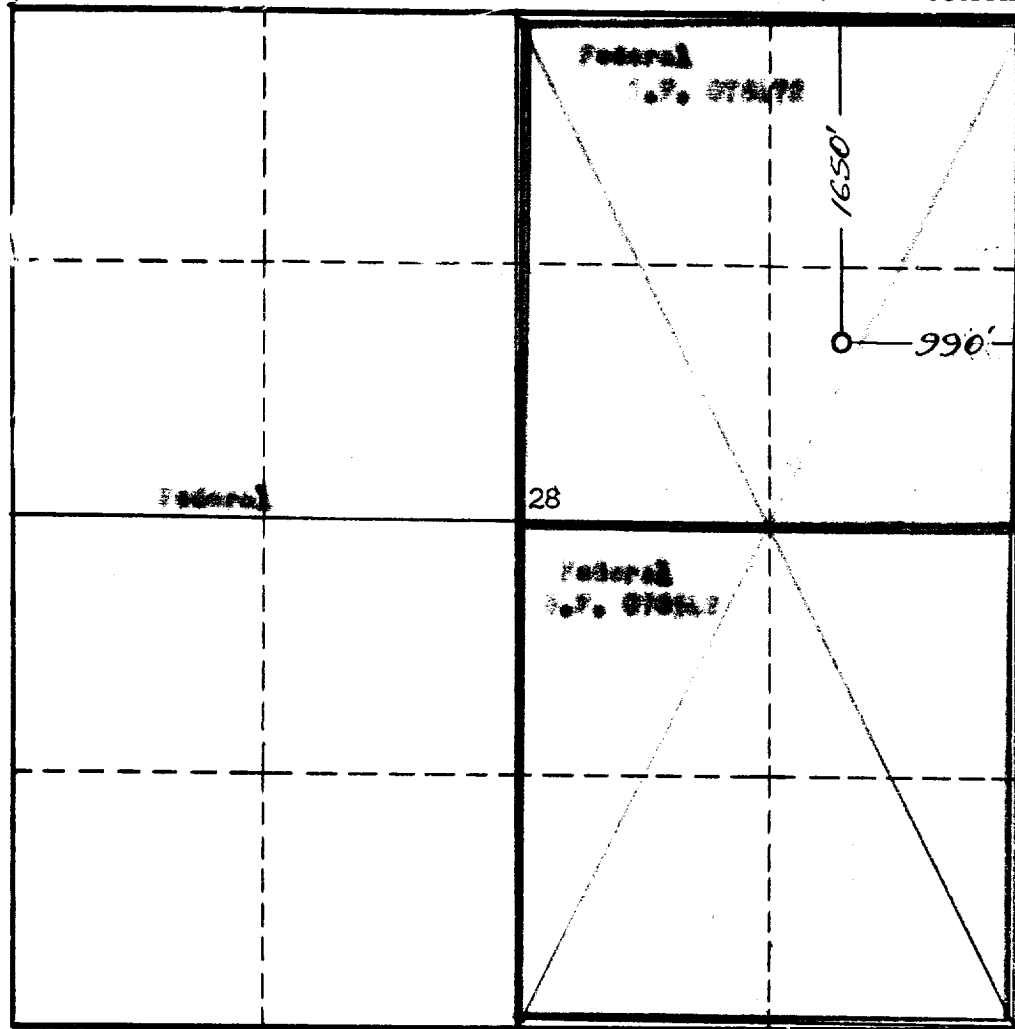

NOTE

This section of  
form is to be  
used for gas  
wells only.



SCALE: 1"=1000'

1. Is this Well a Dual Comp. ? Yes    No   .
2. If the answer to Question 1 is yes, are there any other dually completed wells within the dedicated acreage? Yes    No   .

Name Original signed by T. A. Dugan  
Position San Juan 32-7  
Representing San Juan 32-7  
Address San Juan 32-7

This is to certify that the above plat was prepared from field notes of actual surveys made by me or under my supervision and that the same are true and correct to the best of my knowledge and belief.

Date Surveyed 8 MAY 1956  
James P. Leese  
Registered Professional Engineer and/or  
Land Surveyor James P. Leese  
N. Mex. Reg. No. 1463