

District I
P.O. Box 1980, Hobbs, NM

District II
P.O. Drawer DC, Artesia, NM 88221

District III
1000 Rio Brazos Rd, Aztec, NM 87410

State of New Mexico
Energy, Minerals and Natural Resources Department

OIL CONSERVATION DIVISION

2040 South Pacheco Street
Santa Fe, New Mexico 87505

SUBMIT 1 COPY TO
APPROPRIATE
DISTRICT OFFICE
AND 1 COPY TO
SANTA FE OFFICE

*Risk
Bedrock*

PIT REMEDIATION AND CLOSURE REPORT

Operator: PNM Gas Services (Burlington) **Telephone:** 324-3764

Address: 603 W. Elm Street Farmington, NM 87401

Facility or Well Name: Thompson #10

Location: Unit E Sec 27 T 31N R 12W County San Juan

Pit Type: Separator Dehydrator Other _____

Land Type: BLM State Fee Other _____

Pit Location: Pit dimensions: length 20' width 20' depth 3'

(Attach diagram) Reference: wellhead other _____

Footage from reference: 90'

Direction from reference: 75 Degrees East North
of West South

Depth to Ground Water: <small>(Vertical distance from contaminants to seasonal high water elevation of ground water)</small>	Less than 50 feet (20 points) 50 feet to 99 feet (10 points) Greater than 100 feet (0 points)	<u>0</u>
Wellhead Protection Area: <small>(Less than 200 feet from a private domestic water source, or; less than 1,000 feet from all other water sources)</small>	Yes (20 points) No (0 points)	<u>0</u>
Distance to Surface Water: <small>(Horizontal distance to perennial lakes, ponds, rivers, streams, creeks, irrigation canals and ditches)</small>	Less than 200 feet (20 points) 200 feet to 1,000 feet (10 points) Greater than 1,000 feet (0 points)	<u>0</u>
RANKING SCORE (TOTAL POINTS):		<u>0</u>

RECEIVED
JAN 31 2000
OIL CON. DIV.
DIST. 3

Thompson #10

Date Remediation Started: 06/07/1999

Date Completed: 06/07/1999

Remediation Method: Excavation

Approx. Cubic Yard 146

(Check all appropriate sections) Landfarmed

Amount Landfarmed (cubic yds) 126

Other 20 cu yds overburden.

Remediation Location: Onsite

Offsite _____

(i.e., landfarmed onsite, name and location of offsite facility)

Backfill Material Location: _____

General Description of Remedial Action:

Excavated contaminated soil to a pit size of 18' X 20' X 11' and landfarmed soil onsite within a bermed area at a depth of 6" to 12". Soil was aerated by disking/plowing until soil met regulatory levels.

*** Sandstone encountered at 11'. See attached risk analysis form.

Ground Water Encountered: No Yes Depth _____

Final Pit Closure Sampling:

Sample Location 5 pt composite-bottom

(if multiple samples, attach sample result and diagram of sample locations and depths.)

Sample depth 11'

Sample date 06/07/1999 Sample time 2:05:00 PM

Sample Results

Benzene (ppm) 32 ***

Total BTEX (ppm) 191.3 ***

Field headspace (ppm) _____

TPH (ppm) 1250.00 Method 8015B

Vertical Extent (ft) _____ Risk Analysis form attached Yes No

Ground Water Sample: Yes No (If yes, see attached Groundwater Site Summary Report)

I HEREBY CERTIFY THAT THE INFORMATION ABOVE IS TRUE AND COMPLETE TO THE BEST OF MY KNOWLEDGE AND MY BELIEF

DATE January 24, 2000

PRINTED NAME **Maureen Gannon**

SIGNATURE Maureen Gannon

AND TITLE **Project Manager**

Thompson #10
Burlington
Sec. 27, 31N, 12W, E

6-7-99

↑
N

Site diagram:

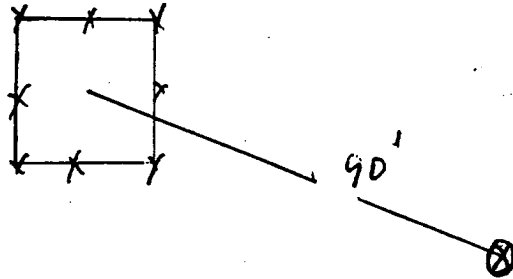

OH removed from section

End of excavation:

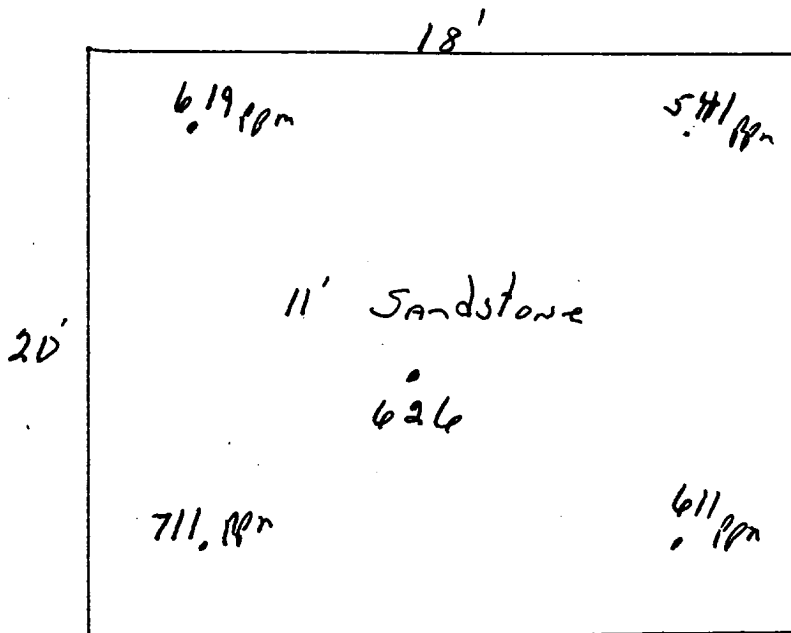

Field Headspace (walls) 5.7 ppm

OFF: (505) 325-5667



LAB: (505) 325-1556

On Site Technologies, LTD.

Date: 17-Jun-99

CLIENT: PNM - Public Service Company of NM

Project: PNM Pit Remediation

Lab Order: 9906017

CASE NARRATIVE

Samples were analyzed using the methods outlined in the following references:

Test Methods for Evaluating Solid Waste, Physical/Chemical Methods, SW846, 3rd Edition

All method blanks, laboratory spikes, and/or matrix spikes met quality assurance objectives.

OFF: (505) 325-5667



LAB: (505) 325-1556

ANALYTICAL REPORT

Date: 17-Jun-99

Client:	PNM - Public Service Company of NM	Client Sample Info:	Thompson #10
Work Order:	9906017	Client Sample ID:	9906071410, Wall 27'
Lab ID:	9906017-12A	Matrix:	SOIL
Project:	PNM Pit Remediation	Collection Date:	6/7/99 2:10:00 PM
		COC Record:	7605

Parameter	Result	PQL	Qual	Units	DF	Date Analyzed
DIESEL RANGE ORGANICS		SW8015B				Analyst: DC
T/R Hydrocarbons: C10-C28	ND	25		mg/Kg	1	6/14/99

Qualifiers:

PQL - Practical Quantitation Limit	S - Spike Recovery outside accepted recovery limits
ND - Not Detected at Practical Quantitation Limit	R - RPD outside accepted recovery limits
J - Analyte detected below Practical Quantitation Limit	E - Value above quantitation range
B - Analyte detected in the associated Method Blank	Surr: - Surrogate

Thompson #10
Sec-27 T31N R-12W UL E
Burlington

Land farm Denwing

App 126 cu. yds

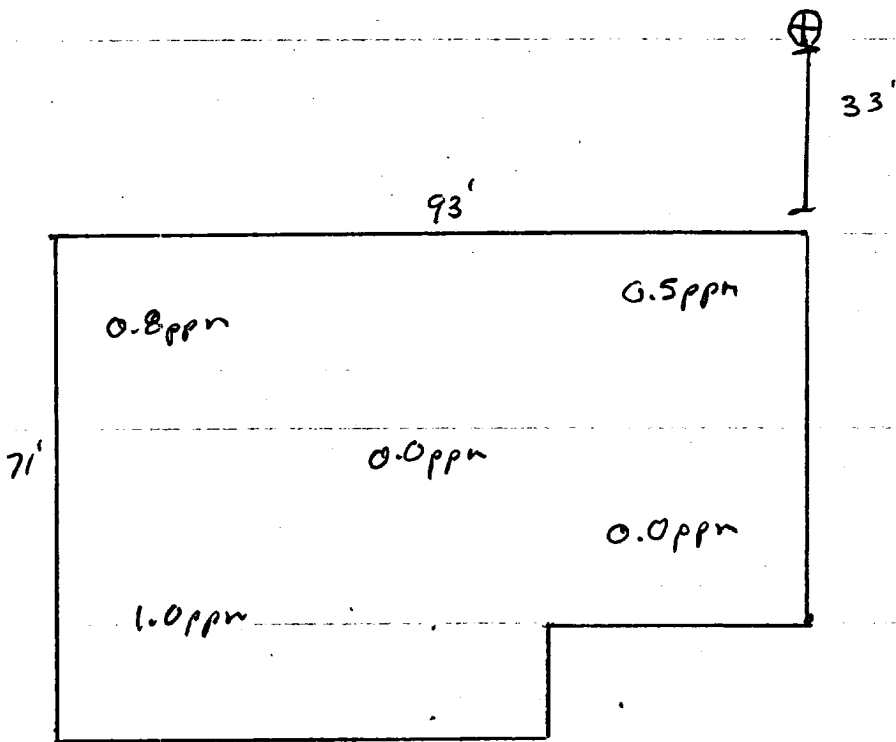

2" to 12" Depth
Headspace 4.0 ppm
Sample # 9907130818

Not to Scale

OFF: (505) 325-5667



LAB: (505) 325-1556

On Site Technologies, LTD.

Date: 28-Jul-99

CLIENT: PNM - Public Service Company of NM

Project: PNM Pit Remediation Landfarms

Lab Order: 9907030

CASE NARRATIVE

Samples were analyzed using the methods outlined in the following references:

Test Methods for Evaluating Solid Waste, Physical/Chemical Methods, SW846, 3rd Edition

All method blanks, laboratory spikes, and/or matrix spikes met quality assurance objectives.

OFF: (505) 325-5667



LAB: (505) 325-1556

ANALYTICAL REPORT

Date: 28-Jul-99

Client:	PNM - Public Service Company of NM	Client Sample Info:	Thompson 10 LF
Work Order:	9907030	Client Sample ID:	9907130818; 5pt. Comp
Lab ID:	9907030-07A	Matrix:	SOIL
Project:	PNM Pit Remediation Landfarms	Collection Date:	7/13/99 8:18:00 AM
		COC Record:	7489

Parameter	Result	PQL	Qual	Units	DF	Date Analyzed
DIESEL RANGE ORGANICS		SW8015B				Analyst: DC
T/R Hydrocarbons: C10-C28	28	25		mg/Kg	1	7/26/99

Qualifiers:	PQL - Practical Quantitation Limit	S - Spike Recovery outside accepted recovery limits
	ND - Not Detected at Practical Quantitation Limit	R - RPD outside accepted recovery limits
	J - Analyte detected below Practical Quantitation Limit	E - Value above quantitation range
	B - Analyte detected in the associated Method Blank	Surr: - Surrogate

P.O. BOX 2606 • FARMINGTON, NM 87499

TECHNOLOGY BLENDING INDUSTRY WITH THE ENVIRONMENT



Environmental Services

Well Name:	Thompson #10
Well Legals:	Unit E, Sec 27, T31N, R12W
Pit Type:	Dehydrator
Horizontal Distance to Surface Water:	Greater than 1,000 feet
Groundwater Depth:	Greater than 100 feet

RISK ANALYSIS

PNM requests closure of their former pit on the Thompson #10 well site using a limited risk analysis based on the following conditions:

1. Groundwater is estimated to be at a depth of 191 feet based upon the elevation of the site and the elevation of the nearest "listed" or "named" wash. (Reference: Flora Vista, NM series 7.5 minute topographic map.)
2. PNM excavated 146 cubic yards of soil from the former pit. Subsurface lateral contamination has been remediated (see attached map and analytical results for the side wall profiles). Source removal minimizes the possibility of surface water contamination.
3. Sandstone was encountered at 11 feet below ground surface. Bedrock/sandstone provides a barrier between remaining contamination and groundwater. Vertical migration through bedrock or sandstone to groundwater is unlikely.
4. PNM excavated and performed remediation to the maximum depth and horizontal extent practicable.

PNM believes that their former pit on the Thompson #10 well site poses minimal threat to groundwater, human health and the environment based upon our past experience in excavating over 1,000 pits.