

(SUBMIT IN TRIPLICATE)

UNITED STATES
DEPARTMENT OF THE INTERIOR
GEOLOGICAL SURVEY

Indian Agency Navajo-Ute Tribal
Contract _____
Allottee _____
Lease No. 14-20-604-1951

			X

SUNDRY NOTICES AND REPORTS ON WELLS

NOTICE OF INTENTION TO DRILL.....	X	SUBSEQUENT REPORT OF WATER SHUT-OFF.....	
NOTICE OF INTENTION TO CHANGE PLANS.....		SUBSEQUENT REPORT OF SHOOTING OR ACIDIZING.....	
NOTICE OF INTENTION TO TEST WATER SHUT-OFF.....		SUBSEQUENT REPORT OF ALTERING CASING.....	
NOTICE OF INTENTION TO REDRILL OR REPAIR WELL.....		SUBSEQUENT REPORT OF REDRILLING OR REPAIR.....	
NOTICE OF INTENTION TO SHOOT OR ACIDIZE.....		SUBSEQUENT REPORT OF ABANDONMENT.....	
NOTICE OF INTENTION TO PULL OR ALTER CASING.....		SUPPLEMENTARY WELL HISTORY.....	
NOTICE OF INTENTION TO ABANDON WELL.....			

(INDICATE ABOVE BY CHECK MARK NATURE OF REPORT, NOTICE, OR OTHER DATA)

December 17, 1959

Horseshoe Ute

Well No. 30 is located 1990 ft. from [N] line and 645 ft. from [E] line of sec. 34

SE NE/4 Section 34
(1/4 Sec. and Sec. No.)

31N
(Twp.)

16W
(Range)

NMPM
(Meridian)

Horseshoe Gallup
(Field)

San Juan

(County or Subdivision)

New Mexico

(State or Territory)

The elevation of the derrick floor above sea level is 5478 ft.

DETAILS OF WORK

(State names of and expected depths to objective sands; show sizes, weights, and lengths of proposed casings; indicate mudding jobs, cementing points, and all other important proposed work)

It is intended to drill a well through the Lower-Gallup Formation using rotary tools and mud circulation. Possible productive intervals will be perforated and sandoil fractured.

Estimated Total Depth 1485'.

Casing Program:

9-5/8" at 100' with 125 sacks cement circulated to surface.

5-1/2" at 1485' with 100 sacks cement.

The SE/4 NE/4 of Section 34 is dedicated to this well.

SE/4 NE/4 Section 34 Navajo-Ute Tribal Contract 14-20-604-1951

I understand that this plan of work must receive approval in writing by the Geological Survey before operations may be commenced.

Company El Paso Natural Gas Products Company

Address Post Office Box 1565
Farmington, New Mexico

By Original Signed EWELL N. WALSH

Title Division Petroleum Engineer

NEW MEXICO OIL CONSERVATION COMMISSION

Well Location and Acreage Dedication Plat

Section A.

Date December 17, 1959

Navajo-Ute Tribal Contract
14-20-604-1951

Operator El Paso Natural Gas Products Company Lease Horseshoe Ute
Well No. 30 Unit Letter H Section 34 Township 31 North Range 16 West NMPM
Located 1990 Feet From North Line, 645 Feet From East Line
County San Juan G. L. Elevation 5472 Dedicated Acreage 40 Acres
Name of Producing Formation Lower Gallup Pool Horseshoe Gallup

1. Is the Operator the only owner* in the dedicated acreage outlined on the plat below?
Yes X No
2. If the answer to question one is "no," have the interests of all the owners been consolidated by communitization agreement or otherwise? Yes No . If answer is "yes,"
Type of Consolidation
3. If the answer to question two is "no," list all the owners and their respective interests below:

Owner

Land Description

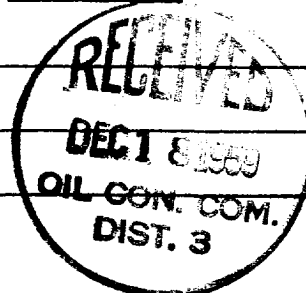

Section. B

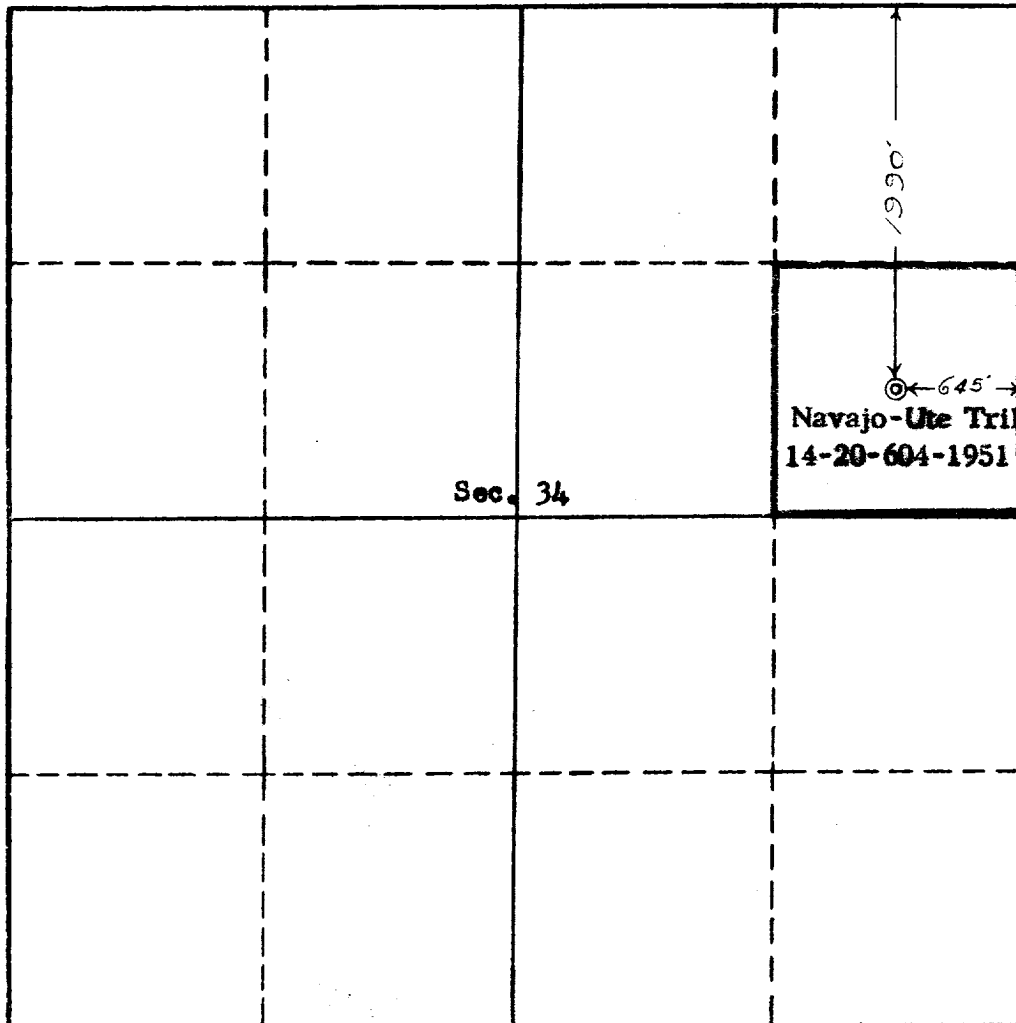

This is to certify that the information in Section A above is true and complete to the best of my knowledge and belief.

El Paso Natural Gas Products Co.
(Operator)

Original Signed EWELL N. WALSH
(Representative)

Box 1565, Farmington, New Mexico
Address

This is to certify that the well location shown on the plat in Section B was located from field notes of a trial survey made by me or under my supervision and that the same is true to the best of my knowledge and belief.

Date Surveyed Dec. 15, 1959

Ernest V. Echohawk
Ernest V. Echohawk
Registered Land Surveyor.

Certificate No. 1545