

30-047-20153  
045

UNITED STATES  
DEPARTMENT OF THE INTERIOR  
GEOLOGICAL SURVEY

APPLICATION FOR PERMIT TO DRILL, DEEPEN, OR PLUG BACK

1a. TYPE OF WORK  
 DRILL  DEEPEN  PLUG BACK

b. TYPE OF WELL  
 OIL WELL  GAS WELL  OTHER  SINGLE ZONE  MULTIPLE ZONE

2. NAME OF OPERATOR  
 El Paso Natural Gas Company

3. ADDRESS OF OPERATOR  
 Box 990, Farmington, New Mexico

4. LOCATION OF WELL (Report location clearly and in accordance with any State requirements.)\*  
 At surface 1050' South, 875' West  
 At proposed prod. zone

14. DISTANCE IN MILES AND DIRECTION FROM NEAREST TOWN OR POST OFFICE\*

15. DISTANCE FROM PROPOSED\* LOCATION TO NEAREST PROPERTY OR LEASE LINE, FT. (Also to nearest drlg. unit line, if any)

16. NO. OF ACRES IN LEASE

17. NO. OF ACRES ASSIGNED TO THIS WELL

18. DISTANCE FROM PROPOSED LOCATION\* TO NEAREST WELL, DRILLING, COMPLETED, OR APPLIED FOR, ON THIS LEASE, FT.

19. PROPOSED DEPTH

20. ROTARY OR CABLE TOOLS

21. ELEVATIONS (Show whether DF, RT, GR, etc.)

22. APPROX. DATE WORK WILL START\*

5. LEASE DESIGNATION AND SERIAL NO.  
 SF 078459-B

6. IF INDIAN, ALLOTTEE OR-TRIBE NAME

7. UNIT AGREEMENT NAME  
 Allison Unit

8. FARM OR LEASE NAME  
 Allison Unit

9. WELL NO.  
 28

10. FIELD AND POOL, OR WILDCAT  
 Blanco Mesa Verde

11. SEC., T., R., M., OR BLK. AND SURVEY OR AREA  
 Sec. 14, T-32-N, R-7-W  
 N.M.P.M.

12. COUNTY OR PARISH 13. STATE  
 San Juan New Mexico

23. PROPOSED CASING AND CEMENTING PROGRAM

| SIZE OF HOLE | SIZE OF CASING | WEIGHT PER FOOT | SETTING DEPTH | QUANTITY OF CEMENT          |
|--------------|----------------|-----------------|---------------|-----------------------------|
| 13 3/4"      | 9 5/8"         | 32.30#          | 180'          | 160 Sks. to circulate       |
| 8 3/4"       | 7"             | 20#             | 4000'         | 150 Sks. Top of Kirtland    |
| 6 1/4"       | * 1/2" Liner   | 10.3#           | 3900-6275'    | 250 Sks. to circulate Liner |

Selective zones in the Mesa Verde formation will be perforated and sand water fractured.

The W/2 of Section 14 is dedicated to this well.

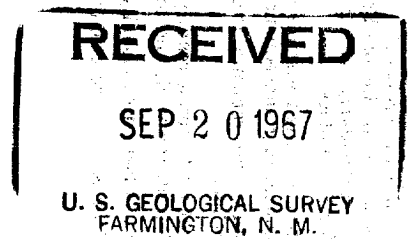

IN ABOVE SPACE DESCRIBE PROPOSED PROGRAM: If proposal is to deepen or plug back, give data on present productive zone and proposed new productive zone. If proposal is to drill or deepen directionally, give pertinent data on subsurface locations and measured and true vertical depths. Give blowout preventer program, if any.

24. SIGNED Original Signed F. H. WOOD TITLE Petroleum Engineer DATE 9-18-67

(This space for Federal or State office use)

PERMIT NO. APPROVAL DATE

APPROVED BY TITLE DATE

CONDITIONS OF APPROVAL, IF ANY:

## Instructions

**General:** This form is designed for submitting proposals to perform certain well operations, as indicated, on all types of lands and leases for appropriate action by either a Federal or a State agency, or both, pursuant to applicable Federal and/or State laws and regulations. Any necessary special instructions concerning the use of this form and the number of copies to be submitted, particularly with regard to local, area, or regional procedures and practices, either are shown below or will be issued by, or may be obtained from, the local Federal and/or State office.

**Item 1:** If the proposal is to redrill to the same reservoir at a different subsurface location or to a new reservoir, use this form with appropriate notations. Consult applicable State or Federal regulations concerning subsequent work proposals or reports on the well.

**Item 4:** If there are no applicable State requirements, locations on Federal or Indian land should be described in accordance with Federal requirements. Consult local State or Federal office for specific instructions.

**Item 14:** Needed only when location of well cannot readily be found by road from the land or lease description. A plat, or plats, separate or on this reverse side, showing the roads to, and the surveyed location of, the well, and any other required information, should be furnished when required by Federal or State agency offices.

**Items 15 and 18:** If well is to be, or has been directionally drilled, give distances for subsurface location of hole in any present or objective production zone.

**Item 22:** Consult applicable Federal or State regulations, or appropriate officials, concerning approval of the proposal before operations are started.



**NEW MEXICO OIL CONSERVATION COMMISSION  
WELL LOCATION AND ACERAGE DEDICATION PLAT**

All distances must be from the outer boundaries of the Section

|   |  |                         |  |   |                       |
|---|--|-------------------------|--|---|-----------------------|
| Operator<br><b>EL PASO NATURAL GAS COMPANY</b>  |  |                         | Lease<br><b>ALLISON UNIT (SF-078459-B)</b> |   | Well No.<br><b>28</b> |
| Unit Letter<br><b>M</b>   | Section<br><b>14</b>                     | Township<br><b>32-N</b> | Range<br><b>7-W</b>                        | County<br><b>SAN JUAN</b>                 |                       |
| Actual Footage Location of Well:<br><b>1050</b> feet from the <b>SOUTH</b> line and <b>875</b> feet from the <b>WEST</b> line |  |                         |  |   |                       |
| Ground Level Elev.<br><b>6829</b>   | Producing Formation<br><b>MESA VERDE</b> |                         | Pool<br><b>BLANCO MESA VERDE</b>           | Dedicated Acreage:<br><b>320.00</b> Acres |                       |

1. Outline the acreage dedicated to the subject well by colored pencil or hachure marks on the plat below.
2. If more than one lease is dedicated to the well, outline each and identify the ownership thereof (both as to working interest and royalty),
3. If more than one lease of different ownership is dedicated to the well, have the interests of all owners been consolidated by communitization, unitization, force-pooling, etc?

Yes     No    If answer is "yes," type of consolidation ..... **Unitization** .....

If answer is "no," list the owners and tract descriptions which have actually consolidated. (Use reverse side of this Form if necessary.) .....

No allowable will be assigned to the well until all interests have been consolidated (by communitization, unitization, forced-pooling, or otherwise) or until a non standard unit, eliminating such interests, has been approved by the Commission.

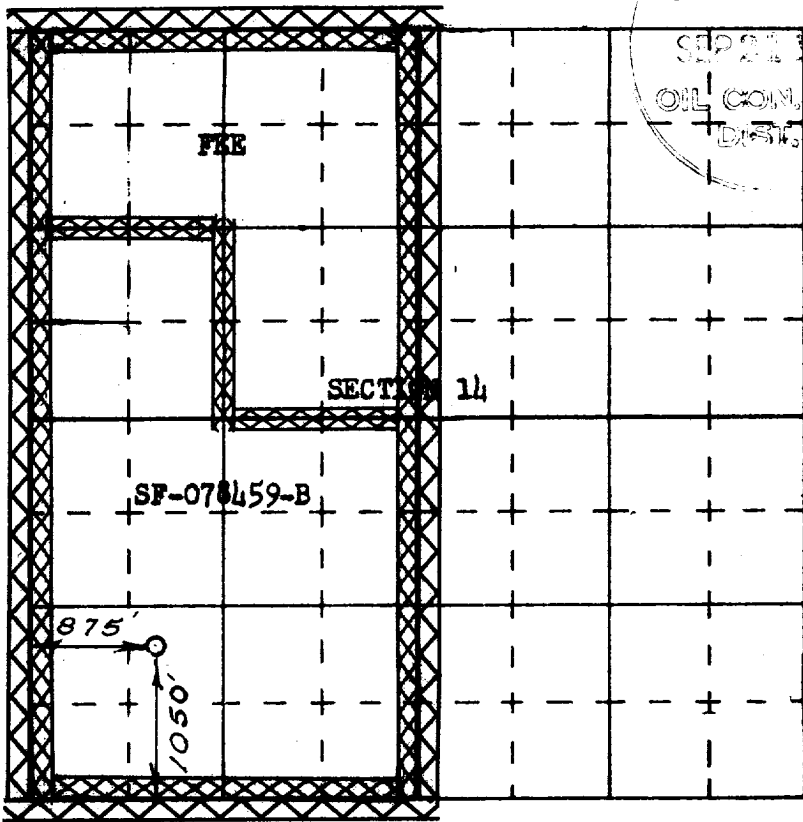

**CERTIFICATION**

I hereby certify that the information contained herein is true and complete to the best of my knowledge and belief.

Original Signed **F. H. WOOD**

Name \_\_\_\_\_  
**Petroleum Engineer**  
 Position \_\_\_\_\_  
**El Paso Natural Gas Company**  
 Company \_\_\_\_\_  
**September 28, 1967**  
 Date \_\_\_\_\_

I hereby certify that the well location shown on this plat was plotted from field notes of actual surveys made by me or under my supervision, and that the same is true and correct to the best of my knowledge and belief.

Date Surveyed \_\_\_\_\_  
**AUGUST 7, 1967**

Registered Professional Engineer  
 and/or Land Surveyor

*David P. Kilmer*  
 Certificate No. **1760**