

NO. OF COPIES RECEIVED	6
DISTRIBUTION	
SANTA FE	1
FILE	1
U.S.G.S.	2
LAND OFFICE	1
OPERATOR	1

# NEW MEXICO OIL CONSERVATION COMMISSION

30-045-21617

Form C-101  
Revised 1-1-65

5A. Indicate Type of Lease
STATE <input type="checkbox"/> FEE <input checked="" type="checkbox"/>

5. State Oil & Gas Lease No.

## APPLICATION FOR PERMIT TO DRILL, DEEPEN, OR PLUG BACK

1a. Type of Work		7. Unit Agreement Name	
b. Type of Well OIL WELL <input type="checkbox"/> GAS WELL <input checked="" type="checkbox"/> OTHER <input type="checkbox"/>		8. Farm or Lease Name Kelly A	
2. Name of Operator El Paso Natural Gas Company		9. Well No. 5	
3. Address of Operator PO Box 990, Farmington, NM 87401		10. Field and Pool, or Wildcat Undes. Pictured Cliffs	
4. Location of Well UNIT LETTER F LOCATED 1480 FEET FROM THE North LINE AND 1780 FEET FROM THE West LINE OF SEC. 15 TWP. 31N RCE. 10W NMPM		12. County San Juan	
19. Proposed Depth 3175'		19A. Formation Pictured Cliffs	
21. Elevations (Show whether DP, RT, etc.) 6168'GR		20. Rotary or C.T. Rotary	
21A. Kind & Status Plug. Bond Statewide		22. Approx. Date Work will start	

### 23. PROPOSED CASING AND CEMENT PROGRAM

SIZE OF HOLE	SIZE OF CASING	WEIGHT PER FOOT	SETTING DEPTH	SACKS OF CEMENT	EST. TOP
12 1/4"	8 5/8"	24.0#	120'	106 cu. ft.	circulate
6 3/4"	2 7/8"	6.4#	3175'	568 cu. ft.	cover Ojo Alamo

Selectively perforate and sandwater fracture the Pictured Cliffs formation.

The NW/4 of Section 15 is dedicated to this well.

A 3000 psi W.P. and 6000 psi test double gate preventor equipped with blind and pipe rams will be used for blow out prevention on this well.

IN ABOVE SPACE DESCRIBE PROPOSED PROGRAM: IF PROPOSAL IS TO DEEPEN OR PLUG BACK, GIVE DATA ON PRESENT PRODUCTIVE ZONE AND PROPOSED NEW PRODUCTIVE ZONE. GIVE BLOWOUT PREVENTER PROGRAM, IF ANY.

I hereby certify that the information above is true and complete to the best of my knowledge and belief.

Signed W. Jones Title Drilling Clerk Date December 4, 1974

(This space for State Use)

APPROVED BY Ernest C. Amato TITLE SUPERVISOR DIST. #5 DATE 12-5-74

CONDITIONS OF APPROVAL, IF ANY:

**NEW MEXICO OIL CONSERVATION COMMISSION  
WELL LOCATION AND ACREAGE DEDICATION PLAT**

Form C-102  
Supersedes C-128  
Effective 1-1-65

All distances must be from the outer boundaries of the Section.

Operator <b>EL PASO NATURAL GAS COMPANY</b>		Lease <b>KELLY A</b>		(FEE)		Well No. <b>5</b>
Unit Letter <b>F</b>	Section <b>15</b>	Township <b>31-N</b>	Range <b>10-W</b>	County <b>SAN JUAN</b>		
Actual Footage Location of Well: <div style="display: flex; justify-content: space-between;"> <span>1480 feet from the NORTH line and</span> <span>1780 feet from the WEST line</span> </div>						
Ground Level Elev. <b>6168</b>	Producing Formation <b>PICTURED CLIFFS</b>	Pool <b>UNDESIGNATED PICTURED CLIFFS</b>	Dedicated Acreage: <b>160.00 158.18</b> Acres			

1. Outline the acreage dedicated to the subject well by colored pencil or hachure marks on the plat below.
2. If more than one lease is dedicated to the well, outline each and identify the ownership thereof (both as to working interest and royalty).
3. If more than one lease of different ownership is dedicated to the well, have the interests of all owners been consolidated by communitization, unitization, force-pooling, etc?

☒ Yes    ☐ No    If answer is "yes," type of consolidation **Communitization**

If answer is "no," list the owners and tract descriptions which have actually been consolidated. (Use reverse side of this form if necessary.) \_\_\_\_\_

No allowable will be assigned to the well until all interests have been consolidated (by communitization, unitization, forced-pooling, or otherwise) or until a non-standard unit, eliminating such interests, has been approved by the Commission.

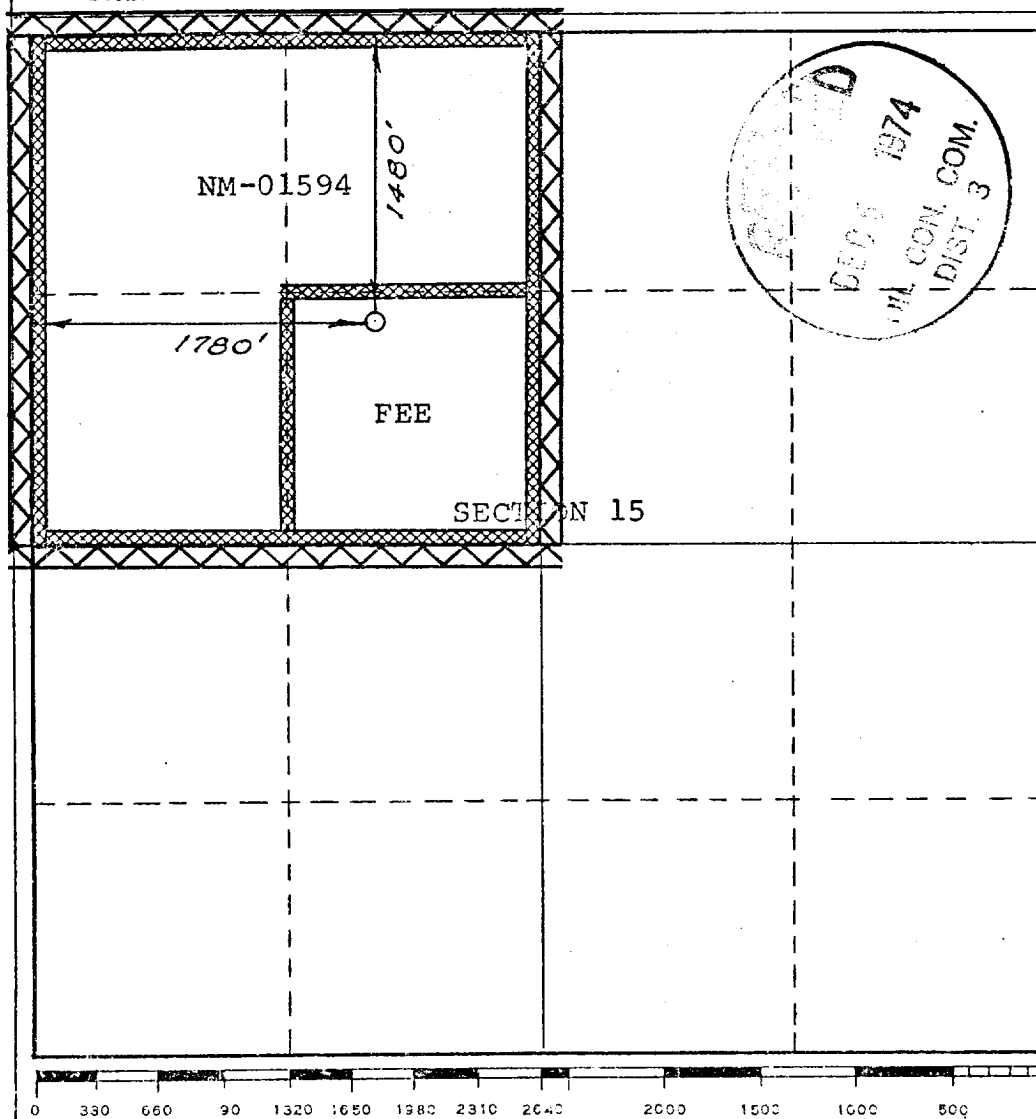

**CERTIFICATION**

I hereby certify that the information contained herein is true and complete to the best of my knowledge and belief.

Original Signed by  
**D. G. Brien**

Name  
**Drilling Clerk**  
Position  
**El Paso Natural Gas Co.**  
Company  
**December 4, 1974**  
Date

I hereby certify that the well location shown on this plat was plotted from field notes of actual surveys made by me or under my supervision, and that the same is true and correct to the best of my knowledge and belief.

Date Surveyed  
**APRIL 9, 1974**

Registered Professional Engineer  
and/or Land Surveyor

Certificate No. **1760**