

Development Plan for Surface Use
WALKER NO. 6

1. Existing Roads: (Exhibit "A")
Equipment and personnel will utilize U.S. Highway 550 approx. 5 miles west of the location. The existing exit from the highway will be used.
2. Planned Access Roads: (Exhibit "A")
Location falls near existing lease road. Very little, if any new road will have to be built.
3. Location of Existing Wells:
The proposed well is approx. 125' SW of Walker No. 1-A.
4. Lateral Roads to Well Location: (Exhibit "A")
See attached map - Exhibit "A"
5. Location of Tank Battery and Flow Line:
The same tank battery as the Walker No. 1 will be used. A 2" flow line will be laid north of the present battery. See Exhibit "A" for well locations.
6. Location and Type of Water Supply:
The source water to be used in the drilling operation will be from the irrigation ditch on U.S. Highway 550 approx. 5 miles west of the proposed location. Water will be hauled by trucks.
7. Waste Disposal:
The drilling contractor will furnish a metal toilet. Cuttings, metal, wire, etc. that will not burn, will either be buried or hauled off the location.
8. Location of Camps:
No camps are anticipated.
9. Location of Airstrips:
None required.
10. Location Layout: (Exhibit "B")
Will spot the small mobile rig in the most convenient manner on a compacted drilling pad. No particular terrain or drainage problem anticipated.
11. Plans for Restoration of the Surface:
A minimum of the area will be disturbed to build the location. Upon completion of drilling, the area will be leveled and the pits either filled or fenced as soon as the rig is moved. All areas not needed in producing operations will be seeded with a grass mixture of five pounds crested wheat grass, five pounds intermediate wheat grass and three pounds nomad alfalfa to each acre. The planting will be done when conditions are favorable.
12. General Description of the Topography, Vegetation and Other Aspects of the Area:
Area is rocky, but relatively flat with large amount of sagebrush, but few pinion trees.

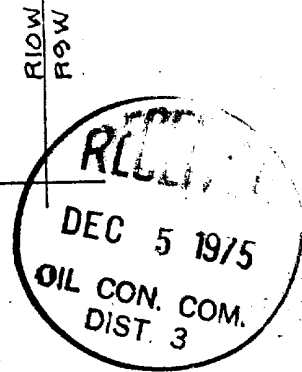

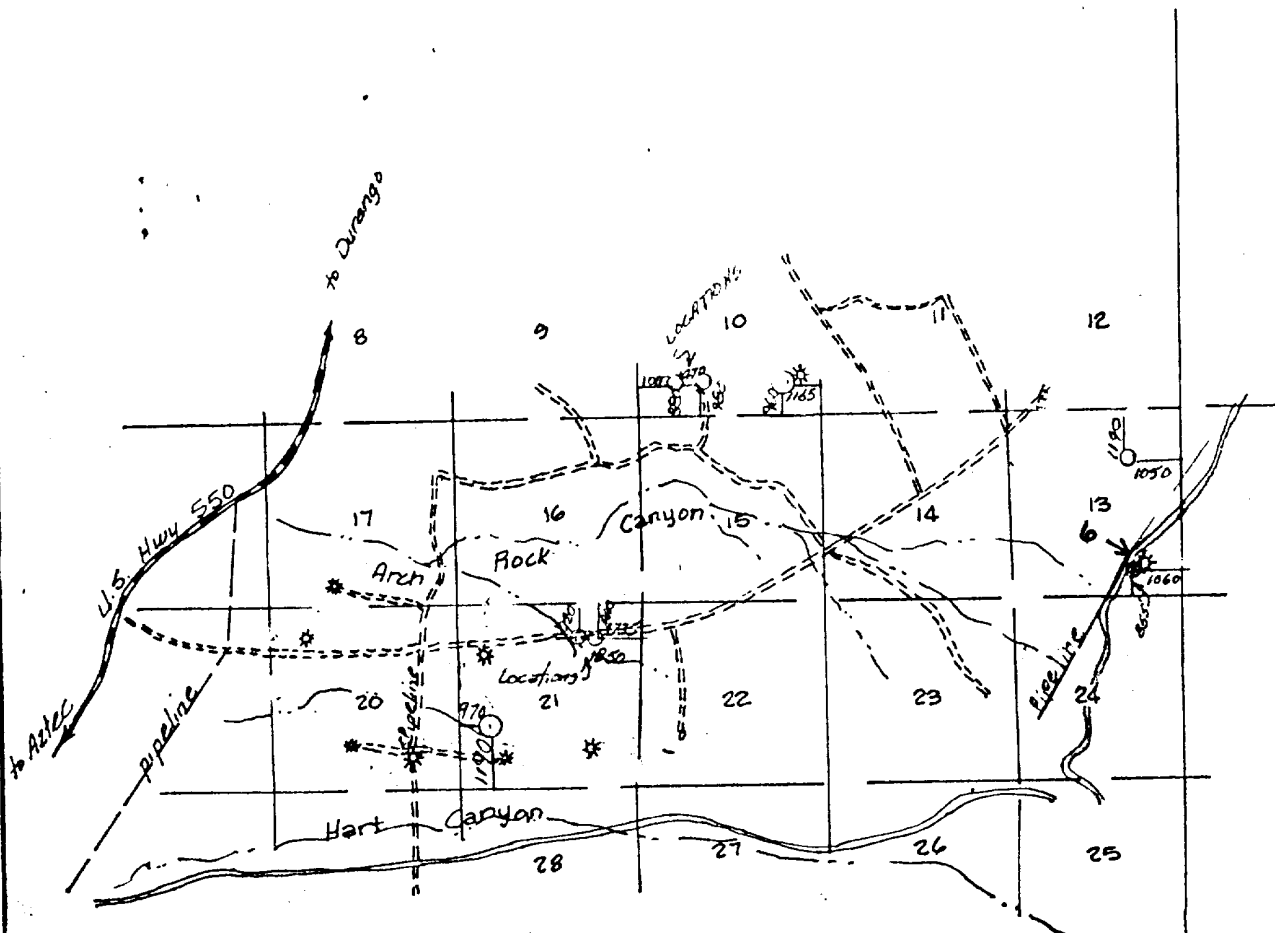

VICINITY MAP
FOR
KOCH EXPLORATION CO.
Well located in
SE/4 & NE/4 Sec. 13, & NE/4 Sec. 21,
& SW/4 Sec. 10, T31N, R10W, N.M.P.M.,
San Juan Co., New Mex. Scale: 1" = 1 mile
San Juan Engineering Co.
Farmington, New Mexico.

TOILET Δ
LOCATION APPROX. 150' x 200'

TRAILER

PIPE RACK

RIG
ENGINES
AND
PUMPS

MUD

WATER TANKS

MUD
TANKS

RESERVE PIT
APPROX. 50' x 100'

BURN PIT
APPROX.
30' x 30'

REC'D
DEC 5 1975
OIL CON. COM.
DIST. 3

N

EXHIBIT "B"

WALKER NO. 6
SE SE Sec. 13-31N-10W
San Juan County, New Mexico

P. O. Box 959
Farmington, New Mexico 87401

December 5, 1975

Koch Industries Inc.
P. O. Box 2256
Wichita, Kansas 67201

Gentlemen:

Your "Notice of Intent to Drill", form 9-331-C, submitted November 25, 1975 for well No. 6 Walker, SE $\frac{1}{4}$ SE $\frac{1}{4}$ sec. 13, T. 31N, R. 10W, San Juan County, New Mexico indicated the lease number to be NM 014110. The lease number should be NM 013688-A.

We have changed the number on our copies of the notice. If this is the correct assumption of your intent, please correct your records and inform this office and we will proceed with the processing of the intent to drill.

Sincerely yours,

(Orig. Sgd.) M. L. Seelinger

M. L. Seelinger
Acting District Engineer

cc:
NMOCC

