

UNITED STATES
DEPARTMENT OF THE INTERIOR
GEOLOGICAL SURVEY

30-045-21953

5. LEASE DESIGNATION AND SERIAL NO.

NM 03187

6. IF INDIAN, ALLOTTEE OR TRIBE NAME

7. UNIT AGREEMENT NAME

8. FARM OR LEASE NAME

LAMBE

9. WELL NO.

8

10. FIELD AND POOL, OR WILDCAT

Blanco
Pictured cliffs11. SEC., T., R., M., OR BLK.
AND SURVEY OR AREA

Sec. 21-31N-10W

12. COUNTY OR PARISH 13. STATE

San Juan New Mexico

APPLICATION FOR PERMIT TO DRILL, DEEPEN, OR PLUG BACK

1a. TYPE OF WORK

DRILL ☒DEEPEN ☐PLUG BACK ☐

b. TYPE OF WELL

OIL
WELL ☐GAS
WELL ☒

OTHER

SINGLE
ZONE ☒MULTIPLE
ZONE ☐

2. NAME OF OPERATOR

Koch Industries Inc.

3. ADDRESS OF OPERATOR

P.O. Box 2256, Wichita, Kansas 67201

4. LOCATION OF WELL (Report location clearly and in accordance with any State requirements.)*

At surface

1070' FNL & 1850' FEL SE NW NE

At proposed prod. zone

14. DISTANCE IN MILES AND DIRECTION FROM NEAREST TOWN OR POST OFFICE*

Approx. 15 miles NE of Bloomfield

15. DISTANCE FROM PROPOSED*

LOCATION TO NEAREST
PROPERTY OR LEASE LINE, FT.

(Also to nearest drlg. unit line, if any) 860' FNL

16. NO. OF ACRES IN LEASE

310.38

17. NO. OF ACRES ASSIGNED
TO THIS WELL

154.64

18. DISTANCE FROM PROPOSED LOCATION*

TO NEAREST WELL, DRILLING, COMPLETED,
OR APPLIED FOR, ON THIS LEASE, FT.

Appr. 285' SW

19. PROPOSED DEPTH

2900'

20. ROTARY OR CABLE TOOLS

Rotary

21. ELEVATIONS (Show whether DF, RT, GR, etc.)

6147' GR

22. APPROX. DATE WORK WILL START*

1-21-76

23. PROPOSED CASING AND CEMENTING PROGRAM

SIZE OF HOLE	SIZE OF CASING	WEIGHT PER FOOT	SETTING DEPTH	QUANTITY OF CEMENT
8-3/4"	7"	26#	200'	150
6-1/4"	4 1/2"	10.5#	2900'	350

1. Set SH 7" csg. tested to 3000# @ 200'. Cement w/enough to circ. to surface. WOC 24 hours.
 2. Test csg. to 1000# & drill to approx. 1800' w/native mud. Mud up w/ Gel-Benex type mud & drill thru Pictured Cliffs. Run approx. 2900' of new 4 1/2" 10.5# CW-55 ST&C csg. Use enough cement to cover Ojo.
 3. 8" LWP Shaeffer double pipe ram BOP's will be used. Check BOP's each tour & blind rams each trip.
 4. Well head will be LP screw type - will not be used to frac through.
 5. Mud program: 0-200' Gel-Lime Slurry, 200-1800' Water & Benex, 1800-2900' Gel-Spersene Mud.
 6. Anticipated BHP at TD max. of 1000#. No abnormal pressures anticipated.
 7. Auxillary & BOP equipment on rig as follows: (A) Double ram BOP, (B) Kelly cocks (if required), (C) Rotating drilling head (if required), (D) Kill valve on rig floor.
 8. Complete well by swabbing csg. dry. Perf Pictured Cliffs w/2 HPF & frac
- IN ABOVE SPACE DESCRIBE PROPOSED PROGRAM: If proposal is to deepen or plug back, give data on present productive zone and proposed new productive zone. If proposal is to drill or deepen directionally, give pertinent data on subsurface locations and measured and true vertical depths. Give blowout preventer program, if any. w/slick water & sand.

24.

SIGNED

Ernest L. Schmit

TITLE

Operations Manager

DATE

12-1-75

(This space for Federal or State office use)

PERMIT NO.

APPROVAL DATE

APPROVED BY

TITLE

CONDITIONS OF APPROVAL, IF ANY:

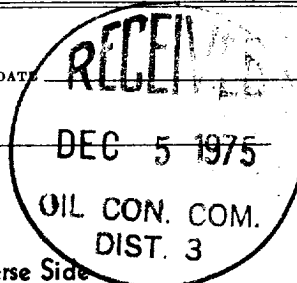
OK

*See Instructions On Reverse Side

**NEW MEXICO OIL CONSERVATION COMMISSION
WELL LOCATION AND ACREAGE DEDICATION PLAT**

Form O-10
Supersedes C-128
Effective 1-1-65

All distances must be from the outer boundaries of the Section

Operator KOCH EXPLORATION COMPANY			Lease LAMBE		Well No. 8
Unit Letter B	Section 21	Township 31 NORTH	Range 10 WEST	County SAN JUAN	
Actual Footage Location of Well: 1070 feet from the NORTH line and 1850 feet from the EAST line					
Ground Level Elev. 6147	Producing Formation Pictured Cliffs		Pool Blanco	Dedicated Acreage: 154.64 Acres	

- Outline the acreage dedicated to the subject well by colored pencil or hachure marks on the plat below.
- If more than one lease is dedicated to the well, outline each and identify the ownership thereof (both as to working interest and royalty).
- If more than one lease of different ownership is dedicated to the well, have the interests of all owners been consolidated by communitization, unitization, force-pooling, etc?

☐ Yes ☐ No If answer is "yes," type of consolidation _____

If answer is "no," list the owners and tract descriptions which have actually been consolidated. (Use reverse side of this form if necessary.) _____

No allowable will be assigned to the well until all interests have been consolidated (by communitization, unitization, forced-pooling, or otherwise) or until a non-standard unit, eliminating such interests, has been approved by the Commission.

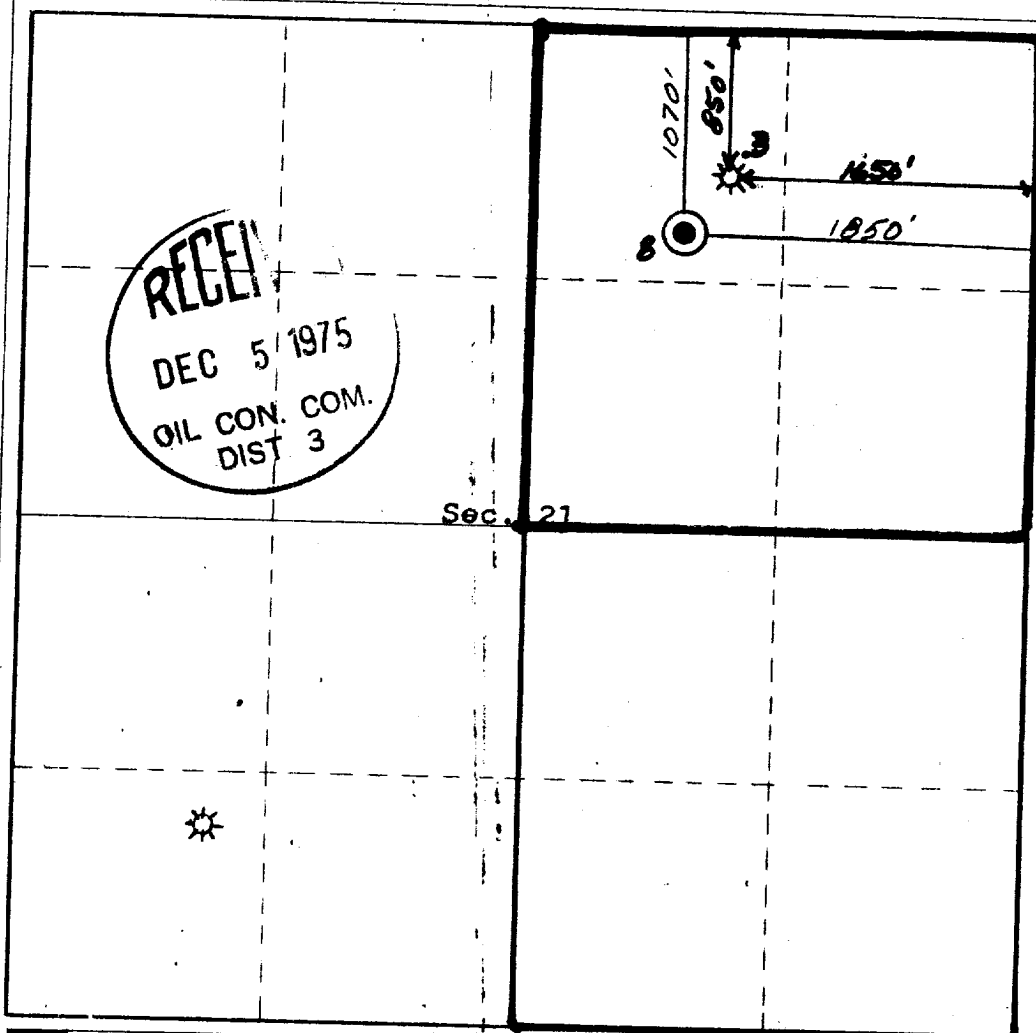

CERTIFICATION

I hereby certify that the information contained herein is true and complete to the best of my knowledge and belief.

Dwight L. Schriest
Name

Operations Manager

Position

Koch Industries Inc.

Company

December 1, 1975

Date

I hereby certify that the well location shown on this plat was plotted from field notes of surveys made by me or under my supervision and that the same is true and correct to the best of my knowledge and belief.

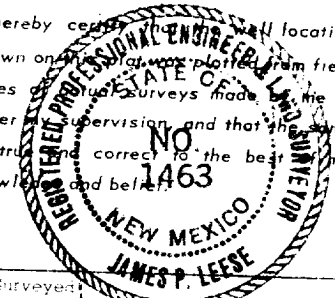

Date Surveyed

26 November, 1975

Registered Professional Engineer and/or Land Surveyor

James P. Leese

James P. Leese

Certificate No.

1463

