

**NEW MEXICO OIL CONSERVATION COMMISSION  
WELL LOCATION AND ACREAGE DEDICATION PLAT**

Form O-102  
Supersedes O-128  
Effective 1-1-65

All distances must be from the outer boundaries of the Section.

Operator <b>Atlantic Richfield Company</b>			Lease		Well No. <b>293</b>
Unit Letter <b>C</b>	Section <b>30</b>	Township <b>31</b>	Range <b>16</b>	County <b>San Juan</b>	
Actual Footage Location of Well:					
<b>1260</b>		feet from the <b>North</b>		line and <b>1470</b> feet from the <b>West</b> line	
Ground Level Elev. <b>5625</b>	Producing Formation <b>Gallup</b>	Pool <b>Horseshoe Gallup</b>		Dedicated Acreage <b>NA - Unitized</b>	

Re: Order No. R-2210-

1. Outline the acreage dedicated to the subject well by colored pencil or hatchure marks on the plat below.
2. If more than one lease is dedicated to the well, outline each and identify the ownership thereof (both as to working interest and royalty).
3. If more than one lease of different ownership is dedicated to the well, have the interests of all owners been consolidated by communitization, unitization, force-pooling, etc?

☒ Yes    ☐ No    If answer is "yes," type of consolidation Unitization

If answer is "no," list the owners and tract descriptions which have actually been consolidated. (Use reverse side of this form if necessary.) \_\_\_\_\_

No allowable will be assigned to the well until all interests have been consolidated (by communitization, unitization, forced-pooling, or otherwise) or until a non-standard unit, eliminating such interests, has been approved by the Commission.

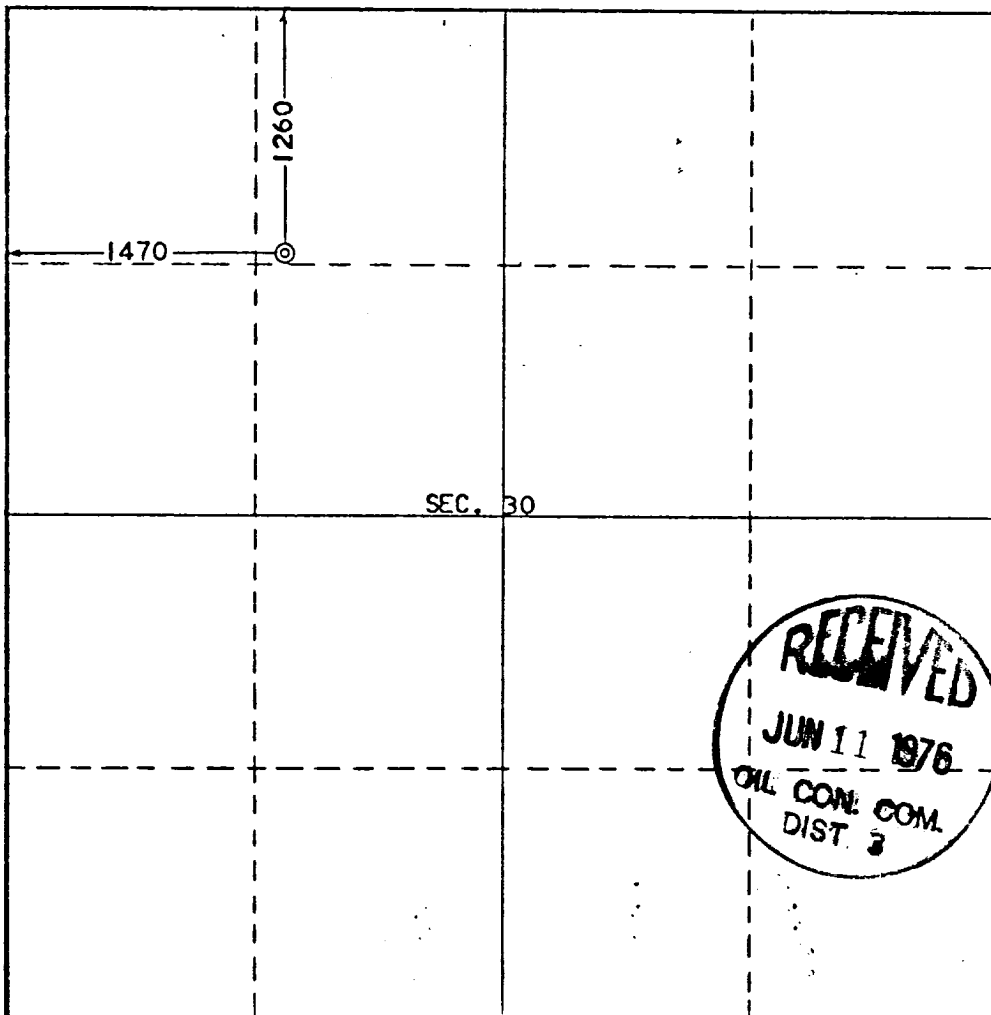

**CERTIFICATION**

I hereby certify that the information contained herein is true and complete to the best of my knowledge and belief.

Name W. A. Walther, Jr.  
 Position W. A. Walther, Jr.  
Operations Manager  
 Company ATLANTIC RICHFIELD COMPANY  
 Date \_\_\_\_\_

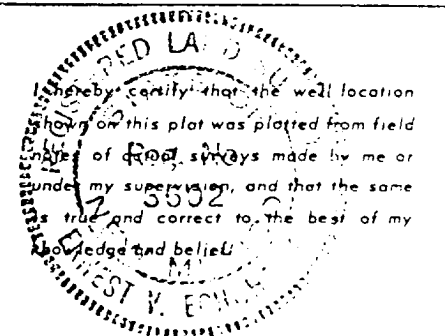

Date Surveyed May 20, 1976  
 Registered Professional Engineer and/or Land Surveyor  
E. V. Echhawk  
 Certificate No. 3602  
**E.V. Echhawk LS**

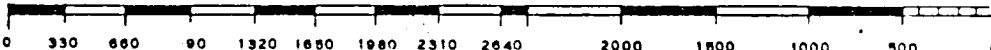

## OIL CONSERVATION COMMISSION

By Tex DISTRICT

OIL CONSERVATION COMMISSION  
BOX 2088  
SANTA FE, NEW MEXICO

DATE

June 11, 1976

RE:

Proposed MC

Proposed DHC

Proposed NSL

Proposed SWD

Proposed WFX

Proposed PMX

*Jim Kapteina*

Gentlemen:

I have examined the application dated June 7, 1976  
for the Atlantic Richfield  
Operator Lease and Well No. Unit, S-T-R

and my recommendations are as follows:

Versus Pac Gallup Unit # 291, 292, 293, 294  
295, 296 & 297.

Approve: All wells are inside location.  
#294 does not identify it to be 10 feet from  
the 40-acre line as required by Ordinance 2210-A

Yours very truly,

*MR. Kendrick*

Rocky Mountain District  
1860 Lincoln St. — Suite 501  
Denver, Colorado 80203  
Telephone 303 573-4049

W. A. Walther, Jr.  
Operations Manager



JUN - 9 1976  
OIL CONSERVATION COM.  
Santa Fe

June 7, 1976

Mr. Joe D. Ramey, Secretary-Director  
Oil Conservation Commission, State of New Mexico  
P. C. Box 2088  
Santa Fe, New Mexico 87501

Re: Horseshoe Gallup Unit  
San Juan County, New Mexico

Dear Mr. Ramey:

Atlantic Richfield Company, Operator of the Horseshoe Gallup Unit, and pursuant Case No. 5236, Order No. R-2210-A, hereby requests administrative approval to drill seven (7) infill Gallup formation producing wells at unorthodox locations. As set forth in Order No. R-2210-A, the following are enclosed:

1. (a) Copy of Certified Location Plat, each well.  
(b) Copy of Application for Permit to Drill, each well.  
(c) Map showing the Unit boundary, all existing wells, and location of the seven (7) proposed wells.
2. Schematic drawing for each well, based on current information.

Atlantic Richfield Company is the Operator of all offset locations, therefore, notification to offset operators is not required.

Your administrative approval is respectfully requested.

Very truly yours,

  
W. A. Walther, Jr.

Encls.

