

PERTINENT DRILLING INFORMATION

HORSESHOE GALLUP UNIT, Well #29h  
1378' f/South & 1325' f/East lines  
Sec. 30-31N-16W, San Juan County, New Mexico

1. Surface Casing: 8-5/8" OD 24# J-55 ST&C SH 120'
2. Casing Head: 8-5/8" x 10", Ser. 600 (2000#WP, 4000#T) OCT C-22 or equivalent, w/2 - 2" LP outlets w/1 - 2000#WP valve.
3. Intermediate Casing: None
4. Blowout Preventer:
  - Type - Ram Type
  - Series - Ser. 600 (2000#WP, 4000#T) or greater
  - No. of Rams - Two; one blind ram and one pipe ram for size drill pipe in use.
  - Manufacturer - Cameron or Shaffer, hydraulic operated. Fill, kill and choke line will be 2000#WP or greater, connected below rams on BOP.
  - Blowout Equipment - Will be pressure tested to 800 psi before drilling out of casing and operational checks will be made daily.
5. Auxiliary Equipment: Kelly Cock  
Sub with full opening valve on floor for use when kelly not in hole.
6. Anticipated Bottom Hole or Maximum Expected Pressure: 700 psi
7. Drilling Fluids:
  - Surface - Water & gel w/lime to maintain clean hole for running casing.
  - Below Surface - Water w/necessary gel and chemicals to maintain drillable hole. 9.0<sup>+</sup> ppg, viscosity as required, 10<sup>+</sup> water loss, LCM if required. Maintain stock weight material on location.



< 8" Cut >

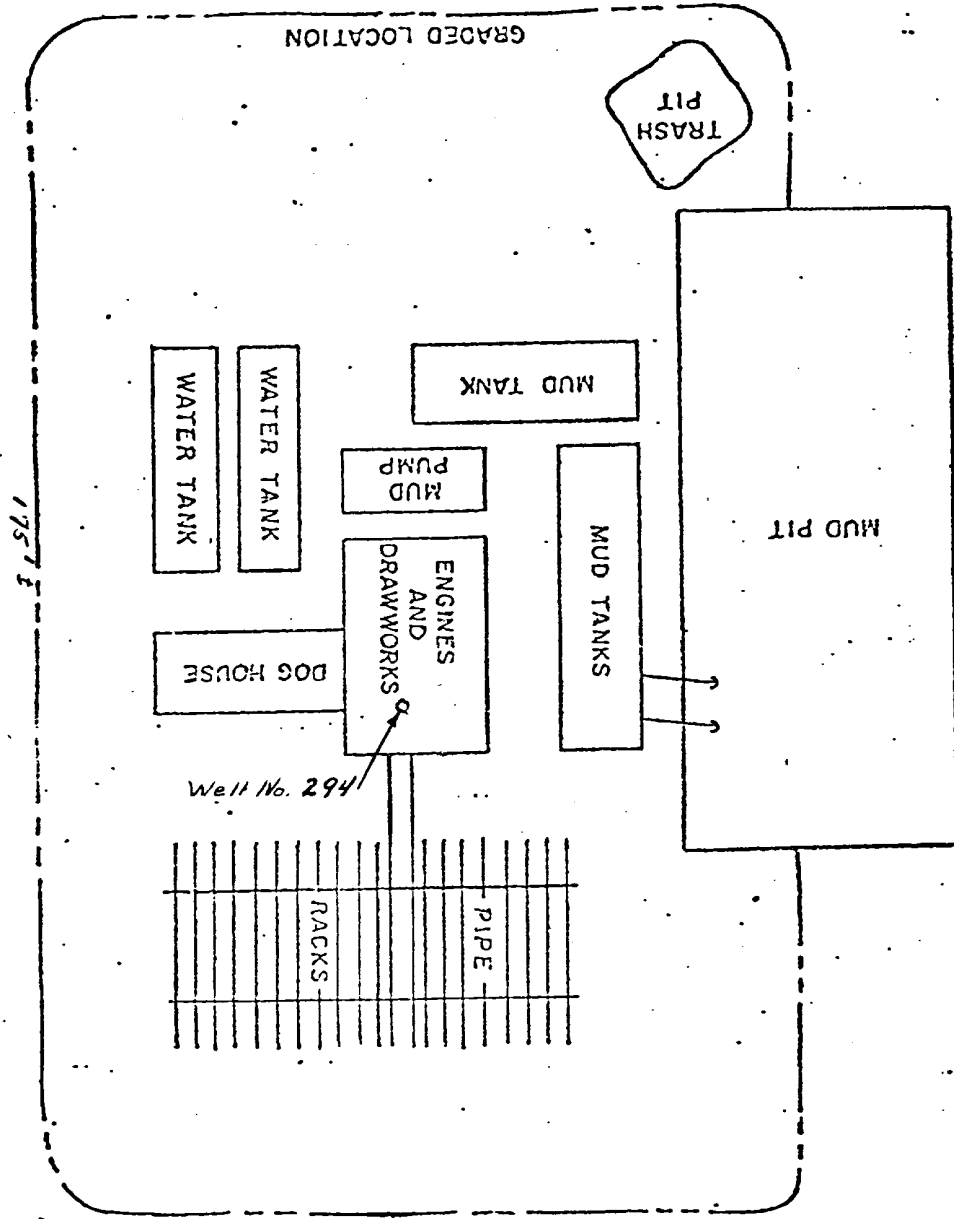

**RECEIVED**  
JUN 9 1976  
OIL CON. CON.  
DIST 3

DEVELOPMENT PLAN FOR SURFACE USE

1. Existing Roads: Attached is a portion of the Chimney Rock quadrangle map showing main access from Hwy 550, approximately 3 miles east of Ship Rock, New Mexico. Also attached is a Lease Road map showing the main lease roads in the vicinity of the proposed location.
2. Planned Access Roads: The attached Lease Road Map shows the main lease roads in the vicinity of the proposed location. Access road to be constructed has been marked in "red".
3. Location of Existing Wells: Existing wells in the vicinity of the proposed location are shown on both the attached Lease Road map and Flow Line map.
4. Lateral Roads to Well Locations: Lateral roads to well locations are shown on the Lease Road Map.
5. Location of Tank Batteries and Flow Lines: The attached Flow Line map shows the existing flow line and battery installations. The flow line to be installed, if the well is productive, has been marked in "green".
6. Location and Type of Water Supply: Water supply for drilling will be from Water Supply Well #2-W (NW NW Sec. 32-31N-16W). Water for cementing operations will be from ditch at turnoff of access road from Hwy. 550.
7. Methods for Handling Waste Disposal: Cuttings to be disposed of in reserve pit, a burn pit to be used for disposal of trash, garbage, etc., and both pits to be filled and levelled on cleanup of location.
8. Location of Camps: None
9. Location of Airstrips: None
10. Rig Layout: Per the attached drawing.
11. Restoration of Surface: Upon completion of drilling operations, the disturbed surface will be restored as near as practical to its original contours. If sufficient topsoil is encountered, it will be stockpiled for restoration of the surface. Restoration will be to the satisfaction of the United States Geological Survey.
12. This location is relatively flat with some downward slope from north to south and southeast. Approximately an 8" cut will be required on the north-northwest side and an 8" fill on the south - southeast side. There is only a very small amount of vegetation, some pasture grasses and a few tumble weeds. Any disturbance to wildlife, vegetation, and local environment will be very minimal and for only a temporary duration.



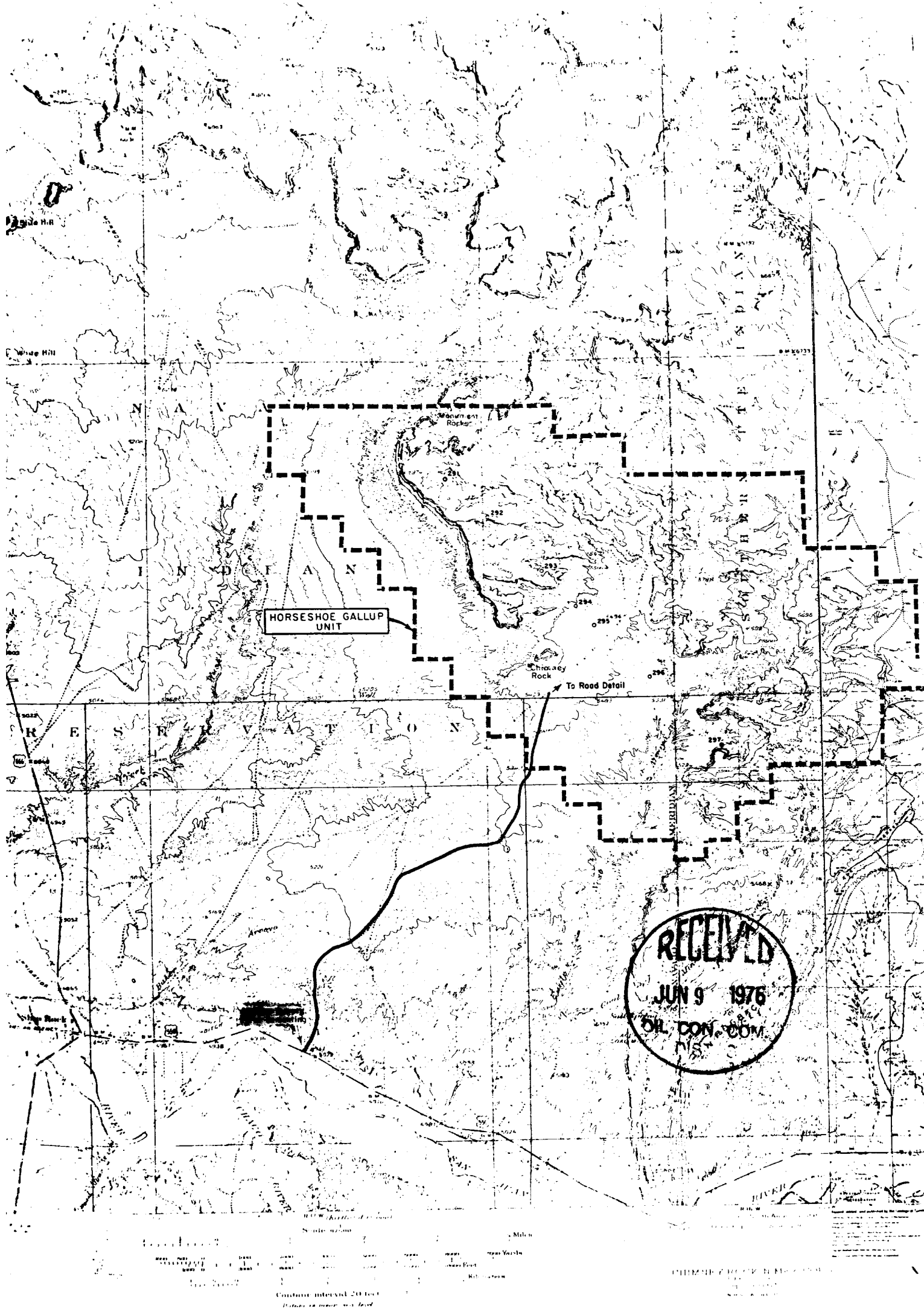

Lease Roads

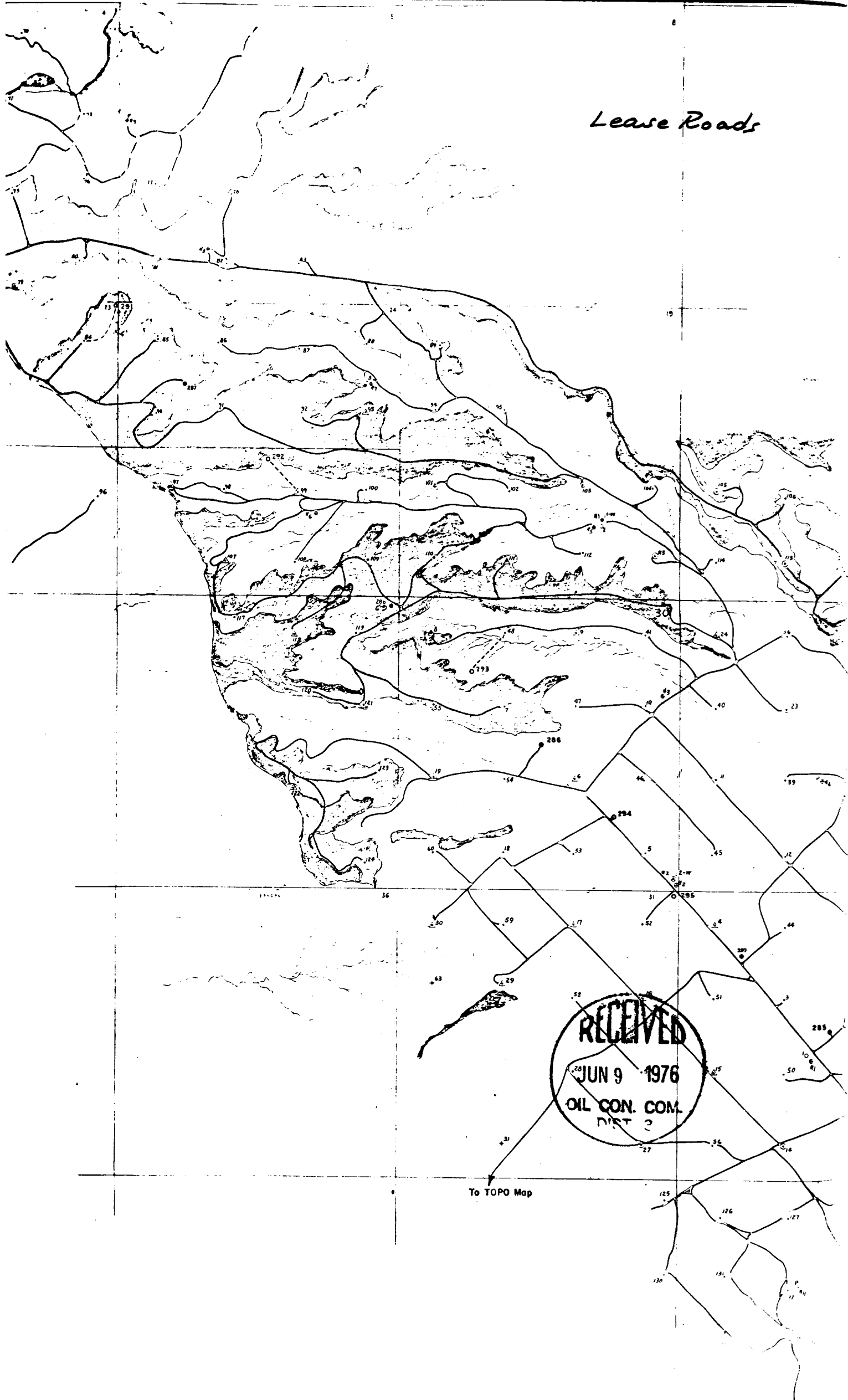

RECEIVED  
JUN 9 1976  
OIL CON. COM.  
DIST 2

To TOPO Map

Flow Lines

NAVAJO INDIAN UTE INDIAN

NAVAJO TRIBAL ATLANTIC

MOBIL OIL CO.

NAVAJO "A"

EPN 89 C 292

ATLANTIC

Water Supply

RECEIVED JUN 9 1976

NAVAJO "B"

NAVAJO "C"

LEGEND

- Proposed Plantings
- Future Oil Flowlines
- Proposed Buried Oil Flowlines
- Future Oil Flowlines

NAVAJO "A"

NAVAJO "B"

NAVAJO "C"

NAVAJO "D"

NAVAJO "E"

NAVAJO "F"

NAVAJO "G"

NAVAJO "H"

NAVAJO "I"

NAVAJO "J"

NAVAJO "K"

NAVAJO "L"

NAVAJO "M"

NAVAJO "N"

NAVAJO "O"

NAVAJO "P"

NAVAJO "Q"

NAVAJO "R"

NAVAJO "S"

NAVAJO "T"

NAVAJO "U"

NAVAJO "V"

NAVAJO "W"

NAVAJO "X"

NAVAJO "Y"

NAVAJO "Z"

NAVAJO "AA"

NAVAJO "AB"

NAVAJO "AC"

NAVAJO "AD"

NAVAJO "AE"

NAVAJO "AF"

NAVAJO "AG"

NAVAJO "AH"

NAVAJO "AI"

NAVAJO "AJ"

NAVAJO "AK"

NAVAJO "AL"

NAVAJO "AM"

NAVAJO "AN"

NAVAJO "AO"

NAVAJO "AP"

NAVAJO "AQ"

NAVAJO "AR"

NAVAJO "AS"

NAVAJO "AT"

NAVAJO "AU"

NAVAJO "AV"

NAVAJO "AW"

NAVAJO "AX"

NAVAJO "AY"

NAVAJO "AZ"

NAVAJO "BA"

NAVAJO "BB"

NAVAJO "BC"

NAVAJO "BD"

NAVAJO "BE"

NAVAJO "BF"

NAVAJO "BG"

NAVAJO "BH"

NAVAJO "BI"

NAVAJO "BJ"

NAVAJO "BK"

NAVAJO "BL"

NAVAJO "BM"

NAVAJO "BN"

NAVAJO "BO"

NAVAJO "BP"

NAVAJO "BQ"

NAVAJO "BR"

NAVAJO "BS"

NAVAJO "BT"

NAVAJO "BU"

NAVAJO "BV"

NAVAJO "BW"

NAVAJO "BX"

NAVAJO "BY"

NAVAJO "BZ"

NAVAJO "CA"

NAVAJO "CB"

NAVAJO "CC"

NAVAJO "CD"

NAVAJO "CE"

NAVAJO "CF"

NAVAJO "CG"

NAVAJO "CH"

NAVAJO "CI"

NAVAJO "CJ"

NAVAJO "CK"

NAVAJO "CL"

NAVAJO "CM"

NAVAJO "CN"

NAVAJO "CO"

NAVAJO "CP"

NAVAJO "CQ"

NAVAJO "CR"

NAVAJO "CS"

NAVAJO "CT"

NAVAJO "CU"

NAVAJO "CV"

NAVAJO "CW"

NAVAJO "CX"

NAVAJO "CY"

NAVAJO "CZ"

NAVAJO "DA"

NAVAJO "DB"

NAVAJO "DC"

NAVAJO "DD"

NAVAJO "DE"

NAVAJO "DF"

NAVAJO "DG"

NAVAJO "DH"

NAVAJO "DI"

NAVAJO "DJ"

NAVAJO "DK"

NAVAJO "DL"

NAVAJO "DM"

NAVAJO "DN"

NAVAJO "DO"

NAVAJO "DP"

NAVAJO "DQ"

NAVAJO "DR"

NAVAJO "DS"

NAVAJO "DT"

NAVAJO "DU"

NAVAJO "DV"

NAVAJO "DW"

NAVAJO "DX"

NAVAJO "DY"

NAVAJO "DZ"

NAVAJO "EA"

NAVAJO "EB"

NAVAJO "EC"

NAVAJO "ED"

NAVAJO "EE"

NAVAJO "EF"

NAVAJO "EG"

NAVAJO "EH"

NAVAJO "EI"

NAVAJO "EJ"

NAVAJO "EK"

NAVAJO "EL"

NAVAJO "EM"

NAVAJO "EN"

NAVAJO "EO"

NAVAJO "EP"

NAVAJO "EQ"

NAVAJO "ER"

NAVAJO "ES"

NAVAJO "ET"

NAVAJO "EU"

NAVAJO "EV"

NAVAJO "EW"

NAVAJO "EX"

NAVAJO "EY"

NAVAJO "EZ"

NAVAJO "FA"

NAVAJO "FB"

NAVAJO "FC"

NAVAJO "FD"

NAVAJO "FE"

NAVAJO "FF"

NAVAJO "FG"

NAVAJO "FH"

NAVAJO "FI"

NAVAJO "FJ"

NAVAJO "FK"

NAVAJO "FL"

NAVAJO "FM"

NAVAJO "FN"

NAVAJO "FO"

NAVAJO "FP"

NAVAJO "FQ"

NAVAJO "FR"

NAVAJO "FS"

NAVAJO "FT"

NAVAJO "FU"

NAVAJO "FV"

NAVAJO "FW"

NAVAJO "FX"

NAVAJO "FY"

NAVAJO "FZ"

NAVAJO "GA"

NAVAJO "GB"

NAVAJO "GC"

NAVAJO "GD"

NAVAJO "GE"

NAVAJO "GF"

NAVAJO "GG"

NAVAJO "GH"

NAVAJO "GI"

NAVAJO "GJ"

NAVAJO "GK"

NAVAJO "GL"

NAVAJO "GM"

NAVAJO "GN"

NAVAJO "GO"

NAVAJO "GP"

NAVAJO "GQ"

NAVAJO "GR"

NAVAJO "GS"

NAVAJO "GT"

NAVAJO "GU"

NAVAJO "GV"

NAVAJO "GW"

NAVAJO "GX"

NAVAJO "GY"

NAVAJO "GZ"

NAVAJO "HA"

NAVAJO "HB"

NAVAJO "HC"

NAVAJO "HD"

NAVAJO "HE"

NAVAJO "HF"

NAVAJO "HG"

NAVAJO "HH"

NAVAJO "HI"

NAVAJO "HJ"

NAVAJO "HK"

NAVAJO "HL"

NAVAJO "HM"

NAVAJO "HN"

NAVAJO "HO"

NAVAJO "HP"

NAVAJO "HQ"

NAVAJO "HR"

NAVAJO "HS"

NAVAJO "HT"

NAVAJO "HU"

NAVAJO "HV"

NAVAJO "HW"

NAVAJO "HX"

NAVAJO "HY"

NAVAJO "HZ"

NAVAJO "IA"

NAVAJO "IB"

NAVAJO "IC"

NAVAJO "ID"

NAVAJO "IE"

NAVAJO "IF"

NAVAJO "IG"

NAVAJO "IH"

NAVAJO "II"

NAVAJO "IJ"

NAVAJO "IK"

NAVAJO "IL"

NAVAJO "IM"

NAVAJO "IN"

NAVAJO "IO"

NAVAJO "IP"

NAVAJO "IQ"

NAVAJO "IR"

NAVAJO "IS"

NAVAJO "IT"

NAVAJO "IU"

NAVAJO "IV"

NAVAJO "IW"

NAVAJO "IX"

NAVAJO "IY"

NAVAJO "IZ"

NAVAJO "JA"

NAVAJO "JB"

NAVAJO "JC"

NAVAJO "JD"

NAVAJO "JE"

NAVAJO "JF"

NAVAJO "JG"

NAVAJO "JH"

NAVAJO "JI"

NAVAJO "JJ"

NAVAJO "JK"

NAVAJO "JL"

NAVAJO "JM"

NAVAJO "JN"

NAVAJO "JO"

NAVAJO "JP"

NAVAJO "JQ"

NAVAJO "JR"

NAVAJO "JS"

NAVAJO "JT"

NAVAJO "JU"

NAVAJO "JV"

NAVAJO "JW"

NAVAJO "JX"

NAVAJO "JY"

NAVAJO "JZ"

NAVAJO "KA"

NAVAJO "KB"

NAVAJO "KC"

NAVAJO "KD"

NAVAJO "KE"

NAVAJO "KF"

NAVAJO "KG"

NAVAJO "KH"

NAVAJO "KI"

NAVAJO "KJ"

NAVAJO "KK"

NAVAJO "KL"

NAVAJO "KM"

NAVAJO "KN"

NAVAJO "KO"

NAVAJO "KP"

NAVAJO "KQ"

NAVAJO "KR"

NAVAJO "KS"

NAVAJO "KT"

NAVAJO "KU"

NAVAJO "KV"

NAVAJO "KW"

NAVAJO "KX"

NAVAJO "KY"

NAVAJO "KZ"

NAVAJO "LA"

NAVAJO "LB"

NAVAJO "LC"

NAVAJO "LD"

NAVAJO "LE"

NAVAJO "LF"

NAVAJO "LG"

NAVAJO "LH"

NAVAJO "LI"

NAVAJO "LJ"

NAVAJO "LK"

NAVAJO "LL"

NAVAJO "LM"

NAVAJO "LN"

NAVAJO "LO"

NAVAJO "LP"

NAVAJO "LQ"

NAVAJO "LR"

NAVAJO "LS"

NAVAJO "LT"

NAVAJO "LU"

NAVAJO "LV"

NAVAJO