

UNITED STATES  
DEPARTMENT OF THE INTERIOR

GEOLOGICAL SURVEY

API 30-045-221031-20-603-2037

APPLICATION FOR PERMIT TO DRILL, DEEPEN, OR PLUG BACK

1a. TYPE OF WORK  
DRILL ☒ DEEPEN ☐ PLUG BACK ☐

b. TYPE OF WELL  
OIL WELL ☒ GAS WELL ☐ OTHER ☐  
SINGLE ZONE ☒ MULTIPLE ZONE ☐

2. NAME OF OPERATOR  
Atlantic Richfield Company

3. ADDRESS OF OPERATOR  
501 Lincoln Tower Bldg., 1860 Lincoln St., Denver, Colo. 80203

4. LOCATION OF WELL (Report location clearly and in accordance with any State requirements.\*)  
At surface  
Unit "J" - 2474' f/South & 2463' f/East lines Sec. 24  
At proposed prod. zone  
Approx. same

14. DISTANCE IN MILES AND DIRECTION FROM NEAREST TOWN OR POST OFFICE\*  
See attached maps

15. DISTANCE FROM PROPOSED\* 166' f/Tr. 15 line  
LOCATION TO NEAREST PROPERTY OR LEASE LINE, FT.  
(Also to nearest drlg. unit line, if any)  
18. DISTANCE FROM PROPOSED LOCATION\* 822' f/#99 in  
TO NEAREST WELL, DRILLING, COMPLETED, OR APPLIED FOR, ON THIS LEASE, FT. NW SE Sec. 24  
16. NO. OF ACRES IN LEASE  
Tr. 15 - 880.00 Ac.  
Unit - 13,527.80 Ac.  
19. PROPOSED DEPTH  
1530'

21. ELEVATIONS (Show whether DF, RT, GR, etc.)  
5707' GL, Ungr.

23. PROPOSED CASING AND CEMENTING PROGRAM

| SIZE OF HOLE | SIZE OF CASING | WEIGHT PER FOOT | SETTING DEPTH | QUANTITY OF CEMENT      |
|--------------|----------------|-----------------|---------------|-------------------------|
| 12-1/4"      | 8-5/8"         | 24#             | 120'          | 125 sx (Cmt to surface) |
| 7-7/8"       | 5-1/2"         | 14#             | T.D.          | 225 sx                  |

Propose to drill well to depth sufficient to test the Gallup Formation. Est tops: Upper Gallup 1305', Lower Gallup 1415'. Will set 8-5/8" OF surface casing at approx. 120' and cement to surface; drill 7-7/8" hole to T.D.; log; if productive, set 5-1/2" OD casing w/ sufficient cement to protect all zones. Productive zone(s) will be perforated, treated if necessary, and well completed.

Re: New Mexico Oil Conservation Commission Order No. R-2210 and R-2210-A

Attachments: Certified Location Plat  
Pertinent Drilling Information  
Development Plan for Surface Use w/ att.  
Archaeological Clearance Report

RECEIVED

JUN 7 1976

U. S. GEOLOGICAL SURVEY  
WASHINGTON, D. C.

IN ABOVE SPACE DESCRIBE PROPOSED PROGRAM: If proposal is to deepen or plug back, give data on present productive zone and proposed new productive zone. If proposal is to drill or deepen directionally, give pertinent data on subsurface locations and measured and true vertical depths. Give blowout preventer program, if any.

24. SIGNED W. A. Walther, Jr. TITLE Operations Manager DATE 6/4/76  
(This space for Federal or State office use)

PERMIT NO. \_\_\_\_\_ APPROVAL DATE \_\_\_\_\_

APPROVED BY abal TITLE \_\_\_\_\_  
CONDITIONS OF APPROVAL, IF ANY:

\*See Instructions On Reverse Side



**NEW MEXICO OIL CONSERVATION COMMISSION  
WELL LOCATION AND ACREAGE DEDICATION PLAT**

Form C-102  
Supersedes C-128  
Effective 1-1-65

All distances must be from the outer boundaries of the Section.

|  |                                      |                       |                                 |   |                        |
|--|--------------------------------------|-----------------------|---------------------------------|---|------------------------|
| Operator<br><b>Atlantic Richfield Company</b>  |                                      |                       | Lease                           |   | Well No.<br><b>292</b> |
| Unit Letter<br><b>J</b>  | Section<br><b>24</b>                 | Township<br><b>31</b> | Range<br><b>17</b>              | County<br><b>San Juan</b>                     |                        |
| Actual Footage Location of Well:<br><b>2474</b> feet from the <b>South</b> line and <b>2463</b> feet from the <b>East</b> line |                                      |                       |                                 |   |                        |
| Ground Level Elev.<br><b>5707</b>  | Producing Formation<br><b>Gallup</b> |                       | Pool<br><b>Horseshoe Gallup</b> | Dedicated Acreage: <b>NA - Unitized</b> Acres |                        |

Re: Order No. R-2210-A

1. Outline the acreage dedicated to the subject well by colored pencil or hachure marks on the plat below.
2. If more than one lease is dedicated to the well, outline each and identify the ownership thereof (both as to working interest and royalty).
3. If more than one lease of different ownership is dedicated to the well, have the interests of all owners been consolidated by communitization, unitization, force-pooling, etc?

☒ Yes    ☐ No    If answer is "yes," type of consolidation Unitization

If answer is "no," list the owners and tract descriptions which have actually been consolidated. (Use reverse side of this form if necessary.) \_\_\_\_\_

No allowable will be assigned to the well until all interests have been consolidated (by communitization, unitization, forced-pooling, or otherwise) or until a non-standard unit, eliminating such interests, has been approved by the Commission.

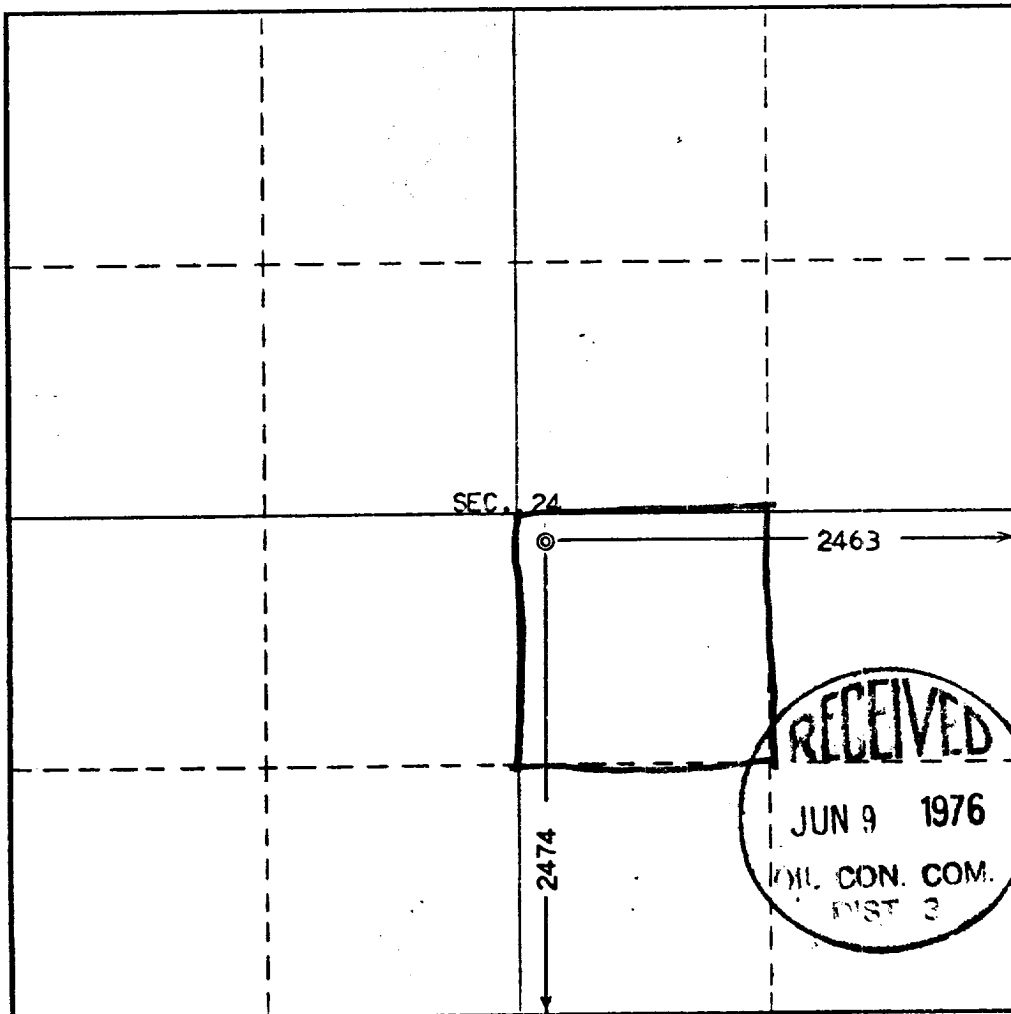

**CERTIFICATION**

I hereby certify that the information contained herein is true and complete to the best of my knowledge and belief.

Name W. A. Walther, Jr.  
Position W. A. Walther, Jr.  
Operations Manager  
Company ATLANTIC RICHFIELD COMPANY  
Date \_\_\_\_\_

By E. V. Echhawk  
I hereby certify that the well location shown on this plat was plotted from field notes of Aug. 20, 1976 made by me or under my supervision, and that the same is true and correct to the best of my knowledge and belief.  
E. V. ECHOHAWK

Date Surveyed May 21, 1976  
Registered Professional Engineer and/or Land Surveyor

E. V. Echhawk  
Certificate No. 3602  
**E. V. Echhawk LS**

0 330 660 990 1320 1650 1980 2310 2640 2000 1500 1000 500 0