

30-045-22109

RECEIVED
100-100-100
DATE 9-14-76

9-14-76

Type of Lease	FEE <input checked="" type="checkbox"/>
Gas Lease No.	
Lease Name	
Lease Name	
Pool, or Wildcat	
Mesa Verde	
20. Rotary or C.T.	
Rotary	
prox. Date Work will start	
days	

EST.	TOP

Drill hole to be made
S. 1/4 Sec. 10, T. 10N, R. 10E
to be made to a depth of 100 feet
S. 1/4 Sec. 10, T. 10N, R. 10E
to be made to a depth of 100 feet
to be made to a depth of 100 feet
to be made to a depth of 100 feet
to be made to a depth of 100 feet
to be made to a depth of 100 feet

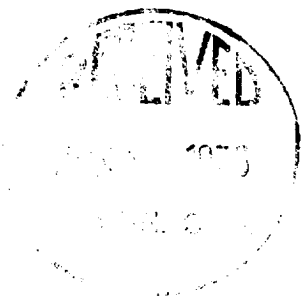

Gas is dedicated

AK Kendrick

INTERVIEW DIST. 10

Date June 9, 1976

JUN 16 1976

DATE

**NEW MEXICO OIL CONSERVATION COMMISSION
WELL LOCATION AND ACREAGE DEDICATION PLAT**

Form C-102
Supersedes C-128
Effective 1-1-65

All distances must be from the outer boundaries of the Section.

Operator Aztec Oil & Gas Company			Lease Grandall		Well No. 2-A
Unit Letter C	Section 19	Township 31N	Range 10W	County San Juan	
Actual Footage Location of Well: 1130 feet from the North line and 1780 feet from the West line					
Ground Level Elev. 5888	Producing Formation Mesa Verde		Pool Blanco	Dedicated Acreage: 315.40 316.69 Acres	

1. Outline the acreage dedicated to the subject well by colored pencil or hachure marks on the plat below.
2. If more than one lease is dedicated to the well, outline each and identify the ownership thereof (both as to working interest and royalty).
3. If more than one lease of different ownership is dedicated to the well, have the interests of all owners been consolidated by communitization, unitization, force-pooling, etc?

☒ Yes ☐ No If answer is "yes," type of consolidation Communitization Agreement

If answer is "no," list the owners and tract descriptions which have actually been consolidated. (Use reverse side of this form if necessary.) _____

No allowable will be assigned to the well until all interests have been consolidated (by communitization, unitization, forced-pooling, or otherwise) or until a non-standard unit, eliminating such interests, has been approved by the Commission.

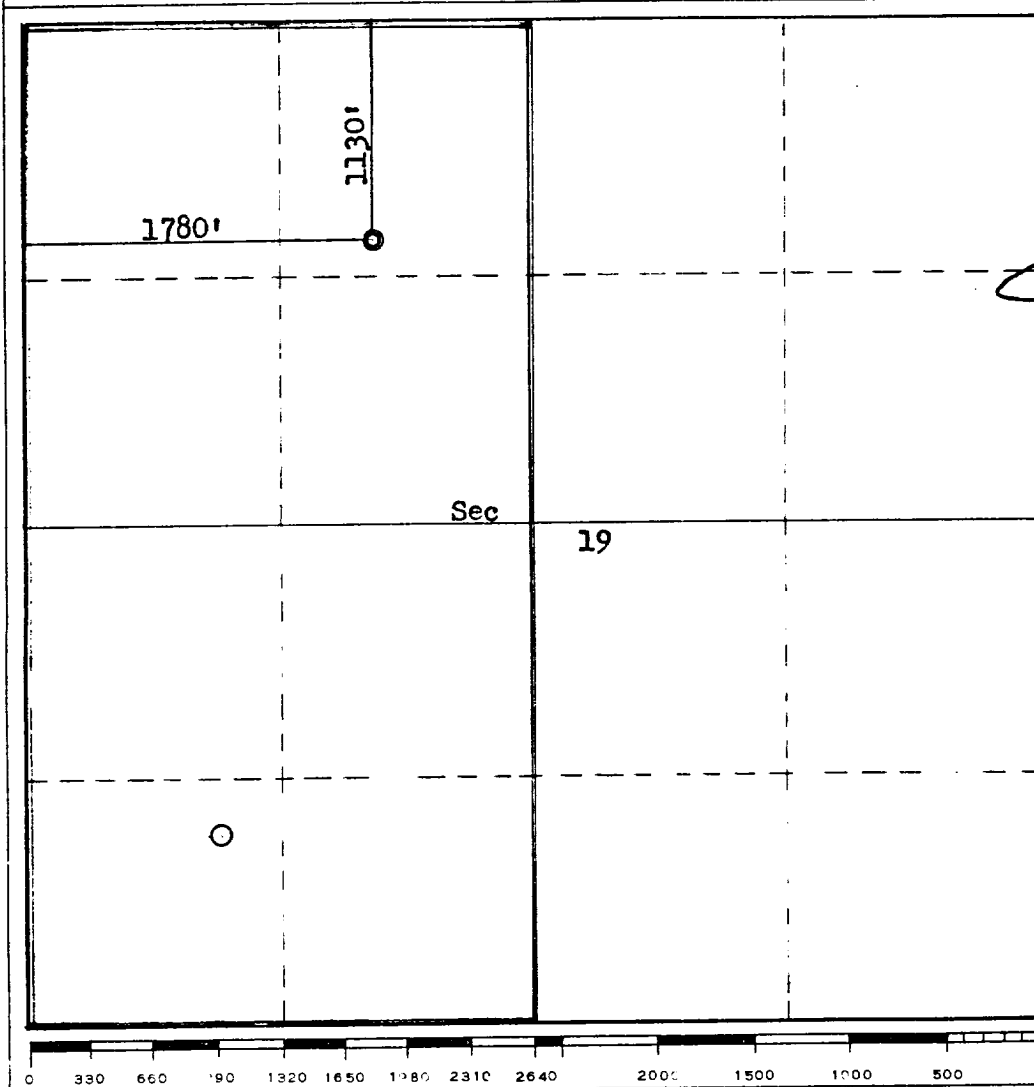

CERTIFICATION

I hereby certify that the information contained herein is true and complete to the best of my knowledge and belief.

Name *Stan Ryan*
 Position District Superintendent
 Company Aztec Oil & Gas Company
 Date June 9, 1976

I hereby certify that the well location shown on this plat was plotted from field notes of actual surveys made by me or under my supervision, and that the same is true and correct to the best of my knowledge and belief.

Date Surveyed May 28, 1976
 Registered Professional Engineer and/or Land Survey
Fred B. Kerr Jr.
 Fred B. Kerr Jr.

Certificate No. 3950