

UNITED STATES
DEPARTMENT OF THE INTERIOR
GEOLOGICAL SURVEY

APPLICATION FOR PERMIT TO DRILL, DEEPEN, OR PLUG BACK

1a. TYPE OF WORK
DRILL ☒ DEEPEN ☐ PLUG BACK ☐

b. TYPE OF WELL
OIL WELL ☐ GAS WELL ☒ OTHER ☐ SINGLE ZONE ☒ MULTIPLE ZONE ☐

2. NAME OF OPERATOR
Aztec Oil & Gas Company

3. ADDRESS OF OPERATOR
P. O. Drawer 570, Farmington, New Mexico

4. LOCATION OF WELL (Report location clearly and in accordance with any State requirements.*)
At surface 870' FSL & 980' FWL
Section 6-31N-11W
At proposed prod. zone

14. DISTANCE IN MILES AND DIRECTION FROM NEAREST TOWN OR POST OFFICE*

15. DISTANCE FROM PROPOSED* LOCATION TO NEAREST PROPERTY OR LEASE LINE, FT. (Also to nearest drlg. unit line, if any)

18. DISTANCE FROM PROPOSED LOCATION* TO NEAREST WELL, DRILLING, COMPLETED, OR APPLIED FOR, ON THIS LEASE, FT.

21. ELEVATIONS (Show whether DF, RT, GR, etc.)
6458' GR

23. PROPOSED CASING AND CEMENTING PROGRAM

SIZE OF HOLE	SIZE OF CASING	WEIGHT PER FOOT	SETTING DEPTH	QUANTITY OF CEMENT
13-3/4"	9-5/8"	32.30#	200'	224 cu. ft.
8-3/4"	7"	20#	4970'	629 cu. ft.
6-1/4"	4-1/2"	10.50#	4820 - 5630'	125 cu. ft.
	1-1/2"	2.90#	5630'	

PROPOSE TO:

Drill 13-3/4" hole.
Set 200' of 9-5/8" casing, cement with 224 cubic feet cement.
Drill 8-3/4" hole to approximately 4970'.
Run 7" casing, cement with 629 cubic feet cement.
Gas drill 6-1/4" hole to approximately 5630'.
Run 4-1/2" liner from 4820 to total depth.
Cement with 125 cubic feet cement.
Selectively perforate and frac Mesa Verde formation.
Run 1-1/2" tubing.
Install well head.

RECEIVED

JUL 13 1976

U. S. GEOLOGICAL SURVEY
FARMINGTON, N. M.

IN ABOVE SPACE DESCRIBE PROPOSED PROGRAM: If proposal is to deepen or plug back, give data on present productive zone and proposed new productive zone. If proposal is to drill or deepen directionally, give pertinent data on subsurface locations and measured and true vertical depths. Give blowout preventer program, if any.

24.  District Superintendent July 13, 1976

(This space for Federal or State office use)

PERMIT NO. _____ APPROVAL DATE _____

APPROVED BY _____ TITLE _____ DATE _____

CONDITIONS OF APPROVAL, IF ANY:

*See Instructions On Reverse Side

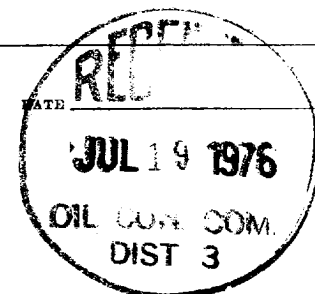

NEW MEXICO OIL CONSERVATION COMMISSION
WELL LOCATION AND ACREAGE DEDICATION PLAT

Form C-102
Supersedes C-128
Effective 1-1-65

All distances must be from the outer boundaries of the Section.

Operator Aztec Oil & Gas Company			Lease Dusenberry		Well No. 1-A
Unit Letter M	Section 6	Township 31N	Range 11W	County San Juan	
Actual Footage Location of Well:					
870 feet from the South line and		980 feet from the West line		Dedicated Acreage:	
Ground Level Elev. 6458 Gr	Producing Formation Mesa Verde	Pool Blanco		311.42	Acres

1. Outline the acreage dedicated to the subject well by colored pencil or hachure marks on the plat below.

2. If more than one lease is dedicated to the well, outline each and identify the ownership thereof (both as to working interest and royalty).

3. If more than one lease of different ownership is dedicated to the well, have the interests of all owners been consolidated by communitization, unitization, force-pooling, etc?

☐ Yes ☐ No If answer is "yes," type of consolidation _____

If answer is "no," list the owners and tract descriptions which have actually been consolidated. (Use reverse side of this form if necessary.) _____

No allowable will be assigned to the well until all interests have been consolidated (by communitization, unitization, forced-pooling, or otherwise) or until a non-standard unit, eliminating such interests, has been approved by the Commission.

CERTIFICATION

I hereby certify that the information contained herein is true and complete to the best of my knowledge and belief.

Name: *San Juan*
Position: District Superintendent
Company: Aztec Oil & Gas Company
Date: June 17, 1976

I hereby certify that the well location shown on this plat was plotted from field notes of actual surveys made by me or under my supervision, and that the same is true and correct to the best of my knowledge and belief.

Date Surveyed: May 27, 1976
Registered Professional Engineer, and Land Surveyor

Fred B. Kerr Jr.
Certificate No. 3950

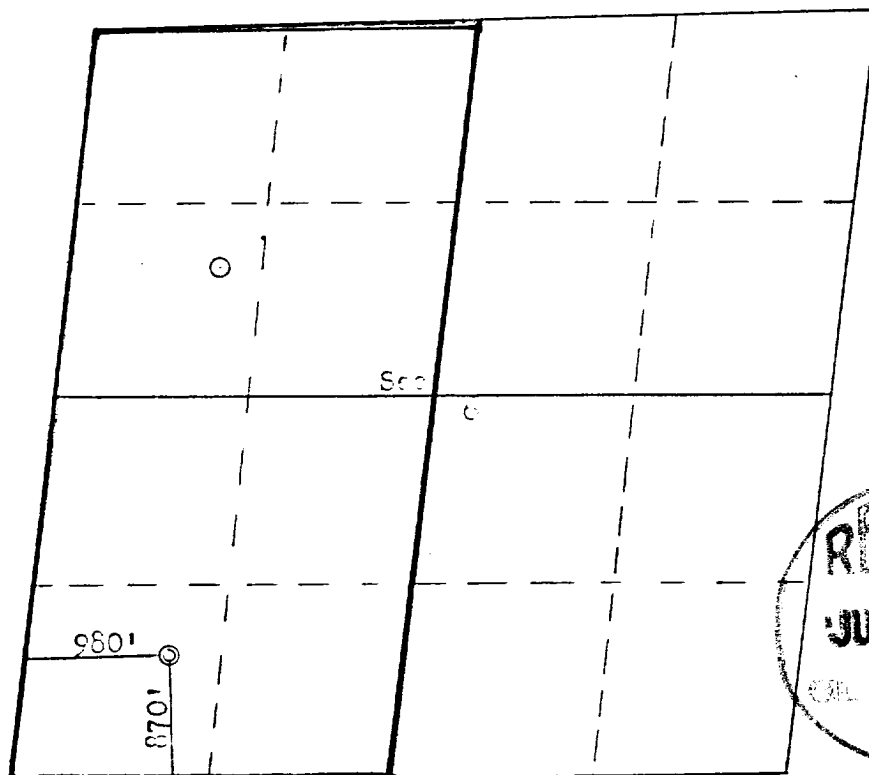

Scale: 1"=1320'

RECEIVED
JUL 19 1976

OIL CON. COM.
DIST 3