

UNITED STATES  
DEPARTMENT OF THE INTERIORGEOLOGICAL SURVEY *API 30-045 - 22125*

## APPLICATION FOR PERMIT TO DRILL, DEEPEN, OR PLUG BACK

## 1a. TYPE OF WORK

DRILL ☒DEEPEN ☐PLUG BACK ☐

## b. TYPE OF WELL

OIL  
WELL ☐GAS  
WELL ☒

OTHER

SINGLE  
ZONE ☐MULTIPLE  
ZONE ☐

## 2. NAME OF OPERATOR

Palmer Oil Company

## 3. ADDRESS OF OPERATOR

P. O. Box 2564, Billings, Montana 59103

## 4. LOCATION OF WELL (Report location clearly and in accordance with any State requirements.)

At surface

820' from East Line &amp; 1525' from South Line

At proposed prod. zone

Same

## 14. DISTANCE IN MILES AND DIRECTION FROM NEAREST TOWN OR POST OFFICE\*

Two (2) miles east of La Plata

U. S. GEOLOGICAL SURVEY

15. DISTANCE FROM PROPOSED\*  
LOCATION TO NEAREST  
PROPERTY OR LEASE LINE, FT.  
(Also to nearest drlg. unit line, if any)

790'

## 16. NO. OF ACRES IN LEASE

479.63

17. NO. OF ACRES ASSIGNED  
TO THIS WELL240 *5/320*18. DISTANCE FROM PROPOSED LOCATION\*  
TO NEAREST WELL, DRILLING, COMPLETED,  
OR APPLIED FOR, ON THIS LEASE, FT.

3355'

## 19. PROPOSED DEPTH

6900'

## 20. ROTARY OR CABLE TOOLS

Rotary

## 21. ELEVATIONS (Show whether DF, RT, GR, etc.)

5785' GR

## 22. APPROX. DATE WORK WILL START\*

July 1, 1976

## 23.

## PROPOSED CASING AND CEMENTING PROGRAM

SIZE OF HOLE	SIZE OF CASING	WEIGHT PER FOOT	SETTING DEPTH	QUANTITY OF CEMENT
12-14"	8-5/8"	24#	200'	185 sacks
7-7/8"	5-1/2"	15 1/2#	6900'	350 sacks

- Palmer Oil Company is in the process of communitizing 240 acres of Federal Lease USA NM-10183 with 80 acres of fee acreage as illustrated and outlined in red on the attached plat.
- Palmer will drill a 6900' Dakota test in the NE SE of Section 1-T31N-R13W.
- Well to be drilled by rotary tools. Set 200' of 8-5/8" casing and cement to surface; drill 7-7/8" to T.D.
- IES and Porosity logs will be run at T.D. All potential zones will be analyzed from surface to T.D., and if potentially commercial, 5-1/2" casing will be set, cemented and perforated.
- After perforating, the productive zones will be fractured, if necessary.

*Sheffer 10" - 3000 psi BOP w/ blind and pipe rams to be used.*

IN ABOVE SPACE DESCRIBE PROPOSED PROGRAM. If proposal is to deepen or plug back, give data on present productive zone and proposed new productive zone. If proposal is to drill or deepen directionally, give pertinent data on subsurface locations and measured and true vertical depths. Give blowout preventer program, if any.

## 24.

SIGNED

*Donald K. Roberts*

TITLE

President

DATE

May 30, 1976

(This space for Federal or State office use)

PERMIT NO.

APPROVAL DATE

JUN 21 1976

APPROVED BY

TITLE

OIL CON. COM.  
DIST 3

DATE

CONDITIONS OF APPROVAL, IF ANY:

*Okal*

NEW MEXICO OIL CONSERVATION COMMISSION  
WELL LOCATION AND ACREAGE DEDICATION PLAT

Form C-102  
Supersedes C-128  
Effective 1-1-65

All distances must be from the outer boundaries of the Section.

Operator <b>Palmer Oil Company</b>			Lease <b>Federal 1</b>		Well No. <b>#1</b>
Unit Letter <b>I</b>	Section <b>1</b>	Township <b>31N</b>	Range <b>13W</b>	County <b>San Juan</b>	
Actual Footage Location of Well: <b>1525</b> feet from the <b>South</b> line and <b>820</b> feet from the <b>East</b> line					
Ground Level Elev. <b>5785</b>	Producing Formation <b>Dakota</b>		Pool <b>Basin</b>		Dedicated Acreage: <b>320</b> Acres

1. Outline the acreage dedicated to the subject well by colored pencil or hatchure marks on the plat below.
2. If more than one lease is dedicated to the well, outline each and identify the ownership thereof (both as to working interest and royalty).
3. If more than one lease of different ownership is dedicated to the well, have the interests of all owners been consolidated by communitization, unitization, force-pooling, etc?

☐ Yes ☒ No If answer is "yes," type of consolidation \_\_\_\_\_

If answer is "no," list the owners and tract descriptions which have actually been consolidated. (Use reverse side of this form if necessary.) Plan to communitize

No allowable will be assigned to the well until all interests have been consolidated (by communitization, unitization, forced-pooling, or otherwise) or until a non-standard unit, eliminating such interests, has been approved by the Commission.

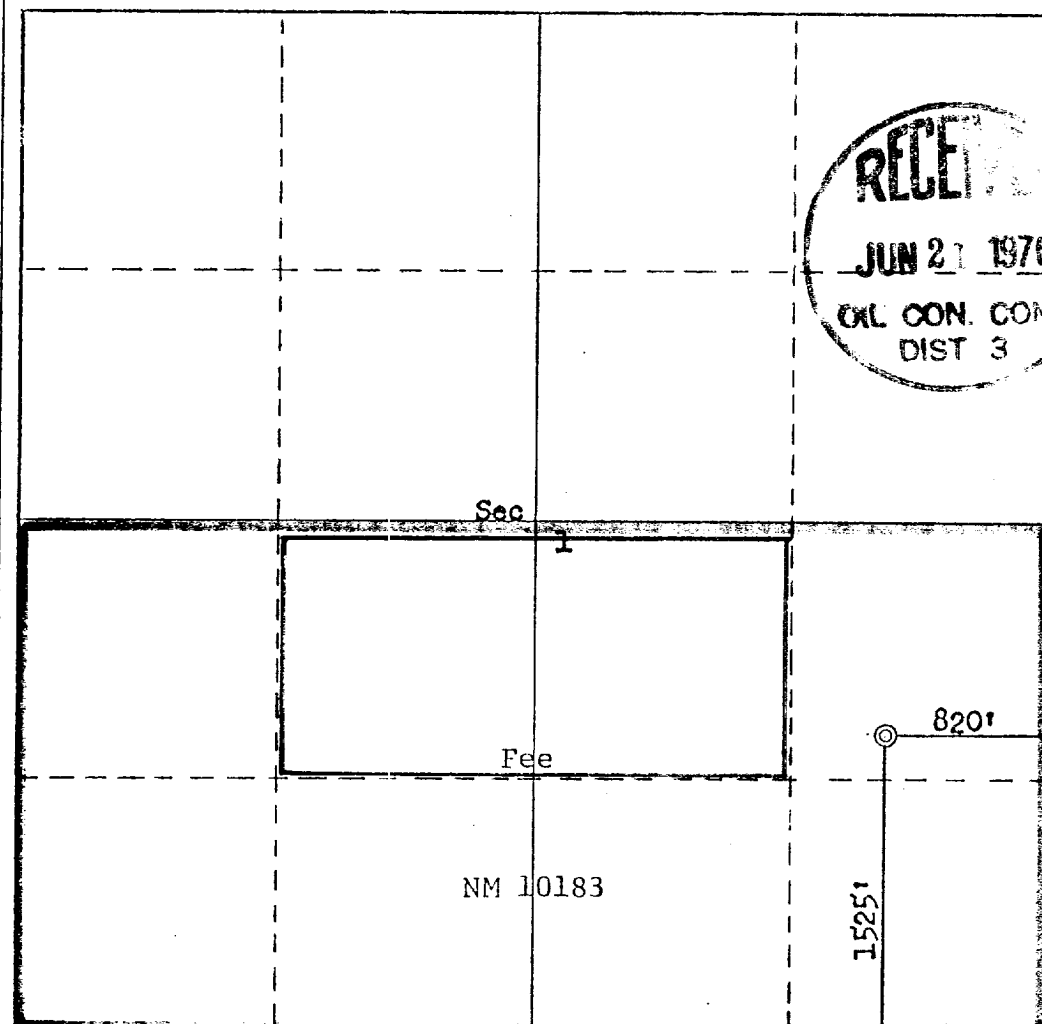

CERTIFICATION

I hereby certify that the information contained herein is true and complete to the best of my knowledge and belief.

*J. A. Dugan*  
Name

Thomas A. Dugan

Position

Consulting Engineer

Company

Palmer Oil Company

Date

6-16-76

I hereby certify that the well location shown on this plat was plotted from field notes of actual surveys made by me or under my supervision, and that the same is true and correct to the best of my knowledge and belief.

Date Surveyed

May 26, 1976

Registered Professional Engineer and/or Land Surveyor

*Fred B. Kerr Jr.*  
Fred B. Kerr Jr.

Certificate No.

3950

0 330 660 990 1320 1650 1980 2310 2640 2970 3300 0