

NO. OF COPIES RECEIVED	3
DISTRIBUTION	
SANTA FE	1
FILE	1
U.S.G.S.	
LAND OFFICE	
OPERATOR	1

NEW MEXICO OIL CONSERVATION COMMISSION

Form C-103  
Supersedes Old  
C-102 and C-103  
Effective 1-1-65

5a. Indicate Type of Lease	
State <input type="checkbox"/>	Fee <input checked="" type="checkbox"/>
5. State Oil & Gas Lease No.	

SUNDRY NOTICES AND REPORTS ON WELLS

(DO NOT USE THIS FORM FOR PROPOSALS TO DRILL OR TO DEEPEN OR PLUG BACK TO A DIFFERENT RESERVOIR. USE "APPLICATION FOR PERMIT -" (FORM C-101) FOR SUCH PROPOSALS.)

1. OIL WELL <input type="checkbox"/> GAS WELL <input checked="" type="checkbox"/> OTHER- 2. Name of Operator <b>AMOCO PRODUCTION COMPANY</b>	7. Unit Agreement Name
3. Address of Operator <b>501 Airport Drive, Farmington, New Mexico 87401</b>	8. Farm or Lease Name <b>Uptegrove Gas Com</b>
4. Location of Well UNIT LETTER <b>0</b> , <b>790</b> FEET FROM THE <b>South</b> LINE AND <b>1810</b> FEET FROM THE <b>East</b> LINE, SECTION <b>33</b> TOWNSHIP <b>32N</b> RANGE <b>10W</b> NMPM.	9. Well No. <b>1A</b>
15. Elevation (Show whether DF, RT, GR, etc.) <b>5859' est. GL</b>	10. Field and Pool, or Wildcat <b>Blanco Mesaverde</b>
12. County <b>San Juan</b>	

Check Appropriate Box To Indicate Nature of Notice, Report or Other Data

NOTICE OF INTENTION TO:

PERFORM REMEDIAL WORK <input type="checkbox"/>	PLUG AND ABANDON <input type="checkbox"/>
TEMPORARILY ABANDON <input type="checkbox"/>	CHANGE PLANS <input type="checkbox"/>
PULL OR ALTER CASING <input type="checkbox"/>	OTHER <input checked="" type="checkbox"/> <b>Change of Location</b>

SUBSEQUENT REPORT OF:

REMEDIAL WORK <input type="checkbox"/>	ALTERING CASING <input type="checkbox"/>
COMMENCE DRILLING OPNS. <input type="checkbox"/>	PLUG AND ABANDONMENT <input type="checkbox"/>
CASING TEST AND CEMENT JOBS <input type="checkbox"/>	
OTHER <input type="checkbox"/>	

17. Describe Proposed or Completed Operations (Clearly state all pertinent details, and give pertinent dates, including estimated date of starting any proposed work) SEE RULE 1103.

**Amoco Production Company proposes to change the location for the subject well from 1470' FSL and 1190' FKL, Section 33, T-32-N, R-10-W, back to the original location of 790' FSL and 1810' FKL, Section 33, T-32-N, R-10-W.**



18. I hereby certify that the information above is true and complete to the best of my knowledge and belief.

SIGNED *Ph. Montoya* TITLE **Area Engineer** DATE **December 3, 1976**

APPROVED BY *AR Dendroide* SUPERVISOR DIST. #3 DATE **DEC 6 1976**

CONDITIONS OF APPROVAL, IF ANY:

NEW MEXICO OIL CONSERVATION COMMISSION  
WELL LOCATION AND ACREAGE DEDICATION PLAT

Form O-110  
Supersedes O-128  
Effective 1-1-65

All distances must be from the outer boundaries of the Section.

Lessee <b>Amoco Production Company</b>			Lease <b>Uptegrove Gas Com</b>		Well No. <b>1A</b>
Unit Letter <b>0</b>	Section <b>33</b>	Township <b>32N</b>	Range <b>10W</b>	County <b>San Juan</b>	
Actual Footage Location of Well:					
<b>790</b>	feet from the	<b>South</b>	line and	<b>1810</b>	feet from the <b>East</b> line
Ground Level Elev. <b>5859' est.</b>	Producing Formation <b>Mesa Verde</b>		Pool <b>Blanco Mesaverde</b>		Dedicated Acreage: <b>320</b> Acres

1. Outline the acreage dedicated to the subject well by colored pencil or hachure marks on the plat below.
2. If more than one lease is dedicated to the well, outline each and identify the ownership thereof (both as to working interest and royalty).
3. If more than one lease of different ownership is dedicated to the well, have the interests of all owners been consolidated by communitization, unitization, force-pooling, etc?

☐ Yes ☐ No If answer is "yes," type of consolidation \_\_\_\_\_

If answer is "no," list the owners and tract descriptions which have actually been consolidated. (Use reverse side of this form if necessary.) \_\_\_\_\_

No allowable will be assigned to the well until all interests have been consolidated (by communitization, unitization, forced-pooling, or otherwise) or until a non-standard unit, eliminating such interests, has been approved by the Commission.

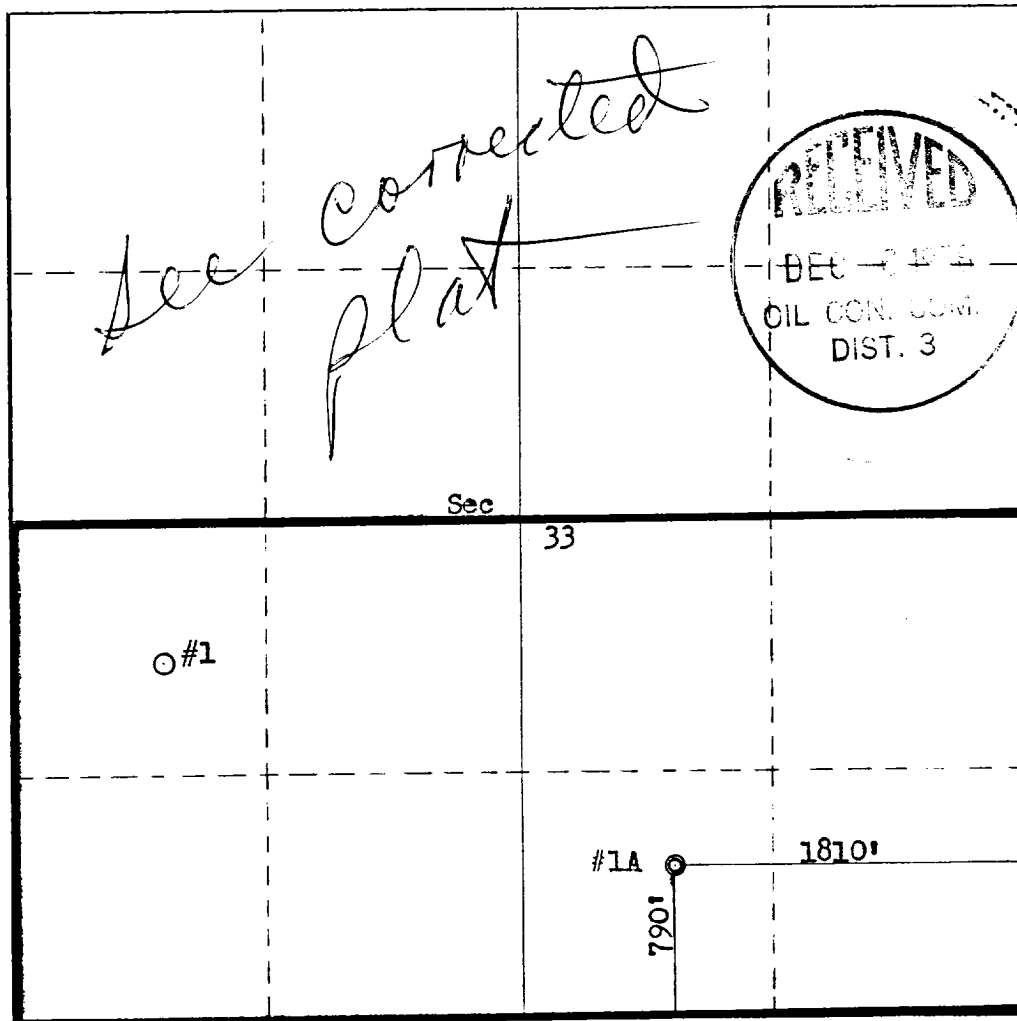

CERTIFICATION

I hereby certify that the information contained herein is true and complete to the best of my knowledge and belief.

Name  
**H. D. Montgomery**  
Position  
**Area Engineer**  
Company  
**AMOCO PRODUCTION COMPANY**  
Date  
**July 28, 1976**

I hereby certify that the well location shown on this plat was plotted from field notes of actual surveys made by me or under my supervision, and that the same is true and correct to the best of my knowledge and belief.

Date Surveyed  
**July 12, 1976**  
Registered Professional Engineer  
and/or Land Surveyor

**Fred B. Kerr Jr.**  
Certificate No.

**3950**

