

NO. OF COPIES RECEIVED	5
DISTRIBUTION	
SANTA FE	1
FILE	1
U.S.G.S.	2
LAND OFFICE	
OPERATOR	1

NEW MEXICO OIL CONSERVATION COMMISSION

APPROVAL VALID
FOR 90 DAYS UNLESS
DRILLING COMMENCED,

EXPIRES 11/29/76

30-045-22178

Form C-101
Revised 1-1-65

5A. Indicate Type of Lease	
STATE <input type="checkbox"/>	FEE <input checked="" type="checkbox"/>
5. State Oil & Gas Lease No.	

APPLICATION FOR PERMIT TO DRILL, DEEPEN, OR PLUG BACK

1a. Type of Work		7. Unit Agreement Name	
b. Type of Well OIL WELL <input type="checkbox"/> GAS WELL <input checked="" type="checkbox"/> OTHER <input type="checkbox"/>		8. Farm or Lease Name Schneider Gas Con "B"	
2. Name of Operator AMOCO PRODUCTION COMPANY		9. Well No. 1	
3. Address of Operator 501 Airport Drive, Farmington, NM 87401		10. Field and Pool, or Wildcat Blanco Pictured Cliffs	
4. Location of Well UNIT LETTER M LOCATED 1110 FEET FROM THE South LINE AND 1185 FEET FROM THE West LINE OF SEC. 28 TWP. 32N RGE. 10W NMPM		12. County San Juan	
19. Proposed Depth 3050'		19A. Formation Pictured Cliffs	
20. Rotary or C.T. Rotary		21. Elevations (Show whether DF, RT, etc.) 6059' GL (Est.)	
21A. Kind & Status Plug. Bond Statewide		21B. Drilling Contractor Unknown	
22. Approx. Date Work will start September 1976			

23.

PROPOSED CASING AND CEMENT PROGRAM

SIZE OF HOLE	SIZE OF CASING	WEIGHT PER FOOT	SETTING DEPTH	SACKS OF CEMENT	EST. TOP
12-1/4"	8-5/8"	24#	250'	200	Circulate
7-7/8"	4-1/2"	10.5#	3050'	750	Circulate

Amoco proposes to drill the above well to develop the Pictured Cliffs reservoir. The well will be drilled using rotary tools with mud as a circulating media to TD. Production casing will be set through the Pictured Cliffs formation upon completion. Perforations and stimulation will be based on analysis of open hole logs. Copy of all logs will be filed upon completion. Amoco's standard blowout prevention will be employed (see attached drawing for blowout preventer design). Upon completion, the well will be cleaned and the reserve pit filled and leveled. This gas is not dedicated to a purchaser.

IN ABOVE SPACE DESCRIBE PROPOSED PROGRAM: IF PROPOSAL IS TO DEEPEN OR PLUG BACK, GIVE DATA ON PRESENT PRODUCTIVE ZONE AND PROPOSED NEW PRODUCTIVE ZONE. GIVE BLOWOUT PREVENTER PROGRAM, IF ANY.

I hereby certify that the information above is true and complete to the best of my knowledge and belief.

Signed W. Montgomery Title Area Engineer Date August 31, 1976

(This space for State Use)

APPROVED BY AR Kendrick TITLE DATE

CONDITIONS OF APPROVAL, IF ANY:

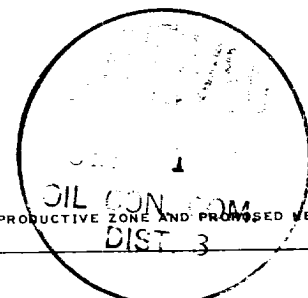

NEW MEXICO OIL CONSERVATION COMMISSION
WELL LOCATION AND ACREAGE DEDICATION PLAT

Form C-102
Supersedes C-128
Effective 1-1-65

All distances must be from the outer boundaries of the Section.

Operator Amoco Production Company			Lease Schneider Gas Com "B"		Well No. 1
Unit Letter M	Section 28	Township 32N	Range 10W	County San Juan	
Actual Footage Location of Well: 1110 feet from the South line and 1185 feet from the West line					
Ground Level Elev. 6059	Producing Formation Pictured Cliffs		Pool Blanco Pictured Cliffs		Dedicated Acreage: 160 Acres

1. Outline the acreage dedicated to the subject well by colored pencil or hachure marks on the plat below.
2. If more than one lease is dedicated to the well, outline each and identify the ownership thereof (both as to working interest and royalty).
3. If more than one lease of different ownership is dedicated to the well, have the interests of all owners been consolidated by communitization, unitization, force-pooling, etc?

☐ Yes ☐ No If answer is "yes," type of consolidation _____

If answer is "no," list the owners and tract descriptions which have actually been consolidated. (Use reverse side of this form if necessary.) _____

No allowable will be assigned to the well until all interests have been consolidated (by communitization, unitization, forced-pooling, or otherwise) or until a non-standard unit, eliminating such interests, has been approved by the Commission.

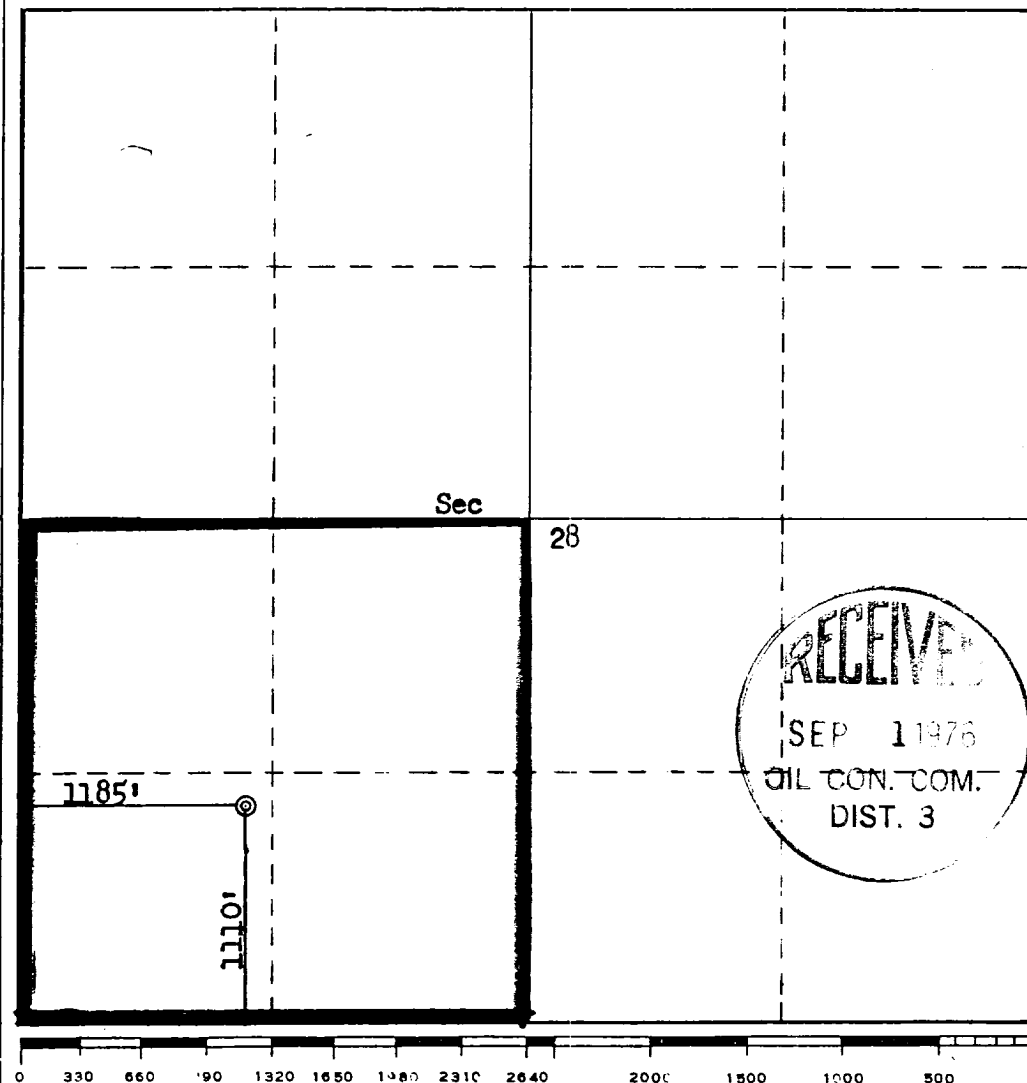

CERTIFICATION

I hereby certify that the information contained herein is true and complete to the best of my knowledge and belief.

Name
H. D. Montgomery
Position
Area Engineer
Company
AMOCO PRODUCTION COMPANY
Date
August 31, 1976

I hereby certify that the well location shown on this plat was plotted from field notes of actual surveys made by me or under my supervision, and that the same is true and correct to the best of my knowledge and belief.

Date Surveyed
August 25, 1976
Registered Professional Engineer and/or Land Surveyor
Fred B. Kerr
Certificate No.
3950