

NO. OF COPIES RECEIVED	5
DISTRIBUTION	
SANTA FE	1
FILE	1
U.S.G.S.	2
LAND OFFICE	
OPERATOR	1

NEW MEXICO OIL CONSERVATION COMMISSION

30-045-22282

Form C-101
Revised 1-1-65

5A. Indicate Type of Lease	
STATE <input type="checkbox"/>	FEE <input checked="" type="checkbox"/>
5. State Oil & Gas Lease No.	

APPLICATION FOR PERMIT TO DRILL, DEEPEN, OR PLUG BACK

1a. Type of Work		7. Unit Agreement Name	
b. Type of Well DRILL <input checked="" type="checkbox"/> DEEPEN <input type="checkbox"/> PLUG BACK <input type="checkbox"/> OIL WELL <input type="checkbox"/> GAS WELL <input checked="" type="checkbox"/> OTHER <input type="checkbox"/> SINGLE ZONE <input checked="" type="checkbox"/> MULTIPLE ZONE <input type="checkbox"/>		8. Farm or Lease Name Kelly Gas Com "A"	
2. Name of Operator AMOCO PRODUCTION COMPANY		9. Well No. 7	
3. Address of Operator 501 Airport Drive, Farmington, New Mexico 87401		10. Field and Pool, or Wildcat Blanco Pictured Cliffs	
4. Location of Well UNIT LETTER H LOCATED 1830 FEET FROM THE North LINE AND 1165 FEET FROM THE East LINE OF SEC. 15 TWP. 31N RGE. 10W NMPM		12. County San Juan	
19. Proposed Depth 3050'		19A. Formation Pictured Cliffs	
20. Rotary or C.T. Rotary		21. Elevations (Show whether DE, RT, etc.) 6234' GL	
21A. Kind & Status Plug. Bond Statewide		21B. Drilling Contractor Signal Rig No. 8	
22. Approx. Date Work will start December, 1976			

23.

PROPOSED CASING AND CEMENT PROGRAM

SIZE OF HOLE	SIZE OF CASING	WEIGHT PER FOOT	SETTING DEPTH	SACKS OF CEMENT	EST. TOP
12-1/4"	8-5/8"	24#	250'	200	Circulate
7-7/8"	4-1/2"	10.5#	3050'	750	Circulate

Amoco proposes to drill the above well to develop the Pictured Cliffs reservoir. The well will be drilled using rotary tools with mud as the circulating media to TD. Production casing will be set through the Pictured Cliffs formation upon completion. Perforations and stimulation will be based on analysis of open hole logs. Copy of all logs will be filed upon completion. Amoco's standard blowout prevention will be employed (see attached drawing for blowout prevention design).

Upon completion, the well location will be cleaned and the reserve pit filled and leveled. This gas is not dedicated to a purchaser.

APPROVAL VALID
FOR 90 DAYS UNLESS
DRILLING COMMENCED,

EXPIRES 3-2-77

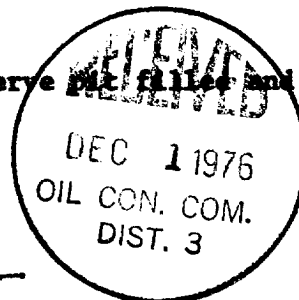

IN ABOVE SPACE DESCRIBE PROPOSED PROGRAM: IF PROPOSAL IS TO DEEPEN OR PLUG BACK, GIVE DATA ON PRESENT PRODUCTIVE ZONE AND PROPOSED NEW PRODUCTIVE ZONE. GIVE BLOWOUT PREVENTION PROGRAM, IF ANY.

I hereby certify that the information above is true and complete to the best of my knowledge and belief.

Signed [Signature] Title Area Superintendent Date November 29, 1976

(This space for State Use)

APPROVED BY [Signature] TITLE SUPERVISOR DATE DEC 1 1976

CONDITIONS OF APPROVAL, IF ANY:

NEW MEXICO OIL CONSERVATION COMMISSION
WELL LOCATION AND ACREAGE DEDICATION PLAT

Form C-102
Supersedes C-128
Effective 1-1-65

All distances must be from the outer boundaries of the Section.

Operator Amoco Production Company		Lease Kelly Gas Com "A"		Well No. 7
Unit Letter H	Section 15	Township 31N	Range 10W	County San Juan
Actual Footage Location of Well: 1830 feet from the North line and 1165 feet from the East line				
Ground Level Elev. 6234	Producing Formation Pictured Cliffs	Pool Blanco Pictured Cliffs	Dedicated acreage: 159.34 Acres	

1. Outline the acreage dedicated to the subject well by colored pencil or hachure marks on the plat below.
2. If more than one lease is dedicated to the well, outline each and identify the ownership thereof (both as to working interest and royalty).
3. If more than one lease of different ownership is dedicated to the well, have the interests of all owners been consolidated by communitization, unitization, force-pooling, etc?

☐ Yes ☐ No If answer is "yes," type of consolidation _____

If answer is "no," list the owners and tract descriptions which have actually been consolidated. (Use reverse side of this form if necessary.) _____

No allowable will be assigned to the well until all interests have been consolidated (by communitization, unitization, forced-pooling, or otherwise) or until a non-standard unit, eliminating such interests, has been approved by the Commission.

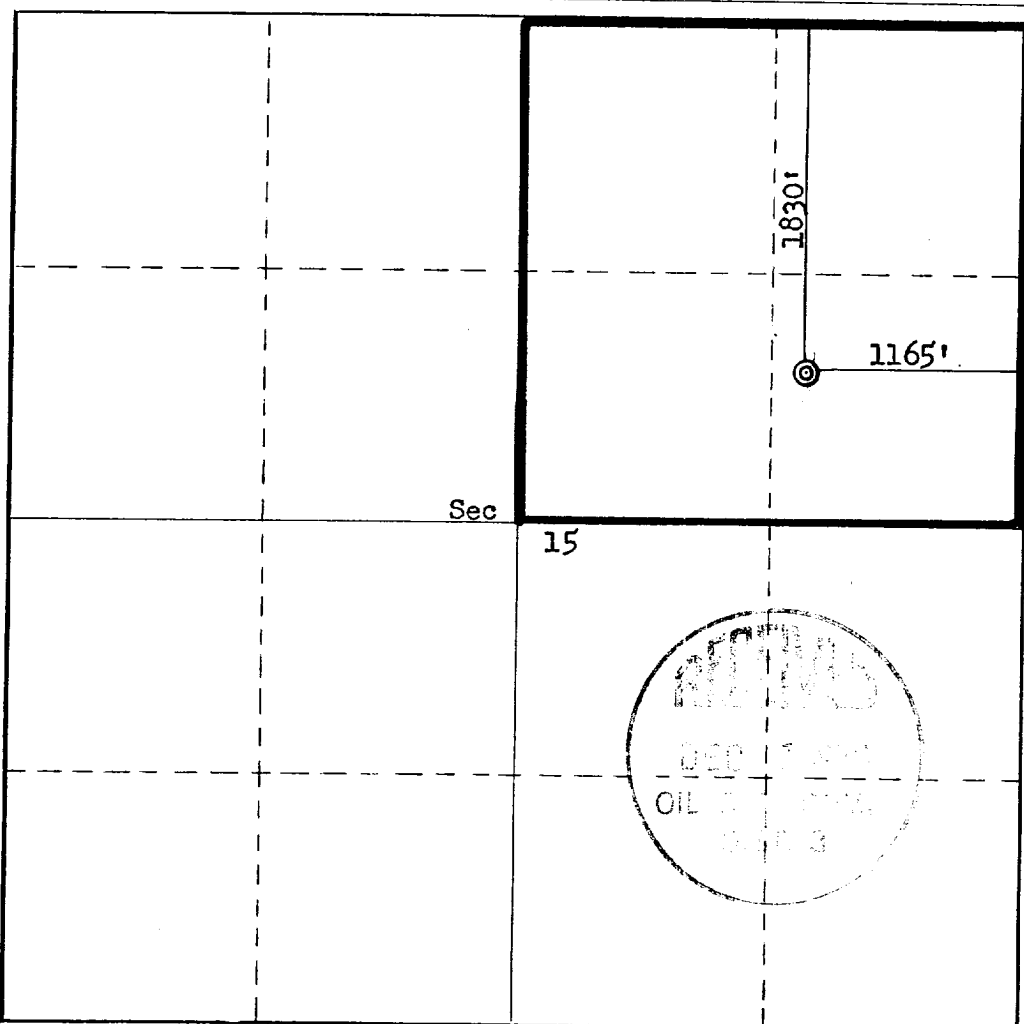

CERTIFICATION

I hereby certify that the information contained herein is true and complete to the best of my knowledge and belief.

Name
L. O. Speer, Jr.
Position
Area Superintendent
Company
AMOCO PRODUCTION COMPANY
Date
November 29, 1976

I hereby certify that the well location shown on this plat was plotted from field notes of actual surveys made by me or under my supervision, and that the same is true and correct to the best of my knowledge and belief.

Date Surveyed
November 2, 1976
Registered Professional Engineer and/or Land Surveyor
Fred B. Kerr, Jr.
Certificate No.
3950

