

NO. OF COPIES RECEIVED	5
DISTRIBUTION	
SANTA FE	1
FILE	1
U.S.G.S.	2
LAND OFFICE	
OPERATOR	1

# NEW MEXICO OIL CONSERVATION COMMISSION

30-075-22341  
Form C-101  
Revised 1-1-65

## APPLICATION FOR PERMIT TO DRILL, DEEPEN, OR PLUG BACK

1a. Type of Work DRILL <input checked="" type="checkbox"/> DEEPEN <input type="checkbox"/> PLUG BACK <input type="checkbox"/>		5a. Indicate Type of Lease STATE <input type="checkbox"/> FEE <input checked="" type="checkbox"/>	
b. Type of Well OIL WELL <input type="checkbox"/> GAS WELL <input checked="" type="checkbox"/> OTHER <input type="checkbox"/>		5. State Oil & Gas Lease No.	
2. Name of Operator Palmer Oil & Gas Company		7. Unit Agreement Name	
3. Address of Operator P. O. Box 2564, Billings, Montana 59103		8. Farm or Lease Name Federal 1 Nichols Gas Com	
4. Location of Well UNIT LETTER _____ LOCATED 1820 FEET FROM THE West LINE AND 1525 FEET FROM THE South LINE OF SEC. 1 TWP. 31N RGE. 13W NMFM		9. Well No. No. 1 A	
		10. Field and Pool, or Wildcat Blanco Mesaverde	
		12. County San Juan	
		19. Proposed Depth 4800'	
		19A. Formation Mesaverde	
		20. Rotary or C.T. rotary	
21. Elevations (Show whether DF, RT, etc.) 5759 grd		21A. Kind & Status Plug. Bond \$10,000 Blanket	
		21B. Drilling Contractor (negotiating)	
		22. Approx. Date Work will start March 1, 1977	

23.

### PROPOSED CASING AND CEMENT PROGRAM

SIZE OF HOLE	SIZE OF CASING	WEIGHT PER FOOT	SETTING DEPTH	SACKS OF CEMENT	EST. TOP
12-1/4"	9-5/8"	24#	200'	185 sx	
8-1/4"	7"	23#	3875'	350 sx	
6-1/2"	4-1/2"	9.5#	4800'	350 sx	

- Palmer Oil & Gas Company has communitized 240 acres of Federal Lease USA NM-10183 with 80 acres of fee acreage as illustrated and outlined in red on the attached plat.
- We plan to drill a 4800' Mesaverde test in the NE1/4SW1/4 of Section 1-T31N-R13W.
- Well will be drilled with rotary tools. 200' of 9-5/8" surface casing will be set and cemented to surface. An 8-1/4" hole will be mud drilled to approximately 3875' and a string of 7" 23# intermediate casing will be set and cemented to surface. The hole will be reduced to 6-1/4" and gas drilled to approximate T.D. of 4800' to test the Mesaverde. Intermediate logs will be run at 3875'. At T.D., logs will be run and, if productive, 4-1/2" x 9.5# liner will be set from 3800' to T.D. and cemented with approximately 350 sacks cement.
- The well will be perforated 2 JSPF and 1 JSPF in 2 stages utilizing 2% KCL water and 10/20 sand.

APPROVED FOR 90 DAYS UNLESS  
DRILLING COMMENCED,

EXPIRES 5-15-77

IN ABOVE SPACE DESCRIBE PROPOSED PROGRAM: IF PROPOSAL IS TO DEEPEN OR PLUG BACK, GIVE DATA ON PRESENT PRODUCTIVE ZONE AND PROPOSED NEW PRODUCTIVE ZONE. GIVE BLOWOUT PREVENTER PROGRAM, IF ANY.

I hereby certify that the information above is true and complete to the best of my knowledge and belief.

Signed L. C. Campbell Title Land Manager Date January 28, 1977  
(This space for State Use)

Original Signed by A. R. Kendrick

APPROVED BY \_\_\_\_\_ TITLE \_\_\_\_\_ DATE \_\_\_\_\_

CONDITIONS OF APPROVAL, IF ANY:

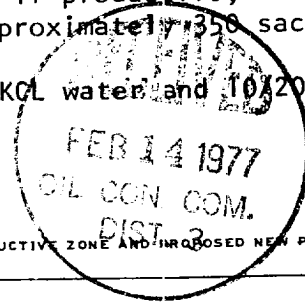

**NEW MEXICO OIL CONSERVATION COMMISSION  
WELL LOCATION AND ACERAGE DEDICATION PLAT**

All distances must be from the outer boundaries of the Section

Operator <b>PALMER OIL COMPANY</b>			Lease <i>Federal</i> <b>NICHOLS GAS COM.</b>		Well No. <b>1-A</b>
Unit Letter <b>K</b>	Section <b>1</b>	Township <b>31 NORTH</b>	Range <b>13 WEST</b>	County <b>SAN JUAN</b>	
Actual Footage Location of Well: <div style="display: flex; justify-content: space-between;"> <span><b>1525</b> feet from the <b>South</b> line and</span> <span><b>1820</b> feet from the <b>West</b> line</span> </div>					
Ground Level Elev. <b>5759</b>	Producing Formation <b>Mesaverde</b>	Pool <b>Blanco Mesaverde</b>		Dedicated Acreage: <b>320</b>	Acres

1. Outline the acreage dedicated to the subject well by colored pencil or hachure marks on the plat below.
  2. If more than one lease is dedicated to the well, outline each and identify the ownership thereof (both as to working interest and royalty),
  3. If more than one lease of different ownership is dedicated to the well, have the interests of all owners been consolidated by communitization, unitization, force-pooling, etc?
- (X) Yes    ( ) No    If answer is "yes," type of consolidation Communitization

If answer is "no," list the owners and tract descriptions which have actually consolidated. (Use reverse side of this form if necessary.)

No allowable will be assigned to the well until all interests have been consolidated (by communitization, unitization, forced-pooling, or otherwise) or until a non standard unit, eliminating such interests, has been approved by the Commission.

**CERTIFICATION**

I hereby certify that the information contained herein is true and complete to the best of my knowledge and belief.

Name L. C. Campbell  
 Position Land Manager  
Palmer Oil & Gas Company  
 Company  
January 28, 1977  
 Date

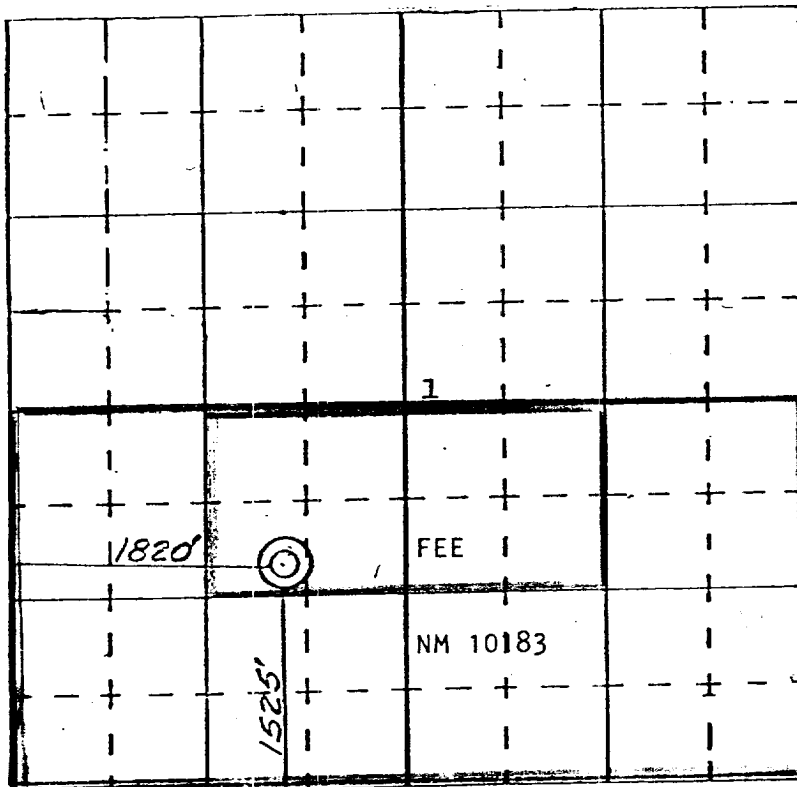

I hereby certify that the well location shown on this plat was plotted from field notes or other surveys made by me or under my supervision, that the same is true and correct to the best of my knowledge and belief.

21 December 1976  
 Date Surveyed  
James P. Lees  
 Registered Professional Engineer  
 and/or Land Surveyor **James P. Lees**

**1463**

Certificate No.