

UNITED STATES  
DEPARTMENT OF THE INTERIOR  
GEOLOGICAL SURVEYSUBMIT IN TRIPPLICATE  
(Other instructions on re-  
verse side)Form approved  
Budget Bureau No. 42 R1424  
5. LEASE DESIGNATION AND SERIAL NO.

NM 013688

6. IF INDIAN, ALLOTTEE OR TRIBE NAME

## SUNDRY NOTICES AND REPORTS ON WELLS

(Do not use this form for proposals to drill or to deepen or plug back to a different reservoir.  
Use "APPLICATION FOR PERMIT--" for such proposals.)

1. <input type="checkbox"/> OIL WELL, <input type="checkbox"/> GAS WELL, <input checked="" type="checkbox"/> OTHER		7. UNIT AGREEMENT NAME
2. NAME OF OPERATOR El Paso Natural Gas Company		8. FARM OR LEASE NAME Atlantic
3. ADDRESS OF OPERATOR Box 990, Farmington, New Mexico 87401		9. WELL NO. 6A
4. LOCATION OF WELL (Report location clearly and in accordance with any State requirements.* See also space 17 below.) At surface  900'N, 1800'W		10. FIELD AND POOL, OR WILDCAT Blanco P. C. & Blanco M. V.
14. PERMIT NO.		11. SEC., T., R., M., OR BLK. AND SURVEY OR AREA Sec. 22, T-31-N, R-10-W
15. ELEVATIONS (Show whether DF, RT, GR, etc.) 6256' GL		12. COUNTY OR PARISH N. M. P. M. San Juan
		13. STATE New Mexico

## 16. Check Appropriate Box To Indicate Nature of Notice, Report, or Other Data

## NOTICE OF INTENTION TO:

TEST WATER SHUT-OFF

PULL OR ALTER CASING

FRACTURE TREAT

MULTIPLE COMPLETE

SHOOT OR ACIDIZE

ABANDON\*

REPAIR WELL

CHANGE PLANS

(Other)

## SUBSEQUENT REPORT OF:

WATER SHUT-OFF

REPAIRING WELL

FRACTURE TREATMENT

ALTERING CASING

SHOOTING OR ACIDIZING

ABANDONMENT\*

(Other)

(NOTE: Report results of multiple completion on Well Completion or Recompletion Report and Log form.)

17. DESCRIBE PROPOSED OR COMPLETED OPERATIONS (Clearly state all pertinent details, and give pertinent dates, including estimated date of starting any proposed work. If well is directionally drilled, give subsurface locations and measured and true vertical depths for all markers and zones pertinent to this work.)\*

This well was originally planned as a single Mesa Verde completion. It is now planned to dually complete this well in the Pictured Cliffs & Mesa Verde formations. The casing and cementing will remain the same.

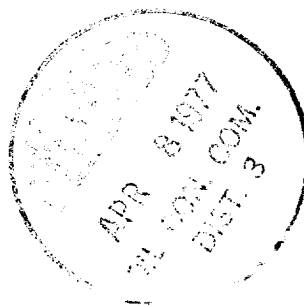

APR 7 1977

18. I hereby certify that the foregoing is true and correct

SIGNED

*A. B. Duaco*

TITLE

Drilling Clerk

DATE

April 5, 1977

(This space for Federal or State office use)

APPROVED BY

TITLE

DATE

CONDITIONS OF APPROVAL, IF ANY:

## WELL LOCATION AND ACREAGE DEDICATION PLAT

Supervisory G-12B  
Effective 1-1-65

All distances must be from the outer boundaries of the Section.

Operator <b>EL PASO NATURAL GAS COMPANY</b>		Lease <b>ATLANTIC</b>		(NM-013688)		Well No. <b>6A</b>	
Unit Letter <b>C</b>	Section <b>22</b>	Township <b>31-N</b>	Range <b>10-W</b>	County <b>SAN JUAN</b>			
Actual Footage Location of Well: <b>900</b> feet from the <b>NORTH</b> line and <b>1800</b> feet from the <b>WEST</b> line							
Ground Level Elev. <b>6256</b>	Producing Formation <b>PICTURED CLIFFS &amp; MESA VERDE</b>		Pool <b>BLANCO PICTURED CLIFFS BLANCO MESA VERDE</b>		Dedicated Acreage: <b>159.80 &amp; 320.40</b> Acres		

1. Outline the acreage dedicated to the subject well by colored pencil or hatchure marks on the plat below.
2. If more than one lease is dedicated to the well, outline each and identify the ownership thereof (both as to working interest and royalty).
3. If more than one lease of different ownership is dedicated to the well, have the interests of all owners been consolidated by communitization, unitization, force-pooling, etc?

☐ Yes ☐ No If answer is "yes," type of consolidation \_\_\_\_\_

If answer is "no," list the owners and tract descriptions which have actually been consolidated. (Use reverse side of this form if necessary.) \_\_\_\_\_

No allowable will be assigned to the well until all interests have been consolidated (by communitization, unitization, forced-pooling, or otherwise) or until a non-standard unit, eliminating such interests, has been approved by the Commission. NOTE: THIS PLAT IS REISSUED TO SHOW DUAL COMPLETION. 5-6-77

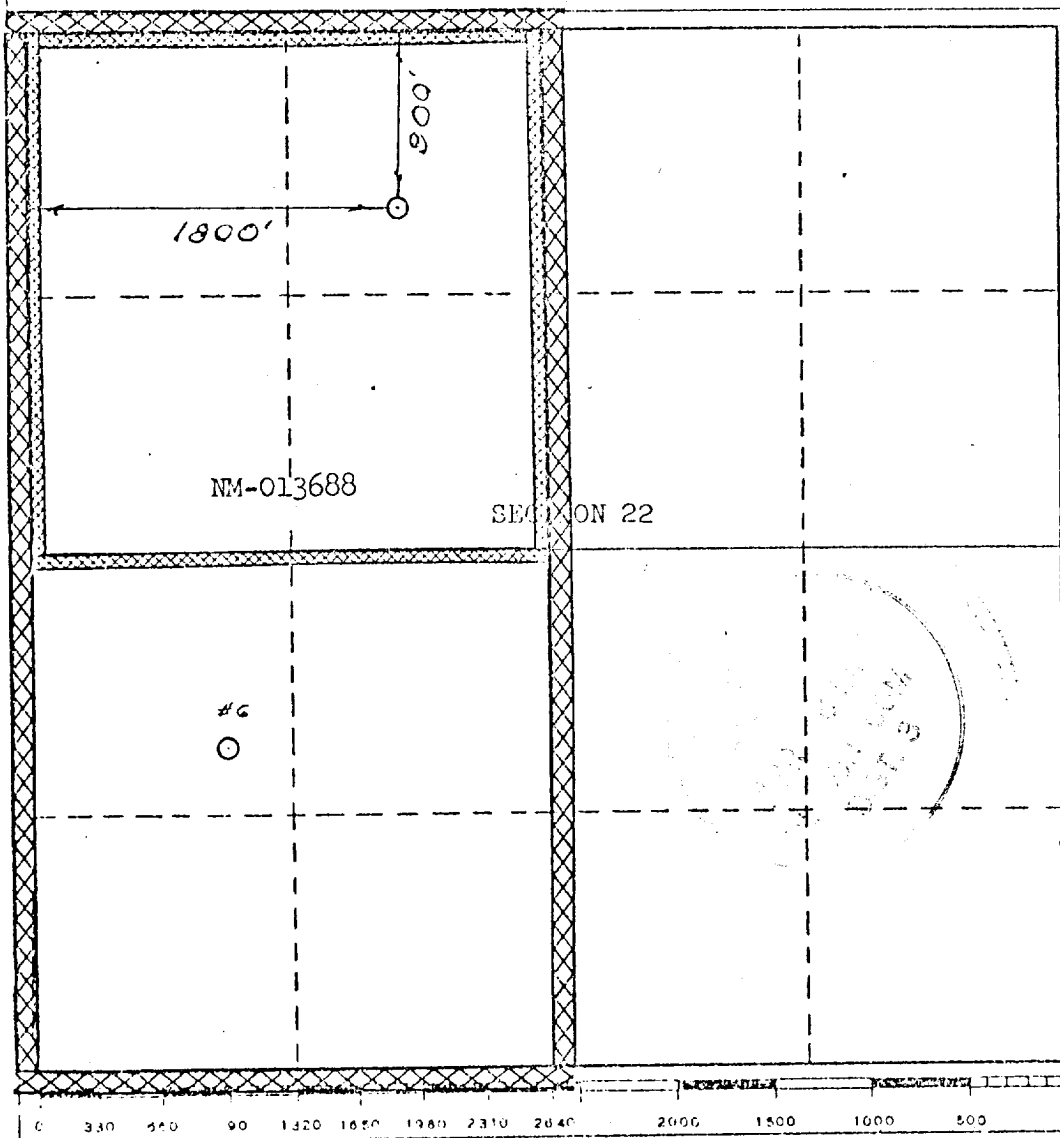

## CERTIFICATION

I hereby certify that the information contained herein is true and complete to the best of my knowledge and belief.

Original Signed by  
**D. G. Brisco**

Name

Drilling Clerk

Position

El Paso Natural Gas Company

Company

April 7, 1977

Date

I hereby certify that the well location shown on this plat was plotted from field notes of actual surveys made by me or under my supervision, and that the same is true and correct to the best of my knowledge and belief.

Date Surveyed

MARCH 9, 1977

Registered Professional Engineer  
and/or Land Surveyor

Certificate No.

1760