

An Archaeological Survey of Two
Proposed Well Locations & Access Roads
Conducted for Kimbark Operating Company

MAR 1 8 1977

Suzanne DeHoff
Cultural Resource
Management Program
San Juan Campus
N. M. State University
28 February 1977

An Archaeological Survey of Two
Proposed Well Locations & Access Roads
Conducted for Kimbark Operating Company

These surveys were conducted on February 26, 1977 by Suzanne DeHoff of the Cultural Resource Management Program, New Mexico State University, San Juan Campus. They were done at the request of Elliott Riggs, representing Kimbark Operating Company, and with the verbal agreement of T. E. Taylor of the Mountain Ute Bureau of Indian Affairs. A visual inspection was made on foot of the areas to be disturbed by the construction of the well locations and access roads.

Proposed Well Kimbark Lizzard Federal #1 is to be located 660 feet from the north line and 760 feet from the west line of Section 25, Township 31 North, Range 15 West, N. M.P.M. in San Juan County, New Mexico. This is on the Mountain Ute Indian Reservation. (Figure 1)

This location is on a slight slope to the east. The soil is a sandy loam with a lot of large gravel. There are local outcrops of shale in the area. Vegetation consists of four-wing saltbush, snake broomweed, and russian thistle.

The access road runs east and down the slope to a flat area and then winds north to the road. (Figure 2)

Nothing was found during the survey to indicate either direct or indirect adverse affects on the cultural resources would result from the proposed construction and thus clearance for this

location is recommended.

Proposed Well Kimbark Clarence Darrow Federal #1 lies 825 feet from the north line and 905 feet from the west line of Section 14, Township 31 North, Range 14 West, N.M.P.M. in San Juan County, New Mexico. (Figure 3) This location is on the Mountain Ute Indian Reservation.

The site lies on the southeast slope of a hill. The soil is rocky and sandy with large sandstone and shale outcroppings. Vegetation consists of pinon, juniper, saltbush, russian thistle, mormon tea, yucca, and snake broomweed.

The access road will run to the east at approximately the same elevation as the well pad. Part of the access road will be over a faded but pre-existing road. (Figure 4)

Clearance for this location is recommended as there was nothing found to indicate that the proposed construction would have either direct or indirect adverse affects on the cultural resources.

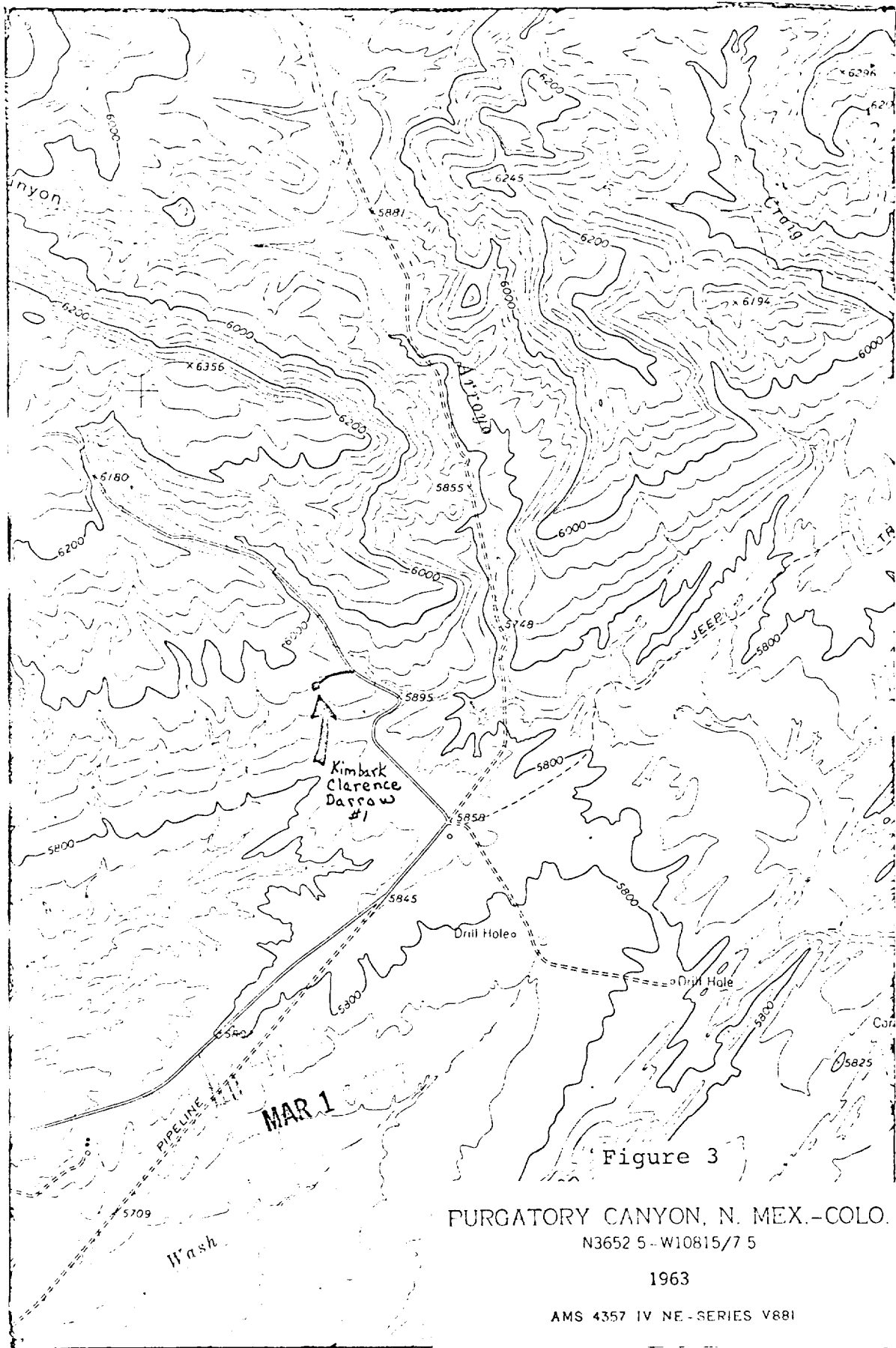

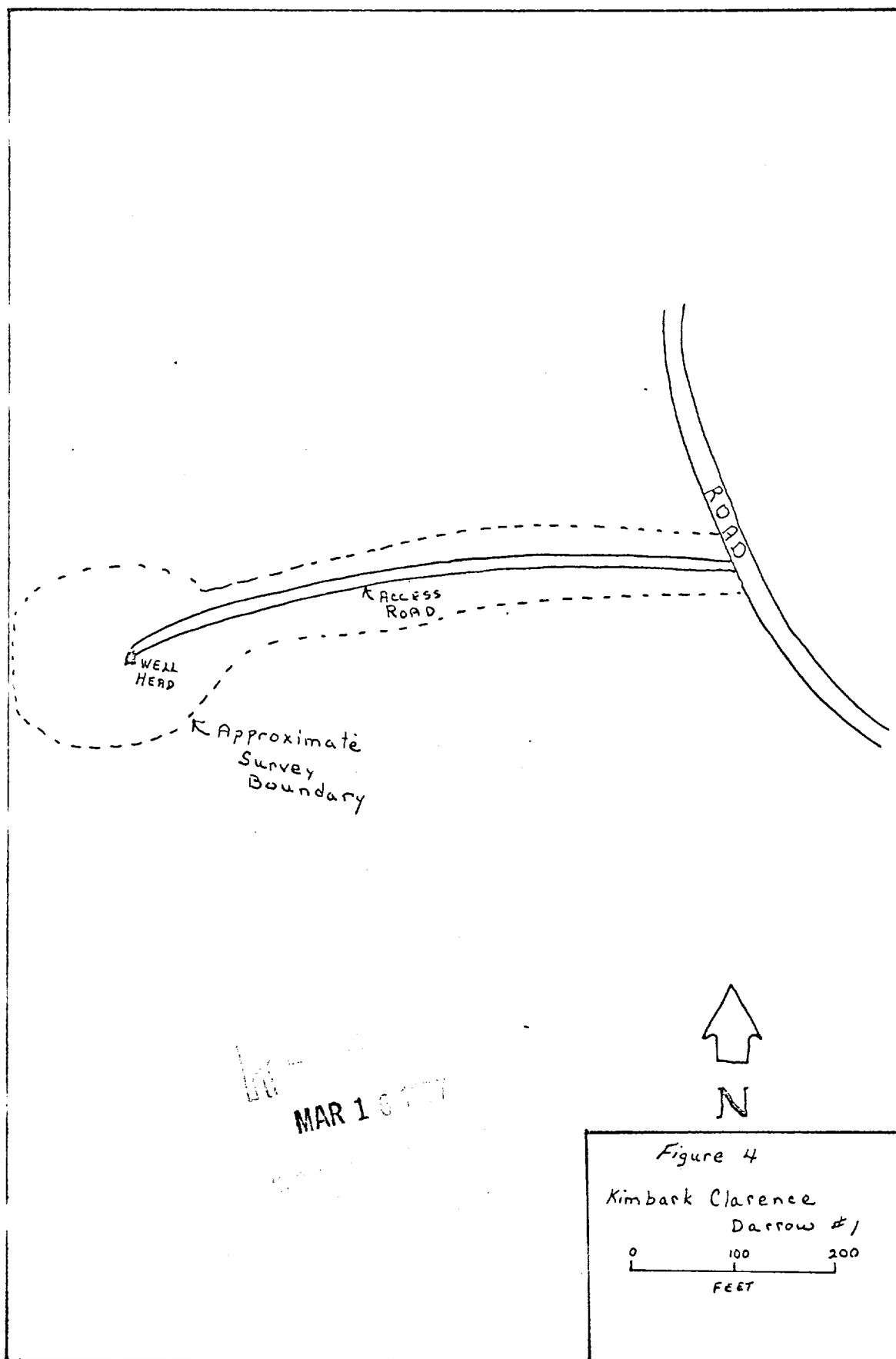

KIMBARK OPERATING COMPANY
KIMBARK COMPANY
KIMBARK ASSOCIATES

KIMBARK
SUITE 808 LINCOLN TOWER BUILDING
1860 LINCOLN STREET
DENVER, COLORADO ~~80202~~ 80295
303-534-7161

WALTER K. ARBUCKLE
GEORGE WALLACE BAYNE
WILLIAM P. THURSTON

March 10, 1977

United States Department of Interior
Bureau of Land Management
PO Box 568
Farmington, New Mexico 87401

Gentlemen:

The 13 Point Program for Kimbark Operating Co., Federal Clarence Darrow #1 well is as follows:

1. See attached topographic map showing access from Kirtland, New Mexico.
2. Rough roads and existing lease roads are in existence to within 550' of the location. There are minimum cuts or fills required on this 550' road.
3. Existing producing wells are shown on attached plat. All other wells are P & A.
4. See attached topographic map for 550' lateral road.
5. See attached plat.
6. The water will be hauled from the San Juan River near Kirtland, New Mexico.
7. All drill cuttings and hand garbage will be covered over in rotary pits. All flamable material will be burned in burn pit and ashes covered over after drilling. All wire line, etc., will be hauled away.
8. None.
9. None.

MAR 10 1977

10. See attached layout.
11. There is only sage brush, sparse grass at this location. There is no top soil, only sand. After leveling and cleanup, it is our plan to plant appropriate grass seed for this area when the moisture level is sufficient to support grass germination. Pits will be fenced till dry enough to fill. Contour of land will be affected as little as possible.
12. The topography here is relatively rough. Operator will keep location as small as possible under the circumstances.
13. I hereby certify that I, or persons under my direct supervision, have inspected the proposed drillsite and access route; that I am familiar with the conditions which presently exist; that the statements made in this plan are, to the best of my knowledge, true and correct; and, that the work associated with the operations proposed herein will be performed by Kimbark Operating Co. and its contractors and sub-contractors in conformity with this plan and the terms and conditions under which it is approved.

KIMBARK OPERATING CO.



Walter K. Arbuckle
President

WKA:jl

K. M. BARK OPERATING COMPANY

LOCATION AND EQUIPMENT LAYOUT

FEDERAL CLARENCE DARROW #1 - NW NW Sec. 14, T31N, R14W
SAN JUAN COUNTY, N. M.

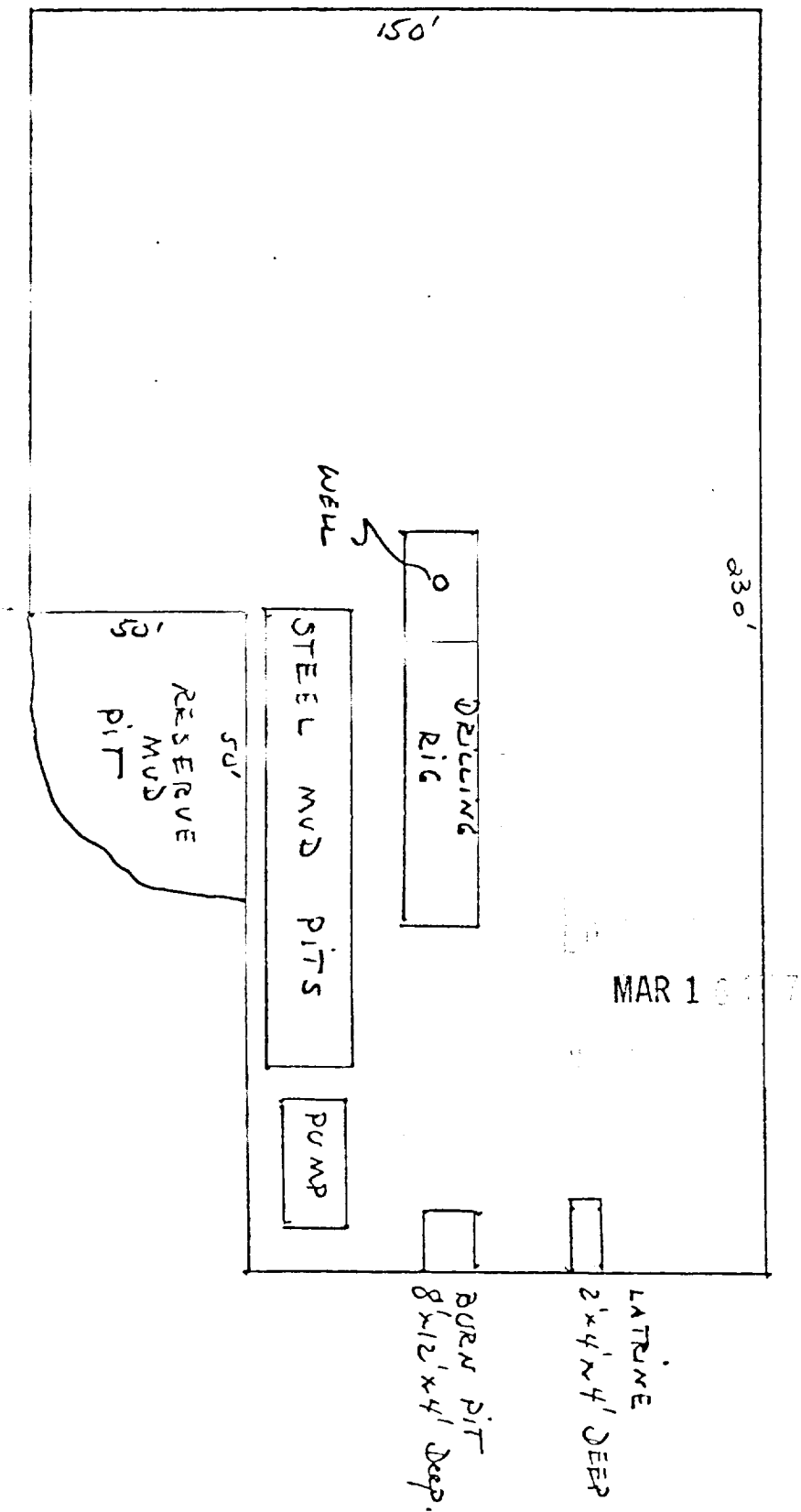

KIMBARK OPERATING COMPANY
KIMBARK COMPANY
KIMBARK ASSOCIATES

KIMBARK
SUITE 808 LINCOLN TOWER BUILDING
1860 LINCOLN STREET
DENVER, COLORADO 80203 80295
303-534-7161

WALTER K. ARBUCKLE
GEORGE WALLACE BAYNE
WILLIAM R. THURSTON

March 10, 1977

Well: Federal Clarence Darrow #1

Location: NW NW Section 14, T31N, R14W
San Juan County, New Mexico

Subject: Safety and Resource Protection 7-Point Program

- 1) 8 5/8" 24# K-55, new.
- 2) 10 3/4" 900 series, 6000 psi.
- 3) None.
- 4) Schaffer 10 3/4", 900 series
double gate, 6000 psi.
- 5) Kelly cocks available, bit float,
sub and valve on floor.
- 6) Anticipated BHP 1200#.
- 7) Water base mud.

MAR 10 1977