

UNITED STATES  
DEPARTMENT OF THE INTERIOR  
GEOLOGICAL SURVEY

SUBMIT IN TRIPLICATE\*  
(Other instructions on re-  
verse side)

Form approved,  
Budget Bureau No. 12 R1424  
5. LEASE DESIGNATION AND SERIAL NO.

SF 078039

6. IF INDIAN, ALLOTTEE OR TRIBE NAME

SUNDRY NOTICES AND REPORTS ON WELLS

(Do not use this form for proposals to drill or to deepen or plug back to a different reservoir.  
Use "APPLICATION FOR PERMIT—" for such proposals.)

1.

OIL WELL ☐ GAS WELL ☒ OTHER

2. NAME OF OPERATOR

El Paso Natural Gas Company

3. ADDRESS OF OPERATOR

Box 990, Farmington, New Mexico 87401

4. LOCATION OF WELL (Report location clearly and in accordance with any State requirements.\*  
See also space 17 below.)  
At surface

1720'S, 850'E

14. PERMIT NO.

15. ELEVATIONS (Show whether DF, RT, GR, etc.)

6451' GL

7. UNIT AGREEMENT NAME

8. FARM OR LEASE NAME

Barnes

9. WELL NO.

6A

10. FIELD AND POOL, OR WILDCAT

Blanco P.C. Ext. & Blanco M

11. SEC., T., R., M., OR BLK. AND  
SURVEY OR AREA

Sec. 23, T-32-N, R-11-W

N.M.P.M.

12. COUNTY OR PARISH

San Juan

13. STATE

New Mexico

16.

Check Appropriate Box To Indicate Nature of Notice, Report, or Other Data

NOTICE OF INTENTION TO:

TEST WATER SHUT-OFF

☐  
☐  
☐  
☐

PULL OR ALTER CASING

☐  
☐  
☐  
☒

MULTIPLE COMPLETE

ABANDON\*

CHANGE PLANS

(Other)

SUBSEQUENT REPORT OF:

WATER SHUT-OFF

☐  
☐  
☐  
☐

FRACTURE TREATMENT

SHOOTING OR ACIDIZING

(Other)

REPAIRING WELL

ALTERING CASING

ABANDONMENT\*

(NOTE: Report results of multiple completion on Well  
Completion or Recompletion Report and Log form.)

17. DESCRIBE PROPOSED OR COMPLETED OPERATIONS (Clearly state all pertinent details, and give pertinent dates, including estimated date of starting any proposed work. If well is directionally drilled, give subsurface locations and measured and true vertical depths for all markers and zones pertinent to this work.)\*

This well was originally planned as a single Mesa Verde completion. It is now planned to dually complete this well in the Pictured Cliffs & Mesa Verde formations. The casing and cementing will remain the same.

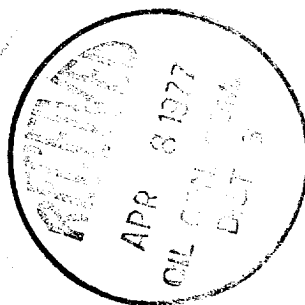

APR 7 1977

GEOLOGICAL SURVEY

18. I hereby certify that the foregoing is true and correct

SIGNED A. G. Duises

TITLE Drilling Clerk

DATE April 5, 1977

(This space for Federal or State office use)

APPROVED BY \_\_\_\_\_  
CONDITIONS OF APPROVAL, IF ANY:

TITLE \_\_\_\_\_

DATE \_\_\_\_\_

NEW MEXICO OIL CONSERVATION COMMISSION  
WELL LOCATION AND ACREAGE DEDICATION PLAT

Supersedes C-128  
Effective 1-1-65

All distances must be from the center boundaries of the Section

Operator <b>EL PASO NATURAL GAS COMPANY</b>		Lease <b>BARNES</b>		(SF-078039)		Well No. <b>6A</b>
Unit Letter <b>I</b>	Section <b>23</b>	Township <b>32-N</b>	Range <b>11-W</b>	County <b>SAN JUAN</b>		
Actual Footage Location of Well: <b>1720</b> feet from the <b>SOUTH</b> line and <b>850</b> feet from the <b>EAST</b> line						
Ground Level Elev. <b>6451</b>	Producing Formation <b>PICTURED CLIFFS &amp; MESA VERDE</b>		Pool <b>BLANCO PICTURED CLIFFS EXT. BLANCO MESA VERDE</b>		Dedicated Acreage: <b>160.00 &amp; 320.00 Acres</b>	

1. Outline the acreage dedicated to the subject well by colored pencil or hatchure marks on the plat below.
2. If more than one lease is dedicated to the well, outline each and identify the ownership thereof (both as to working interest and royalty).
3. If more than one lease of different ownership is dedicated to the well, have the interests of all owners been consolidated by communitization, unitization, force-pooling, etc?

☒ Yes ☐ No If answer is "yes," type of consolidation Communitization

If answer is "no," list the owners and tract descriptions which have actually been consolidated. (Use reverse side of this form if necessary.)

No allowable will be assigned to the well until all interests have been consolidated (by communitization, unitization, forced-pooling, or otherwise) or until a non-standard unit, eliminating such interests, has been approved by the Commission. NOTE: THIS PLAT IS REISSUED TO SHOW DUAL COMPLETION. 4-6-77

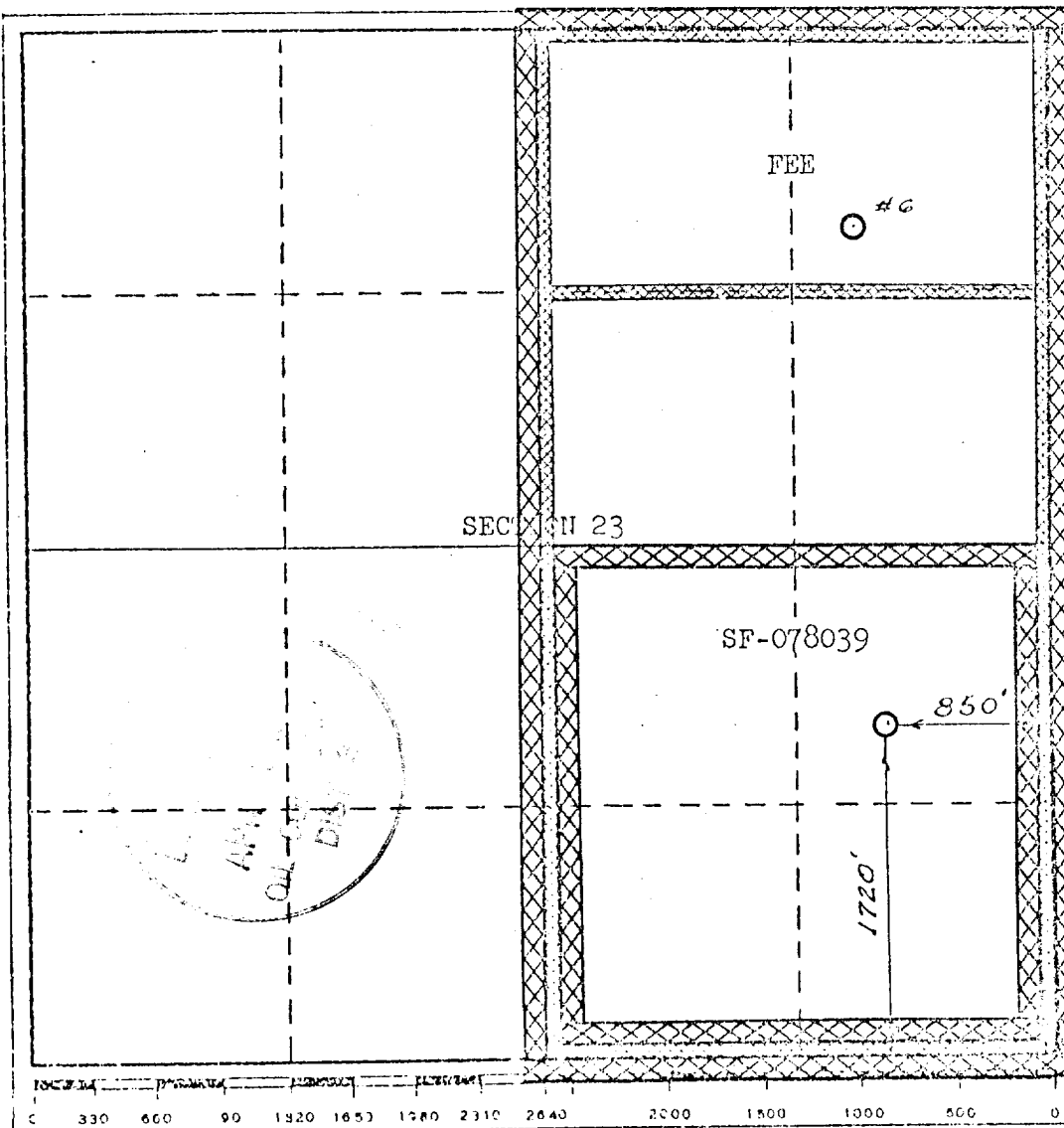

CERTIFICATION

I hereby certify that the information contained herein is true and complete to the best of my knowledge and belief.

*J. D. Duino*

Name

Drilling Clerk

Position

El Paso Natural Gas Company

Company

April 7, 1977

Date

I hereby certify that the well location shown on this plat was plotted from field notes of actual surveys made by me or under my supervision, and that the same is true and correct to the best of my knowledge and belief.

Date Surveyed

MARCH 2, 1977

Registered Professional Engineer and/or Land Surveyor

Certificate No. 1760

330 600 90 1920 1650 1280 2310 2640 2000 1500 1000 500 0