

UNITED STATES
DEPARTMENT OF THE INTERIOR
GEOLOGICAL SURVEY

SUBMIT IN TRIPPLICATE*
(Other Instructions on re-
verse side)

Form approved
Budget Bureau No. 42 R1421
5. LEASE DESIGNATION AND SERIAL NO.

NM 013688

6. IF INDIAN, ALLOTTEE OR TRIBE NAME

SUNDRY NOTICES AND REPORTS ON WELLS

(Do not use this form for proposals to drill or to deepen or plug back to a different reservoir.
Use "APPLICATION FOR PERMIT-" for such proposals.)

1. OIL WELL ☐ GAS WELL ☒ OTHER

2. NAME OF OPERATOR

El Paso Natural Gas Company

3. ADDRESS OF OPERATOR

Box 990, Farmington, New Mexico 87401

4. LOCATION OF WELL (Report location clearly and in accordance with any State requirements.*
See also space 17 below.)
At surface

950'S, 1800'E

7. UNIT AGREEMENT NAME

8. FARM OR LEASE NAME

Atlantic

9. WELL NO.

5A

10. FIELD AND POOL, OR WILDCAT

Blanco P. C. & Blanco M. V.

11. SEC., T., R., M., OR BLK. AND
SURVEY OR AREA

Sec. 22, T-31-N, R-10-W

N.M.P.M.

12. COUNTY OR PARISH 13. STATE

San Juan

New Mexico

14. PERMIT NO.

15. ELEVATIONS (Show whether DF, RT, GR, etc.)

6314' GL

16. Check Appropriate Box To Indicate Nature of Notice, Report, or Other Data

NOTICE OF INTENTION TO:

TEST WATER SHUT-OFF

☐
☐
☐
☐

PULL OR ALTER CASING

☐
☐
☐
☒

FRACTURE TREAT

MULTIPLE COMPLETE

SHOOT OR ACIDIZE

ABANDON*

REPAIR WELL

CHANGE PLANS

(Other)

SUBSEQUENT REPORT OF:

WATER SHUT-OFF

☐
☐
☐
☐

REPAIRING WELL

☐
☐
☐
☐

FRACTURE TREATMENT

ALTERING CASING

SHOOTING OR ACIDIZING

ABANDONMENT*

(Other)

(NOTE: Report results of multiple completion on Well
Completion or Recompletion Report and Log form.)

17. DESCRIBE PROPOSED OR COMPLETED OPERATIONS (Clearly state all pertinent details, and give pertinent dates, including estimated date of starting any proposed work. If well is directionally drilled, give subsurface locations and measured and true vertical depths for all markers and zones pertinent to this work.)*

This well was originally planned as a single Mesa Verde completion. It is now planned to dually complete this well in the Pictured Cliffs & Mesa Verde formations. The casing and cementing will remain the same.



APR 7 1977

GEOLOGICAL SURVEY

18. I hereby certify that the foregoing is true and correct

SIGNED

A. B. Swice

TITLE Drilling Clerk

DATE April 5, 1977

(This space for Federal or State office use)

APPROVED BY

CONDITIONS OF APPROVAL, IF ANY:

TITLE

DATE

WELL LOCATION AND ACREAGE DEDICATION PLAT

Form No. 1
Supersedes C-128
Effective 1-1-65

All distances must be from the outer boundaries of the Section.

Operator EL PASO NATURAL GAS COMPANY			Lease ATLANTIC (NM-013688)		Well No. 5A
Plot Letter 0	Section 22	Township 31-N	Range 10-W	County SAN JUAN	
Actual Footage Location of Well: 950 feet from the SOUTH line and 1800 feet from the EAST line					
Ground Level Elev. 6314	Producing Formation PICTURED CLIFFS & MESAVERDE	Pool BLANCO PICTURED CLIFFS BLANCO MESA VERDE	Dedicated Acreage: 152.94 & 309.96 Acres		

1. Outline the acreage dedicated to the subject well by colored pencil or hachure marks on the plat below.
2. If more than one lease is dedicated to the well, outline each and identify the ownership thereof (both as to working interest and royalty).
3. If more than one lease of different ownership is dedicated to the well, have the interests of all owners been consolidated by communitization, unitization, force-pooling, etc?

☐ Yes ☐ No If answer is "yes," type of consolidation _____

If answer is "no," list the owners and tract descriptions which have actually been consolidated. (Use reverse side of this form if necessary.) _____

No allowable will be assigned to the well until all interests have been consolidated (by communitization, unitization, forced-pooling, or otherwise) or until a non-standard unit, eliminating such interests, has been approved by the Commission. NOTE: THIS PLAT IS REISSUED TO SHOW DUAL COMPLETION. 4-6-77

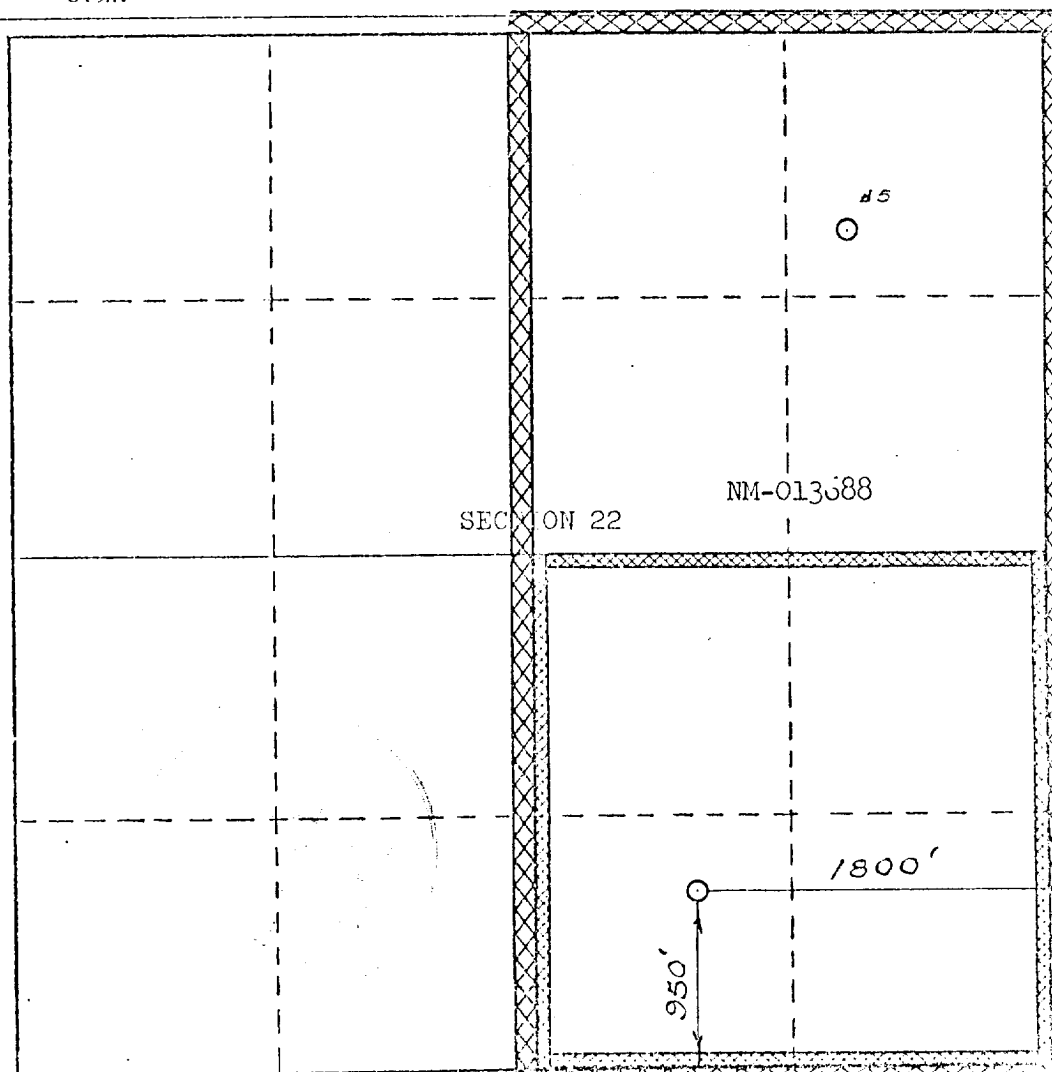

CERTIFICATION

I hereby certify that the information contained herein is true and complete to the best of my knowledge and belief.

J. G. Quico

Name

Drilling Clerk

Position

El Paso Natural Gas Company

Company

April 7, 1977

Date

I hereby certify that the well location shown on this plat was plotted from field notes of actual surveys made by me or under my supervision, and that the same is true and correct to the best of my knowledge and belief.

Date Surveyed

MARCH 10, 1977

Registered Professional Engineer and Licensed Surveyor

David O'Brien

Certificate No.

1760

0 330 660 990 1320 1650 1980 2310 2640 2000 1500 1000 660 0