

OIL CONSERVATION DIVISION

P.O. Box 2088
Santa Fe, New Mexico 87504-2088

Revised 1-1-89
RECEIVED
MAR 07 1989

REQUEST FOR ALLOWABLE AND AUTHORIZATION
TO TRANSPORT OIL AND NATURAL GAS

OIL CON. DIV
DIST. 3

Operator <u>Amoco Production Company</u>		Well API No.
Address <u>2325 East 30th Street, Farmington NM 87401</u>		
Reason(s) for Filing (Check proper box) <input checked="" type="checkbox"/> Other (Please explain)		
New Well <input type="checkbox"/>	Change in Transporter of:	
Recompletion <input type="checkbox"/>	Oil <input type="checkbox"/> Dry Gas <input type="checkbox"/>	<u>Pool Name Change</u>
Change in Operator <input type="checkbox"/>	Casinghead Gas <input type="checkbox"/> Condensate <input type="checkbox"/>	<u>Case #9421 Order #R-8769</u>
If change of operator give name and address of previous operator		

II. DESCRIPTION OF WELL AND LEASE

Lease Name <u>Fields LS</u>	Well No. <u>4A</u>	Pool Name, including Formation <u>Undesignated Fruitland Sand</u>	Kind of Lease State <input type="checkbox"/> Federal <input type="checkbox"/> or Fee	Lease No. <u>NM-010989</u>
Location				
Unit Letter <u>0</u> : <u>840</u> Feet From The <u>S</u> Line and <u>1580</u> Feet From The <u>E</u> Line				
Section <u>28</u> Township <u>32N</u> Range <u>11W</u> , NMPM, <u>San Juan</u> County				

III. DESIGNATION OF TRANSPORTER OF OIL AND NATURAL GAS

Name of Authorized Transporter of Oil <input type="checkbox"/> or Condensate <input checked="" type="checkbox"/>	Address (Give address to which approved copy of this form is to be sent)
<u>Conoco</u>	<u>P.O. Box 460, Hobbs NM 88240</u>
Name of Authorized Transporter of Casinghead Gas <input type="checkbox"/> or Dry Gas <input checked="" type="checkbox"/>	Address (Give address to which approved copy of this form is to be sent)
<u>El Paso Natural Gas Co.</u>	<u>Caller Service 4990, Farmington NM 87499</u>
If well produces oil or liquids, give location of tanks.	Is gas actually connected? When?
Unit <u>0</u> Sec. <u>28</u> Twp. <u>32N</u> Rge. <u>11W</u>	<u>Yes</u> <u>7-10-78</u>

If this production is commingled with that from any other lease or pool, give commingling order number:

IV. COMPLETION DATA

Designate Type of Completion - (X)	Oil Well <input type="checkbox"/>	Gas Well <input type="checkbox"/>	New Well <input type="checkbox"/>	Workover <input type="checkbox"/>	Deepen <input type="checkbox"/>	Plug Back <input type="checkbox"/>	Same Res'v <input type="checkbox"/>	Diff Res'v <input type="checkbox"/>
Date Spudded	Date Compl. Ready to Prod.		Total Depth			P.B.T.D.		
Elevations (DF, RKB, RT, GR, etc.)	Name of Producing Formation		Top Oil/Gas Pay			Tubing Depth		
Perforations						Depth Casing Shoe		
TUBING, CASING AND CEMENTING RECORD								
HOLE SIZE	CASING & TUBING SIZE		DEPTH SET			SACKS CEMENT		

V. TEST DATA AND REQUEST FOR ALLOWABLE

OIL WELL (Test must be after recovery of total volume of load oil and must be equal to or exceed top allowable for this depth or be for full 24 hours.)

Date First New Oil Run To Tank	Date of Test	Producing Method (Flow, pump, gas lift, etc.)	
Length of Test	Tubing Pressure	Casing Pressure	Choke Size
Actual Prod. During Test	Oil - Bbls.	Water - Bbls.	Gas - MCF

GAS WELL

Actual Prod. Test - MCF/D	Length of Test	Bbls. Condensate/MMCF	Gravity of Condensate
Testing Method (pitot, back pr.)	Tubing Pressure (Shut-in)	Casing Pressure (Shut-in)	Choke Size

VI. OPERATOR CERTIFICATE OF COMPLIANCE

I hereby certify that the rules and regulations of the Oil Conservation Division have been complied with and that the information given above is true and complete to the best of my knowledge and belief.

B. D. Shaw

Signature B. D. Shaw Adm. Supv.
Printed Name 3-3-89 Title
Date (505) 325-8841 Telephone No.

OIL CONSERVATION DIVISION

Date Approved MAR 07 1989

By B. D. Shaw
Title SUPERVISION DISTRICT # 3

INSTRUCTIONS: This form is to be filed in compliance with Rule 1104

- 1) Request for allowable for newly drilled or deepened well must be accompanied by tabulation of deviation tests taken in accordance with Rule 111.
- 2) All sections of this form must be filled out for allowable on new and recompleted wells.
- 3) Fill out only Sections I, II, III, and VI for changes of operator, well name or number, transporter, or other such changes.
- 4) Separate Form C 104 must be filed for each pool in multiply completed wells.

All distances must be from the outer boundaries of the Section.

Operator Amoco Production Co.		Lease Fields LS		Well No. 4A
Init Letter 0	Section 28	Township 32N	Range 11W	County San Juan

Actual Footage Location of Well: 840 feet from the South line and 1580 feet from the East line				
Ground Level Elev. 6185'	Producing Formation Fruitland	Pool Undesignated Fruitland Sand	Dedicated Acreage: 160 SE/4	Acres 160

1. Outline the acreage dedicated to the subject well by colored pencil or hatch marks on the plat below.
2. If more than one lease is dedicated to the well, outline each and identify the ownership thereof (both as to working interest and royalty).
3. If more than one lease of different ownership is dedicated to the well, have the interests of all owners been consolidated by communitization, unitization, force-pooling, etc?

☐ Yes ☐ No If answer is "yes," type of consolidation _____

If answer is "no," list the owners and tract descriptions which have actually been consolidated. (Use reverse side of this form if necessary.) _____

No allowable will be assigned to the well until all interests have been consolidated (by communitization, unitization, forced-pooling, or otherwise) or until a non-standard unit, eliminating such interests, has been approved by the Division.

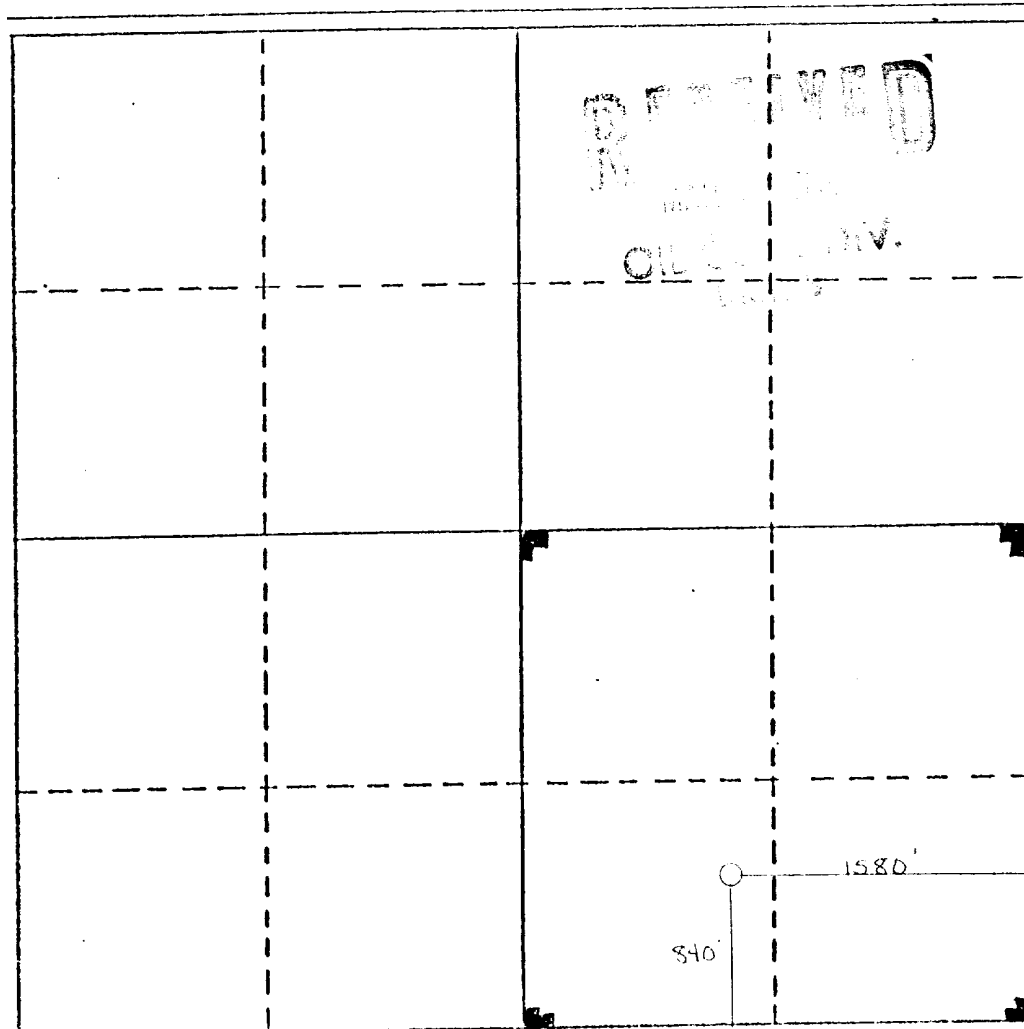

CERTIFICATION

I hereby certify that the information contained herein is true and complete to the best of my knowledge and belief.

B.D. Shaw

Name
B.D. Shaw
Position
Admin. Supv
Company
Amoco
Date
3-3-89

I hereby certify that the well location shown on this plat was plotted from field notes of actual surveys made by me or under my supervision, and that the same is true and correct to the best of my knowledge and belief.

On file

Date Surveyed

Registered Professional Engineer
and/or Land Surveyor

Certificate No.

