

OIL CONSERVATION COMMISSION
Albuquerque DISTRICT

OIL CONSERVATION COMMISSION
BOX 2088
SANTA FE, NEW MEXICO

DATE 5-24-77

RE: Proposed MC ✓
Proposed DHC _____
Proposed NSL _____
Proposed SWD _____
Proposed WFX _____
Proposed PMX _____

Carl Flveg

Gentlemen:

I have examined the application dated 5-¹⁹~~25~~-77
for the El Paso Natural Gas Co. Lucerne A#4A C-10-31N-10W
Operator Lease and Well No. Unit, S-T-R

and my recommendations are as follows:

Approve

Yours very truly,

AR Kendrick

NEW MEXICO OIL CONSERVATION COMMISSION
SANTA FE, NEW MEXICO
APPLICATION FOR MULTIPLE COMPLETION

Form O-107
5-1-61

Operator El Paso Natural Gas Company		County San Juan		Date May 19, 1977
Address PO Box 990, Farmington, NM 87401		Lease Lucerne A		Well No. 4A
Location of Well C	Tract 10	Township 31N		Range 10W

1. Has the New Mexico Oil Conservation Commission heretofore authorized the multiple completion of a well in these same pools or in the same zones within one mile of the subject well? YES ☒ NO ☐
2. If answer is yes, identify one such instance: Order No. _____; Operator Lease, and Well No.: **Re: NMOCC Memo #18-58**

	Upper Zone	Intermediate Zone	Lower Zone
a. Name of Pool and Formation	Pictured Cliffs		Mesa Verde
b. Top and Bottom of Pay Section (Perforations)	2975-3165'		4600-5600'
c. Type of production (Oil or Gas)	gas		gas
d. Method of Production (Flowing or Artificial Lift)	flow		flow

4. The following are attached. (Please check YES or NO)

- | | | |
|---|-------------------------------------|---|
| Yes <input checked="" type="checkbox"/> | No <input type="checkbox"/> | a. Diagrammatic Sketch of the Multiple Completion, showing all casing strings, including diameters and setting depths, centralizers and/or turbolizers and location thereof, quantities used and top of cement, perforated intervals, tubing strings, including diameters and setting depth, location and type of packers and side door chokes, and such other information as may be pertinent. |
| <input checked="" type="checkbox"/> | <input type="checkbox"/> | b. Plat showing the location of all wells on applicant's lease, all offset wells on offset leases, and the names and addresses of operators of all leases offsetting applicant's lease. |
| <input type="checkbox"/> | <input checked="" type="checkbox"/> | c. Waivers consenting to such multiple completion from each offset operator, or in lieu thereof, evidence that said offset operators have been furnished copies of the application.* |
| <input type="checkbox"/> | <input checked="" type="checkbox"/> | d. Electrical log of the well or other acceptable log with tops and bottoms of producing zones and intervals of perforation indicated thereon. (If such log is not available at the time application is filed it shall be submitted as provided by Rule 112-A.) |

5. List all offset operators to the lease on which this well is located together with their correct mailing address.

Koch Industries, PO Box 2256, Wichita, KS 67201

6. Were all operators listed in Item 5 above notified and furnished a copy of this application? YES ☒ NO ☐. If answer is yes, give date of such notification **May 19, 1977**.

CERTIFICATE: I, the undersigned, state that I am the **Drilling Clerk** of the **El Paso Natural Gas** (company), and that I am authorized by said company to make this report; and that this report was prepared under my supervision and direction and that the facts stated therein are true, correct and complete to the best of my knowledge.

[Signature]

Signature

*Should waivers from all offset operators not accompany an application for administrative approval, the New Mexico Oil Conservation Commission will hold the application for a period of twenty (20) days from date of receipt by the Commission's Santa Fe office. If, after said twenty-day period, no protest nor request for hearing is received by the Santa Fe office, the application will then be processed.

NOTE: If the proposed multiple completion will result in an unorthodox well location and/or a non-standard proration unit in one or more of the producing zones, then separate application for approval of the same should be filed simultaneously with this application.

Plat Showing Location of Intended Dual Completion
El Paso Natural Gas Company Lucerne A #4A(PM) Well
and Offset Acreage

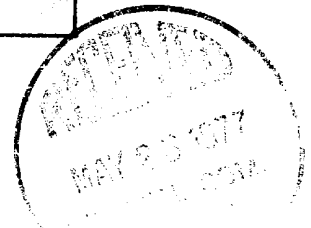
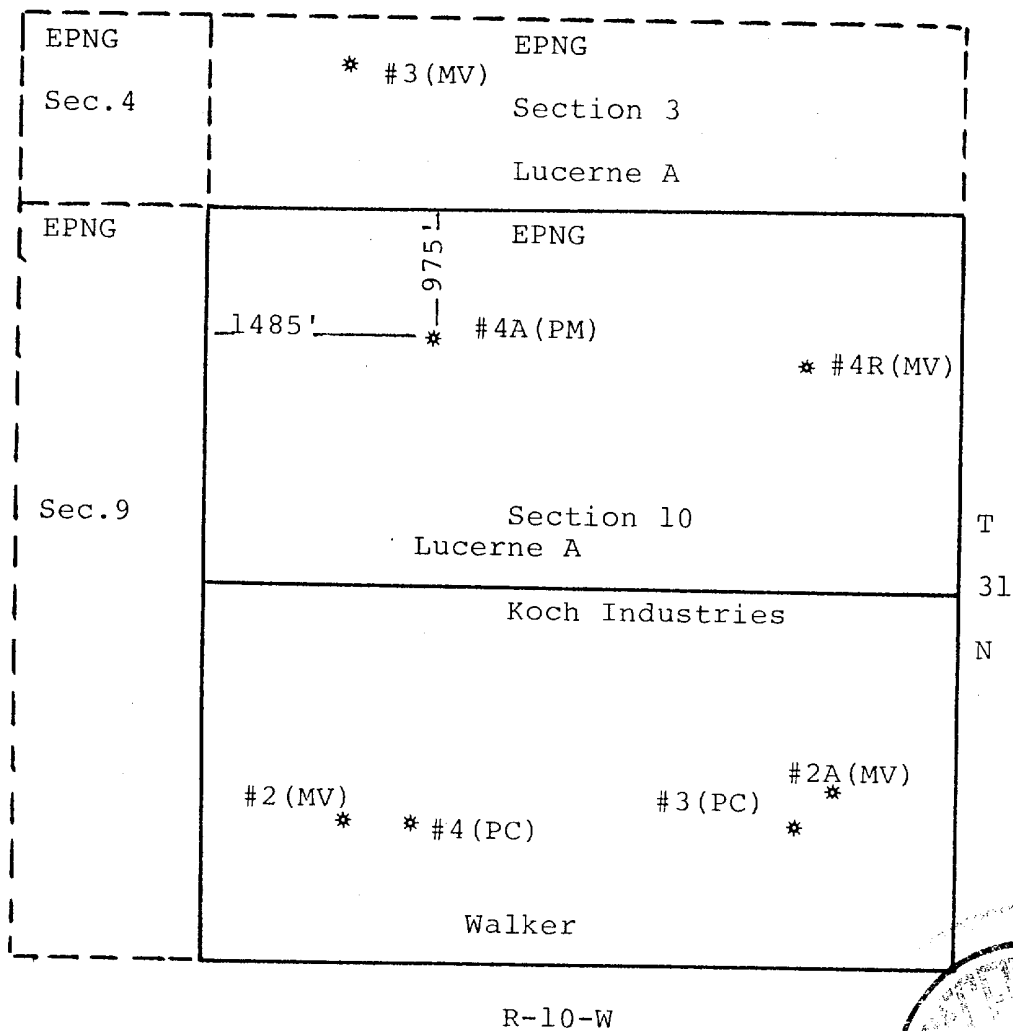

Schematic Diagram of Intended Dual Completion
 El Paso Natural Gas Company Lucerne A #4A
 NW/4 Section 10, T-31-N, R-10-W

Dual String
 xmas tree

Zero reference point 10.0' above top flange
 of tubing hanger

