

UNITED STATES
DEPARTMENT OF THE INTERIOR
GEOLOGICAL SURVEY

30-045-2286

APPLICATION FOR PERMIT TO DRILL, DEEPEN, OR PLUG BACK

13. TYPE OF WORK DRILL <input checked="" type="checkbox"/> DEEPEN <input type="checkbox"/> PLUG BACK <input type="checkbox"/>			5. LEASE DESIGNATION AND SERIAL NO. NM 03189	
b. TYPE OF WELL OIL WELL <input type="checkbox"/> GAS WELL <input checked="" type="checkbox"/> OTHER <input type="checkbox"/> SINGLE ZONE <input type="checkbox"/> MULTIPLE ZONE <input type="checkbox"/>			6. IF INDIAN, ALLOTTEE OR TRIBE NAME	
2. NAME OF OPERATOR Northwest Pipeline Corporation			7. UNIT AGREEMENT NAME Cox Canyon Unit	
3. ADDRESS OF OPERATOR P.O. Box 90, Farmington, New Mexico 87401			8. FARM OR LEASE NAME Cox Canyon Unit	
4. LOCATION OF WELL (Report location clearly and in accordance with any State requirements.)* At surface 1520 FSL & 1070 FWL At proposed prod. zone As above			9. WELL NO. 26	
14. DISTANCE IN MILES AND DIRECTION FROM NEAREST TOWN OR POST OFFICE*			10. FIELD AND POOL, OR WILDCAT Blanco Pictured Cliffs	
15. DISTANCE FROM PROPOSED* LOCATION TO NEAREST PROPERTY OR LEASE LINE, FT. (Also to nearest drlg. unit line, if any) 1070'			11. SEC., T., R., M., OR BLK. AND SURVEY OR AREA Sec. 9, T32N, R11W	
16. NO. OF ACRES IN LEASE NA			12. COUNTY OR PARISH San Juan	
17. NO. OF ACRES ASSIGNED TO THIS WELL 164.2 168.30			13. STATE N.M.	
18. DISTANCE FROM PROPOSED LOCATION* TO NEAREST WELL, DRILLING, COMPLETED, OR APPLIED FOR, ON THIS LEASE, FT. NA			19. PROPOSED DEPTH 3338'	
20. ROTARY OR CABLE TOOLS Rotary			21. APPROX. DATE WORK WILL START*	
22. ELEVATIONS (Show whether DF, RT, GR, etc.) 6546 GR				

PROPOSED CASING AND CEMENTING PROGRAM

SIZE OF HOLE	SIZE OF CASING	WEIGHT PER FOOT	SETTING DEPTH	QUANTITY OF CEMENT
12 1/4"	8 5/8"	24#	120'	85 sks.
6 3/4"	2 7/8"	6.4#	3338'	225 sks.

Selectively perforate and stimulate the Pictured Cliffs formation.

A BOP will be installed after the surface casing has been run and cemented.
All subsequent operations will be conducted through the BOP.

The ~~well~~ of Section 9 is dedicated to this well.

Gas is dedicated.

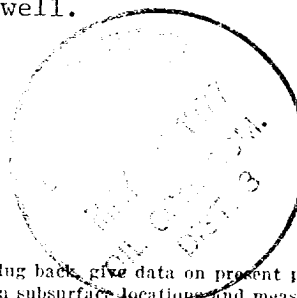

APR 29 1977

IN ABOVE SPACE DESCRIBE PROPOSED PROGRAM: If proposal is to deepen or plug back, give data on present productive zone and proposed new productive zone. If proposal is to drill or deepen directionally, give pertinent data on subsurface locations and measured and true vertical depths. Give blowout preventer program, if any.

24. SIGNED J.P. Slattery TITLE Drilling Engineer DATE 4/5/77
(This space for Federal or State office use)

PERMIT NO. APPROVAL DATE

APPROVED BY CONDITIONS OF APPROVAL, IF ANY: TITLE DATE

*See Instructions On Reverse Side

White man

NEW MEXICO OIL CONSERVATION COMMISSION
WELL LOCATION AND ACREAGE DEDICATION PLAT

Form C-102
Supersedes C-128
Effective 1-1-65

All distances must be from the outer boundaries of the Section.

Operator Northwest Pipeline Corporation			Lease Cox Canyon Unit		Well No. 26
Unit Letter L	Section 9	Township 32N	Range 11W	County San Juan	
Actual Footage Location of Well: 1520 feet from the South line and 1070 feet from the West line					
Ground Level Elev. 6546	Producing Formation Pictured Cliffs		Pool Blanco Pictured Cliffs	Dedicated Acreage: 168.30 164.2 Acres	

1. Outline the acreage dedicated to the subject well by colored pencil or hachure marks on the plat below.
2. If more than one lease is dedicated to the well, outline each and identify the ownership thereof (both as to working interest and royalty).
3. If more than one lease of different ownership is dedicated to the well, have the interests of all owners been consolidated by communitization, unitization, force-pooling, etc?

☐ Yes ☐ No If answer is "yes," type of consolidation _____

If answer is "no," list the owners and tract descriptions which have actually been consolidated. (Use reverse side of this form if necessary.) _____

No allowable will be assigned to the well until all interests have been consolidated (by communitization, unitization, forced-pooling, or otherwise) or until a non-standard unit, eliminating such interests, has been approved by the Commission.

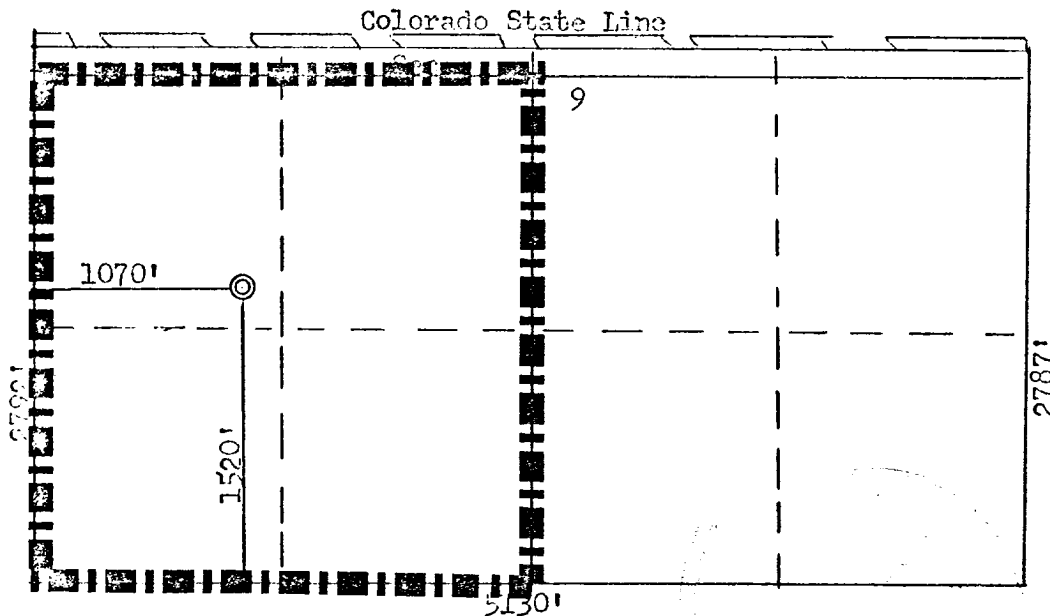

Scale: 1"=1000'

CERTIFICATION

I hereby certify that the information contained herein is true and complete to the best of my knowledge and belief.

J.P. Slattery
Name

J.P. Slattery

Position

Drilling Engineer

Company

Northwest Pipeline Corp.

Date

4/5/77

I hereby certify that the well location shown on this plat was plotted from field notes of actual surveys made by me or under my supervision, and that the same is true and correct to the best of my knowledge and belief.

Date Surveyed

March 17, 1977

Registered Professional Engineer
and Land Surveyor

Fred B. Kern Jr.
Fred B. Kern Jr.

Certificate No.