

**NEW MEXICO OIL CONSERVATION COMMISSION
WELL LOCATION AND ACREAGE DEDICATION PLAT**

Form C-102
Supersedes C-128
Effective 1-1-65

All distances must be from the outer boundaries of the Section.

Operator Phillips Petroleum Company			Lease San Juan 32-7 Unit		Well No. 45
Unit Letter K	Section 35	Township 32N	Range 7W	County San Juan	
Actual Footage Location of Well: 1800 feet from the South line and 1610 feet from the West line					
Ground Level Elev. 6572	Producing Formation Pictured Cliffs		Pool S. Los Pinos Fruitland Sand PC		Dedicated Acreage: 160 Acres

1. Outline the acreage dedicated to the subject well by colored pencil or hachure marks on the plat below.
2. If more than one lease is dedicated to the well, outline each and identify the ownership thereof (both as to working interest and royalty).
3. If more than one lease of different ownership is dedicated to the well, have the interests of all owners been consolidated by communitization, unitization, force-pooling, etc?

☐ Yes ☐ No If answer is "yes," type of consolidation _____

If answer is "no," list the owners and tract descriptions which have actually been consolidated. (Use reverse side of this form if necessary.) _____

No allowable will be assigned to the well until all interests have been consolidated (by communitization, unitization, forced-pooling, or otherwise) or until a non-standard unit, eliminating such interests, has been approved by the Commission.

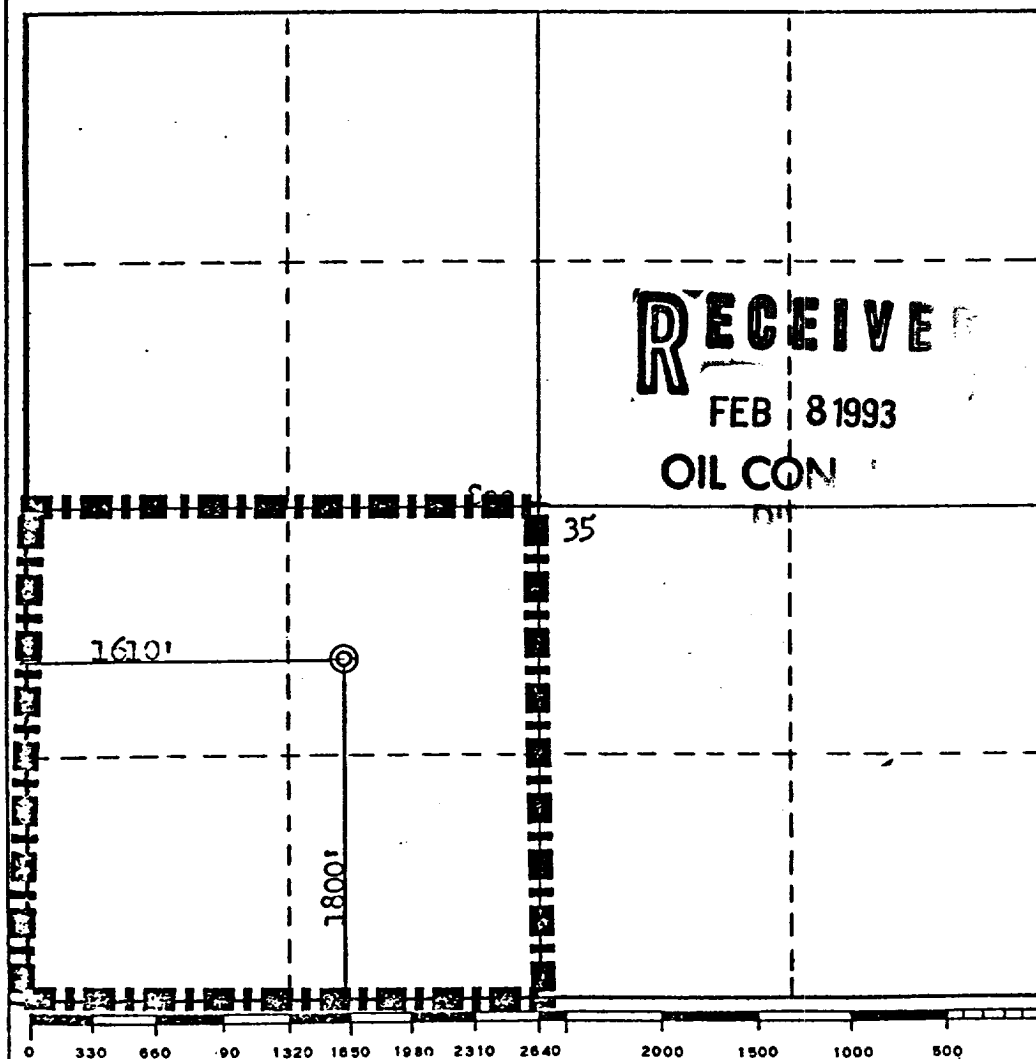

CERTIFICATION

I hereby certify that the information contained herein is true and complete to the best of my knowledge and belief.

L. E. Robinson
Name

L. E. Robinson

Position

Sr. Drlg & Prod Engr Spec.

Company

Phillips Petroleum Company

Date

February 5, 1993

I hereby certify that the well location shown on this plat was plotted from field notes of actual surveys made by me or under my supervision, and that the same is true and correct to the best of my knowledge and belief.

Date Surveyed

March 16, 1993

Registered Professional Engineer
and/or Land Surveyor

Fred B. Kern Jr.
Certificate No.

3950