

NO. OF COPIES RECEIVED	6
DISTRIBUTION	
SANTA FE	1
FILE	1
U.S.G.S.	2
LAND OFFICE	
OPERATOR	2

# NEW MEXICO OIL CONSERVATION COMMISSION

30-045-22576  
Form C-101  
Revised 1-4-65

5A. Indicate Type of Lease	
STATE <input type="checkbox"/>	FEE <input checked="" type="checkbox"/>

5. State Oil & Gas Lease No.

## APPLICATION FOR PERMIT TO DRILL, DEEPEN, OR PLUG BACK

1a. Type of Work		7. Unit Agreement Name	
b. Type of Well OIL WELL <input type="checkbox"/> GAS WELL <input checked="" type="checkbox"/> OTHER <input type="checkbox"/>		Allison Unit	
DRILL <input checked="" type="checkbox"/> DEEPEN <input type="checkbox"/> PLUG BACK <input type="checkbox"/>		8. Farm or Lease Name	
SINGLE ZONE <input checked="" type="checkbox"/> MULTIPLE ZONE <input type="checkbox"/>		Allison Unit	
2. Name of Operator		9. Well No.	
El Paso Natural Gas Company		22	
3. Address of Operator		10. Field and Pool, or Wildcat	
PO Box 990, Farmington, NM 87401		Blanco Mesa Verde	
4. Location of Well UNIT LETTER B LOCATED 1150 FEET FROM THE North LINE AND 1850 FEET FROM THE East LINE OF SEC. 25 TWP. 32N RGE. 7W NMPM		12. County	
		San Juan	
19. Proposed Depth		19A. Formation	20. Rotary or C.T.
6095'		Mesa Verde	Rotary
21. Elevations (Show whether DF, RT, etc.)	21A. Kind & Status Plug. Bond	21B. Drilling Contractor	22. Approx. Date Work will start
6464' GR	statewide		

23.

## PROPOSED CASING AND CEMENT PROGRAM

SIZE OF HOLE	SIZE OF CASING	WEIGHT PER FOOT	SETTING DEPTH	SACKS OF CEMENT	EST. TOP
13 3/4"	9 5/8"	32.3#	200'	224 cu.ft.	circulate
8 3/4"	7"	20.0#	3630'	266 cu.ft.	cover Ojo Alam
6 1/4"	4 1/2"	10.5#	3480'-6095'	456 cu.ft.	fill to 3480'

Selectively perforate and sandwater fracture the Mesa Verde formation.

A 3000 psi WP and 6000 psi test double gate preventer equipped with blind and pipe rams will be used for blow out prevention on this well.

This gas is dedicated.

The N/2 of Section 25 is dedicated to this well.

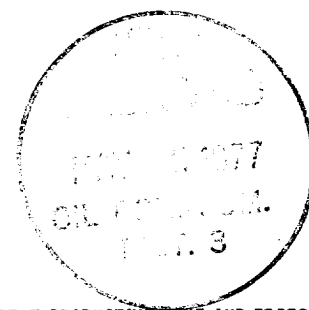

IN ABOVE SPACE DESCRIBE PROPOSED PROGRAM: IF PROPOSAL IS TO DEEPEN OR PLUG BACK, GIVE DATA ON PRESENT PRODUCTIVE ZONE AND PROPOSED NEW PRODUCTIVE ZONE. GIVE BLOWOUT PREVENTER PROGRAM, IF ANY.

I hereby certify that the information above is true and complete to the best of my knowledge and belief.

Signed D. P. Davis Title Drilling Clerk Date May 5, 1977

(This space for State Use)

APPROVED BY AR Hendrick TITLE SUPERVISOR DIST DATE May 5, 1977  
CONDITIONS OF APPROVAL, IF ANY:

NEW MEXICO OIL CONSERVATION COMMISSION  
WELL LOCATION AND ACREAGE DEDICATION PLAT

Form C-102  
Supersedes C-128  
Effective 1-1-65

All distances must be from the outer boundaries of the Section.

Operator <b>EL PASO NATURAL GAS COMPANY</b>		Lease <b>ALLISON UNIT (FEE)</b>		Well No. <b>22</b>
Unit Letter <b>B</b>	Section <b>25</b>	Township <b>32-N</b>	Range <b>7-W</b>	County <b>SAN JUAN</b>
Actual Footage Location of Well: <b>1150</b> feet from the <b>NORTH</b> line and <b>1850</b> feet from the <b>EAST</b> line				
Ground Level Elev. <b>6464</b>	Producing Formation <b>MESA VERDE</b>	Pool <b>BLANCO MESA VERDE</b>	Dedicated Acreage: <b>N 320.00</b> Acres	

1. Outline the acreage dedicated to the subject well by colored pencil or hatchure marks on the plat below.
2. If more than one lease is dedicated to the well, outline each and identify the ownership thereof (both as to working interest and royalty).
3. If more than one lease of different ownership is dedicated to the well, have the interests of all owners been consolidated by communitization, unitization, force-pooling, etc?

☐ Yes ☐ No If answer is "yes," type of consolidation \_\_\_\_\_

If answer is "no," list the owners and tract descriptions which have actually been consolidated. (Use reverse side of this form if necessary.) \_\_\_\_\_

No allowable will be assigned to the well until all interests have been consolidated (by communitization, unitization, forced-pooling, or otherwise) or until a non-standard unit, eliminating such interests, has been approved by the Commission. NOTE: THIS PLAT IS REISSUED TO REFLECT A MOVED LOCATION. 4-21-77

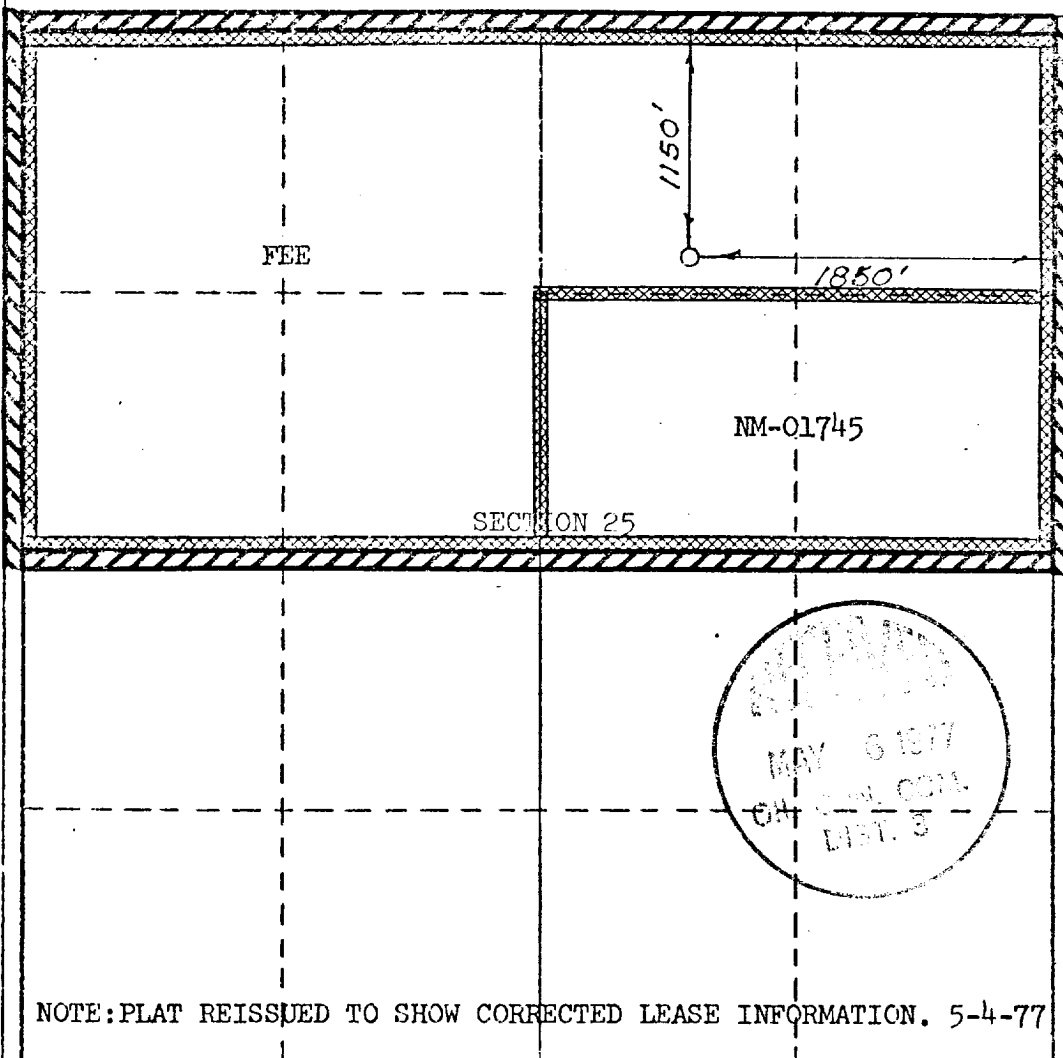

CERTIFICATION

I hereby certify that the information contained herein is true and complete to the best of my knowledge and belief.

Original Signed by  
**D. G. Brisco**

Name  
**Drilling Clerk**  
Position  
**El Paso Natural Gas**  
Company  
**May 6, 1977**  
Date

I hereby certify that the well location shown on this plat was plotted from field notes of actual surveys made by me or under my supervision, and that the same is true and correct to the best of my knowledge and belief.

Date Surveyed  
**APRIL 20, 1977**

Registered Professional Engineer  
and/or Land Surveyor

Certificate No. **1760**

0 330 660 990 1320 1650 1980 2310 2640 2970 3300 3630 3960 4290 4620 4950 5280 5610 5940 6270 6600