

WELL LOCATION AND ACREAGE DEDICATION PLAT

Effective 1-1-85

All distances must be from the outer boundaries of the Section.

Operator Southland Royalty Company		Lease Burnt Mesa		Well No. #1-A
Unit Letter J	Section 25	Township 32N	Range 7W	County San Juan
Actual Footage Location of Well: 1830 feet from the South line and 1550 feet from the East line				
Ground Level Elev. 7548'	Producing Formation Mesa Verde/Pictured Cliffs	Pool Blanco/So. Los Pinos	Dedicated Acreage: 320 Acres	

1. Outline the acreage dedicated to the subject well by colored pencil or hachure marks on the plat below.
2. If more than one lease is dedicated to the well, outline each and identify the ownership thereof (both as to working interest and royalty).
3. If more than one lease of different ownership is dedicated to the well, have the interests of all owners been consolidated by communitization, unitization, force-pooling, etc?

☐ Yes ☐ No If answer is "yes," type of consolidation _____

If answer is "no," list the owners and tract descriptions which have actually been consolidated. (Use reverse side of this form if necessary.) _____

No allowable will be assigned to the well until all interests have been consolidated (by communitization, unitization, force-pooling, or otherwise) or until a non-standard unit, eliminating such interests, has been approved by the Commission.

CERTIFICATION

I hereby certify that the information contained herein is true and complete to the best of my knowledge and belief.

Name
Robert E. Fielder
Position
District Engineer
Company
Southland Royalty Company
Date
November 6, 1980

I hereby certify that the well location shown on this plat was plotted from field notes of actual surveys made by me or under my supervision, and that the same is true and correct to the best of my knowledge and belief.

Date Surveyed
April 26, 1977
Registered Professional Engineer and/or Land Surveyor

Fred B. Kerr, Jr.

Certificate No.
3950

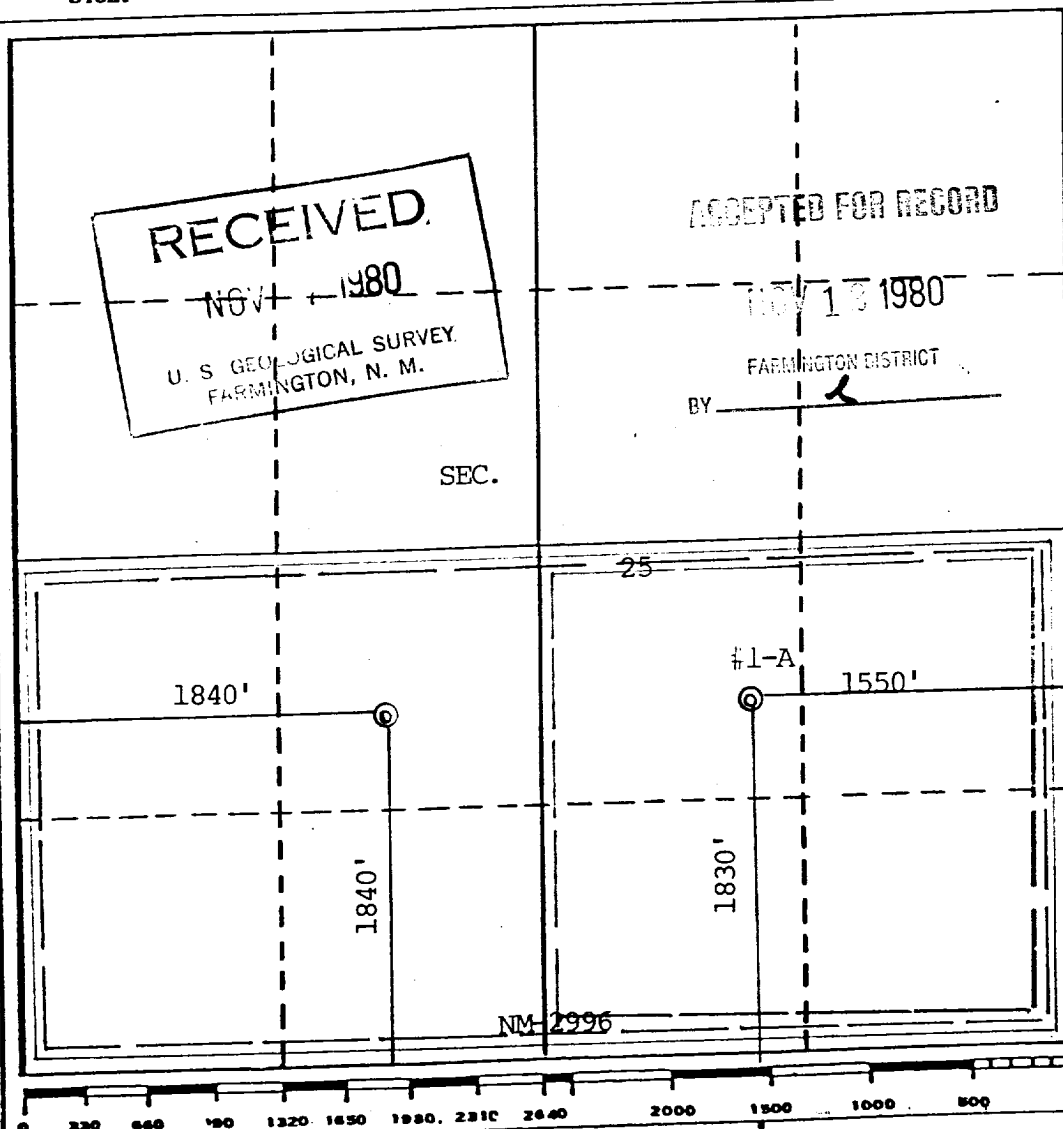

NMCCC