

UNITED STATES
DEPARTMENT OF THE INTERIOR
GEOLOGICAL SURVEY

30-045-22629

APPLICATION FOR PERMIT TO DRILL, DEEPEN, OR PLUG BACK

1a. TYPE OF WORK DRILL <input checked="" type="checkbox"/> DEEPEN <input type="checkbox"/> PLUG BACK <input type="checkbox"/>			5. LEASE DESIGNATION AND SERIAL NO. M-00-C-1420-1709
b. TYPE OF WELL OIL WELL <input type="checkbox"/> GAS WELL <input checked="" type="checkbox"/> OTHER <input type="checkbox"/> SINGLE ZONE <input type="checkbox"/> MULTIPLE ZONE <input type="checkbox"/>			6. IF INDIAN, ALLOTTEE OR TRIBE NAME Ute Mtn. Ute
2. NAME OF OPERATOR Robert C. Anderson			7. UNIT AGREEMENT NAME None
3. ADDRESS OF OPERATOR Suite 910 - National Foundation Bldg. 3535 NW 58th St., Oklahoma City, Okla. 73112			8. FARM OR LEASE NAME Ute Mtn. Ute
4. LOCATION OF WELL (Report location clearly and in accordance with any State requirements.*) At surface 1650 feet south of the North line and 1650 feet West of the East line of Section 14 - Twp. 31N-R16W. At proposed prod. zone Same			9. WELL NO. 5
14. DISTANCE IN MILES AND DIRECTION FROM NEAREST TOWN OR POST OFFICE*			10. FIELD AND POOL, OR WILDCAT Straight Canyon Dakota
15. DISTANCE FROM PROPOSED* LOCATION TO NEAREST PROPERTY OR LEASE LINE, FT. (Also to nearest drlg. unit line, if any) 1650 Feet			11. SEC., T., R., M., OR BLK. AND SURVEY OR AREA Sec. 14-Twp. 31N-R16W N.M.P.M.
16. NO. OF ACRES IN LEASE 640			12. COUNTY OR PARISH San Juan
17. NO. OF ACRES ASSIGNED TO THIS WELL 160			13. STATE New Mexico
18. DISTANCE FROM PROPOSED LOCATION* TO NEAREST WELL, DRILLING COMPLETED, OR APPLIED FOR, ON THIS LEASE, FT. 1476 Feet			20. ROTARY OR CABLE TOOLS Rotary
21. ELEVATIONS (Show whether DF, RT, GR, etc.)			22. APPROX. DATE WORK WILL START* August 1, 1977

23. PROPOSED CASING AND CEMENTING PROGRAM

SIZE OF HOLE	SIZE OF CASING	WEIGHT PER FOOT	SETTING DEPTH	QUANTITY OF CEMENT
9 7/8"	7"	20#	550	300 sx. (Cir. to surface).
6 1/4"	4 1/2"	10.23#	(At proposed depth)	(Amount to protect oil or gas zones).

It is proposed to drill a Dakota sand well to an approximate depth of 2325 feet at the above captioned location in the following manner:
9 7/8" surface hole will be rotary mud-drilled to approx. depth of 550 feet and 7" surface casing set at this depth with cement circulated to surface. A 6 1/4" hole then to be rotary air-drilled to the proposed depth. Blow out preventer will be installed and in use during drilling operations under surface casing. (Type B.O.P. - 8" - 900 Series, hydraulic closing, double ram, 6000 psi test, 3000 psi working pressure Shaffer blow-out preventer). All drilled formations are to be carefully tested as would any prudent operator.

The gas at this location is not dedicated as yet.

IN ABOVE SPACE DESCRIBE PROPOSED PROGRAM: If proposal is to deepen or plug back, give data on present productive zone and proposed new productive zone. If proposal is to drill or deepen directionally, give pertinent data on subsurface locations and measured and true vertical depths. Give blowout preventer program, if any.

24. SIGNED Ashton B. Geren, Jr. Agent for: Robert C. Anderson DATE July 3, 1977
(This space for Federal or State office use)

PERMIT NO. _____ APPROVAL DATE _____

APPROVED BY _____ TITLE _____ DATE _____
CONDITIONS OF APPROVAL, IF ANY:

Instructions

General: This form is designed for submitting proposals to perform certain well operations, as indicated, on all types of lands and leases for appropriate action by either a Federal or a State agency or both, pursuant to applicable Federal and/or State laws and regulations. Any necessary special instructions concerning the use of this form and the number of copies to be submitted, particularly with regard to local, area, or regional procedures and practices, either are shown below or will be issued by, or may be obtained from, the local Federal and/or State office.

Item 1: If the proposal is to redrill to the same reservoir at a different subsurface location or to a new reservoir, use this form with appropriate notations. Consult applicable State or Federal regulations concerning subsequent work proposals or reports on the well.

Item 4: If there are no applicable State requirements, locations on Federal or Indian land should be described in accordance with Federal requirements. Consult local State or Federal office for specific instructions.

Item 14: Needed only when location of well cannot readily be found by road from the land or lease description. A plat, or plats, separate or on this reverse side, showing the roads to, and the surveyed location of, the well, and any other required information, should be furnished when required by Federal or State agency offices.

Items 15 and 18: If well is to be, or has been directionally drilled, give distances for subsurface location of hole in any present or objective production zone.

Item 22: Consult applicable Federal or State regulations, or appropriate officials, concerning approval of the proposal before operations are started.

NEW MEXICO OIL CONSERVATION COMMISSION
WELL LOCATION AND ACREAGE DEDICATION PLAT

Form C-102
Supersedes C-128
Effective 1-1-65

All distances must be from the outer boundaries of the Section.

Operator Robert C. Anderson			Lease Ute Mtn. Ute		Well No. #5
Unit Letter G	Section 14	Township 31N	Range 16W	County San Juan	
Actual Footage Location of Well: 1650 feet from the North line and 1650 feet from the East line					
Ground Level Elev. 5729	Producing Formation Dakota		Pool Straight Canyon Dakota		Dedicated Acreage: 160 Acres

1. Outline the acreage dedicated to the subject well by colored pencil or hachure marks on the plat below.
2. If more than one lease is dedicated to the well, outline each and identify the ownership thereof (both as to working interest and royalty).
3. If more than one lease of different ownership is dedicated to the well, have the interests of all owners been consolidated by communitization, unitization, force-pooling, etc?

☐ Yes ☐ No If answer is "yes," type of consolidation _____

If answer is "no," list the owners and tract descriptions which have actually been consolidated. (Use reverse side of this form if necessary.) _____

No allowable will be assigned to the well until all interests have been consolidated (by communitization, unitization, forced-pooling, or otherwise) or until a non-standard unit, eliminating such interests, has been approved by the Commission.

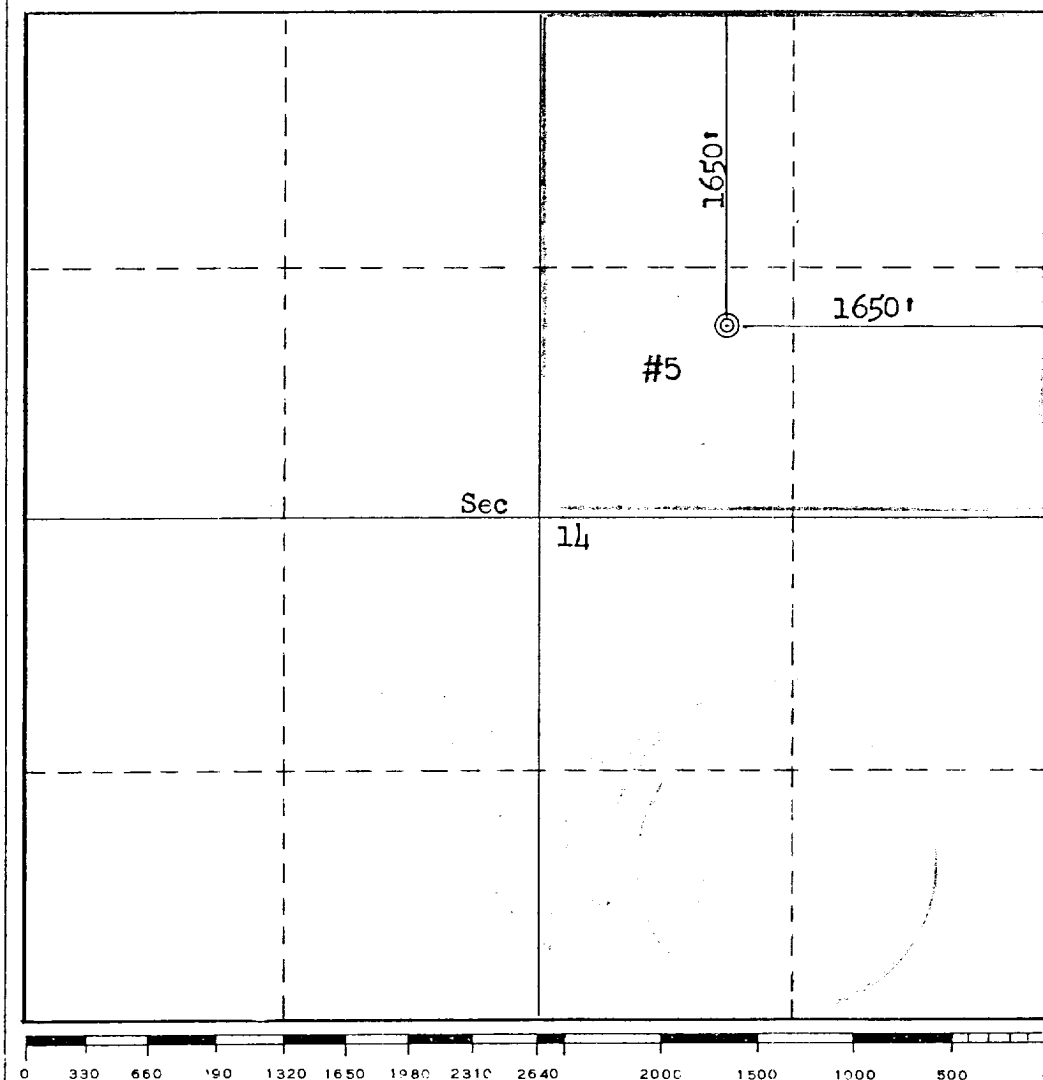

CERTIFICATION

I hereby certify that the information contained herein is true and complete to the best of my knowledge and belief.

Name **Ashton B. Geren, Jr.**
Position **Agent for:**
Robert C. Anderson
Company
Robert C. Anderson
Date
July 3, 1977

I hereby certify that the well location shown on this plat was plotted from field notes of actual surveys made by me or under my supervision, and that the same is true and correct to the best of my knowledge and belief.

Date Surveyed
January 11, 1977
Registered Professional Engineer and/or Land Surveyor
Fred B. Kerr
Certificate No.
3950