

NO. OF COPIES RECEIVED	6
DISTRIBUTION	
SANTA FE	1
FILE	1
U.S.G.S.	2
LAND OFFICE	
OPERATOR	2

NEW MEXICO OIL CONSERVATION COMMISSION

APPROVAL VALID
FOR 90 DAYS UNLESS
DRILLING COMMENCED,

EXPIRES 10-12-77

30-045-22648
Form C-101
Revised 1-1-65

5A. Indicate Type of Lease	
STATE <input type="checkbox"/>	FEE <input checked="" type="checkbox"/>
5. State Oil & Gas Lease No.	

APPLICATION FOR PERMIT TO DRILL, DEEPEN, OR PLUG BACK

1a. Type of Work		7. Unit Agreement Name	
b. Type of Well DRILL <input checked="" type="checkbox"/> DEEPEN <input type="checkbox"/> PLUG BACK <input type="checkbox"/>		8. Farm or Lease Name	
OIL WELL <input type="checkbox"/> GAS WELL <input checked="" type="checkbox"/> OTHER <input type="checkbox"/> SINGLE ZONE <input checked="" type="checkbox"/> MULTIPLE ZONE <input type="checkbox"/>		Lawson	
2. Name of Operator		9. Well No.	
Aztec Oil & Gas Company		# 3	
3. Address of Operator		10. Field and Pool, or Wildcat	
P. O. Drawer 570, Farmington, New Mexico		Blanco Pictured Cliffs	
4. Location of Well UNIT LETTER <u>M</u> LOCATED <u>1170</u> FEET FROM THE <u>South</u> LINE		12. County	
AND <u>930</u> FEET FROM THE <u>West</u> LINE OF SEC. <u>12</u> TWP. <u>31N</u> RGE. <u>11W</u> NMPM		San Juan	
19. Proposed Depth		19A. Formation	
2736'		Pictured Cliffs Rotary	
21. Elevations (Show whether DF, RT, etc.)		20. Rotary or C.T.	
5822' GR		22. Approx. Date Work will start	
21A. Kind & Status Plug. Bond		July 25, 1977	
21B. Drilling Contractor			

23.

PROPOSED CASING AND CEMENT PROGRAM

SIZE OF HOLE	SIZE OF CASING	WEIGHT PER FOOT	SETTING DEPTH	SACKS OF CEMENT	EST. TOP
12-1/4"	8-5/8"	28#	160'	120 sxs	Circ to surface
6-3/4"	2-7/8"	6.5#	2736'	290 sxs	

Surface formation is Nacimiento.

Top of Ojo Alamo sand is at 893'.

Top of Pictured Cliffs sand is at 2556'.

A fresh water mud system will be used for drilling to total depth.
It is anticipated that IES and Gamma Ray Density logs will be run
at total depth.

No abnormal pressures or poisonous gases are anticipated in this well.
It is expected that this well be drilled before July 25, 1977. This
depends on time required for approvals, rig availability and the
weather.

Gas is dedicated.

IN ABOVE SPACE DESCRIBE PROPOSED PROGRAM: IF PROPOSAL IS TO DEEPEN OR PLUG BACK, GIVE DATA ON PRESENT PRODUCTIVE ZONE AND PROPOSED NEW PRODUCTIVE ZONE. GIVE BLOWOUT PREVENTER PROGRAM, IF ANY.

I hereby certify that the information above is true and complete to the best of my knowledge and belief.

Signed [Signature] Title District Production Mgr. Date July 13, 1977

(This space for State Use)

ORIGINAL SIGNED BY N. E. MAXWELL, JR.

PETROLEUM ENGINEER DIST. NO. 3

JUL 14 1977

APPROVED BY _____ TITLE _____ DATE _____

CONDITIONS OF APPROVAL, IF ANY:

**NEW MEXICO OIL CONSERVATION COMMISSION
WELL LOCATION AND ACREAGE DEDICATION PLAT**

Form C-102
Supersedes C-128
Effective 1-1-65

All distances must be from the outer boundaries of the Section.

Operator: Aztec Oil & Gas Company			Lease: Lawson		Well No.: 3
Unit Letter: M	Section: 12	Township: 31N	Range: 11W	County: San Juan	
Actual Footage Location of Well:					
1170 feet from the South line and		930 feet from the West line			
Ground Level Elev.: 5822	Producing Formation: Pictured Cliffs	Pool: Blanco	Dedicated Acreage: 160 Acres		

1. Outline the acreage dedicated to the subject well by colored pencil or hachure marks on the plat below.
2. If more than one lease is dedicated to the well, outline each and identify the ownership thereof (both as to working interest and royalty).
3. If more than one lease of different ownership is dedicated to the well, have the interests of all owners been consolidated by communitization, unitization, force-pooling, etc?

☐ Yes ☐ No If answer is "yes," type of consolidation _____

If answer is "no," list the owners and tract descriptions which have actually been consolidated. (Use reverse side of this form if necessary.) _____

No allowable will be assigned to the well until all interests have been consolidated (by communitization, unitization, forced-pooling, or otherwise) or until a non-standard unit, eliminating such interests, has been approved by the Commission.

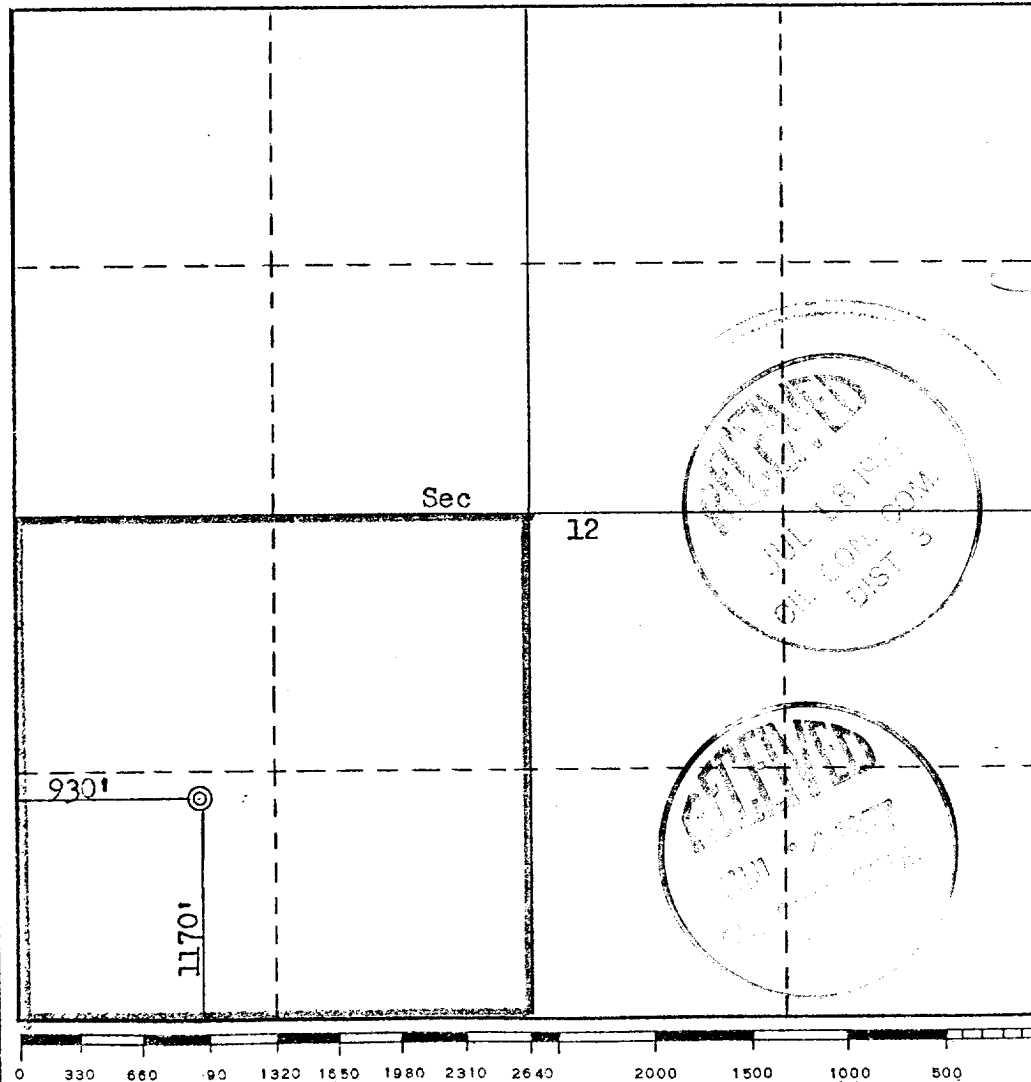

CERTIFICATION

I hereby certify that the information contained herein is true and complete to the best of my knowledge and belief.

Name: *[Signature]*
 Position: **District Production Mgr.**
 Company: **Aztec Oil & Gas Company**
 Date: **July 13, 1977**

I hereby certify that the well location shown on this plat was plotted from field notes of actual surveys made by me or under my supervision, and that the same is true and correct to the best of my knowledge and belief.

Date Surveyed: **June 24, 1977**
 Registered Professional Engineer and/or Land Surveyor:
[Signature]
Fred B. Kern Jr.
 Certificate No.: **3950**