

NO. OF COPIES RECEIVED	6
DISTRIBUTION	
SANTA FE	1
FILE	1
U.S.G.S.	2
LAND OFFICE	1
OPERATOR	1

NEW MEXICO OIL CONSERVATION COMMISSION
 APPROVAL VALID
 FOR 90 DAYS UNLESS
 DRILLING COMMENCED,
 EXPIRES 1-9-78

30-045-22765
 Form C-101
 Revised 1-1-65

5A. Indicate Type of Lease STATE <input checked="" type="checkbox"/> FEE <input type="checkbox"/>
5. State Oil & Gas Lease No. E-8443
7. Unit Agreement Name
8. Farm or Lease Name State Gas Com "M"
9. Well No. 1A
10. Field and Pool, or Wildcat Blanco Mesaverde
12. County San Juan
19. Proposed Depth 5121'
19A. Formation Mesaverde
20. Rotary or C.T. Rotary
21. Elevations (Show whether DF, RT, etc.) 6099' GL
21A. Kind & Status Plug. Bond Statewide
21B. Drilling Contractor Unknown
22. Approx. Date Work will start November 1977

APPLICATION FOR PERMIT TO DRILL, DEEPEN, OR PLUG BACK	
1a. Type of Work DRILL <input checked="" type="checkbox"/> DEEPEN <input type="checkbox"/> PLUG BACK <input type="checkbox"/>	
b. Type of Well OIL WELL <input type="checkbox"/> GAS WELL <input checked="" type="checkbox"/> OTHER <input type="checkbox"/>	SINGLE ZONE <input checked="" type="checkbox"/> MULTIPLE ZONE <input type="checkbox"/>
2. Name of Operator AMOCO PRODUCTION COMPANY	
3. Address of Operator 501 Airport Drive, Farmington, NM 87401	
4. Location of Well UNIT LETTER I LOCATED 1460' FEET FROM THE South LINE AND 1045 FEET FROM THE East LINE OF SEC. 16 TWP. 31N RGE. 12W NMPM	
23. PROPOSED CASING AND CEMENT PROGRAM	

SIZE OF HOLE	SIZE OF CASING	WEIGHT PER FOOT	SETTING DEPTH	SACKS OF CEMENT	EST. TOP
13-3/8"	9-5/8"	32.3#	350'	420 sx	Surf
8-3/4"	7"	20#	2950'	600 sx	Surf
6-1/4"	4-1/2"	10.5#	2750-5121'	320 sx	2750'

Amoco proposes to drill the above well to develop the Mesaverde reservoir. The well will be drilled to the intermediate casing point using water and Benex. The well will then be gas drilled to TD. Completion design will be based on open hole logs. Copy of all logs will be filed upon completion. Amoco's standard blowout prevention will be employed; see attached drawing for blowout preventer design.

Upon completion the well location will be cleaned and the reserve pit filled and leveled.

Gas produced from this well is dedicated to El Paso Natural Gas Company.

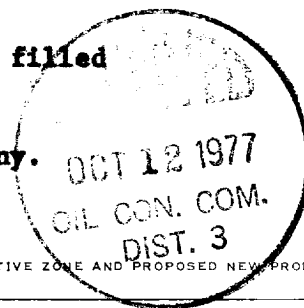

IN ABOVE SPACE DESCRIBE PROPOSED PROGRAM: IF PROPOSAL IS TO DEEPEN OR PLUG BACK, GIVE DATA ON PRESENT PRODUCTIVE ZONE AND PROPOSED NEW PRODUCTIVE ZONE. GIVE BLOWOUT PREVENTER PROGRAM, IF ANY.

I hereby certify that the information above is true and complete to the best of my knowledge and belief.

Signed L. R. Roughton Title Area Engineer Date 10/1/77

(This space for State Use)

APPROVED BY AR Hendrick TITLE SUPERVISOR DIST. 3 DATE OCT 12 1977

CONDITIONS OF APPROVAL, IF ANY:

NEW MEXICO OIL CONSERVATION COMMISSION
WELL LOCATION AND ACREAGE DEDICATION PLAT

Form C-102
Supersedes C-128
Effective 1-1-65

All distances must be from the outer boundaries of the Section.

Operator Amoco Production Company			Lease State Gas Com "M"		Well No. 1A
Unit Letter I	Section 16	Township 31N	Range 12W	County San Juan	
Actual Footage Location of Well: 1160 feet from the South line and 1045 feet from the East line					
Ground Level Elev. 6099	Producing Formation Mesa Verde		Pool Blanco Mesaverde		Dedicated Acreage: 320 Acres

1. Outline the acreage dedicated to the subject well by colored pencil or hachure marks on the plat below.
2. If more than one lease is dedicated to the well, outline each and identify the ownership thereof (both as to working interest and royalty).
3. If more than one lease of different ownership is dedicated to the well, have the interests of all owners been consolidated by communitization, unitization, force-pooling, etc?

☐ Yes ☐ No If answer is "yes," type of consolidation _____

If answer is "no," list the owners and tract descriptions which have actually been consolidated. (Use reverse side of this form if necessary.) _____

No allowable will be assigned to the well until all interests have been consolidated (by communitization, unitization, forced-pooling, or otherwise) or until a non-standard unit, eliminating such interests, has been approved by the Commission.

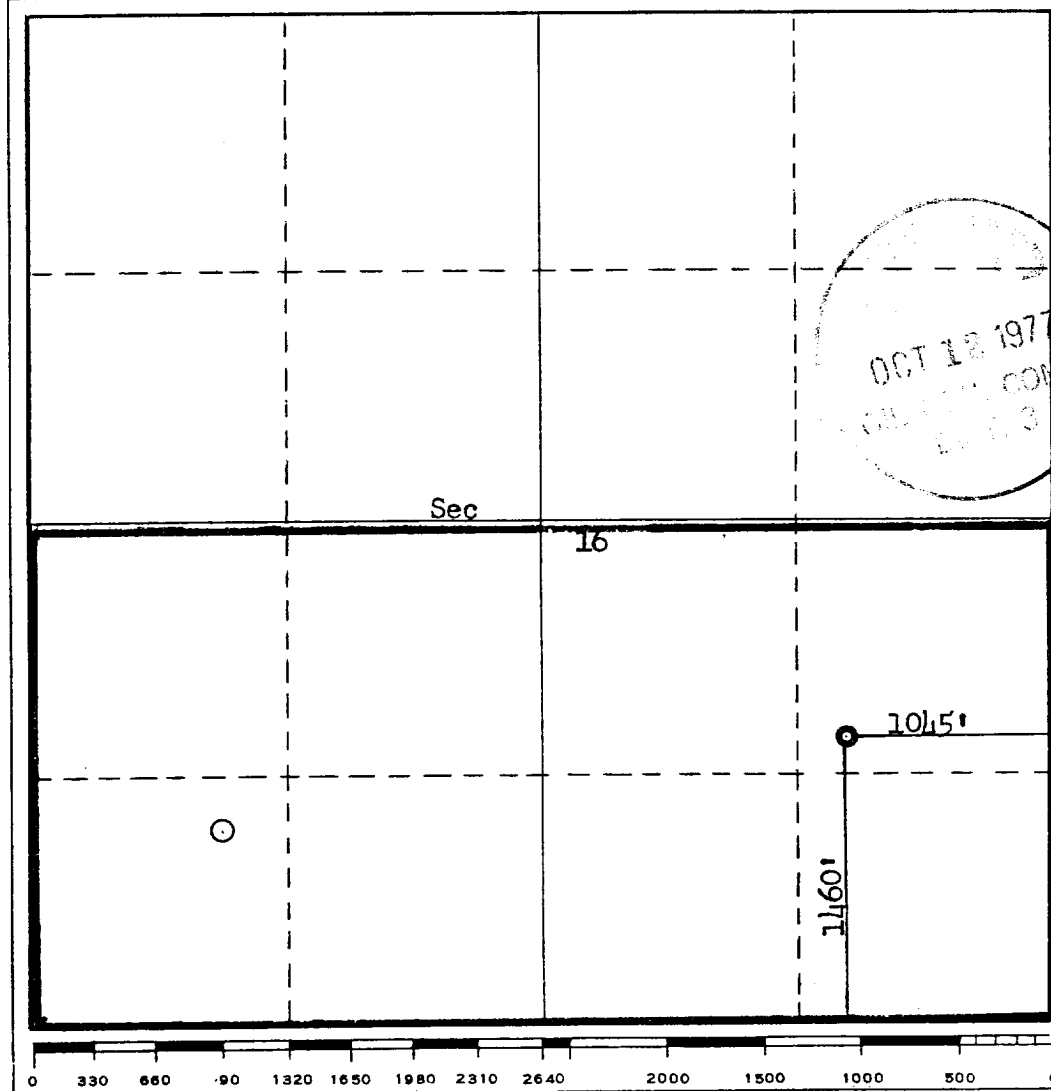

CERTIFICATION

I hereby certify that the information contained herein is true and complete to the best of my knowledge and belief.

Name
J. L. KRUPKA
Position
AREA ENGINEER
Company
AMOCO PRODUCTION COMPANY
Date
SEPTEMBER 21, 1977

I hereby certify that the well location shown on this plat was plotted from field notes of actual surveys made by me or under my supervision, and that the same is true and correct to the best of my knowledge and belief.

Date Surveyed
September 16, 1977
Registered Professional Engineer and/or Land Surveyor
Fred B. Kerr, Jr.
Certificate No.
3950

THIS PORTION, OR ANY PART THEREOF, MAY BE PLACED OUTSIDE OF SUB-STRUCTURE IF DESIRED. USE LONG RADIUS BENDS. PIPE USED FOR EXTENSION SHOULD BE SHOP MADE WITH NO SCREWED CONNECTIONS AND PRESSURE TESTED INITIALLY TO SAME TEST PRESSURE AS THE CHOKE MANIFOLD.

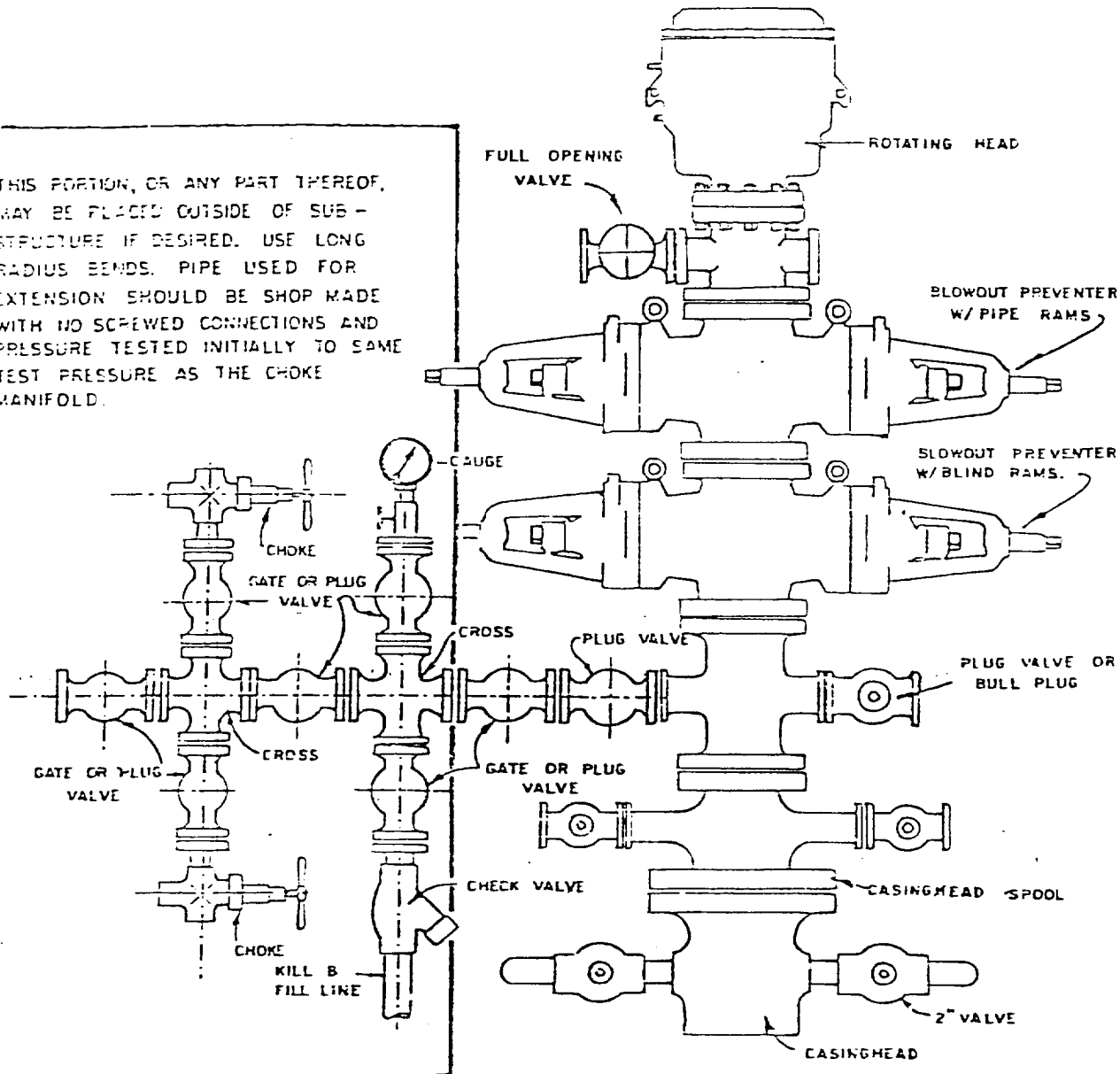

BLOWOUT PREVENTER HOOKUP