

District I
P.O. Box 1980, Hobbes, NM

District II
P.O. Drawer DD, Artes, NM 88211

District III
1000 Rio Brazos Rd, Aztec, NM 87410

State of New Mexico
Energy, Minerals and Natural Resource Department

RECEIVED
OIL CONSERVATION DIVISION
Santa Fe, New Mexico 87504-2088
OCT - 7 1999

10/10W-OK
Sep - OK

SUBMIT 1 COPY TO
APPROPRIATE
DISTRICT OFFICE
AND 1 COPY TO
SANTA FE OFFICE
(Revised 3/9/94)

OIL CON. DIV.
PIT REMEDIATION AND CLOSURE REPORT

Operator: AMOCO PRODUCTION COMPANY Telephone: (505) 326-9216

Address: 200 AMOCO COURT, FARMINGTON, NM 87401

Facility Or: STATE GAS COM M-1A

Well Name

Location: Unit or Qtr/Qtr Sec NE/SE I Sec 16 T 31 R 12 County SAN JUAN

Pit Type: Separator _____ Dehydrator _____ Other BLOW DOWN

Land Type: BLM _____ State XX Fee _____ Other _____

Pit Location: Pit dimensions: Length 52 width 51 depth 9
(Attach diagram)

Reference: wellhead XX Other _____

Footage from reference: 116'

Direction from reference: 24 Degrees NORTH East North _____

of

_____ West South _____

Depth To Ground Water:	Less than 50 feet	(20 points)	
(Vertical Distance from	50 feet to 99 feet	(10 points)	
contaminants to seasonal	Greater than 100 feet	(0 points)	<u>0</u>
high water elevation of			
ground water)			

Wellhead Protection Area:	Yes	(20 points)	
(less than 200 feet from a private	No	(0 points)	<u>0</u>
domestic water source, or, less than			
1000 feet from all other water sources)			

Distance To Surface Water:	Less than 200 feet	(20 points)	
(Horizontal distance to perennial	200 feet to 1000 feet	(10 points)	
lakes, ponds, rivers, streams, creeks,	Greater than 1000 feet	(0 points)	<u>0</u>
irrigation canals and ditches)			

RANKING SCORE (TOTAL POINTS): 0

Date Remediation Started: 06/10/94 Date Completed: 06/11/94
Remediation Method: Excavation XX Approx. cubic yards 133

Landfarmed _____ Insitu Bioremediation _____

Other _____

Remediation Location: Onsite XX Offsite _____
(ie. landfarmed onsite,
name and location of
offsite facility)

General Description of Remediation Action: _____

CONTAMINATION WAS REMEDIATED BY DILUTION AND AERATION.

Ground Water Encountered: No X Yes _____ Depth _____

Final Pit:
Closure Sampling:
(if multiple samples,
attach sample results
and diagram of sample
locations and depths)

Sample location See Attached

Sample depth 9

Sample date 06/10/94 Sample time 02:30:00

Sample Results

Benzene (ppm) _____

Total BTEX (ppm) _____

Field headspace (ppm) 0.0 @ 9' 11/4/97 nv

TPH 68

Ground Water Sample: Yes _____ No XX (If yes, attach sample results)

I HEREBY CERTIFY THAT INFORMATION ABOVE IS TRUE AND COMPLETE

TO THE BEST OF MY KNOWLEDGE AND BELIEF

DATE 07/27/94 5/25/98 nv

SIGNATURE

PRINTED NAME BUDDY SHAW E.C.
AND TITLE

FINAL PIT CLOSURE SAMPLING REPORT

Operator: AMOCO PRODUCTION COMPANY

Telephone: (505) 326-9216

Address: 200 AMOCO COURT, FARMINGTON, NM 87401

Facility Or: STATE GAS COM M-1A

Well Name

Location: Unit or Qtr Qtr Sec NE/SE Sec 16 T 31 R 12 County SAN JUAN

SIDE VIEW

Depth	TPH
Surface	320 ppm
2 ft.	ppm
4 ft.	5720 ppm
6 ft.	ppm
8 ft.	ppm
10 ft.	ppm
12 ft.	ppm
14 ft.	ppm
16 ft.	ppm
18 ft.	ppm
20 ft.	ppm
9' ft.	68 ppm
ft.	ppm
ft.	ppm

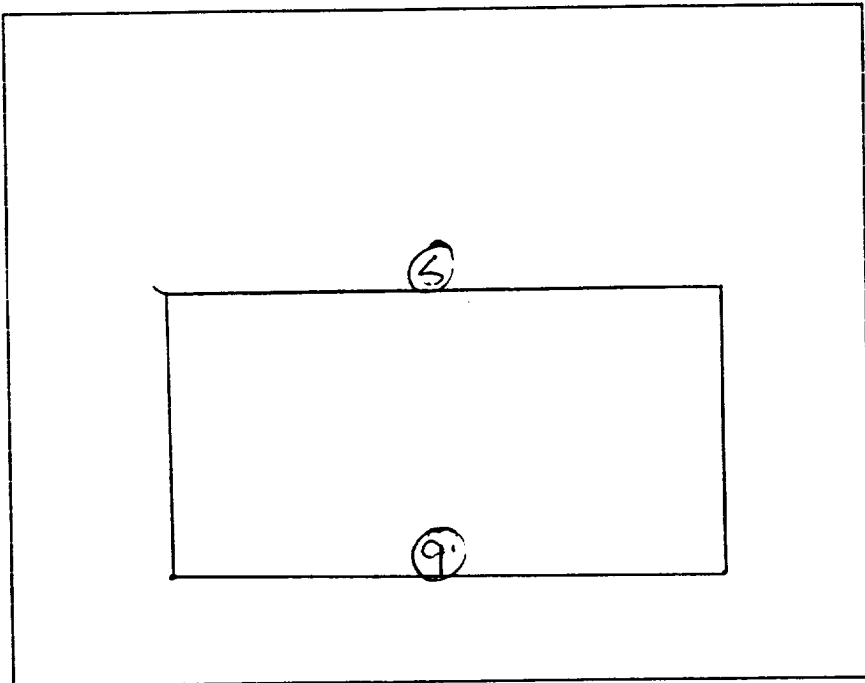

TOP VIEW

North Side	203 ppm
East Side	451 ppm
South Side	83 ppm
West Side	642 ppm

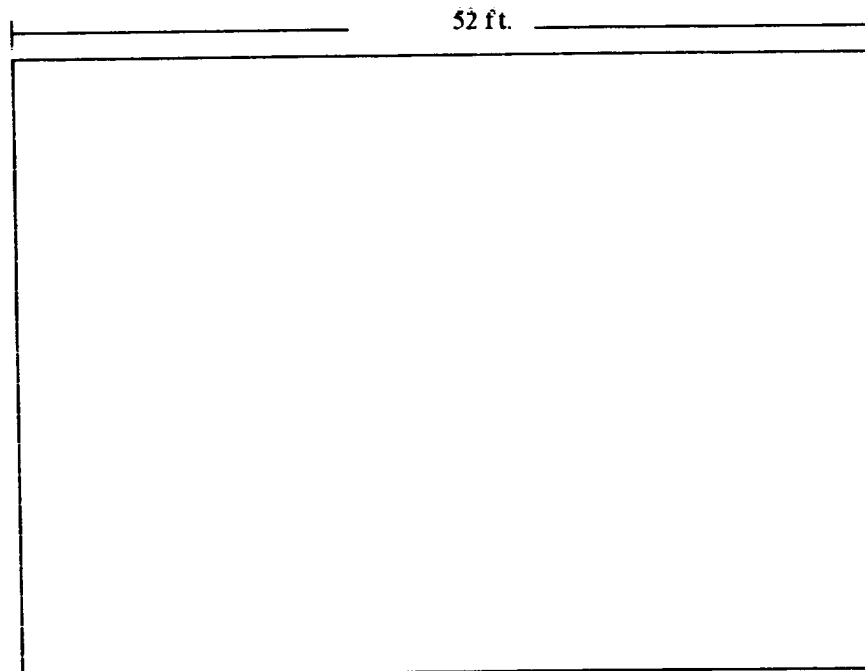

PIT LOCATION DIAGRAM

Operator: AMOCO PRODUCTION CO.

Telephone: (505) 326-9219

Address: 200 AMOCO COURT, FARMINGTON, NM 87401

Facility Or: STATE GC M-1A

Well Name

Location: Unit or Qtr/Qtr Sec

I

Sec

16

T

31

R

12

County

SAN JUAN

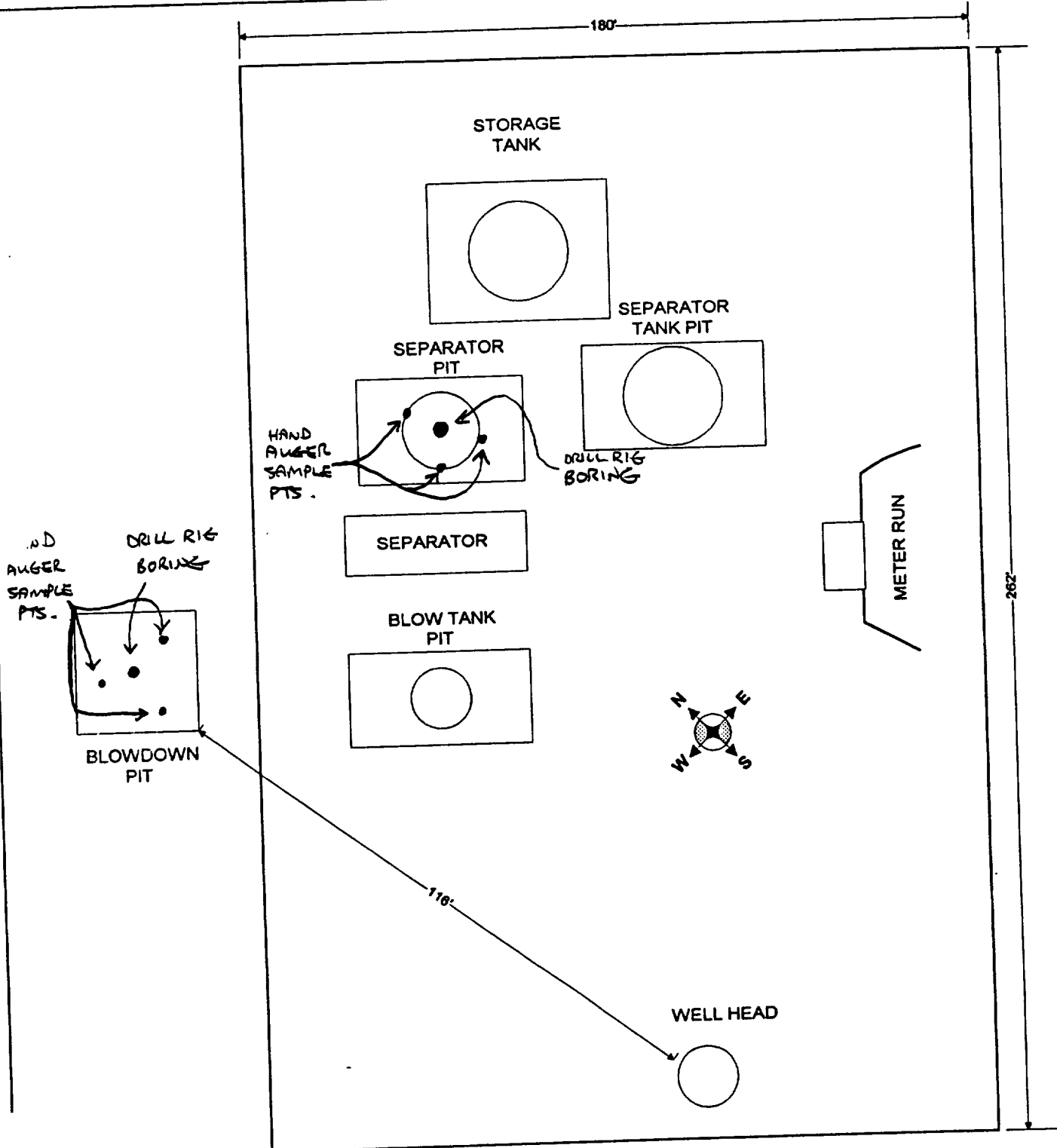

CLIENT: AMOCOBLAGG ENGINEERING, INC.
P.O. BOX 87, BLOOMFIELD, NM 87413
(505) 632-1199LOCATION NO: WEEC.D.C. NO: 5425

FIELD REPORT: LANDFARM/COMPOST PILE CLOSURE VERIFICATION

LOCATION: NAME: STATE GC M WELL #: 1A PITS: BLOW
QUAD/UNIT: I SEC: 16 TWP: 31N RNG: 12W PM: NM CNTY: ST ST: NM
QTR/FOOTAGE: NELH 5E14 CONTRACTOR: WHOLE EARTHDATE STARTED: 11/4/97

DATE FINISHED: _____

ENVIRONMENTAL
SPECIALIST: NU/JCB

SOIL REMEDIATION:

REMEDICATION SYSTEM: DILUTION + AERATIONAPPROX. CUBIC YARDAGE: 133LAND USE: RANGELIFT DEPTH (ft): NA

FIELD NOTES & REMARKS:

DEPTH TO GROUNDWATER: 2100' NEAREST WATER SOURCE: 21000' NEAREST SURFACE WATER: >1000'NMOCB RANKING SCORE: 0 NMOCB TPH CLOSURE STD: 5000 PPM

BORING CONDUCTED @ PIT CENTER ACCORDING TO PIT CLOSURE RECORD, REACHED 10' DEPTH FROM GRADE, NO DISCOLORATION OR HE ODOR OBSERVED THROUGHOUT BORING, COLLECTED 2 SAMPLE PTS. FROM BORING @ 5' & 9' BELOW GRADE, COLLECTED 3 SAMPLE PTS. USING HAND AUGER IN PIT AREA (DEPTHS RANGING FROM 1' TO 3' BELOW GRADE), COLLECTED 5 PT. COMPOSITE FOR LAB ANALYSIS OF DILUTED & AERATED SOIL PLACED BACK IN EXCAVATED PIT AREA.

FIELD 418.1 CALCULATIONS

SAMP. TIME	SAMPLE I.D.	LAB No:	WEIGHT (g)	mL. FREON	DILUTION	READING	CALC. ppm

SKETCH/SAMPLE LOCATIONS

SEE SITE MAP

OVM RESULTS

LAB SAMPLES

SAMPLE ID	FIELD HEADSPACE PID (ppm)	SAMPLE ID	ANALYSIS	TIME	RESULTS
DA-1	0.0	DA-1	TPH (BOLIS)	1/3/5	ND
Se 9'	0.0				

SCALE



0

FT

TRAVEL NOTES:

CALLOUT: NAONSITE: 11/4/97

ENVIROTECH LABS

PRACTICAL SOLUTIONS FOR A BETTER TOMORROW

EPA METHOD 8015 Modified Nonhalogenated Volatile Organics Total Petroleum Hydrocarbons

Client:	Blagg / AMOCO	Project #:	04034-10
Sample ID:	DA - 1	Date Reported:	11-06-97
Laboratory Number:	C410	Date Sampled:	11-04-97
Chain of Custody No:	5425	Date Received:	11-05-97
Sample Matrix:	Soil	Date Extracted:	11-05-97
Preservative:	Cool	Date Analyzed:	11-05-97
Condition:	Cool and Intact	Analysis Requested:	8015 TPH

Parameter	Concentration (mg/Kg)	Det. Limit (mg/Kg)
Gasoline Range (C5 - C10)	ND	0.2
Diesel Range (C10 - C28)	ND	0.1
Total Petroleum Hydrocarbons	ND	0.2

ND - Parameter not detected at the stated detection limit.

References: Method 8015, Nonhalogenated Volatile Organics, Test Methods for Evaluating Solid Waste, SW-846, USEPA, July 1992.

Comments: State GC M #1A Blow Pit 5 Pt. Composite.

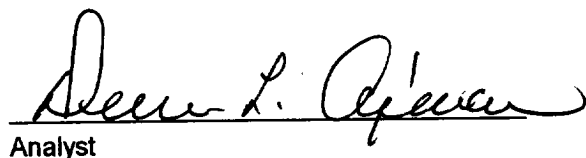
Analyst

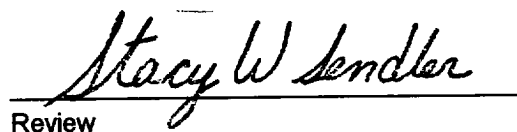
Review

District I
P.O. Box 1980, Hobbes, NM

District II
P.O. Drawer DD, Artes, NM 88211

District III
1000 Rio Brazos Rd, Aztec, NM 87410

State of New Mexico
Energy, Minerals and Natural Resource Department

OIL CONSERVATION DIVISION
P.O. Box 2088
Santa Fe, New Mexico 87504-2088

SUBMIT 1 COPY TO
APPROPRIATE
DISTRICT OFFICE
AND 1 COPY TO
SANTA FE OFFICE
(Revised 3/9/94)

PIT REMEDIATION AND CLOSURE REPORT

Operator: AMOCO PRODUCTION COMPANY Telephone: (505) 326-9216
Address: 200 AMOCO COURT, FARMINGTON, NM 87401
Facility Or: STATE GAS COM M-1A
Well Name _____
Location: Unit or Qtr/Qtr Sec NE/SE Sec 16 T 31 R 12 County SAN JUAN
Pit Type: Separator XX Dehydrator _____ Other _____
Land Type: BLM _____ State XX Fee _____ Other _____

Pit Location: Pit dimensions: Length 23 width 18 depth 8
(Attach diagram)
Reference: wellhead XX Other _____
Footage from reference: 115'
Direction from reference: 20 Degrees ~~NORTH~~ East North _____
of
_____ West South _____

Depth To Ground Water:	Less than 50 feet	(20 points)	
(Vertical Distance from	50 feet to 99 feet	(10 points)	
contaminants to seasonal	Greater than 100 feet	(0 points)	<u>0</u>
high water elevation of			
ground water)			

Wellhead Protection Area:	Yes	(20 points)	
(less than 200 feet from a private	No	(0 points)	<u>0</u>
domestic water source, or, less than			
1000 feet from all other water sources)			

Distance To Surface Water:	Less than 200 feet	(20 points)	
(Horizontal distance to perennial	200 feet to 1000 feet	(10 points)	
lakes, ponds, rivers, streams, creeks,	Greater than 1000 feet	(0 points)	<u>0</u>
irrigation canals and ditches)			

RANKING SCORE (TOTAL POINTS): 0

Date Remediation Started: 06/10/94 Date Completed: 06/11/94
Remediation Method: Excavation XX Approx. cubic yards 800

Landfarmed _____ Insitu Bioremediation _____

Other _____

Remediation Location: Onsite XX Offsite _____
(ie. landfarmed onsite,
name and location of
offsite facility)

General Description of Remediation Action: _____
CONTAMINATION WAS REMEDIATED BY DILUTION AND AERIATION.

Ground Water Encountered: No X Yes _____ Depth _____

Final Pit:
Closure Sampling:
(if multiple samples,
attach sample results
and diagram of sample
locations and depths)

Sample location See Attached

Sample depth 8

Sample date 06/10/94 Sample time 04:30:00

Sample Results

Benzene (ppm) _____

Total BTEX (ppm) _____

Field headspace (ppm) 0.0 @ 8' 11/4/97 915

TPH 76

Ground Water Sample: Yes _____ No XX (If yes, attach sample results)

I HEREBY CERTIFY THAT INFORMATION ABOVE IS TRUE AND COMPLETE
TO THE BEST OF MY KNOWLEDGE AND BELIEF

DATE 07/27/94 5/25/98 915

SIGNATURE

PRINTED NAME BUDDY SHAW E.C.
AND TITLE

FINAL PIT CLOSURE SAMPLING REPORT

Operator: AMOCO PRODUCTION COMPANY Telephone: (505) 326-9216
 Address: 200 AMOCO COURT, FARMINGTON, NM 87401
 Facility Or: STATE GAS COM M-1A
 Well Name _____
 Location: Unit or Qtr/Qtr Sec NE/SE Sec 16 T 31 R 12 County SAN JUAN

Depth	TPH
Surface	2730 ppm
2 ft.	ppm
4 ft.	3760 ppm
6 ft.	ppm
8 ft.	76 ppm
10 ft.	ppm
12 ft.	ppm
14 ft.	ppm
16 ft.	ppm
18 ft.	ppm
20 ft.	ppm
ft.	ppm
ft.	ppm
ft.	ppm

SIDE VIEW

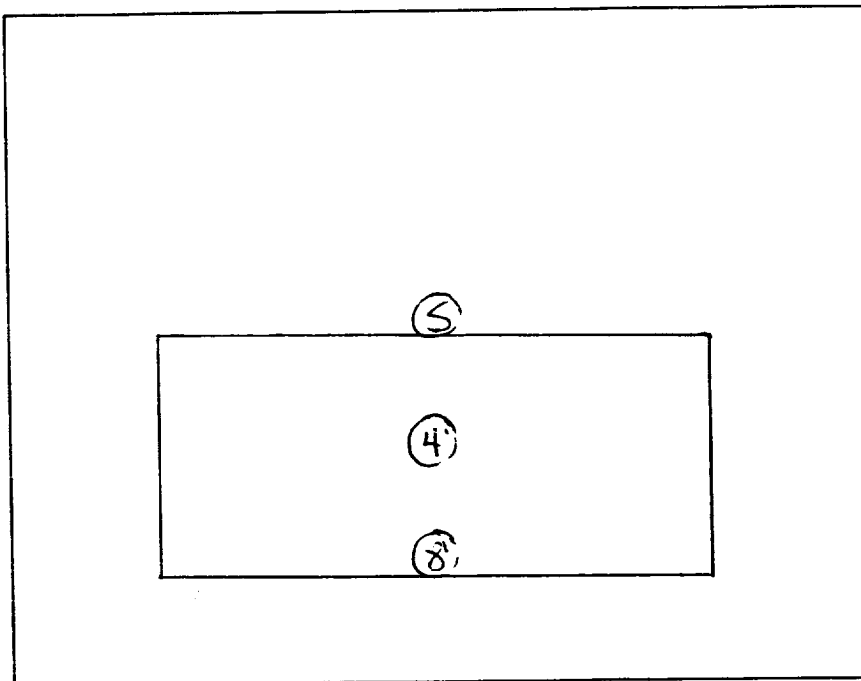

TOP VIEW

North Side	32 ppm
East Side	100 ppm
South Side	77 ppm
West Side	53 ppm

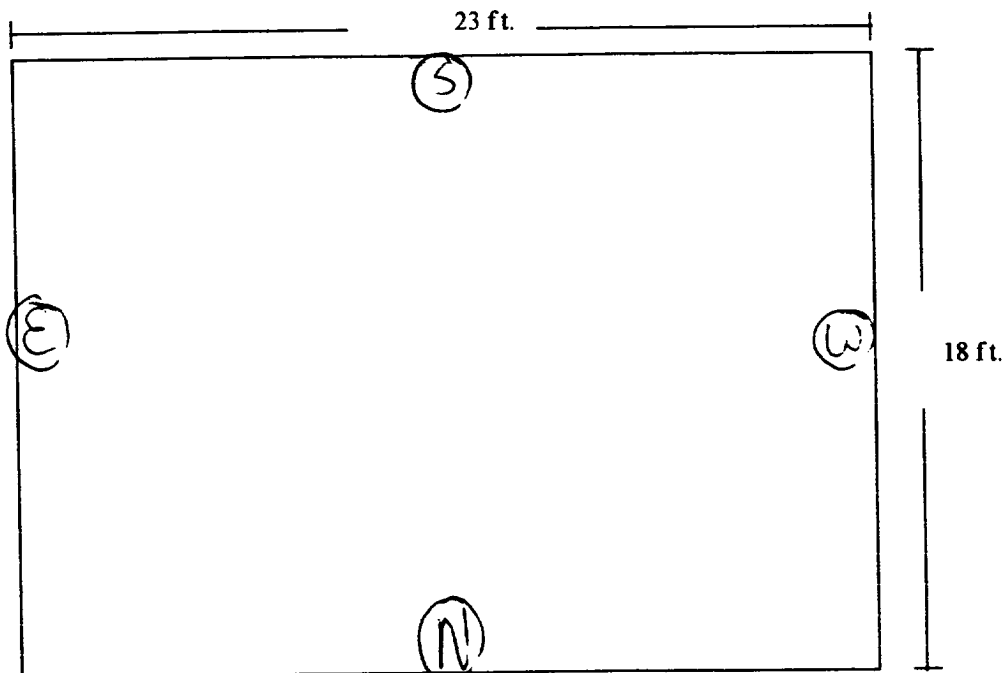

CLIENT: <u>AMOCO</u>	BLAGG ENGINEERING, INC. P.O. BOX 87, BLOOMFIELD, NM 87413 (505) 632-1199	LOCATION NO: <u>WEE</u> C.B.C. NO: <u>5425</u>
----------------------	--	---

FIELD REPORT: LANDFARM/COMPOST PILE CLOSURE VERIFICATION

LOCATION: NAME: <u>STATE</u> <u>GC</u> M WELL #: <u>1A</u> PITS: <u>SEP.</u>	DATE STARTED: <u>11/4/97</u>
QUAD/UNIT: <u>I</u> SEC: <u>16</u> TWP: <u>31N</u> RNG: <u>12W</u> PM: <u>NM</u> CNTY: <u>ST</u> ST: <u>NM</u>	DATE FINISHED: _____
QTP/FOOTAGE: <u>NE1/4</u> <u>SE1/4</u> CONTRACTOR: <u>WHOLE EARTH</u>	ENVIRONMENTAL SPECIALIST: <u>NU/JCB</u>

SOIL REMEDIATION:

REMEDICATION SYSTEM: DILUTION & AERATION

APPROX. CUBIC YARDAGE: 800

LAND USE: RANGE

LIFT DEPTH (ft): NA

FIELD NOTES & REMARKS:

DEPTH TO GROUNDWATER: >100' NEAREST WATER SOURCE: >1000' NEAREST SURFACE WATER: >1000'

NMDCD RANKING SCORE: 0 NMDCD TPH CLOSURE STD: 5000 PPM

BORING CONDUCTED @ PIT CENTER ACCORDING TO PIT CLOSURE RECORD, REACHED 10' DEPTH FROM GRADE, NO DISCOLORATION OR HC ODOR OBSERVED THROUGHOUT BORING, COLLECTED 2 SAMPLE PTS. FROM BORING @ 5' & 8' DEPTHS BELOW GRADE, COLLECTED 3 SAMPLE PTS. USING HAND AUGER IN PIT AREA (DEPTHS RANGING FROM 1'-3" BELOW GRADE), COLLECTED 5 PT. COMPOSITE FOR LAB ANALYSIS OF DILUTED & AERATED SOIL PLACED BACK IN EXCAVATED PIT AREA.

FIELD 418.1 CALCULATIONS

SAMP. TIME	SAMPLE I.D.	LAB No:	WEIGHT (g)	mL. FREON	DILUTION	READING	CALC. ppm

SKETCH/SAMPLE LOCATIONS

SEE SITE MAP

OVM RESULTS

LAB SAMPLES

SAMPLE ID	FIELD HEADSPACE PID (ppm)	SAMPLE ID	ANALYSIS	TIME	RESULTS
DA-1	0.0	DA-1	TPH (E015)	1330	ND
Se 8'	0.0				

SCALE



0 FT

TRAVEL NOTES:

CALLOUT: NA

ONSITE: 11/4/97

ENVIROTECH LABS

PRACTICAL SOLUTIONS FOR A BETTER TOMORROW

EPA METHOD 8015 Modified Nonhalogenated Volatile Organics Total Petroleum Hydrocarbons

Client:	Blagg / AMOCO	Project #:	04034-10
Sample ID:	DA - 1	Date Reported:	11-06-97
Laboratory Number:	C411	Date Sampled:	11-04-97
Chain of Custody No:	5425	Date Received:	11-05-97
Sample Matrix:	Soil	Date Extracted:	11-05-97
Preservative:	Cool	Date Analyzed:	11-05-97
Condition:	Cool and Intact	Analysis Requested:	8015 TPH

Parameter	Concentration (mg/Kg)	Det. Limit (mg/Kg)
Gasoline Range (C5 - C10)	ND	0.2
Diesel Range (C10 - C28)	ND	0.1
Total Petroleum Hydrocarbons	ND	0.2

ND - Parameter not detected at the stated detection limit.

References: Method 8015, Nonhalogenated Volatile Organics, Test Methods for Evaluating Solid Waste, SW-846, USEPA, July 1992.

Comments: State GC M #1A Separator Pit 5 Pt. Composite.

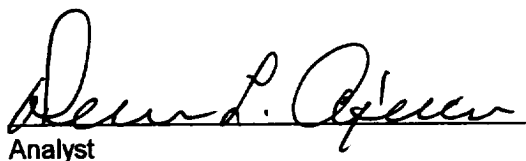
Analyst

Review

ENVIROTECH INC.
5796 U.S. Highway 64-3014
Farmington, New Mexico 87401
(505) 632-0615