

NO. COPIES RECEIVED	5
DISTRIBUTION	
SANTA FE	1
FILE	1
U.S.G.S.	2
LAND OFFICE	
OPERATOR	1

NEW MEXICO OIL CONSERVATION COMMISSION

30-095-22806
Form C-101
Revised 1-1-65

5A. Indicate Type of Lease	
STATE <input type="checkbox"/>	FEE <input checked="" type="checkbox"/>
5. State Oil & Gas Lease No.	

APPLICATION FOR PERMIT TO DRILL, DEEPEN, OR PLUG BACK

1a. Type of Work		7. Unit Agreement Name	
b. Type of Well DRILL <input checked="" type="checkbox"/> DEEPEN <input type="checkbox"/> PLUG BACK <input type="checkbox"/>		8. Farm or Lease Name	
c. Well Type OIL WELL <input type="checkbox"/> GAS WELL <input checked="" type="checkbox"/> OTHER <input type="checkbox"/>		9. Well No.	
2. Name of Operator		10. Field and Pool, or Wildcat	
AMOCO PRODUCTION COMPANY		1A	
3. Address of Operator		11. Field and Pool, or Wildcat	
501 AIRPORT DRIVE, FARMINGTON, NEW MEXICO 87401		Blanco Mesaverde	
4. Location of Well		12. County	
UNIT LETTER <u>I</u> LOCATED <u>1420</u> FEET FROM THE <u>South</u> LINE		San Juan	
AND <u>790</u> FEET FROM THE <u>East</u> LINE OF SEC. <u>5</u> TWP. <u>31N</u> RGE. <u>10W</u> NMPM			
19. Proposed Depth		19A. Formation	
5129'		Mesaverde	
20. Rotary or C.T.		Rotary	
21. Elevations (Show whether DE, RT, etc.)		22. Approx. Date Work will start	
5845' GL		December, 1977	
21A. Kind & Status Plug. Bond		21B. Drilling Contractor	
Statewide		Unknown	

PROPOSED CASING AND CEMENT PROGRAM

SIZE OF HOLE	SIZE OF CASING	WEIGHT PER FOOT	SETTING DEPTH	SACKS OF CEMENT	EST. TOP
13-3/8"	9-5/8"	32.3#	250'	300	Circ.
8-3/4"	7"	20#	3085'	520	Circ.
6-1/4"	4-1/2"	10.5#	5129'	230	Circ.

Amoco proposes to drill the above well to develop the Mesaverde reservoir. The well will be drilled to the intermediate casing point using water and Benex. The well will then be gas drilled to TD. Completion design will be based on open hole logs. Copy of all logs will be filed upon completion. Amoco's standard blowout prevention will be employed; see attached drawing for blowout preventer design.

Upon completion the well location will be cleaned and the reserve pit filled and leveled.

Gas produced from this well is dedicated to El Paso Natural Gas Company.

APPROVAL VALID
FOR 90 DAYS UNLESS
DRILLING COMMENCED,

EXPIRES 3-2-78

IN ABOVE SPACE DESCRIBE PROPOSED PROGRAM: IF PROPOSAL IS TO DEEPEN OR PLUG BACK, GIVE DATE ON PRESENT PRODUCTIVE ZONE AND PROPOSED NEW PRODUCTIVE ZONE. GIVE BLOWOUT PREVENTER PROGRAM, IF ANY.

I hereby certify that the information above is true and complete to the best of my knowledge and belief.

Signed [Signature] Title Area Engineer Date November 29, 1977

(This space for State Use)

APPROVED BY [Signature] TITLE SUPERVISING DISTRICT DATE DEC 2 1977

CONDITIONS OF APPROVAL, IF ANY:

NEW MEXICO OIL CONSERVATION COMMISSION
WELL LOCATION AND ACREAGE DEDICATION PLAT

Form C-102
Supersedes C-128
Effective 1-1-65

All distances must be from the outer boundaries of the Section.

Operator Amoco Production Company			Lease Marcotte Gas Com		Well No. 1A
Unit Letter I	Section 5	Township 31N	Range 10W	County San Juan	
Actual Footage Location of Well: 1420 feet from the South line and 790 feet from the East line					
Ground Level Elev. 5845	Producing Formation Mesa Verde		Pool Blanco Mesaverde	Dedicated Acreage: 320.13 Acres	

1. Outline the acreage dedicated to the subject well by colored pencil or hachure marks on the plat below.
2. If more than one lease is dedicated to the well, outline each and identify the ownership thereof (both as to working interest and royalty).
3. If more than one lease of different ownership is dedicated to the well, have the interests of all owners been consolidated by communitization, unitization, force-pooling, etc?

☐ Yes ☐ No If answer is "yes," type of consolidation _____

If answer is "no," list the owners and tract descriptions which have actually been consolidated. (Use reverse side of this form if necessary.) _____

No allowable will be assigned to the well until all interests have been consolidated (by communitization, unitization, forced-pooling, or otherwise) or until a non-standard unit, eliminating such interests, has been approved by the Commission.

CERTIFICATION

I hereby certify that the information contained herein is true and complete to the best of my knowledge and belief.

Name
J. L. KRUPKA
Position
AREA ENGINEER
Company
AMOCO PRODUCTION COMPANY
Date
NOVEMBER 8, 1977

I hereby certify that the well location shown on this plat was plotted from field notes of actual surveys made by me or under my supervision, and that the same is true and correct to the best of my knowledge and belief.

Date Surveyed
November 2, 1977
Registered Professional Engineer and Land Surveyor
Fred B. Kerr, Jr.
Certificate No.
3950

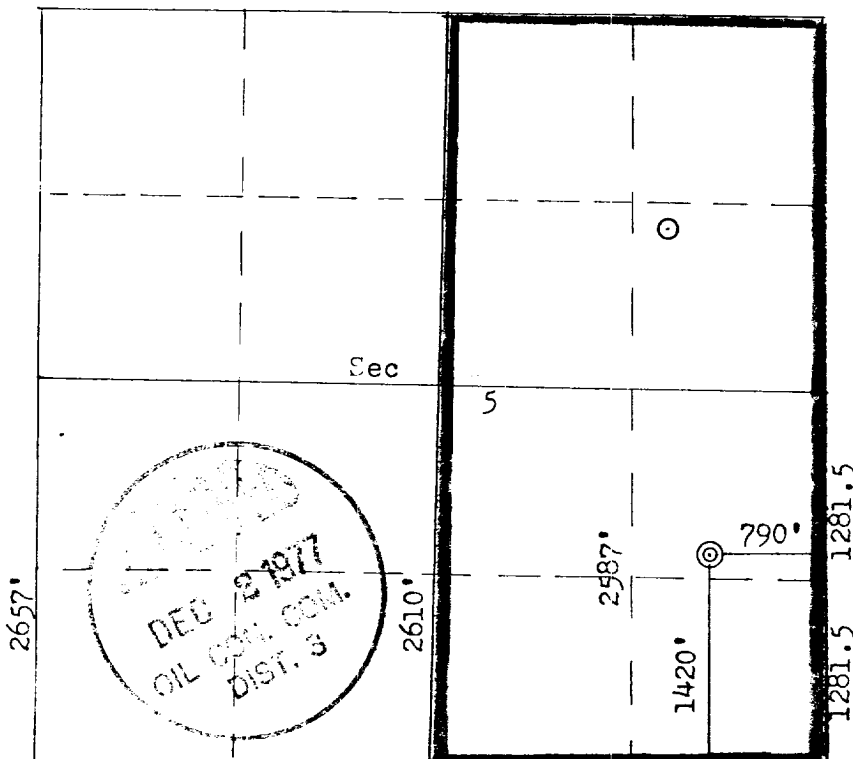

THIS PORTION, OR ANY PART THEREOF, MAY BE PLACED OUTSIDE OF SUB-STRUCTURE IF DESIRED. USE LONG RADIUS BENDS. PIPE USED FOR EXTENSION SHOULD BE SHOP MADE WITH NO SCREWED CONNECTIONS AND PRESSURE TESTED INITIALLY TO SAME TEST PRESSURE AS THE CHOKE MANIFOLD.

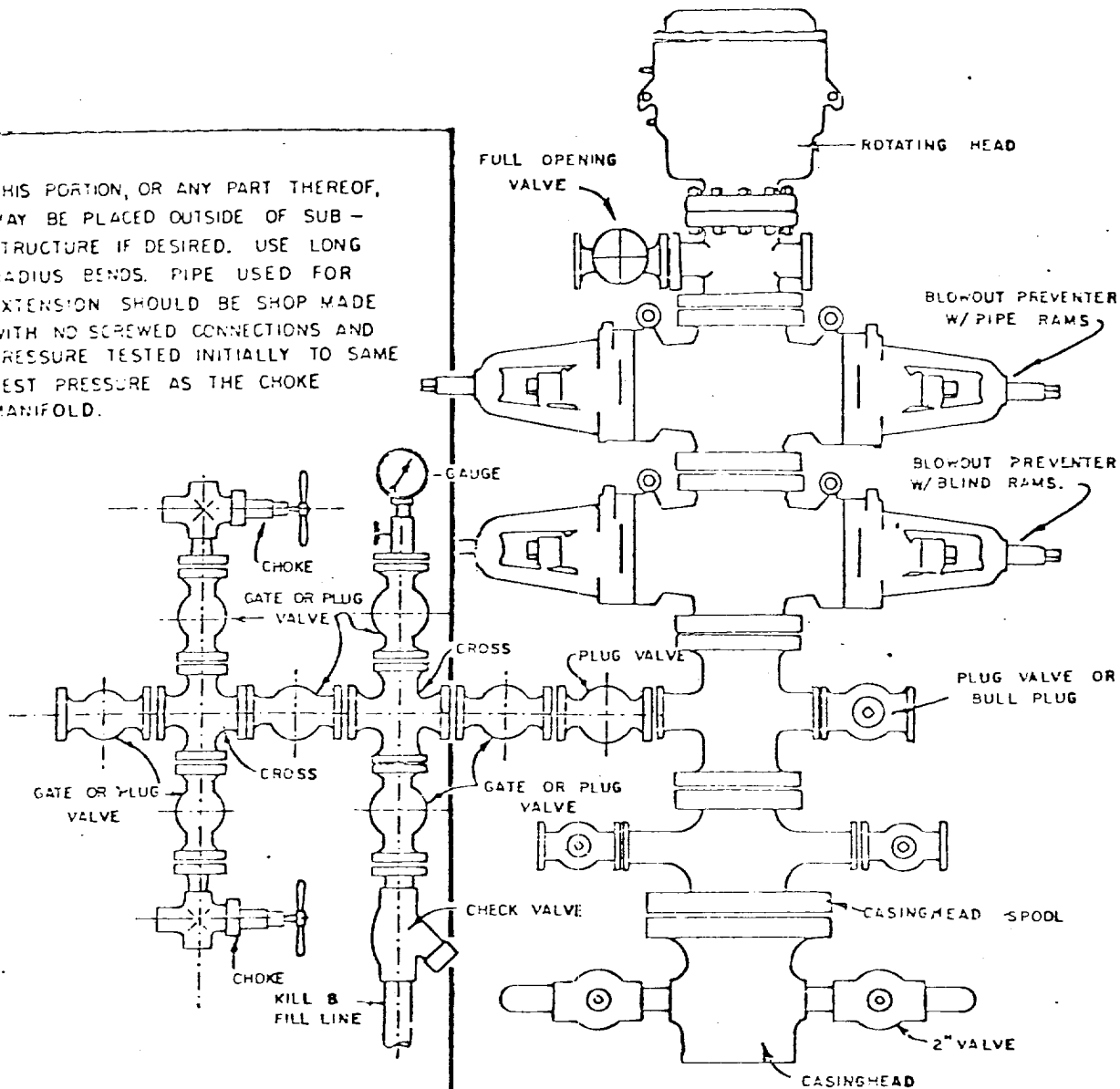

BLOWOUT PREVENTER HOOKUP