

UNITED STATES
DEPARTMENT OF THE INTERIOR
GEOLOGICAL SURVEY

APPLICATION FOR PERMIT TO DRILL, DEEPEN, OR PLUG BACK

1a. TYPE OF WORK

DRILL ☒DEEPEN ☐PLUG BACK ☐

b. TYPE OF WELL

OIL
WELL ☐GAS
WELL ☒

OTHER

SINGLE
ZONE ☐MULTIPLE
ZONE ☐

2. NAME OF OPERATOR

Robert C. Anderson

3. ADDRESS OF OPERATOR

The Summit Bldg. - Suite 415
5929 N. May Ave. Oklahoma City, Okla. 73112

4. LOCATION OF WELL (Report location clearly and in accordance with any State requirements.)*

At surface 790 feet east of the west line and 1850 feet
south of the North line of Sec. 13 - Twp. 31N - R16W.
At proposed prod. zone
Same

14. DISTANCE IN MILES AND DIRECTION FROM NEAREST TOWN OR POST OFFICE*

15. DISTANCE FROM PROPOSED*

LOCATION TO NEAREST
PROPERTY OR LEASE LINE, FT.
(Also to nearest drlg. unit line, if any)

790 feet

16. NO. OF ACRES IN LEASE

640

17. NO. OF ACRES ASSIGNED
TO THIS WELL

160 -

18. DISTANCE FROM PROPOSED LOCATION*

TO NEAREST WELL, DRILLING COMPLETED,
OR APPLIED FOR, ON THIS LEASE, FT.

2640

19. PROPOSED DEPTH

2400

20. ROTARY OR CABLE TOOLS

Rotary

21. ELEVATIONS (Show whether DF, RT, GR, etc.)

5750 GR

22. APPROX. DATE WORK WILL START*

December 12, 1977

23.

PROPOSED CASING AND CEMENTING PROGRAM

SIZE OF HOLE	SIZE OF CASING	WEIGHT PER FOOT	SETTING DEPTH	QUANTITY OF CEMENT
9 7/8"	7"	20.7	575	225sx (Cir. to surface).
6 1/4"	4 1/2"	10.55	(At proposed depth)	(Amount to protect oil or gas zones).

It is proposed to drill a Dakota sand well to an approximate depth of 2400 feet at the above captioned location in the following manner: 9 7/8" surface hole will be rotary mud-drilled to approx. depth of 575 feet and 7" surface casing set at this depth with cement circulated to surface. A 6 1/4" hole then to be rotary air-drilled to the proposed depth. Blow out preventer will be installed and in use during drilling operations under surface casing. (Type B.O.P. - 8" - 900 Series, hydraulic closing, double ram, 6000 psi test, 3000 psi working pressure Chaffer blowout preventer). All drilled formations are to be carefully tested as would any prudent operator.

The gas at this location is not dedicated as yet.

Approx. tops: Surface -- Point Lookout

500' -- Mancos shale

1725' -- Gallup sand zone

1845' -- XXXXXXXX Sanstee

2230' -- Greenhorn

2345' -- Dakota.

IN ABOVE SPACE DESCRIBE PROPOSED PROGRAM: If proposal is to deepen or plug back, give data on present productive zone and proposed new productive zone. If proposal is to drill or deepen directionally, give pertinent data on subsurface locations and measured and true vertical depths. Give blowout preventer program, if any.

24. Ashton B. Beren, Jr.

SIGNED

Ashton B. Beren, Jr.

Agent for:

TITLE Robert C. Anderson

DATE December 8, 1977

(This space for Federal or State office use)

PERMIT NO.

APPROVAL DATE

APPROVED BY

TITLE

DATE

CONDITIONS OF APPROVAL, IF ANY:

1977

Instructions

General: This form is designed for submitting proposals to perform certain well operations, as indicated, on all types of leased well leases for operations to be performed by a Federal or a State agency, or both, pursuant to applicable Federal and/or State laws and regulations. Any necessary special instructions regarding the use of this form and the number of copies to be submitted, particularly with regard to local, area, or regional procedures and practices, either are shown below or will be issued by, or may be obtained from, the local Federal and/or State office.

Item 1: If the proposal is to redrill to the same reservoir at a different subsurface location or to a new reservoir, use this form with appropriate notations. Consult applicable State or Federal regulations concerning subsequent work proposals or reports on the well. Consult local

Item 4: If there are no applicable State requirements, locations on Federal or Indian land should be described in accordance with Federal requirements. Consult local State or Federal office for specific instructions.

Item 14: Needed only when location of well cannot readily be found by road from the land or lease description. A plat, or plats, separate or on this reverse side, showing the roads to, and the surveyed location of, the well, and any other required information, should be furnished when required by Federal or State agency offices.

Items 15 and 18: If well is to be, or has been directionally drilled, give distances for subsurface location of hole in any present or objective production zone

Item 22: Consult applicable Federal or State regulations, or appropriate officials, concerning approval of the proposal before operations are started.

NEW MEXICO OIL CONSERVATION COMMISSION
WELL LOCATION AND ACREAGE DEDICATION PLAT

Form C-102
Supersedes C-128
Effective 1-1-65

All distances must be from the outer boundaries of the Section.

Operator R. C. Anderson			Lease Ute Tribe		Well No. 2
Unit Letter E	Section 13	Township 31N	Range 16W	County San Juan	
Actual Footage Location of Well: 1850 feet from the North line and 790 feet from the West line					
Ground Level Elev. 5750	Producing Formation La Bete		Pool Straight Canyon ext	Dedicated Acreage: 160 Acres	

- Outline the acreage dedicated to the subject well by colored pencil or hatchure marks on the plat below.
- If more than one lease is dedicated to the well, outline each and identify the ownership thereof (both as to working interest and royalty).
- If more than one lease of different ownership is dedicated to the well, have the interests of all owners been consolidated by communitization, unitization, force-pooling, etc?

☐ Yes ☐ No If answer is "yes," type of consolidation _____

If answer is "no," list the owners and tract descriptions which have actually been consolidated. (Use reverse side of this form if necessary.) _____

No allowable will be assigned to the well until all interests have been consolidated (by communitization, unitization, forced-pooling, or otherwise) or until a non-standard unit, eliminating such interests, has been approved by the Commission.

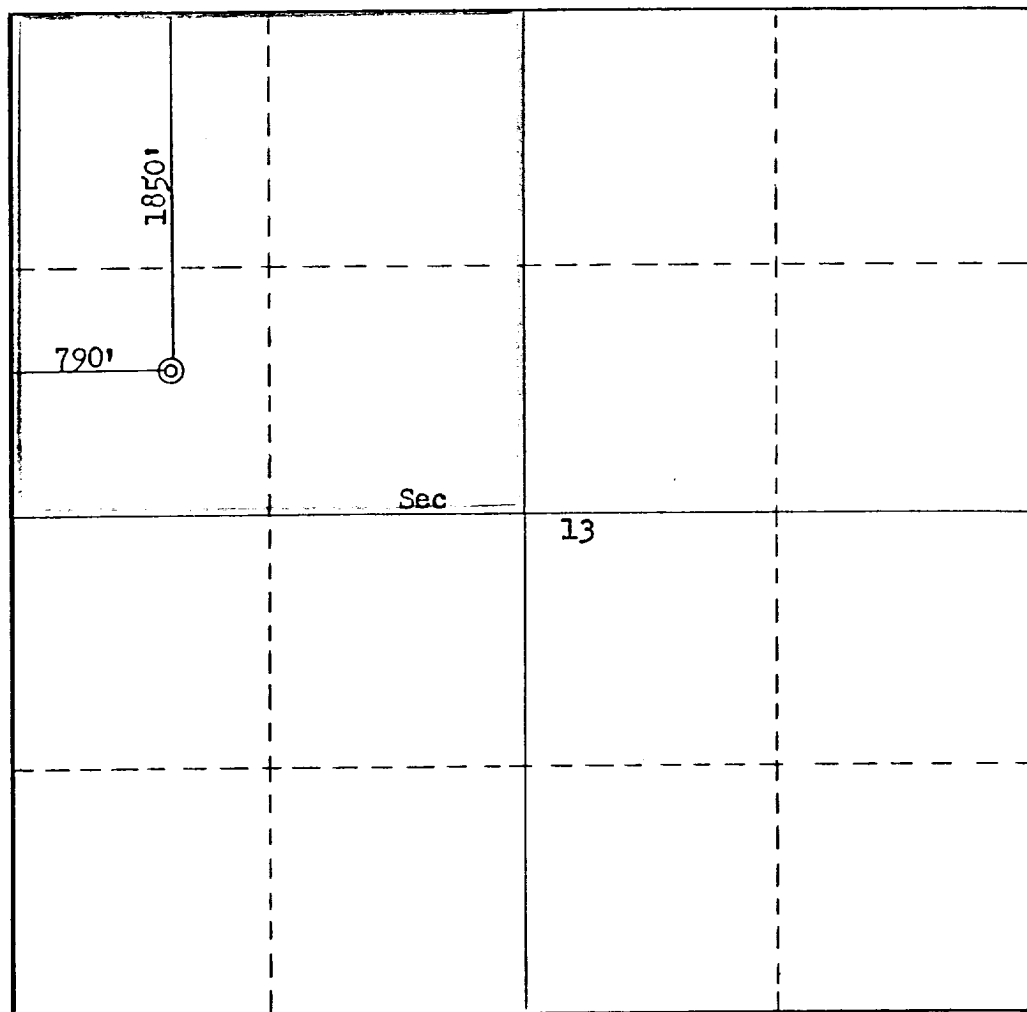

CERTIFICATION

I hereby certify that the information contained herein is true and complete to the best of my knowledge and belief.

Name **Ashton B. Green, Jr.**
Ashton B. Green, Jr.
Position **Agent for:**
Robert C. Anderson
Company
Robert C. Anderson
Date
December 8, 1977

I hereby certify that the well location shown on this plat was plotted from field notes of actual surveys made by me or under my supervision, and that the same is true and correct to the best of my knowledge and belief.

Date Surveyed
July 26, 1977
Registered Professional Engineer and/or Land Surveyor
Fred B. Kerr Jr.
Certificate No.
3950

