

UNITED STATES  
DEPARTMENT OF THE INTERIOR  
GEOLOGICAL SURVEY

## APPLICATION FOR PERMIT TO DRILL, DEEPEN, OR PLUG BACK

## 1a. TYPE OF WORK

DRILL ☒DEEPEN ☐PLUG BACK ☐

## b. TYPE OF WELL

OIL  
WELL ☐GAS  
WELL ☒

OTHER

SINGLE  
ZONE ☐MULTIPLE  
ZONE ☐

## 2. NAME OF OPERATOR

Robert C. Anderson

## 3. ADDRESS OF OPERATOR

The Summit Bldg. - Suite 415  
5929 N. May Ave. Oklahoma City, Okla. 73112

## 4. LOCATION OF WELL (Report location clearly and in accordance with any State requirements.)\*

At surface 790 feet North of the South line and 790 feet  
East of the West line of Section 13 - Township  
At proposed prod. zone 31 North - Range 16 West.  
State:

## 14. DISTANCE IN MILES AND DIRECTION FROM NEAREST TOWN OR POST OFFICE\*

## 15. DISTANCE FROM PROPOSED\*

LOCATION TO NEAREST  
PROPERTY OR LEASE LINE, FT.  
(Also to nearest drlg. unit line, if any)

790 feet.

## 16. NO. OF ACRES IN LEASE

640

17. NO. OF ACRES ASSIGNED  
TO THIS WELL

160

## 18. DISTANCE FROM PROPOSED LOCATION\*

TO NEAREST WELL, DRILLING, COMPLETED,  
OR APPLIED FOR, ON THIS LEASE, FT.

2640 feet.

## 19. PROPOSED DEPTH

2350

## 20. ROTARY OR CABLE TOOLS

Rotary

## 21. ELEVATIONS (Show whether DF, RT, GR, etc.)

5706 GR

## 22. APPROX. DATE WORK WILL START\*

December 20, 1977

## 23.

## PROPOSED CASING AND CEMENTING PROGRAM

SIZE OF HOLE	SIZE OF CASING	WEIGHT PER FOOT	SETTING DEPTH	QUANTITY OF CEMENT
9 7/8"	7"	20#	550	200 sx. (Cir. to surface).
6 1/4"	4 1/2"	10.5#	(At proposed depth)	(Amount to protect oil or gas zones).

It is proposed to drill a Dakota sand well to an approximate depth of 2350 feet at the above captioned location in the following manner:  
9 7/8" surface hole will be rotary mud-drilled to approx. depth of 550 feet and 7" surface casing set at this depth with cement circulated to surface. ~~xxxi~~ A 6 1/4" hole then to be rotary-air drilled to the proposed depth. Blow out preventer will be installed and in use during drilling operations under surface casing. (Type B.O.P. - 8" - 900 Series, hydraulic closing, double ram, 6000 psi test, 3000 psi working pressure Shaffer blow-out preventer). All drilled formations are to be carefully tested as would any prudent operator.

The gas at this location is not dedicated as yet.

Approx. formation tops: Surface -- Point Lookout (Mv)  
1835 -- Sanastee 450' -- Mancos shale  
2180 -- Greenhorn 1625' -- Gallup sand zone  
2295 -- Dakota.

IN ABOVE SPACE DESCRIBE PROPOSED PROGRAM: If proposal is to deepen or plug back, give data on present productive zone and proposed new productive zone. If proposal is to drill or deepen directionally, give pertinent data on subsurface locations and measured and true vertical depths. Give blowout preventer program, if any.

## 24.

SIGNED

Ashton B. Geren, Jr.

TITLE

Agent for:

Robert C. Anderson

DATE

December 8, 1977

(This space for Federal or State office use)

PERMIT NO.

APPROVAL DATE

APPROVED BY

TITLE

DATE

CONDITIONS OF APPROVAL, IF ANY:

## Instructions

**General:** This form is designed for submitting proposals to perform certain well operations as indicated on and type of lands and areas for which it is to be either a Federal or a State agency, or both, pursuant to applicable Federal and/or State laws and regulations. Any necessary statements should be submitted to the appropriate Federal and/or State agency and the number of copies to be submitted, particularly with regard to local area, or regional procedure and procedures, either are shown below or can be obtained from the local Federal and/or State office.

**Item 1:** If the proposal is to redrill to the same reservoir at a different subsurface location or to a new reservoir, use this form with appropriate notations. Consult applicable State or Federal regulations concerning subsequent work proposals or reports on the well.

**Item 4:** If there are no applicable State requirements, locations on Federal or Indian land should be described in accordance with Federal requirements. Consult local State or Federal office for specific instructions.

**Item 14:** Needed only when location of well cannot readily be found by road from the land or lease description. A plat, or plat, separate or on this reverse side, showing the roads to, and the surveyed location of, the well, and any other required information, should be furnished when required by Federal or State agency offices.

**Items 15 and 18:** If well is to be, or has been directionally drilled, give distances for subsurface location of hole in any present or objective production zone.

**Item 22:** Consult applicable Federal or State regulations, or appropriate officials, concerning approval of the proposal before operations are started.

NEW MEXICO OIL CONSERVATION COMMISSION  
WELL LOCATION AND ACREAGE DEDICATION PLAT

Form C-102  
Supersedes C-128  
Effective 1-1-65

All distances must be from the outer boundaries of the Section.

Operator <b>R. C. Anderson</b>			Lease <b>Ute Tribe</b>		Well No. <b>1</b>
Unit Letter <b>M</b>	Section <b>13</b>	Township <b>31N</b>	Range <b>16W</b>	County <b>San Juan</b>	
Actual Footage Location of Well: <b>790</b> feet from the <b>South</b> line and <b>790</b> feet from the <b>West</b> line					
Ground Level Elev. <b>5706</b>	Producing Formation <b>Alota</b>		Pool <b>Straight Canyon ext</b>	Dedicated Acreage <b>160</b> Acres	

1. Outline the acreage dedicated to the subject well by colored pencil or hatchure marks on the plat below.
2. If more than one lease is dedicated to the well, outline each and identify the ownership thereof (both as to working interest and royalty).
3. If more than one lease of different ownership is dedicated to the well, have the interests of all owners been consolidated by communitization, unitization, force-pooling, etc?

☐ Yes ☐ No If answer is "yes," type of consolidation \_\_\_\_\_

If answer is "no," list the owners and tract descriptions which have actually been consolidated. (Use reverse side of this form if necessary.) \_\_\_\_\_

No allowable will be assigned to the well until all interests have been consolidated (by communitization, unitization, forced-pooling, or otherwise) or until a non-standard unit, eliminating such interests, has been approved by the Commission.

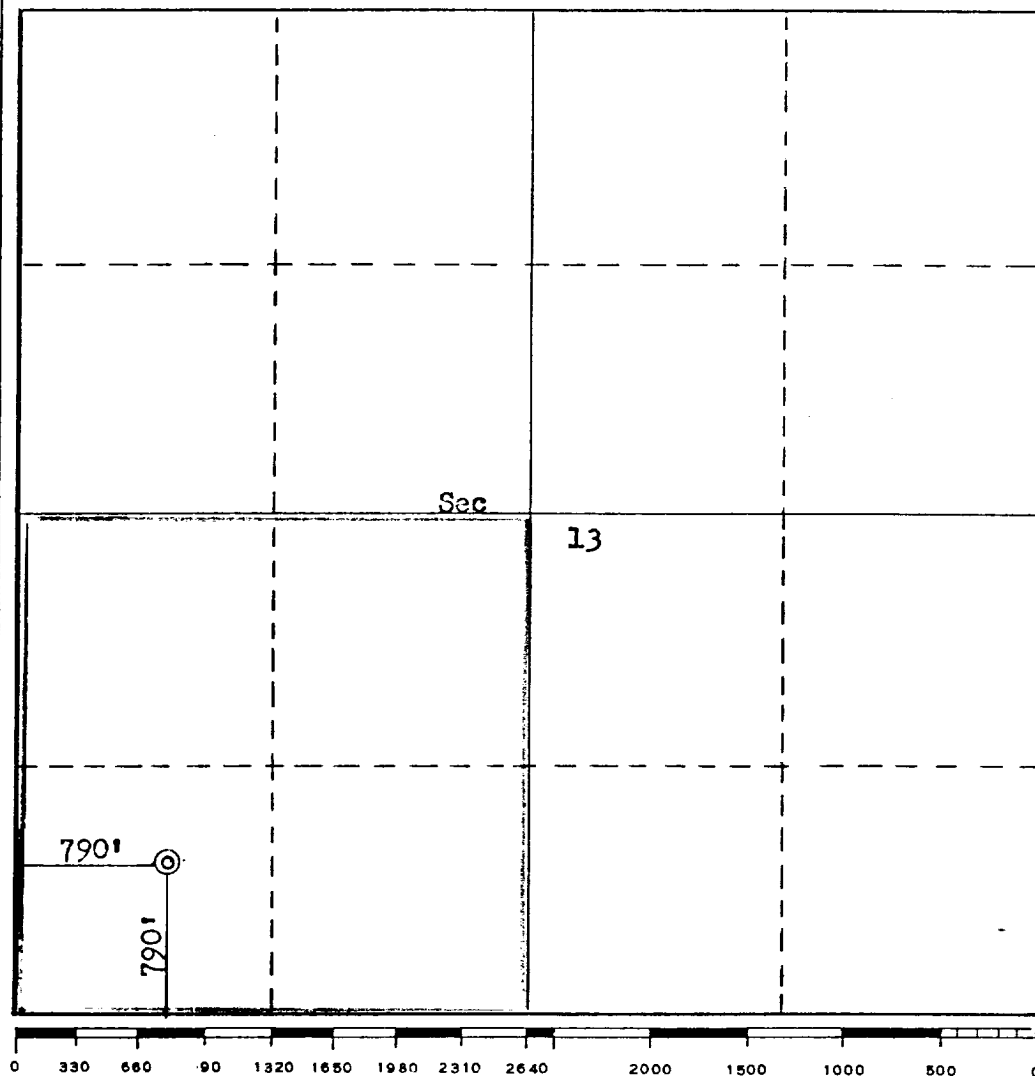

CERTIFICATION

I hereby certify that the information contained herein is true and complete to the best of my knowledge and belief.

Name **Ashton B. Geren, Jr.**  
 Position **Agent for:**  
**Robert C. Anderson**  
 Company  
**Robert C. Anderson**  
 Date  
**December 8, 1977**

I hereby certify that the well location shown on this plat was plotted from field notes of actual surveys made by me or under my supervision, and that the same is true and correct to the best of my knowledge and belief.

Date Surveyed  
**July 26, 1977**  
 Registered Professional Engineer and/or Land Surveyor  
**Fred B. Kerr Jr.**  
 Certificate No.  
**3950**