

OIL CONSERVATION COMMISSION
Albuquerque DISTRICT

OIL CONSERVATION COMMISSION
BOX 2088
SANTA FE, NEW MEXICO

DATE 12-19-77

RE: Proposed MC _____
Proposed DHC _____
Proposed NSL ✓ _____
Proposed SWD _____
Proposed WFX _____
Proposed PMX _____

Gentlemen:

I have examined the application dated 12-9-77
for the El Paso Natural Gas Co. - Fields #11 H-28-37N-11W
Operator Lease and Well No. Unit, S-T-R

and my recommendations are as follows:

Approve

Yours very truly,

AR. J. Frederick

El Paso NATURAL GAS
COMPANY

P. O. BOX 990
FARMINGTON, NEW MEXICO 87401
PHONE: 505-325-2841

December 9, 1977

Mr. Joe Ramey
New Mexico Oil Conservation Commission
Post Office Box 2088
Santa Fe, New Mexico 87501

Dear Mr. Ramey:

This is a request for administrative approval for an unorthodox gas well location in the Blanco Pictured Cliffs pool.

It is intended to locate the El Paso Natural Gas Company Fields #11 at 1440' from the North line and 1270' from the East line of Section 28, T-32-N, R-11-W, San Juan County, New Mexico.

The terrain is extremely rough and there is a high rock ledge to the West of the proposed location. The terrain makes it impossible to build an orthodox location (see attached plat).

All operators of proration units offsetting the proposed unorthodox location have been notified of this application by certified mail.

Plats showing the proposed well location and the terrain of Section 28 along with an ownership plat, are attached.

Yours truly,



D. R. Read
Division Drilling Engineer

DRR:pb



UNITED STATES
DEPARTMENT OF THE INTERIOR
GEOLOGICAL SURVEY

APPLICATION FOR PERMIT TO DRILL, DEEPEN, OR PLUG BACK

1a. TYPE OF WORK DRILL <input checked="" type="checkbox"/> DEEPEN <input type="checkbox"/> PLUG BACK <input type="checkbox"/>			5. LEASE DESIGNATION AND SERIAL NO. NM 010989	
b. TYPE OF WELL OIL WELL <input type="checkbox"/> GAS WELL <input checked="" type="checkbox"/> OTHER <input type="checkbox"/> SINGLE ZONE <input checked="" type="checkbox"/> MULTIPLE ZONE <input type="checkbox"/>			6. IF INDIAN, ALLOTTEE OR TRIBE NAME	
2. NAME OF OPERATOR El Paso Natural Gas Company			7. UNIT AGREEMENT NAME	
3. ADDRESS OF OPERATOR PO Box 990, Farmington, NM 87401			8. FARM OR LEASE NAME Fields	
4. LOCATION OF WELL (Report location clearly and in accordance with any State requirements.*) At surface 1440'N, 1270'E At proposed prod. zone			9. WELL NO. 11	
14. DISTANCE IN MILES AND DIRECTION FROM NEAREST TOWN OR POST OFFICE* 5 3/4 mi.es from Cedar Hill, NM			10. FIELD AND POOL, OR WILDCAT Blanco Pictured Cliffs	
15. DISTANCE FROM PROPOSED* LOCATION TO NEAREST PROPERTY OR LEASE LINE, FT. (Also to nearest drlg. unit line, if any) 1280'		16. NO. OF ACRES IN LEASE 2480	11. SEC., T., R., M., OR BLK. AND SURVEY OR AREA Sec. 28, T-32-N, R-11-W NMPM	
18. DISTANCE FROM PROPOSED LOCATION* TO NEAREST WELL, DRILLING, COMPLETED, OR APPLIED FOR, ON THIS LEASE, FT. 200		19. PROPOSED DEPTH 3265'	12. COUNTY OR PARISH San Juan	
21. ELEVATIONS (Show whether DF, RT, GR, etc.) 6323'GR		13. STATE NM		
22. APPROX. DATE WORK WILL START*			17. NO. OF ACRES ASSIGNED TO THIS WELL 160	
23. PROPOSED CASING AND CEMENTING PROGRAM			20. ROTARY OR CABLE TOOLS Rotary	

SIZE OF HOLE	SIZE OF CASING	WEIGHT PER FOOT	SETTING DEPTH	QUANTITY OF CEMENT
12 1/4"	8 5/8"	24.0#	120'	106 cu.ft. to circulate
6 3/4"	2 7/8"	6.4#	3265'	448 cu.ft. to cover Ojo Alamo

Selectively perforate and sandwater fracture the Pictured Cliffs formation.

A 3000 psi WP and 6000 psi test double gate preventer equipped with blind and pipe rams will be used for blow out prevention on this well.

This gas is dedicated.

The NE/4 of Section 28 is dedicated to this well.

IN ABOVE SPACE DESCRIBE PROPOSED PROGRAM: If proposal is to deepen or plug back, give data on present productive zone and proposed new productive zone. If proposal is to drill or deepen directionally, give pertinent data on subsurface locations and measured and true vertical depths. Give blowout preventer program, if any.

24. SIGNED A. G. Busies TITLE Drilling Clerk DATE December 8, 1977
(This space for Federal or State office use)

PERMIT NO. _____ APPROVAL DATE _____

APPROVED BY _____ TITLE _____ DATE _____
CONDITIONS OF APPROVAL, IF ANY:

**NEW MEXICO OIL CONSERVATION COMMISSION
WELL LOCATION AND ACERAGE DEDICATION PLAT**

All distances must be from the outer boundaries of the Section

Operator EL PASO NATURAL GAS COMPANY			Lease FIELDS (NM-010989)		Well No. 11
Unit Letter H	Section 28	Township 32 NORTH	Range 11 WEST	County SAN JUAN	
Actual Footage Location of Well: 1440 feet from the NORTH line and 1270 feet from the EAST line					
Ground Level Elev. 6323	Producing Formation PICTURED CLIFFS		Pool BLANCO PICTURED CLIFFS		Dedicated Acreage: 160.00 Acres

1. Outline the acreage dedicated to the subject well by colored pencil or hachure marks on the plat below.
2. If more than one lease is dedicated to the well, outline each and identify the ownership thereof (both as to working interest and royalty),
3. If more than one lease of different ownership is dedicated to the well, have the interests of all owners been consolidated by communization, unitization, force-pooling, etc?
☐ Yes ☐ No If answer is "yes," type of consolidation _____

If answer is "no," list the owners and tract descriptions which have actually consolidated. (Use reverse side of this form if necessary.) _____

No allowable will be assigned to the well until all interests have been consolidated (by communization, unitization, forced-pooling, or otherwise) or until a non standard unit, eliminating such interests, has been approved by the Commission.

CERTIFICATION

I hereby certify that the information contained herein is true and complete to the best of my knowledge and belief.

A. G. Buias
 Name
Drilling Clerk
 Position
El Paso Natural Gas Co.
 Company
December 8, 1977
 Date

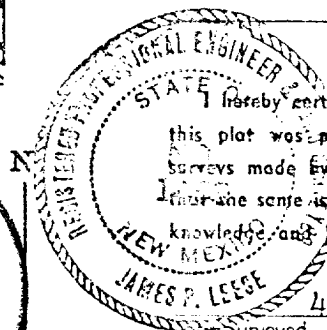
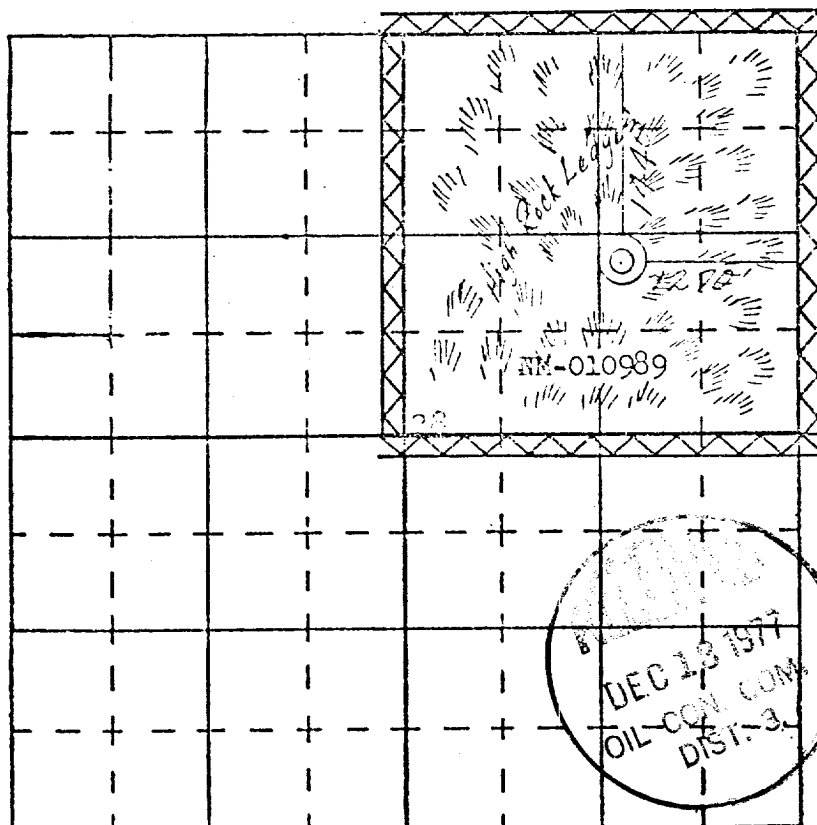

I hereby certify that the well location shown on this plat was plotted from field notes of actual surveys made by me or under my supervision, and that the same is true and correct to the best of my knowledge and belief.

4 November 1977
 Date Surveyed
James P. Leese
 Registered Professional Engineer
 and/or Land Surveyor **James P. Leese**

SCALE—4 INCHES EQUALS 1 MILE

Well Name Fields #11, Pictured Cliffs

Footage---- 1440' FNL, 1270' FEL

APPLICATION FOR NON-STANDARD LOCATION

County San Juan

State New Mexico

Section 28

Township 32N

Range 11W

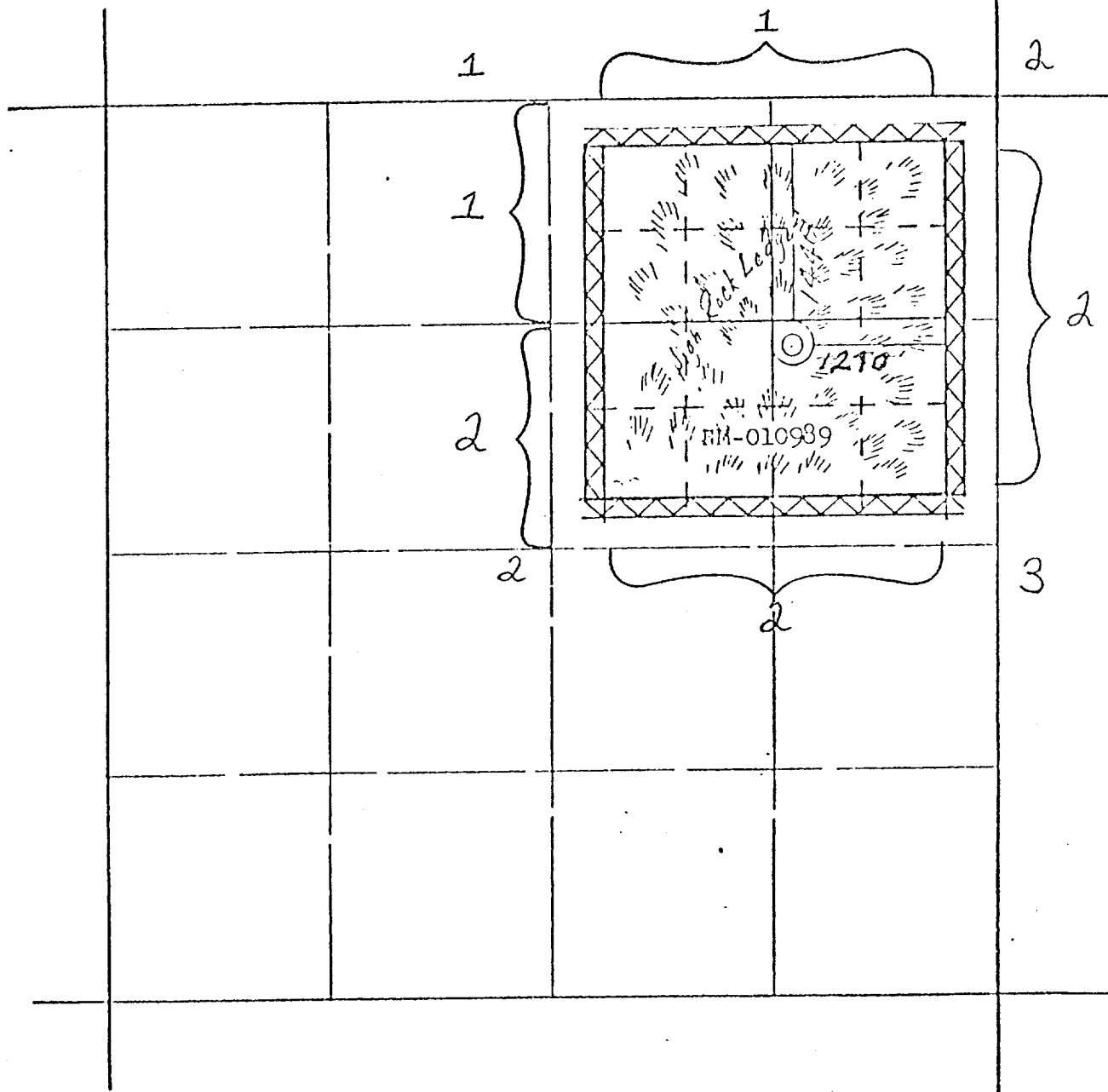

REMARKS:

- (1) Northwest Pipeline Corporation (Cox Canyon Unit)
- (2) El Paso Natural Gas Company
- (3) Amoco Production Company